

SYNCHRO

Contenu

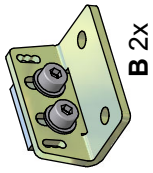

B 2x

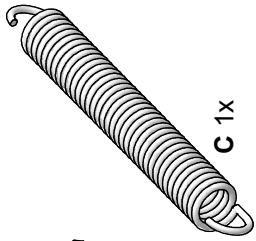

C 1x

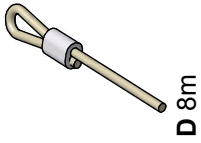

D 8m



E 4x

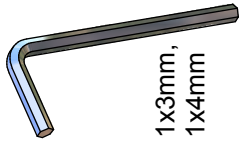

1x3mm,
1x4mm

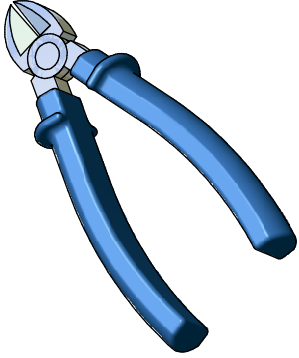
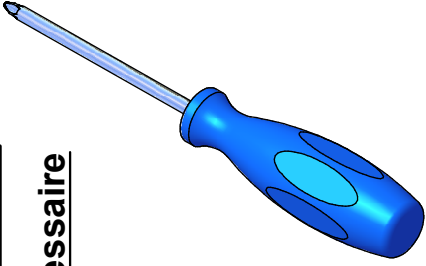

Outillage nécessaire

Méthode de travail

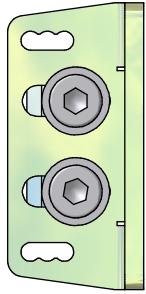

pièce d'entraînement gauche

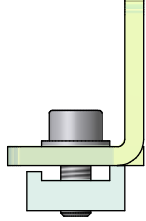

1

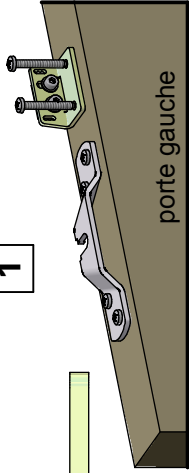

porte gauche

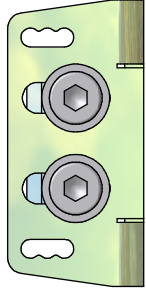

pièce d'entraînement droite

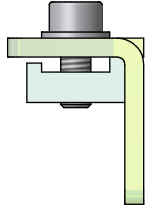

2

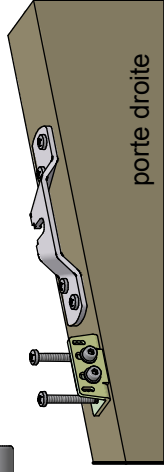

porte droite

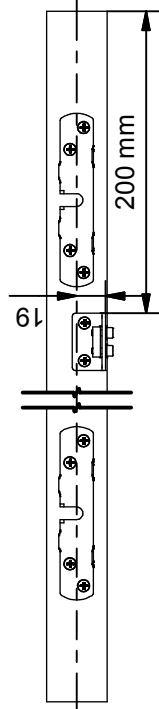
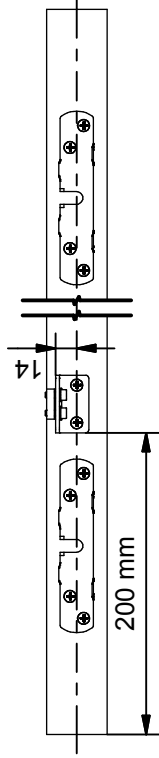

Vue de face

La jonction des 2 rails doit se trouver au centre de l'ouverture dans le mur

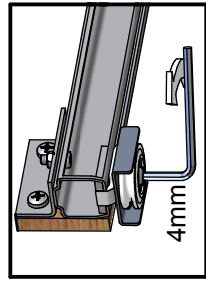
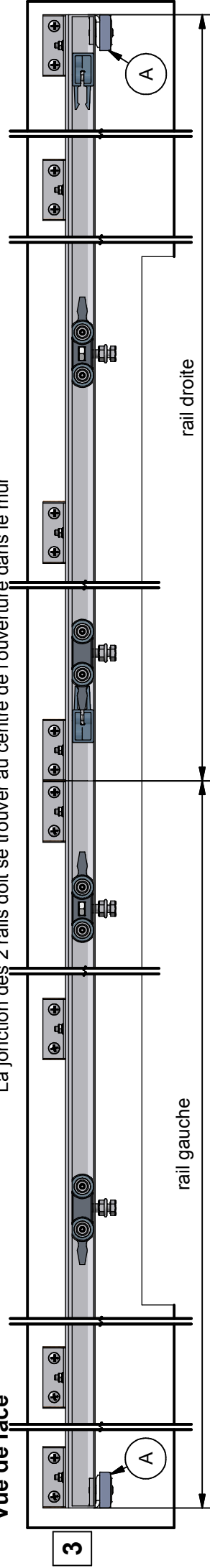

positionner et fixer les roues de retour (2x)

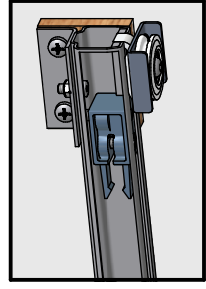

Vue de face

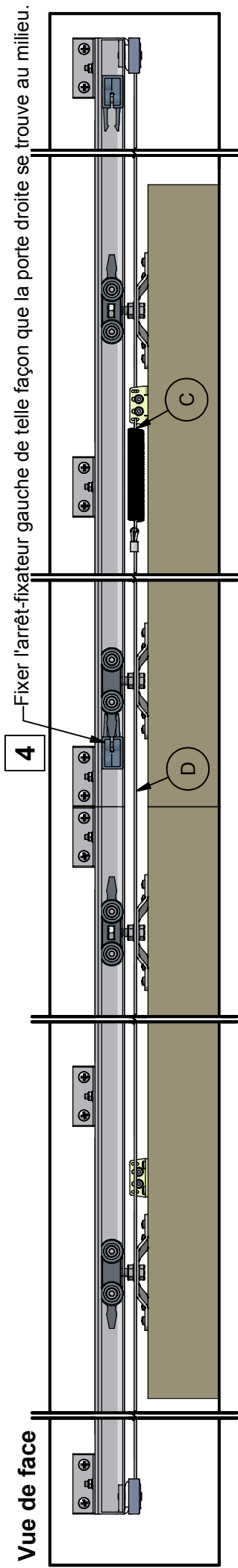

Vue de dessus

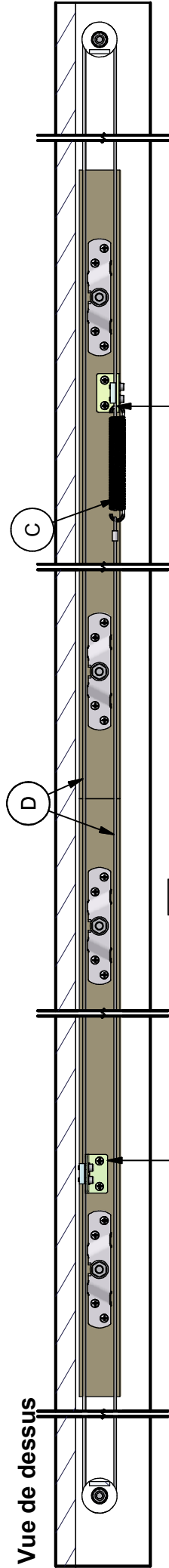

6 Placer la 2^e porte contre la première et fixer le câble à la pièce d'entraînement gauche.

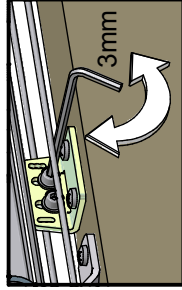

5 Serrer le câble afin d'étirer le ressort jusque $\pm 1\text{cm}$ et le fixer à la pièce d'entraînement droite.

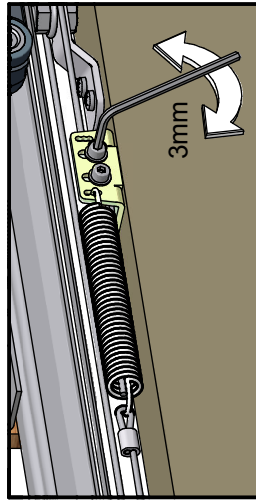

Vue de face

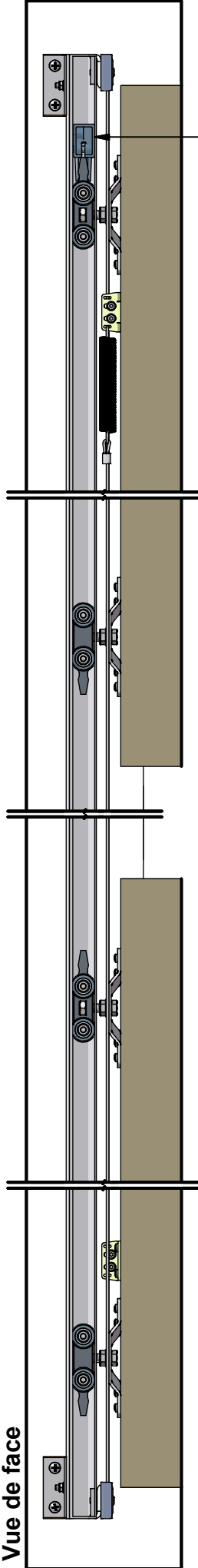

7 Fixer l'arrêt-fixateur droite quand les portes sont ouvertes.

