

NaMara flair



BIFOLD DOOR

PORTE PLIABLE

PORTA A SOFFIETTO

ZWEIFLÜGELIGE FALTTÜR

VOUWDEUR

INSTALLATION TOOLS
OUTILS POUR L'INSTALLATION
STRUMENTI PER L'INSTALLAZIONE
MONTAGEWERKZEUGE
INSTALLATIEMATERIAAL

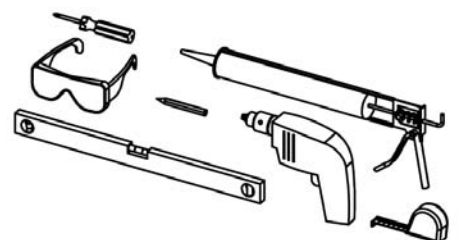

EN

BEFORE YOU INSTALL YOUR SHOWER ENCLOSURE,
PLEASE READ ALL INSTRUCTIONS. FAILURE TO DO SO MAY
LEAD TO INVALIDATION OF YOUR WARRANTY

- The shower tray MUST be fitted level, tiled in and sealed along its entire wall length.
- Glass door edges are vulnerable. Contact with hard surfaces may result in glass breakage.
- The shower enclosure should be sealed on the outside using silicon sealant.
- Check walls for electrical cabling or water pipes before drilling

FR

AVANT D'INSTALLER VOTRE PAROI DE DOUCHE, LIRE
ATTENTIVEMENT TOUTES LES INSTRUCTIONS. LE NON RESPECT DE
CETTE CONSIGNE ANNULERA LA GARANTIE DE VOTRE PRODUIT

- Le receveur doit être monté de niveau, cerclé à l'intérieur et scellé entièrement le long du mur.
- Les bords des portes en verre sont vulnérables. Le contact avec une surface dure peut casser le verre.
- L'extérieur du receveur doit être scellé avec du silicone.
- Avant de percer, vérifiez que dans vos murs ne figure aucun câble électrique ou conduite d'eau.

ITA

PRIMA DI INSTALLARE IL BOX DOCCIA, SIETE PREGATI DI LEGGERE ATTENTAMENTE
LE ISTRUZIONI. LA MANCATA OSSERVANZA DELLE ISTRUZIONI D'INSTALLAZIONE
PUÒ COMPORTARE L'INVALIDITÀ DELLA GARANZIA.

- Il piatto doccia DEVE ESSERE installato in piano, piastrellato e sigillato su tutta la lunghezza della parete a contatto.
- I bordi della porta a vetro sono fragili. Il contatto con superfici dure potrebbe causarne la rottura.
- Il box doccia dovrebbe essere sigillato sul lato esterno con del silicone.
- Prima di usare il trapano controllare che in corrispondenza dei fori nel muro non vi siano passaggi di cavi elettrici o tubi dell'acqua

GER

BITTE LESEN SIE VOR DER MONTAGE IHRER DUSCHKABINE DIE GESAMTE ANLEITUNG.
NICHTBEACHTUNG KANN ZUR ERLÖSCHUNG IHRER GARANTIE FÜHREN.

- Die Duschwanne MUSS eben aufgestellt, eingefliest und entlang ihrer gesamten Wandlänge abgedichtet werden.
- Die Ecken der Glastüren sind zerbrechlich. Kontakt mit harten Oberflächen kann zu Glasbruch führen.
- Die Duschkabine muss von außen mit Dichtmittel versiegelt werden.
- Stellen Sie vor dem Bohren sicher, dass sich keine elektrischen Kabel oder Wasserrohre in den Wänden befinden.

NL

LEES ALLE INSTRUCTIES GOED DOOR VOORDAT U DE DOUCHEDEUR
OF DOUCHEWAND INSTALLEERT. HET NIET NALEVEN VAN DEZE INSTRUCTIES
KAN UW GARANTIE BEPERKEN OF ZELFS TE NIET DOEN.

- De douchebak MOET waterpas geïnstalleerd worden, met tegels vastgezet worden en alle wandaansluitingen moeten met kit goed gedicht worden.
- Hoeken van glazen deuren zijn kwetsbaar. Contact met harde voorwerpen kan leiden tot glasschade.
- De douchedeur of douchewand dient aan de buitenkant met kit afgedicht te worden.
- Controleer vóórdat u begint te boren of zich elektrische leidingen of waterleidingen in de wand bevinden.

PRODUCT SIZE
DIMENSIONS DE LA PORTE
DIMENSIONE PRODOTTO
PRODUKTGRÖSSE
PRODUCTOMVANG

750 - 800 mm
850 - 900 mm
950 - 1000 mm

1150 - 1200 mm

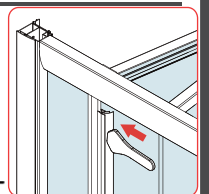
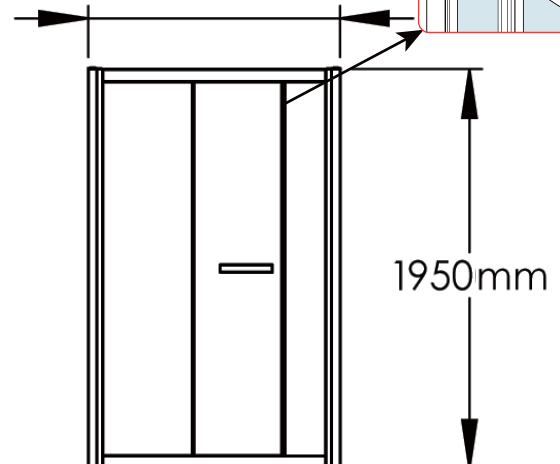
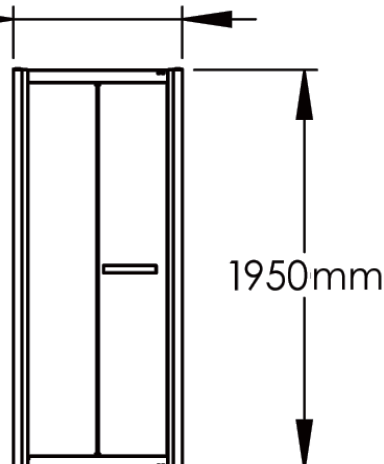

COMPONENT PACK
CONTENU DU SACHET
IMBALLAGGIO COMPONENTE
KOMPONENTEN-VERPACKUNG
VERPAKKING ONDERDELEN

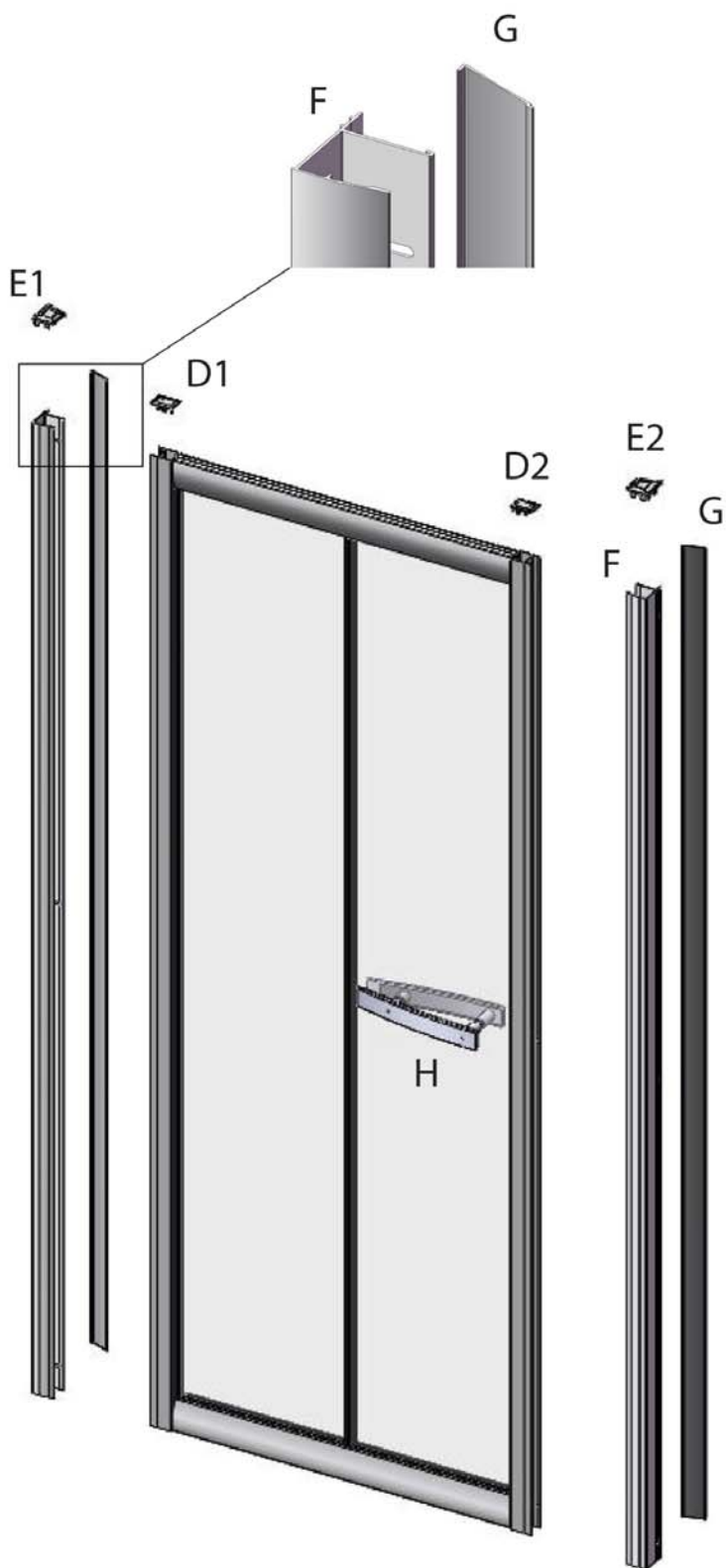
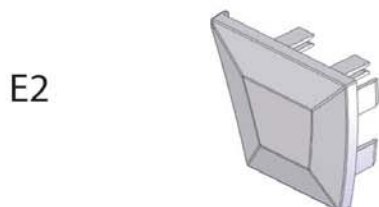
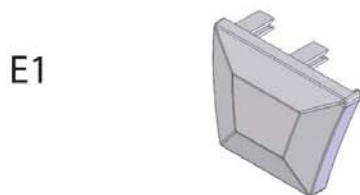
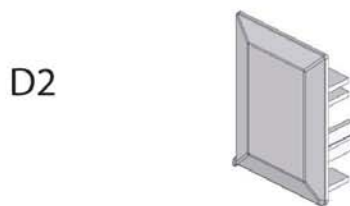
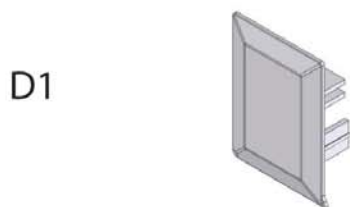

1

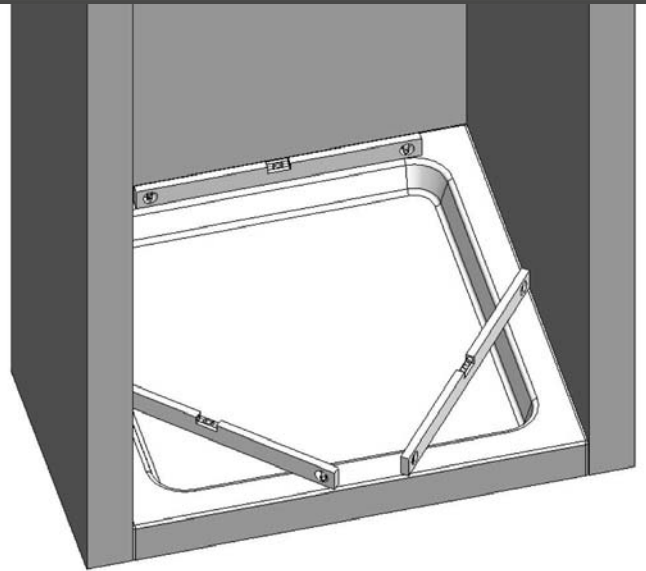
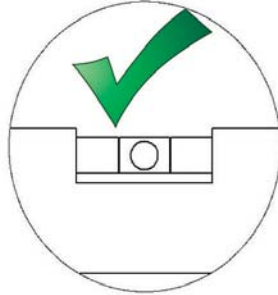
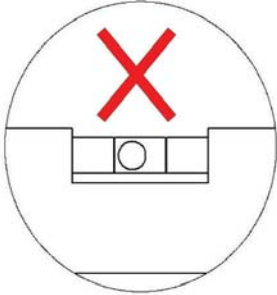

2

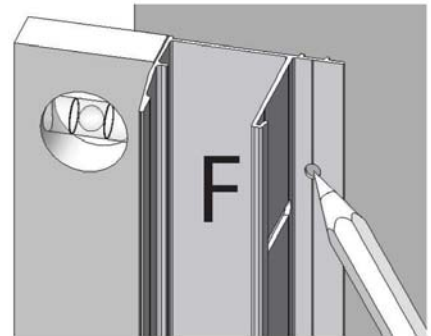
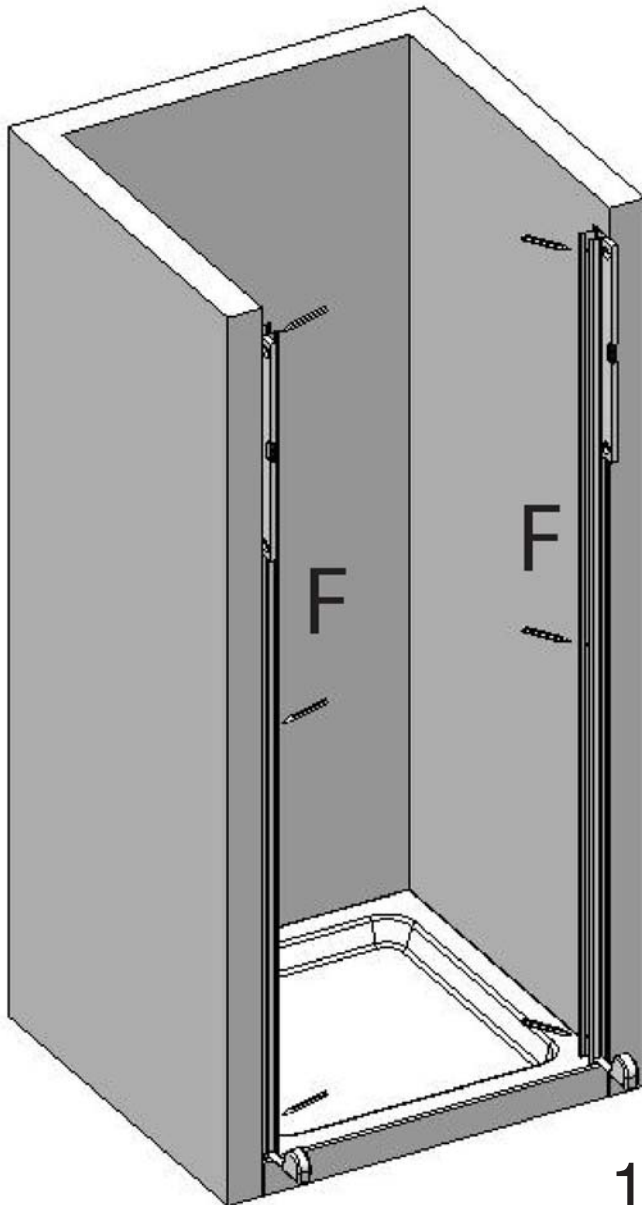

2.2

2.1

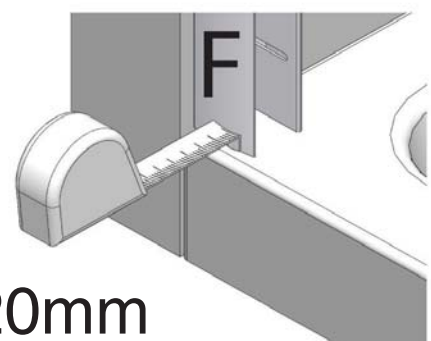

15-20mm

3

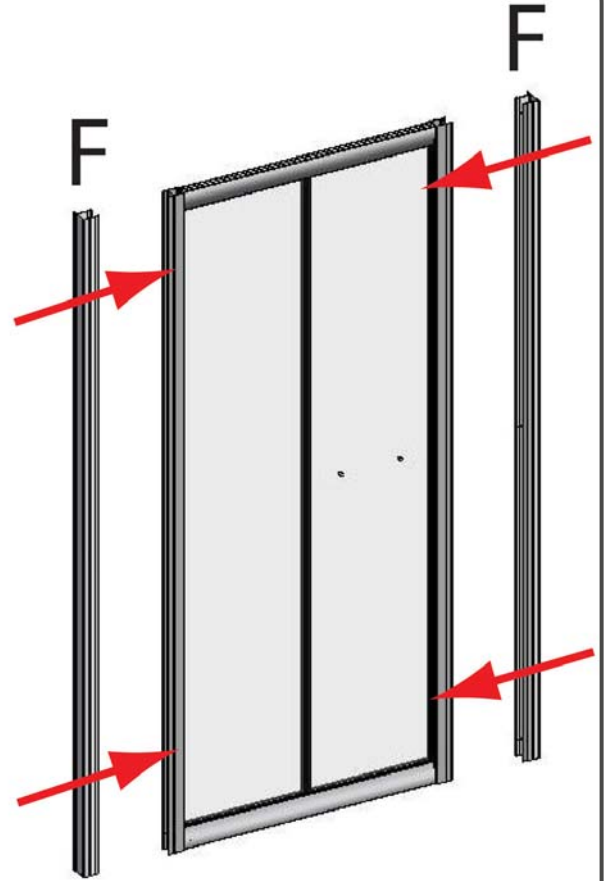
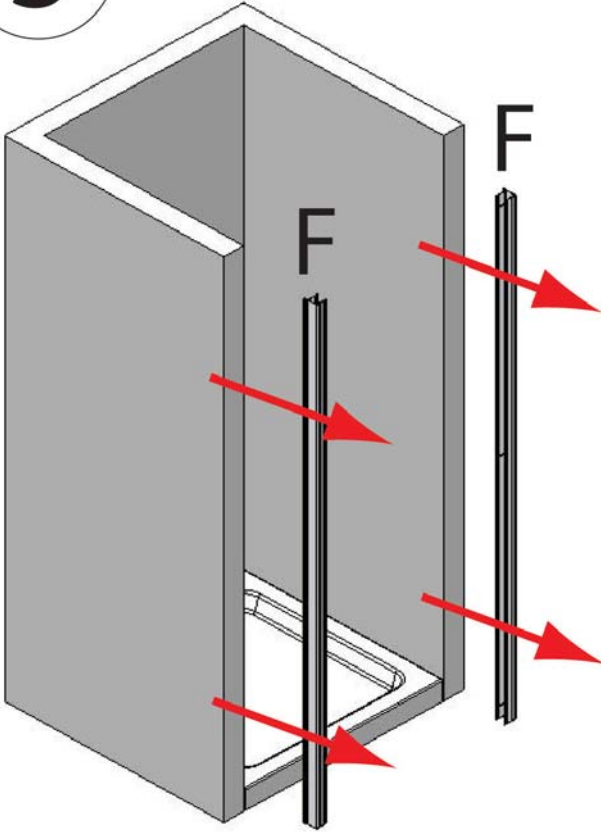

4

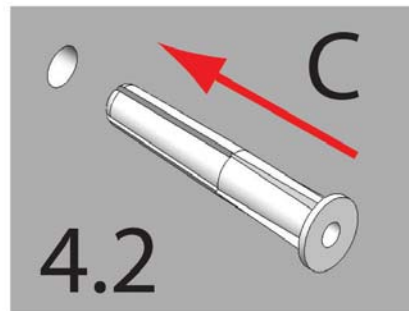
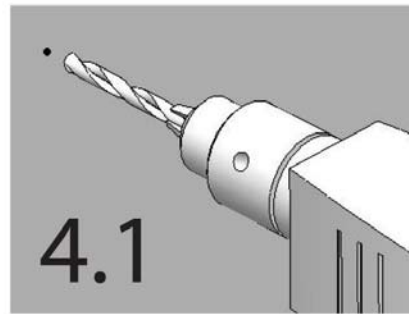
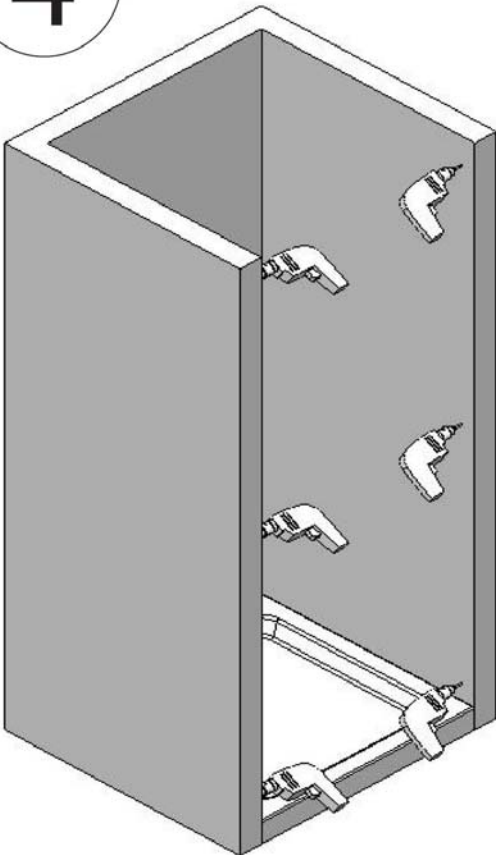

5

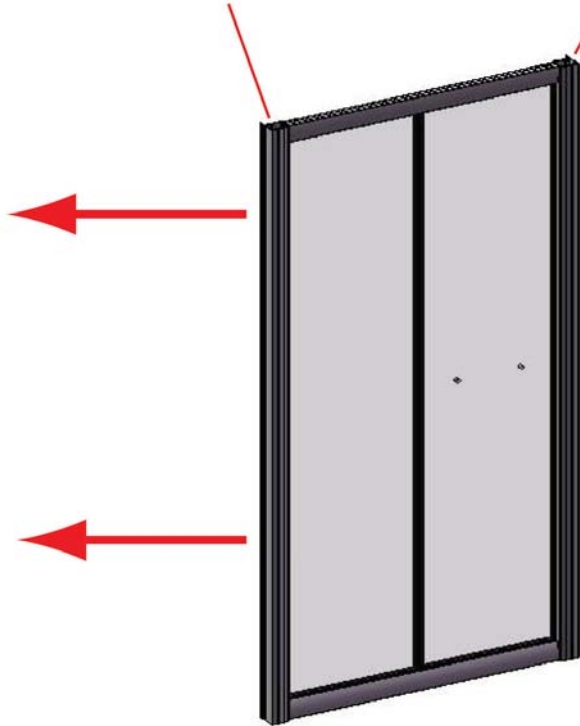
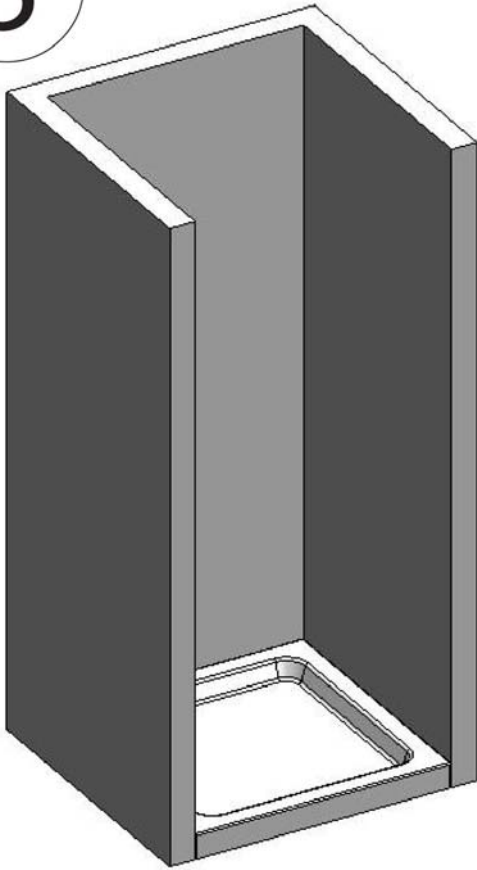

6

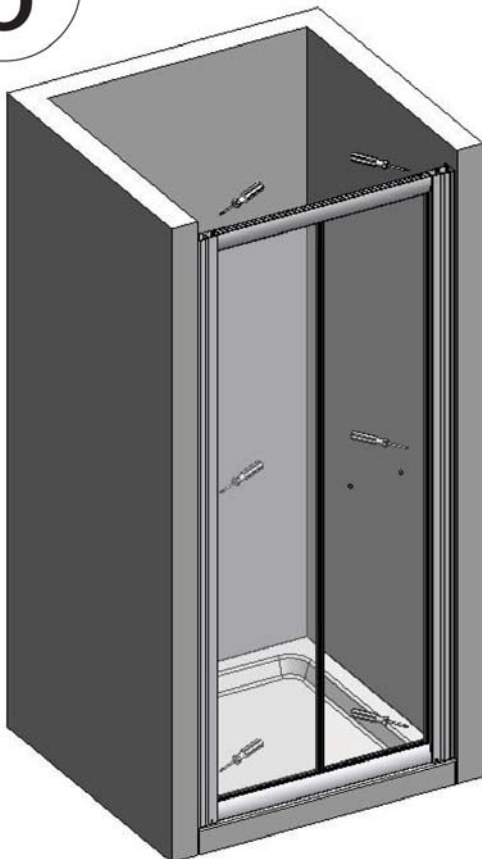

6.1

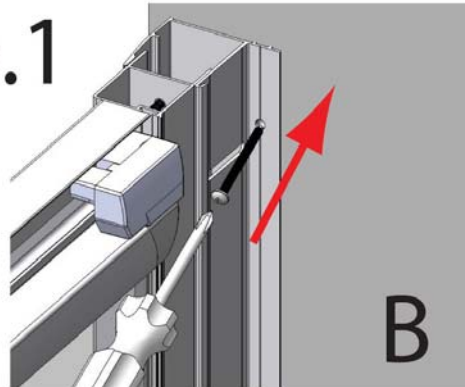

M4X40mm



6.2

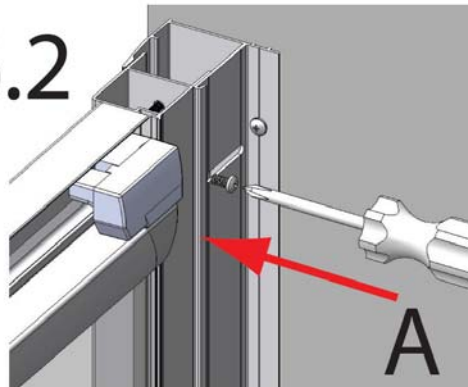

M4x8mm



7

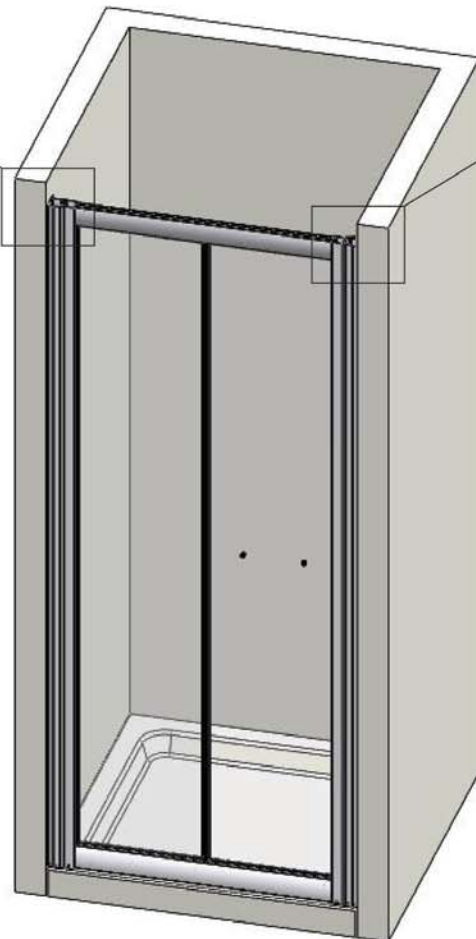
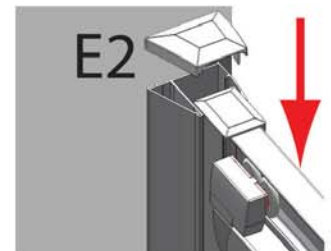
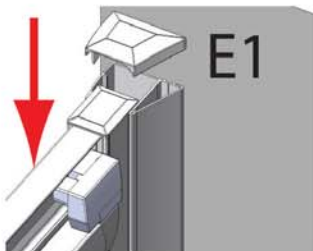
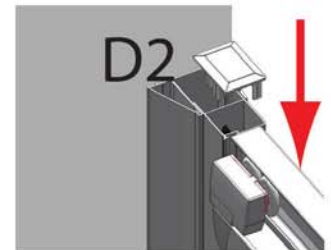
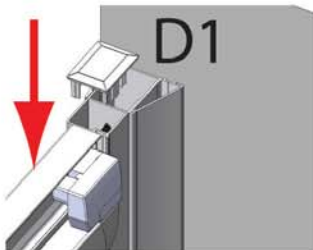
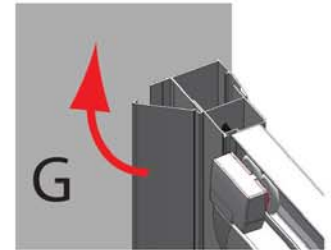
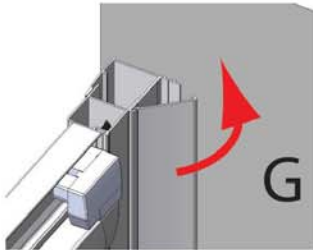
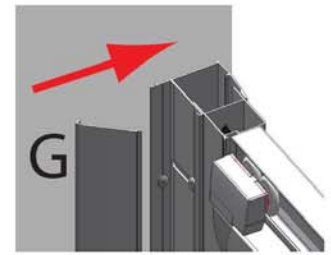
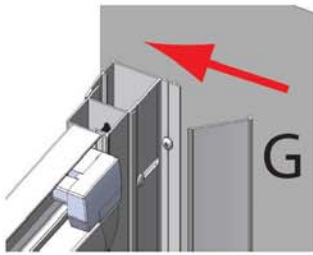

8

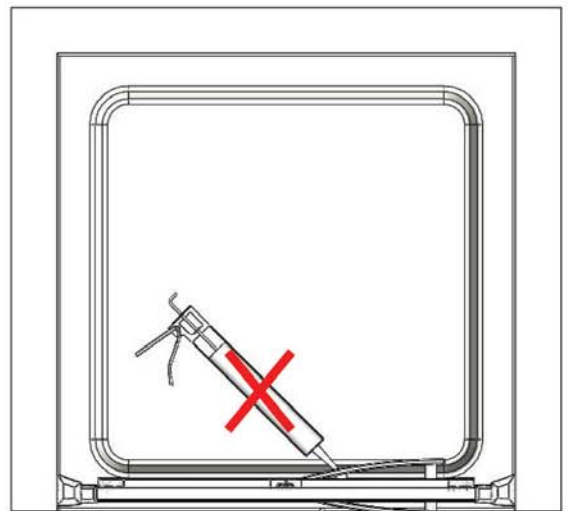
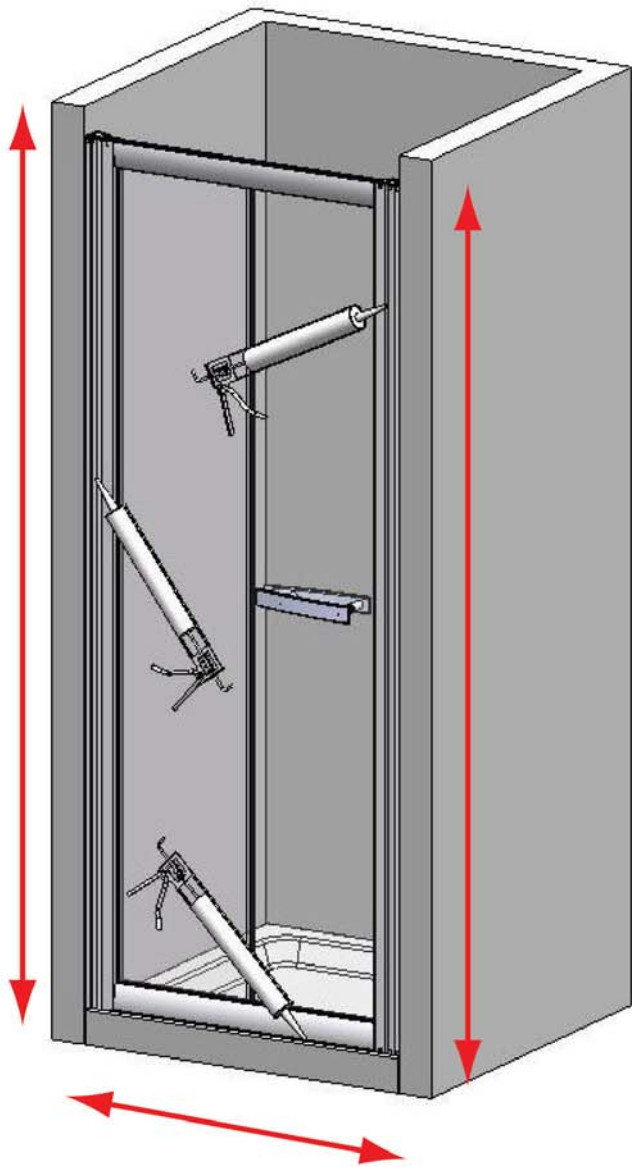

24 HRS

Flair Showers Ltd., Rocks Road, Kingscourt, Co. Cavan, Ireland
17 NA0002-06
NBF PH EN 14428 CA-IR-DA

Flair Showers Ltd., Rocks Road, Kingscourt, Co. Cavan, Ireland

+353 42 966 8000

www.flairshowers.com

EN 14428
EN12150-1
EN ISO 9001:2008