

3. INSTALACIÓN BAJO ENCIMERA

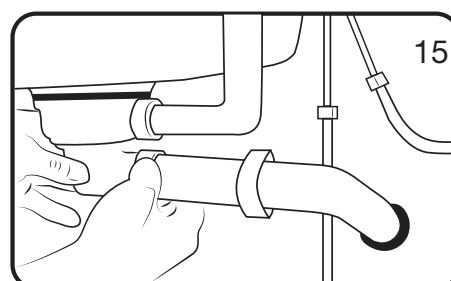

MANUAL DE INSTALACIÓN

MODELOS MARTE Y VENUS

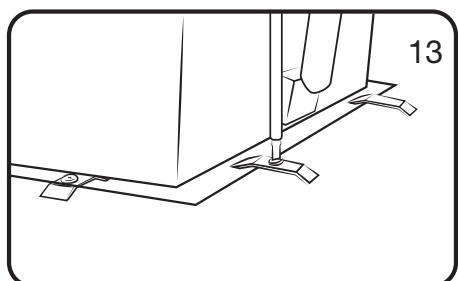
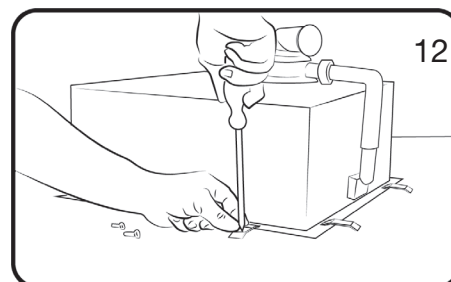
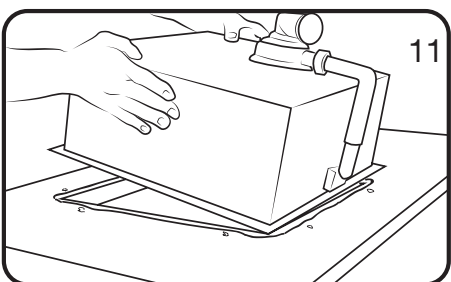
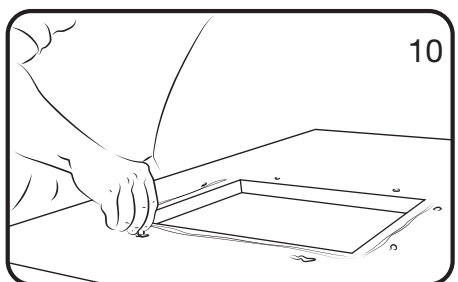
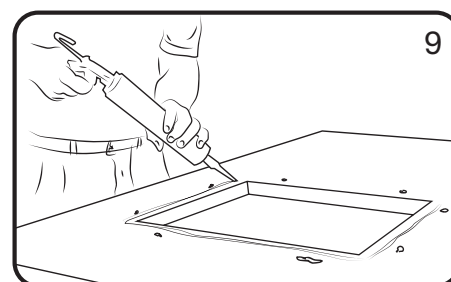
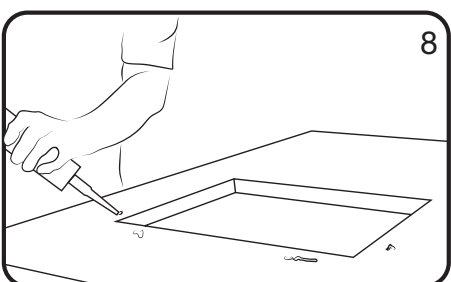
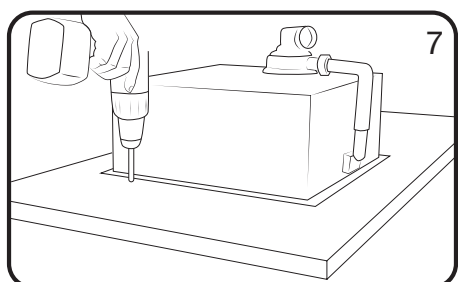
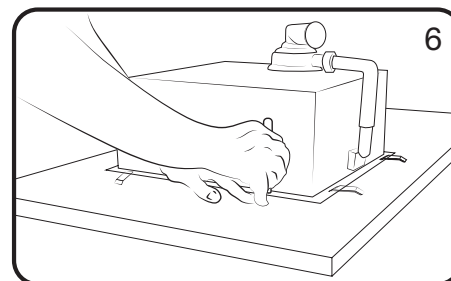
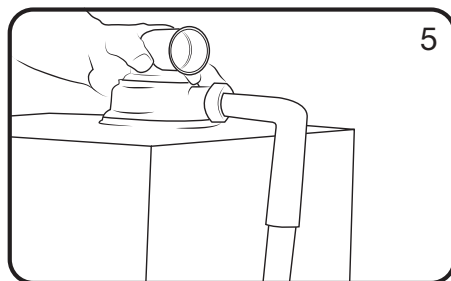
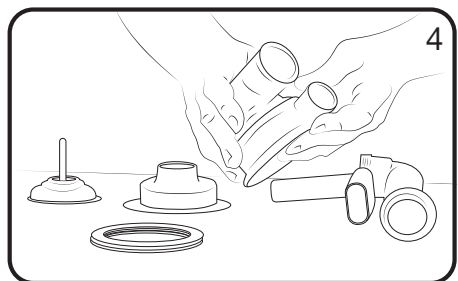
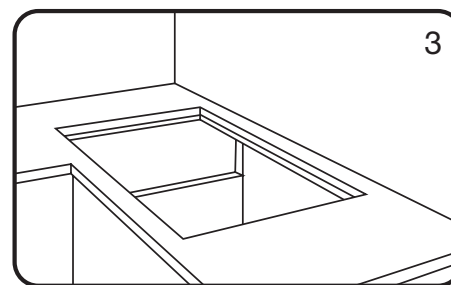
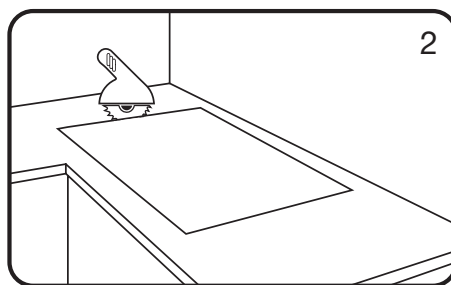
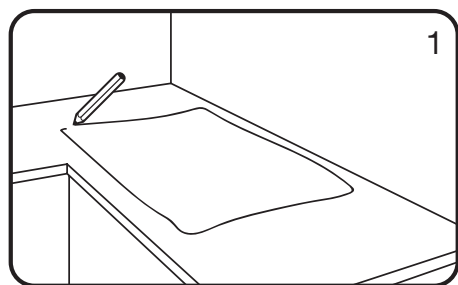

MARTE 400 x 400



VENUS 500 x 400

Usted ha adquirido un fregadero fabricado con acero inoxidable SUS 304 de máxima calidad garantizado de por vida (lea la hoja de garantía del producto). Su fregadero lleva un aislamiento térmico y acústico en la parte posterior que evita la condensación y reduce el ruido del agua.

Antes de empezar la instalación revise su fregadero:

- Posibles golpes en el transporte
- Rayas o acabado no conforme

IMPORTANTE: No instale el fregadero si observa algún daño.

MATERIAL SUMINISTRADO

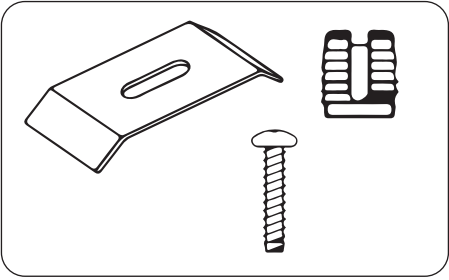

x 6

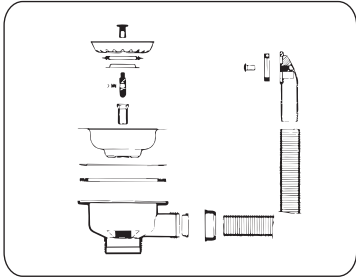

x 1

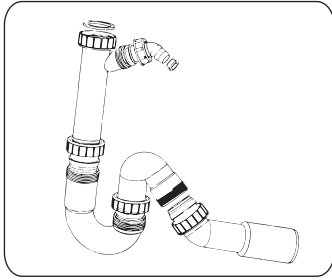

x 1

TIPOS DE INTALACIÓN:

1. INSTALACIÓN SLIM (ENCASTRADO)

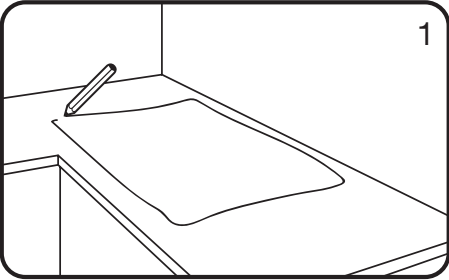

1

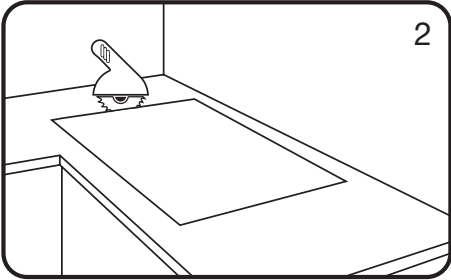

2

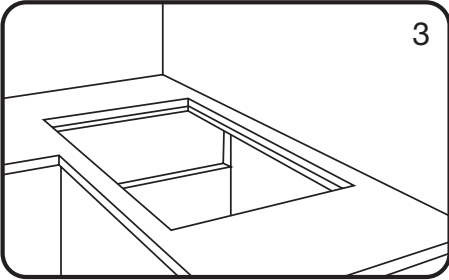

3

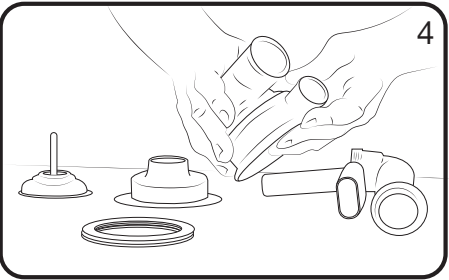

4

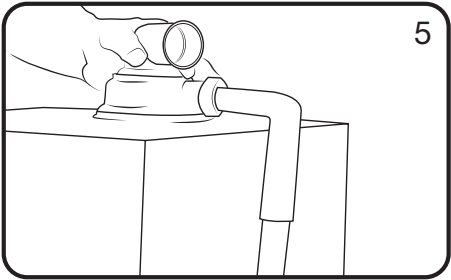

5

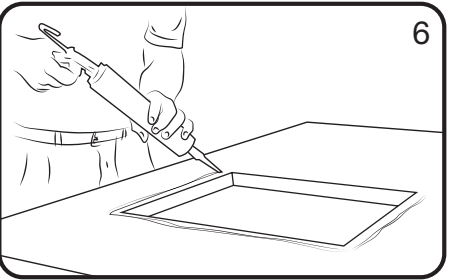

6

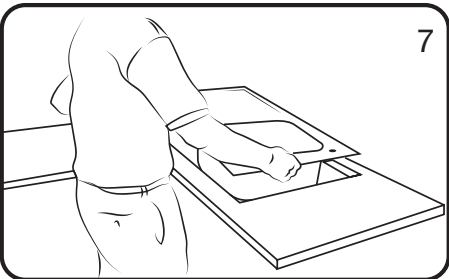

7

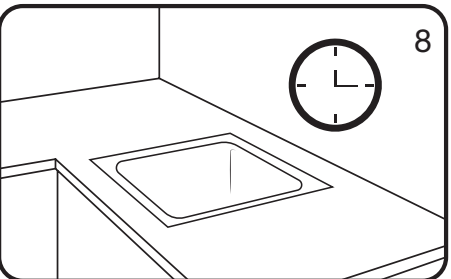

8

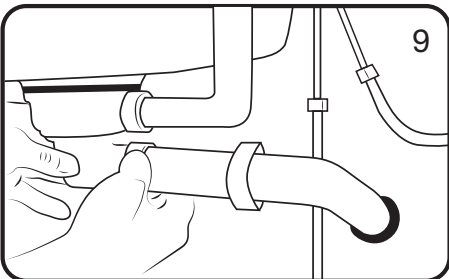

9

2. INSTALACIÓN ENRASADO



1

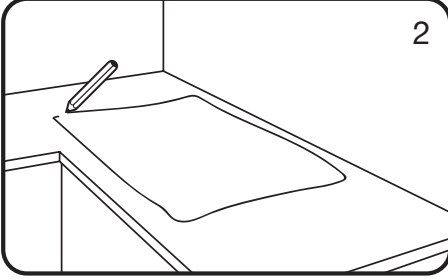

2

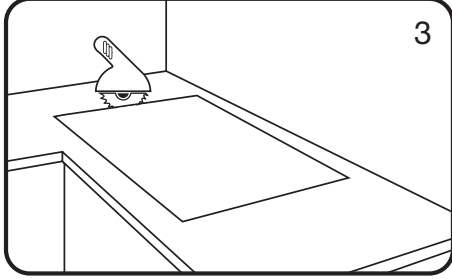

3

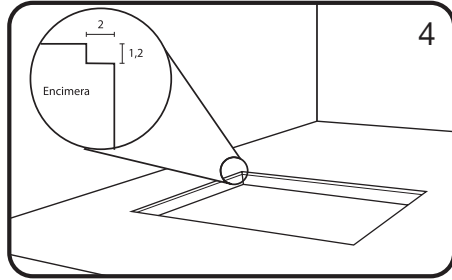

4

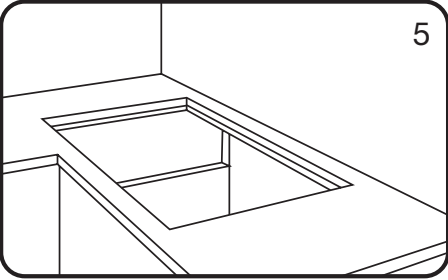

5

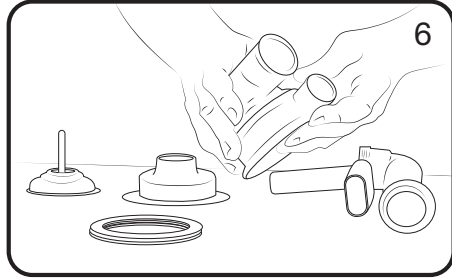

6

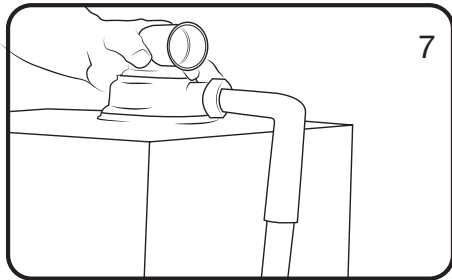

7

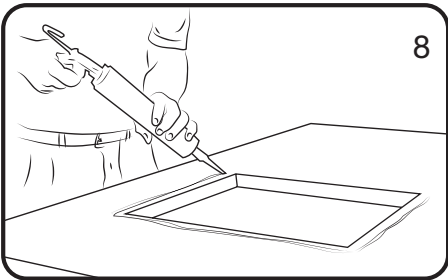

8

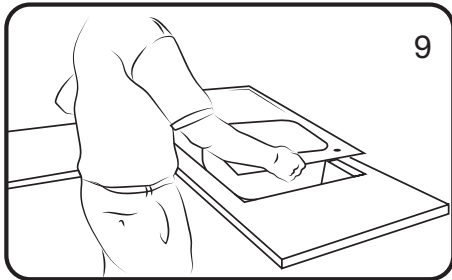

9

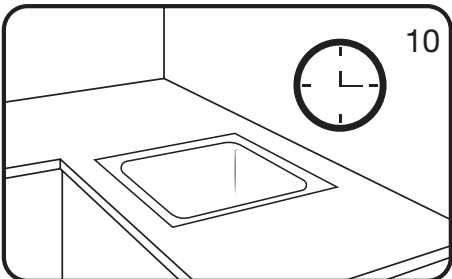

10

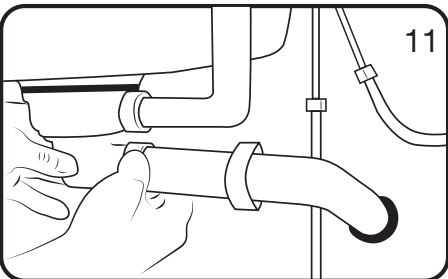

11