



chiusure per la detergenza



SPECIFICA TECNICA

Denominazione: TAPPO SICUREZZA + GUARNIZIONE PE		Codice Tecnoplast: Art. 143 SG	
Materiale: PP	Scala: 1:1	Tolleranza: ±0,2	
Cod. colore:	Peso (gr): 7,25	Confezioni (pz): 2.500	Peso conf. (kg):

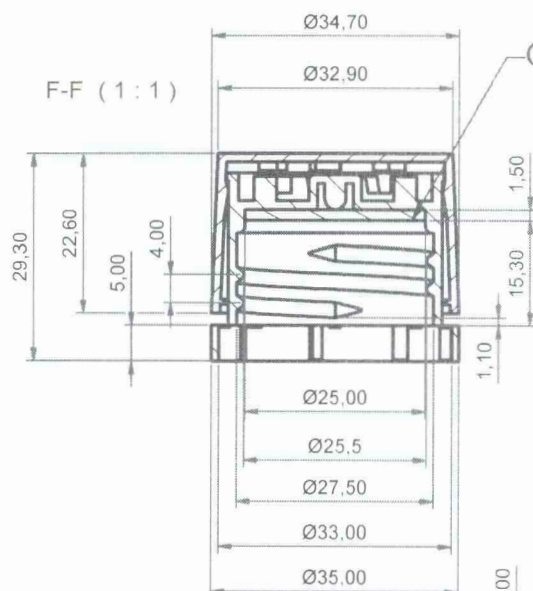
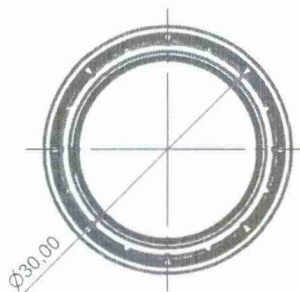

Guarnizione in polietilene

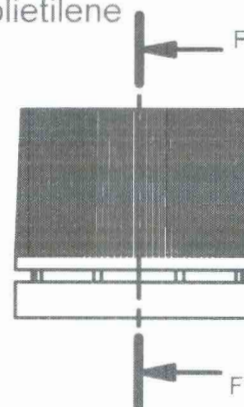

FILETTO TRAPEZOIDALE

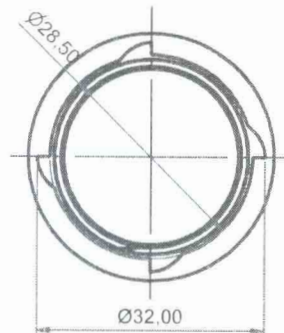
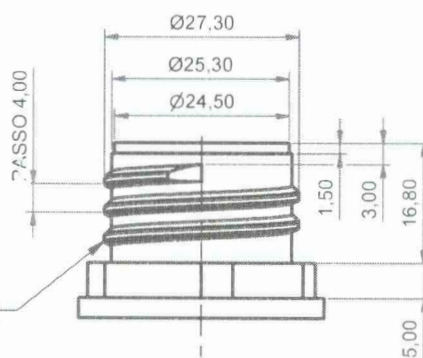

ULTIMO AGGIORNAMENTO: 02/2011

N.B.: I dati riportati nel presente disegno sono forniti a titolo indicativo, pertanto senza alcuna responsabilità da parte della Tecnoplast.



CSI
Certificazione e Testing

DIVISIONE: **FOOD PACKAGING MATERIALS**
DIVISION:

LABORATORIO: **MATERIALI**
LABORATORY:

RAPPORTO DI PROVA
(Test Report)

Pag. 1
di/of
pag. 8

N° 0278\FPM\MATs\10

Data: 29/04/2010
Date:

IDENTIFICAZIONE E DESCRIZIONE DEL CAMPIONE:
SPECIMEN DESCRIPTION:

Sample of bottle and cap described on pag. 2

DATI IDENTIFICATIVI DEL CLIENTE:
CLIENT:

TECNOPLAST DI BATTELLI ALVARO

VIA del Lavoro, 365
47835 SALUDECIO (RN)

NORMA DI RIFERIMENTO:
REFERENCE STANDARD:

UNI EN ISO 8317:2005

DISTRIBUZIONE ESTERNA:
OUTSIDE DISTRIBUTION:

TECNOPLAST DI BATTELLI ALVARO

DISTRIBUZIONE INTERNA:
INSIDE DISTRIBUTION:

Copia: Responsabile Divisione

ENTE DI ACCREDITAMENTO:
ACCREDITATION BODY:



**CSI**

Certificazione e Testing

RAPPORTO DI PROVA
(Test Report)

N° 0278\FPM\MATs\10

Pag. 2
di/of
pag. 8Data: 29/04/2010
Date:**GENERALITIES:**

- Samples receipt date: 13/04/2010
- Initial date of testing: 19/04/2010
- End date of testing: 29/04/2010
- Deviation from standard methods: NO

SAMPLES DESCRIPTION

Bottle BOX500/04 with plastic cap child resistant.

We bring again the reference of technical drawing for every member:

BOTTLE drawing DIS N. 221009_2

CAP drawing ART. 143 SS drawing ART: 143 SG

DECLARATION:

- The test results of the present report refer exclusively to the tested sample.
- The present report cannot be reproduced partially without the Managing Director permission.

SAMPLING

The initial sampling was done by the customer.

The sampling for the test was done drawing part of the sample in our possession.



CSI
Certificazione e Testing

RAPPORTO DI PROVA
(Test Report)

N° 0278\FPM\MATs\10

Pag. 3
di/of
pag. 8

Data: 29/04/2010
Date:



ANALISYS

The test will be performed as UNI EN ISO 8317:2005 "Child - resistant packaging – Requirements and testing procedures for reclosable packages".

The test was carried out by a sequential procedure, with a number of children less than the global method (200 children between the ages of 42 - 51 months inclusive and 100 adults between the ages of 50 - 70).

At the end of each step, the results are evolved and the line was calculated.

From the comparison of this line with two other reference lines, it's possible to decide if is necessary to continue or stop the test.

If the pilot line is under the two reference lines, the test will be consider positively complete; if the pilot line is between the two reference lines the standard expecting to continue the test with other analysis; if the pilot line is above of the two reference lines, the test will be consider negatively complete.

In the chart will be two reference lines, the first indicated as 85 % and the second as 80 %, calculated assuming an opening of bottle like as 85 and 80 %.

Child test

The children shall perform the test in their usual school. If a child is used on more than one test panel, it's desirable that there should be at least one week between the tests.

During the test, children should be removed from the general student body in the test location and protected from extraneous distractions.

The children shall be healthy with non evident physical handicap which may affect manual dexterity.

Each child shall be given a package with the request that it be open by whatever means the child wishes to use; in order to achieve this, 5 min shall be allowed. If a child succeeds in opening the package within 5 min, that child shall remain in the test area until the end of the period. Any child failing to open the packaging in 5 min shall then watch a package being opened and reclosed by the supervisor in full view, without emphasis being placed on the actions of opening and without any verbal instruction. The child shall have a further 5 min to open the package.

**CSI**

Certificazione e Testing

RAPPORTO DI PROVA
(Test Report)

N° 0278\FPM\MATs\10

Pag. 4
di/of
pag. 8Data: 29/04/2010
Date:

n° 0006

After each period of 5 min, it shall be recorded whether a child fails to open the package; if the child succeeds, it shall be recorded whether this was before or after demonstration. It shall also be recorded whether teeth (or any other means) were used to open the package.

Adult test

The 100 valid participants shall be randomly selected between the ages of 50 and 70 according to the criteria of standard.

Each adult shall be given a package together with any accessories and written instructions on how to open and reclose it properly that will be printed in or on the package when supplied to a consumer.

No demonstration of how to open or reclose the package shall be given. Acting independently, a period of 5 min shall be allowed for the test participants to familiarize with the package to be tested by reading the opening and closing instructions and attempting to open and reclose it properly.

Record whether or not the adult succeeds in opening and properly reclosing the package in the 1 min test periods.