



JNKA

IT-Istruzioni di montaggio

base 1 vano giorno

EN-Assembly instructions

open unit with 1 compartment

FR-Notice de montage

Base 1 élément à jour

86670422

86670423

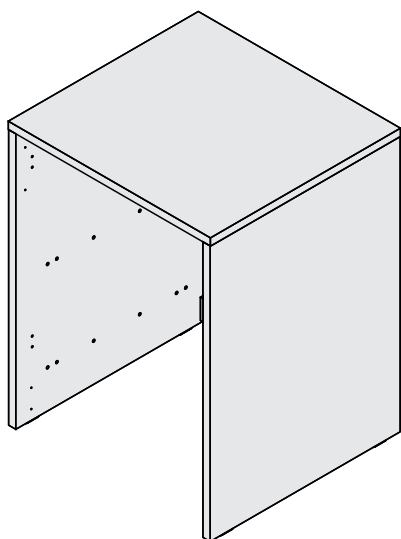

87675531

87675532

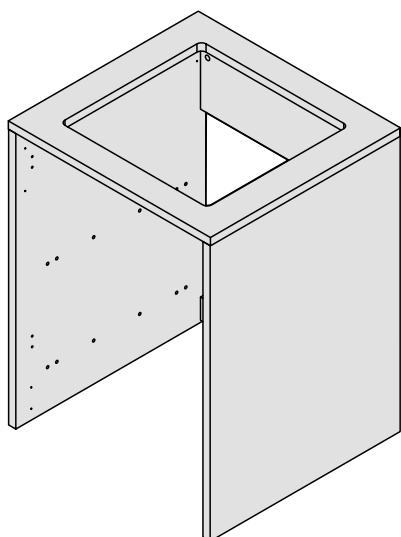

86670395

86670396

opzionale/optional/
optionnel

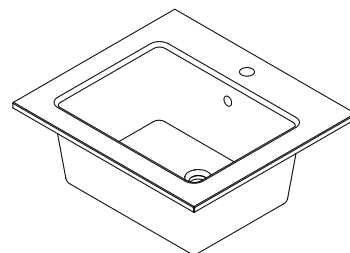

86670391

87675536

opzionale/optional/
optionnel

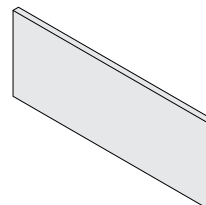

86670392

86670375

opzionale/optional/
optionnel

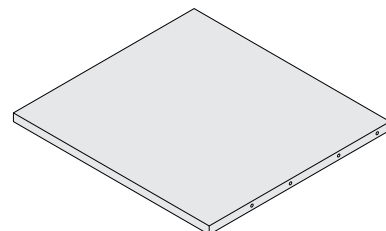

86670376

87675535

opzionale/optional/
optionnel

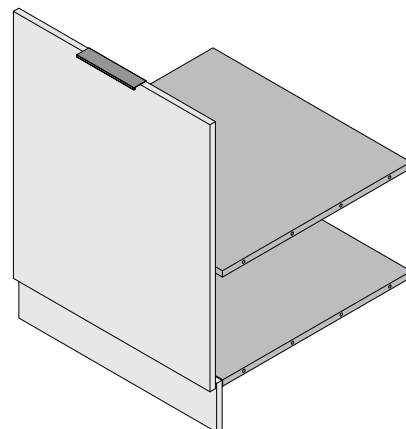

86670422

86670423

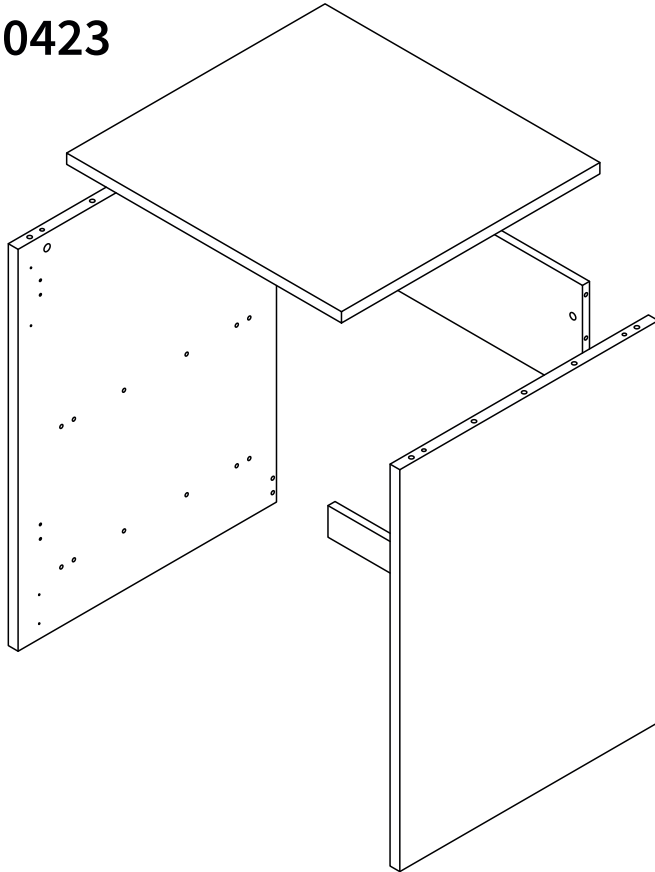

IT-Al fine di evitare il ribaltamento del mobile è obbligatorio il fissaggio dello stesso a parete tramite le apposite attaccaglie.

* Viti e tasselli (non inclusi) devono essere adeguati al tipo di materiale della vostra parete

EN-In order to avoid the furniture overturning, you have absolutely fix it to the wall through the appropriate attachments

* Screws and dowels (not included) must be suitable to the type of material of your wall

FR-Pour éviter tout risque de basculement, le meuble doit être absolument fixé au mur à l'aide des supports de fixation fournis

* Utiliser des vis et chevilles (non fournies) adaptées au type de matériaux de votre mur

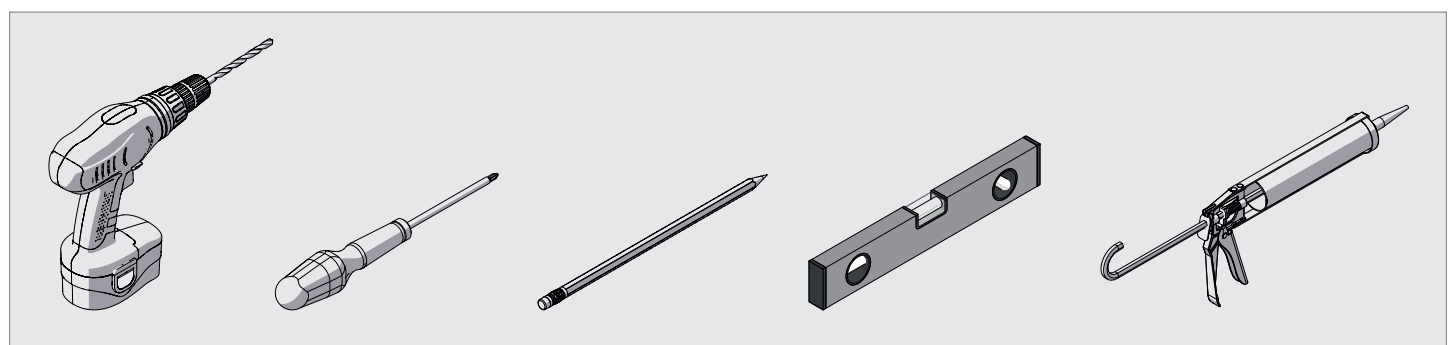
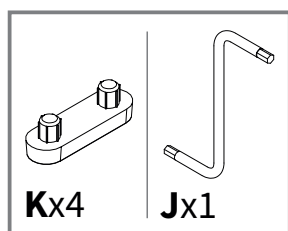
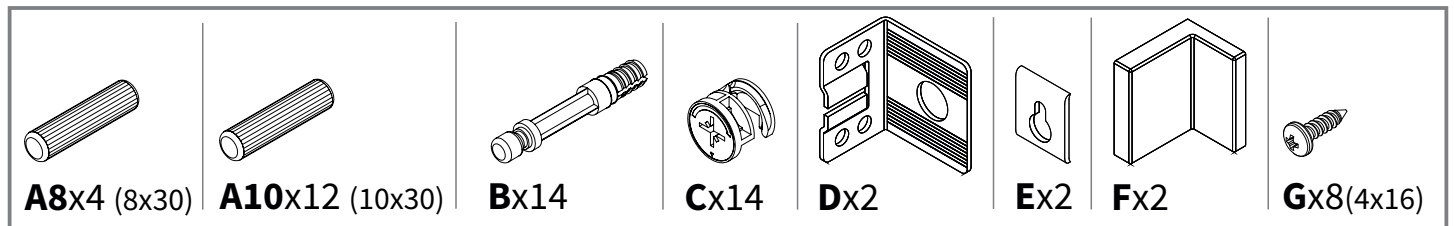

1

IT-Assemblaggio elementi base
EN-Assembly base units elements
FR-Assemblage des éléments de bases

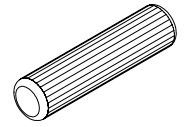
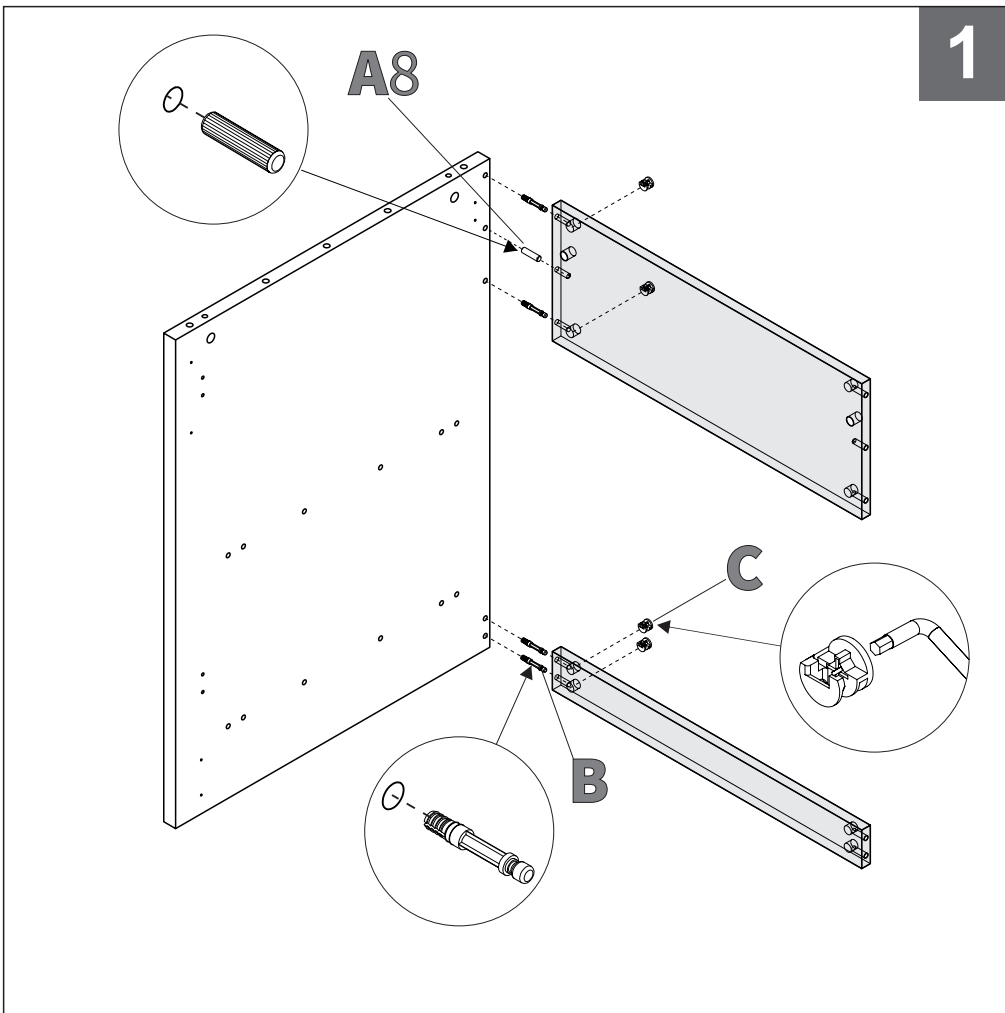

A8x1

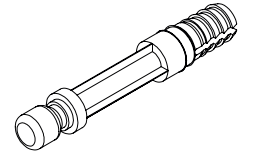

Bx4

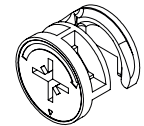

Cx4

2

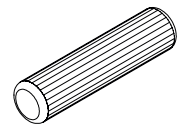
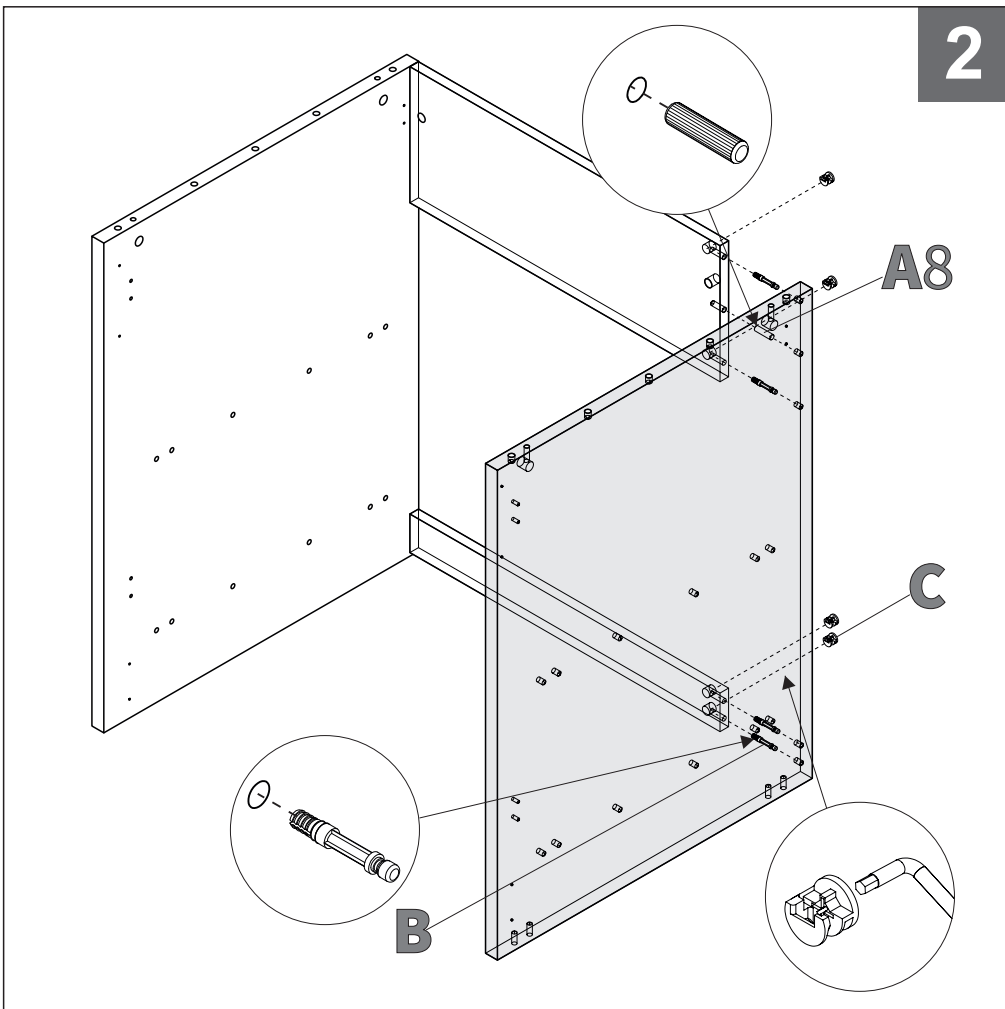

A8x1

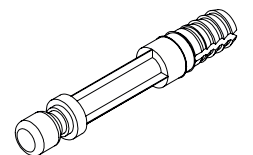

Bx4

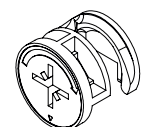

Cx4

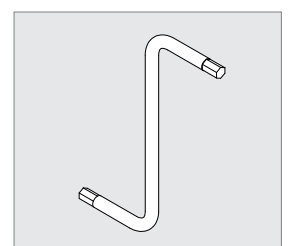

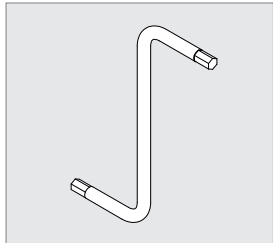
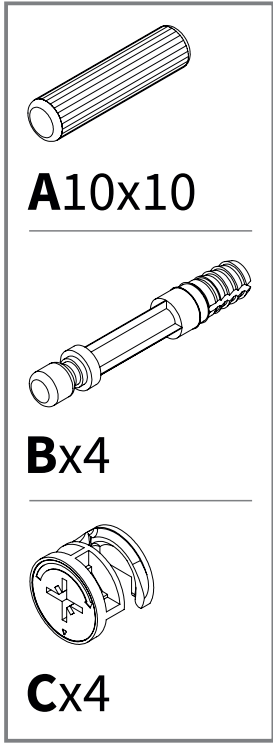
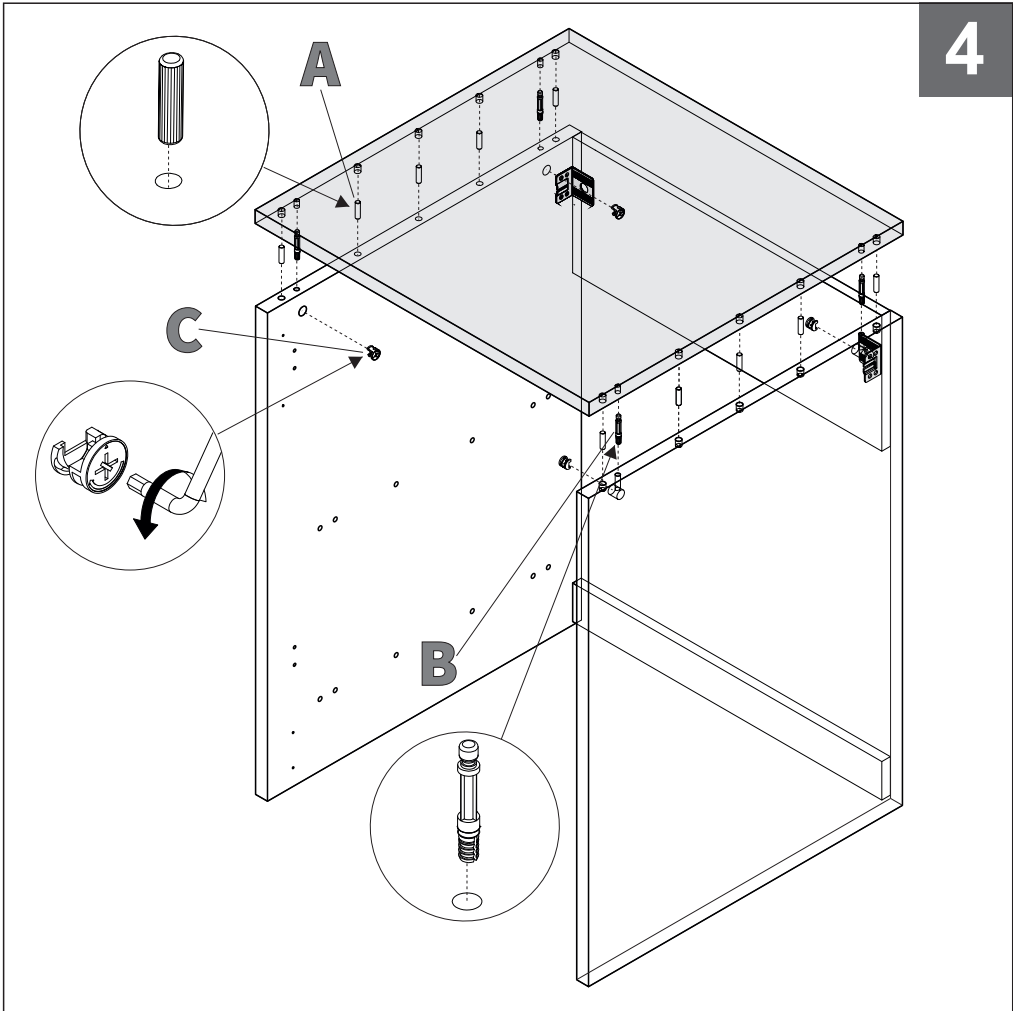
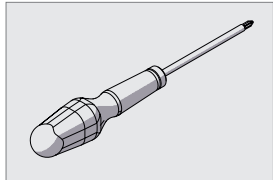
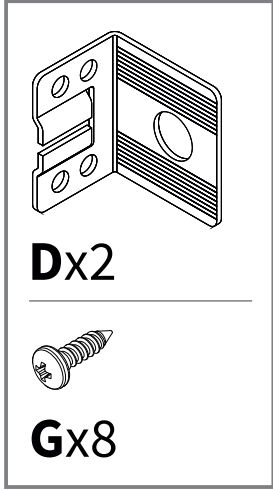
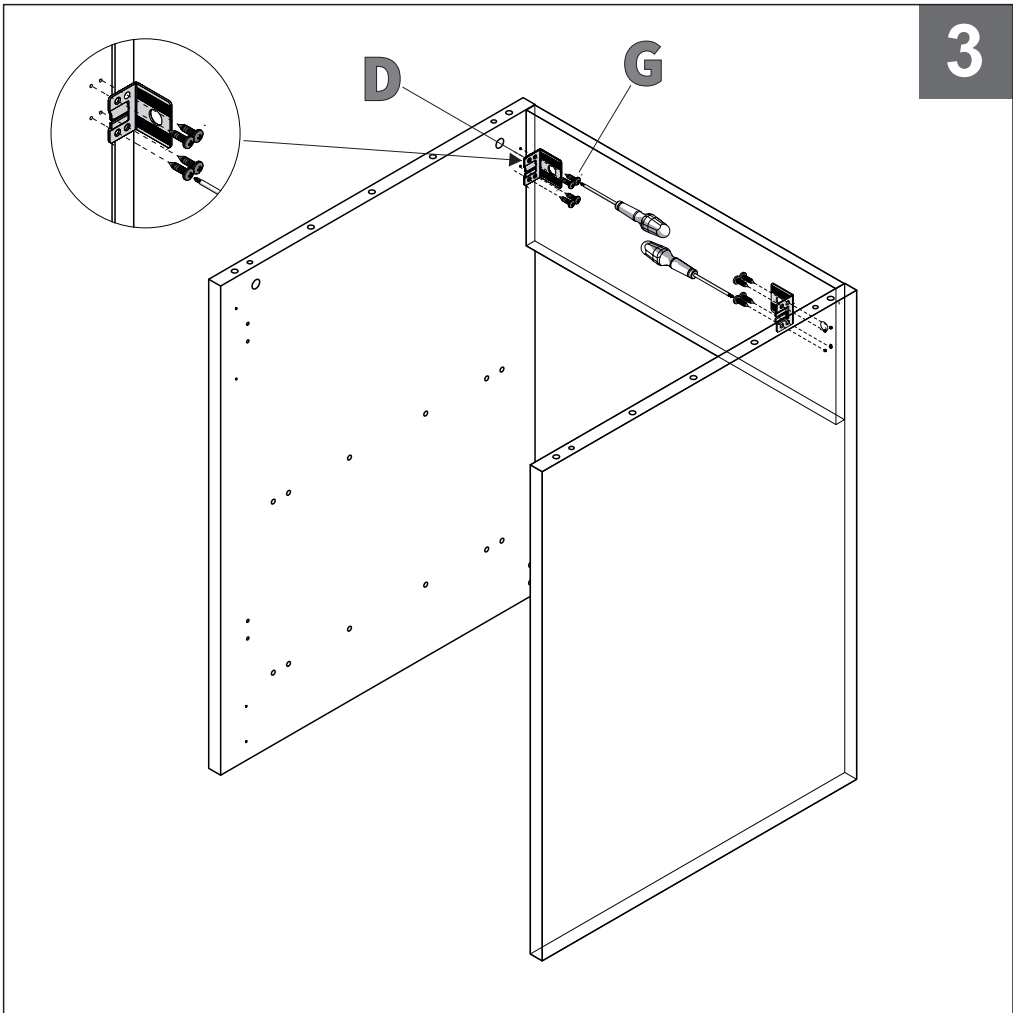

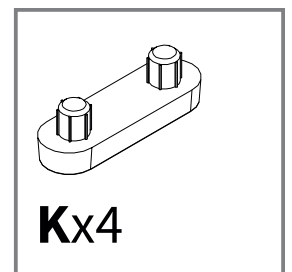
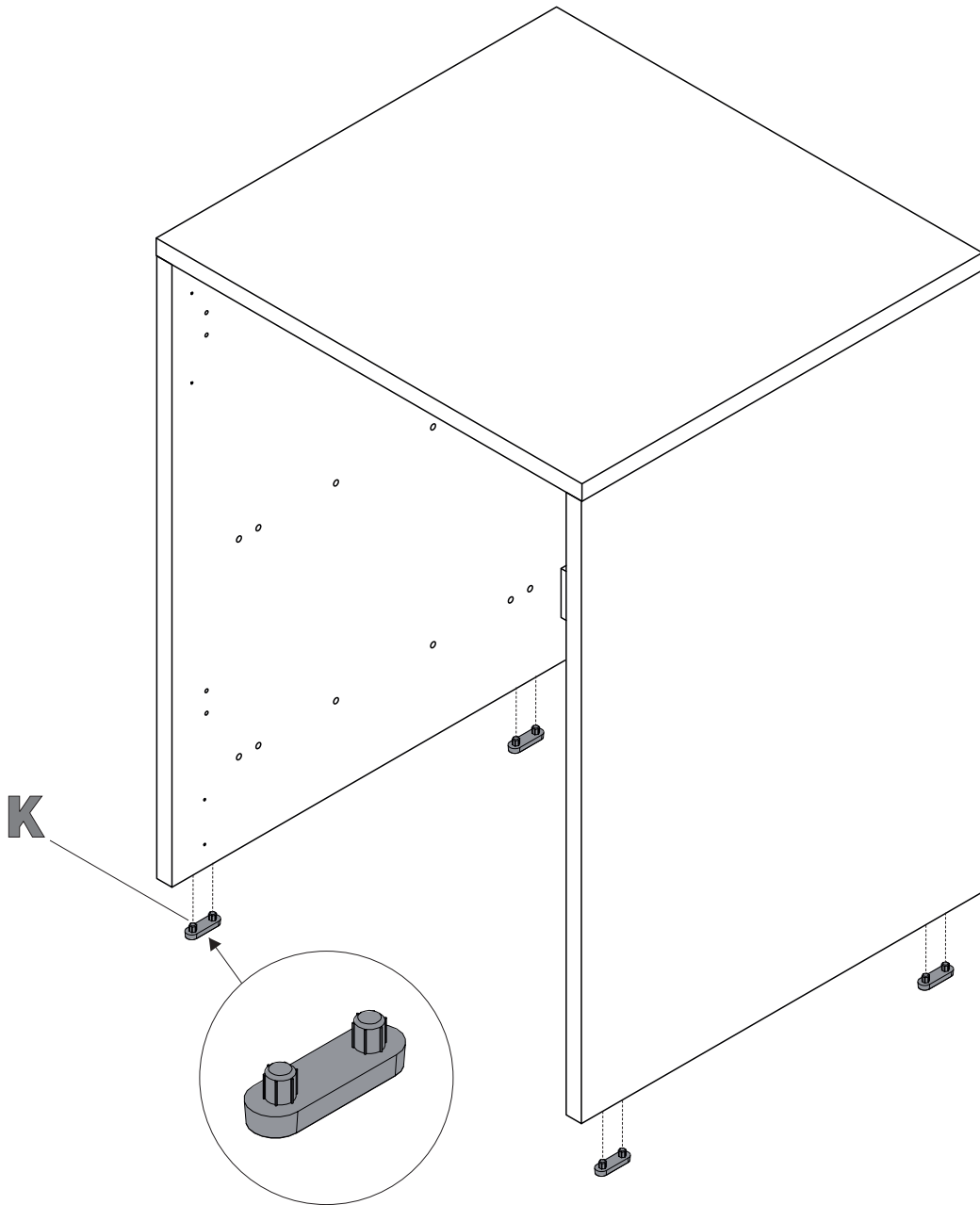

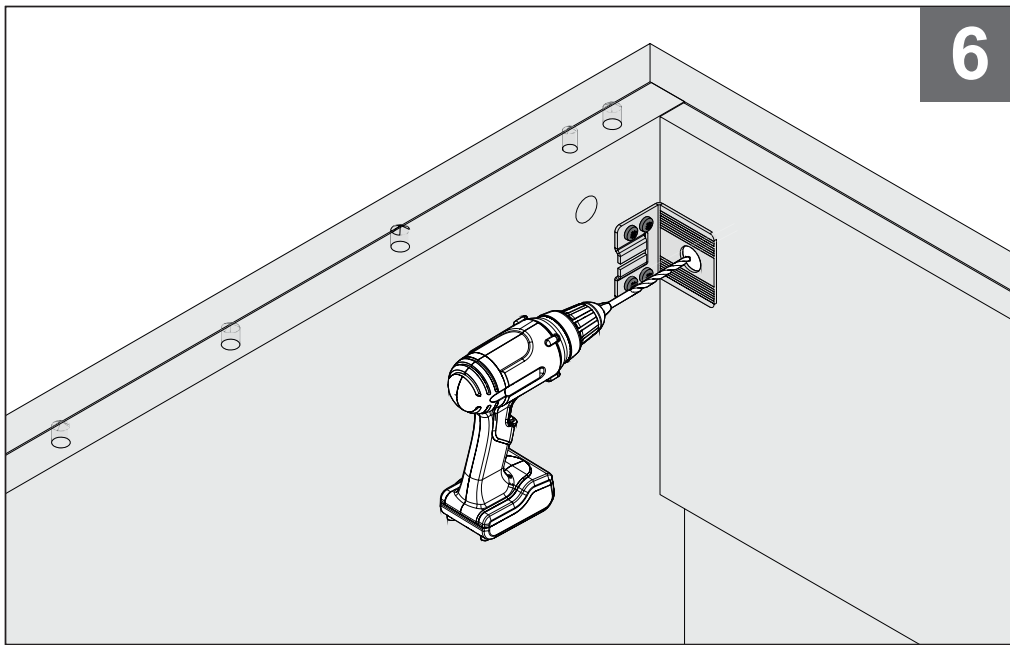

IT-Fissaggio base a parete
 EN-Fixing base unit to wall
 FR-Fixation de base au mur

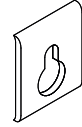

Ex2

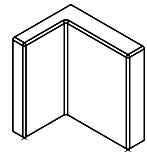

Fx2

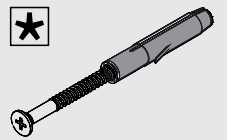
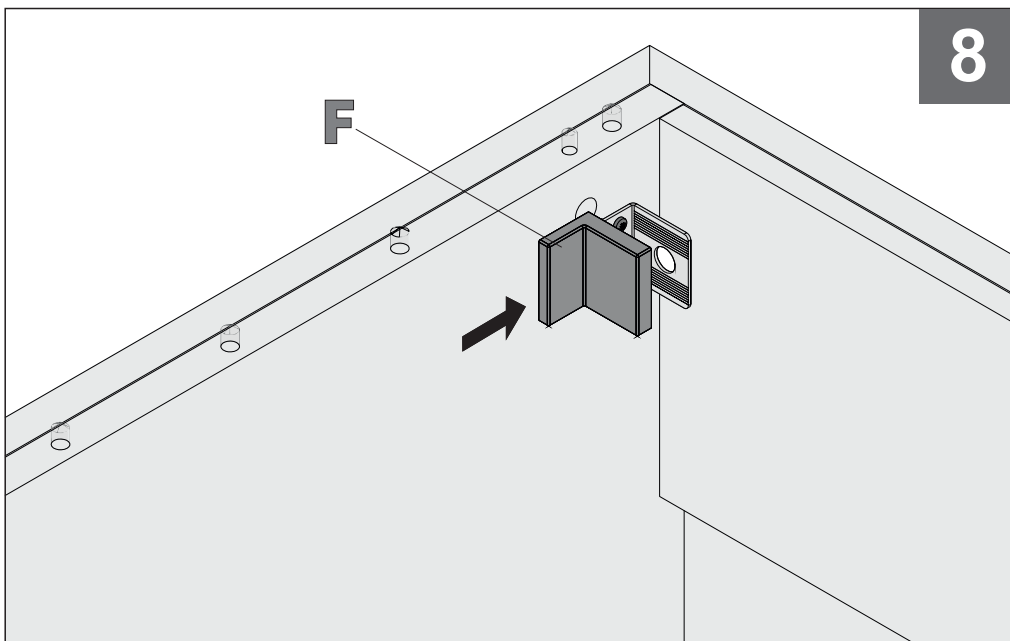
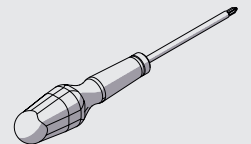
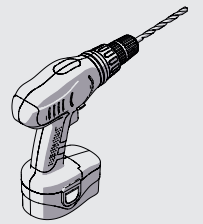
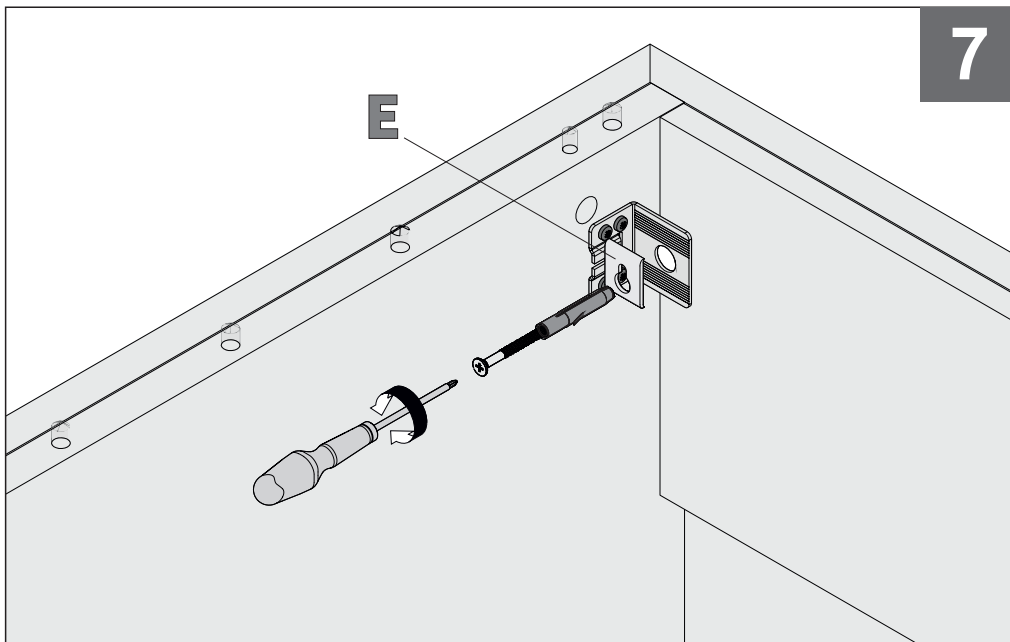

86670391

86670392

86670375

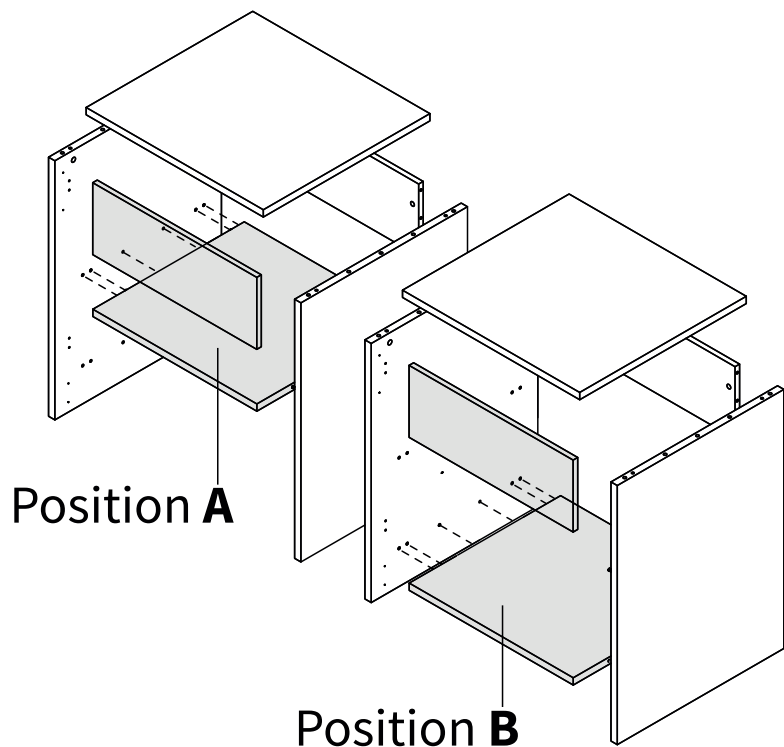

IT-Al fine di evitare il ribaltamento del mobile è obbligatorio il fissaggio dello stesso a parete tramite le apposite attaccaglie.

* Viti e tasselli (non inclusi) devono essere adeguati al tipo di materiale della vostra parete
EN-In order to avoid the furniture overturning, you have absolutely fix it to the wall through the appropriate attachments

* Screws and dowels (not included) must be suitable to the type of material of your wall
FR-Pour éviter tout risque de basculement, le meuble doit être absolument fixé au mur à l'aide des supports de fixation fournis

* Utiliser des vis et chevilles (non fournies) adaptées au type de matériaux de votre mur

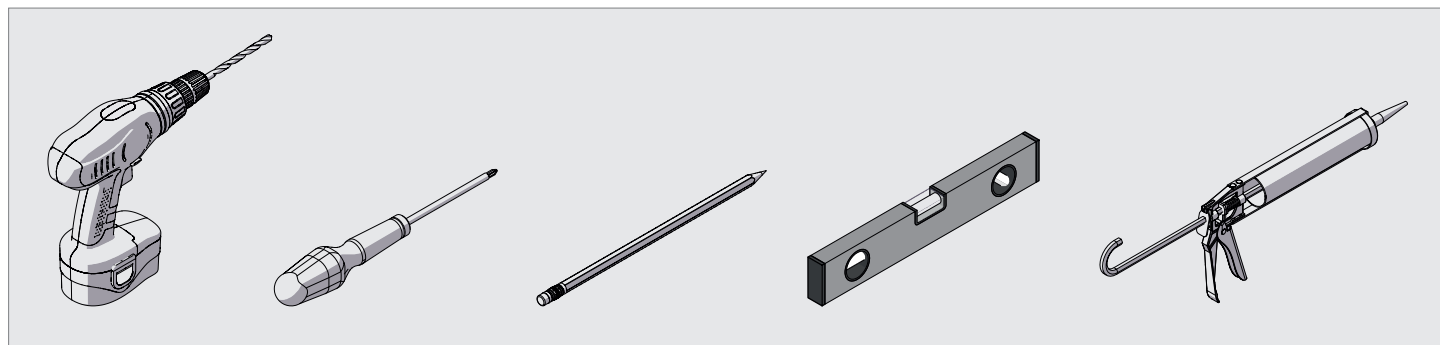
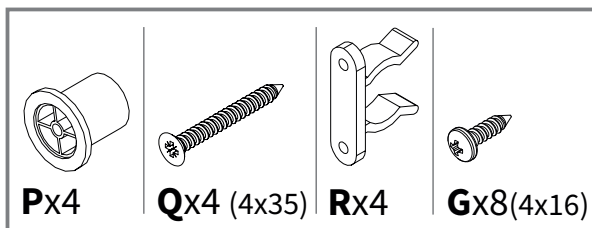
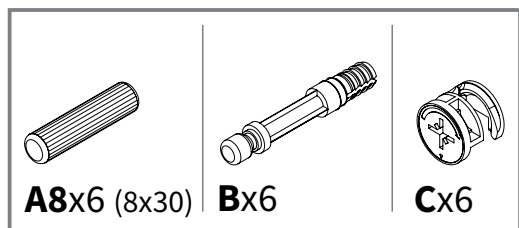

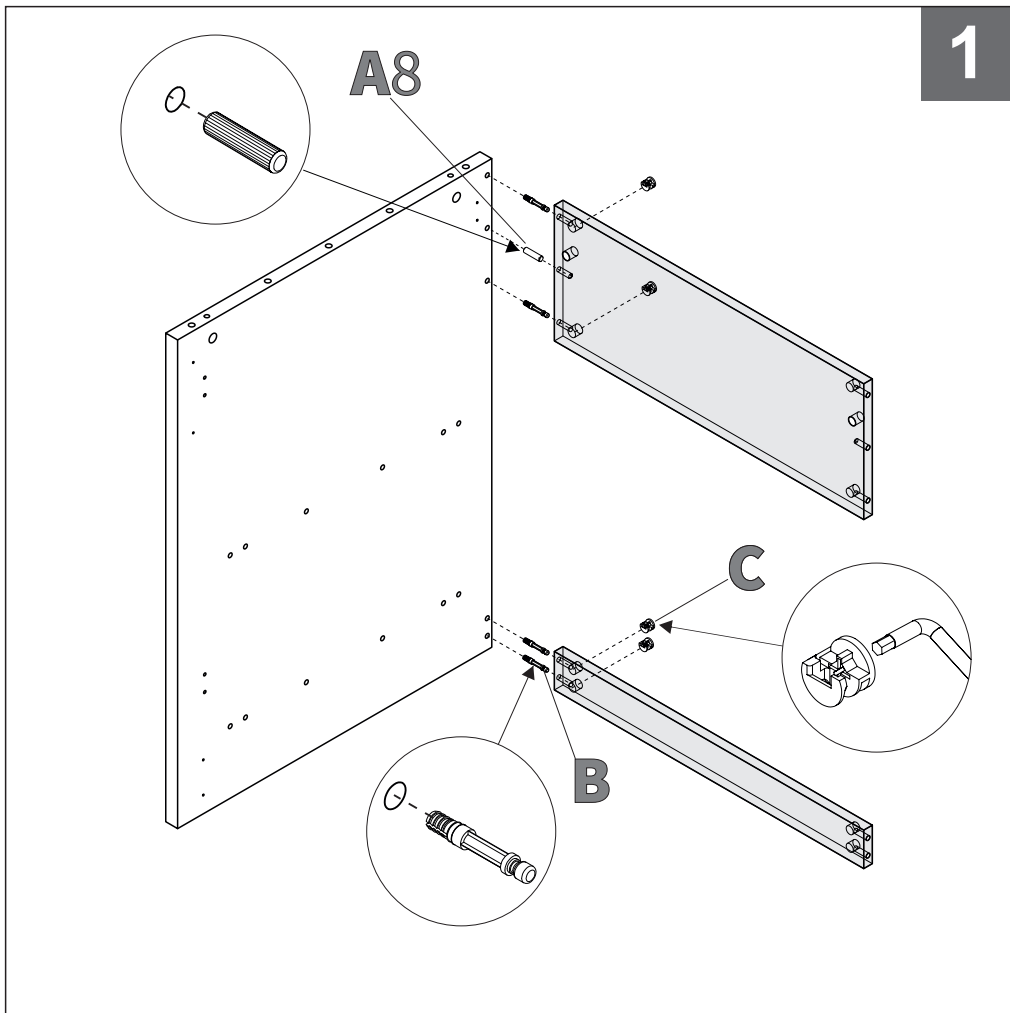

IT-Assemblaggio elementi base
 EN-Assembly base units elements
 FR-Assemblage des éléments de bases

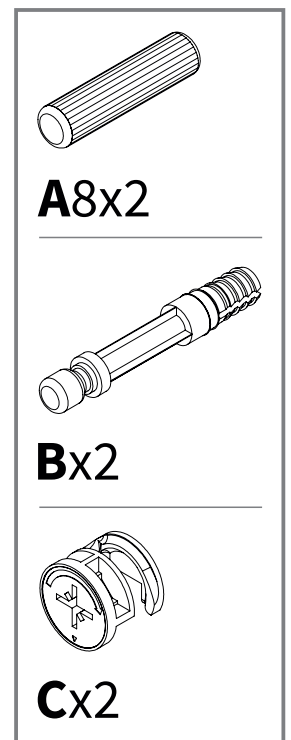
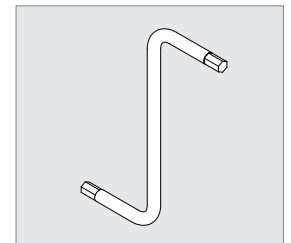
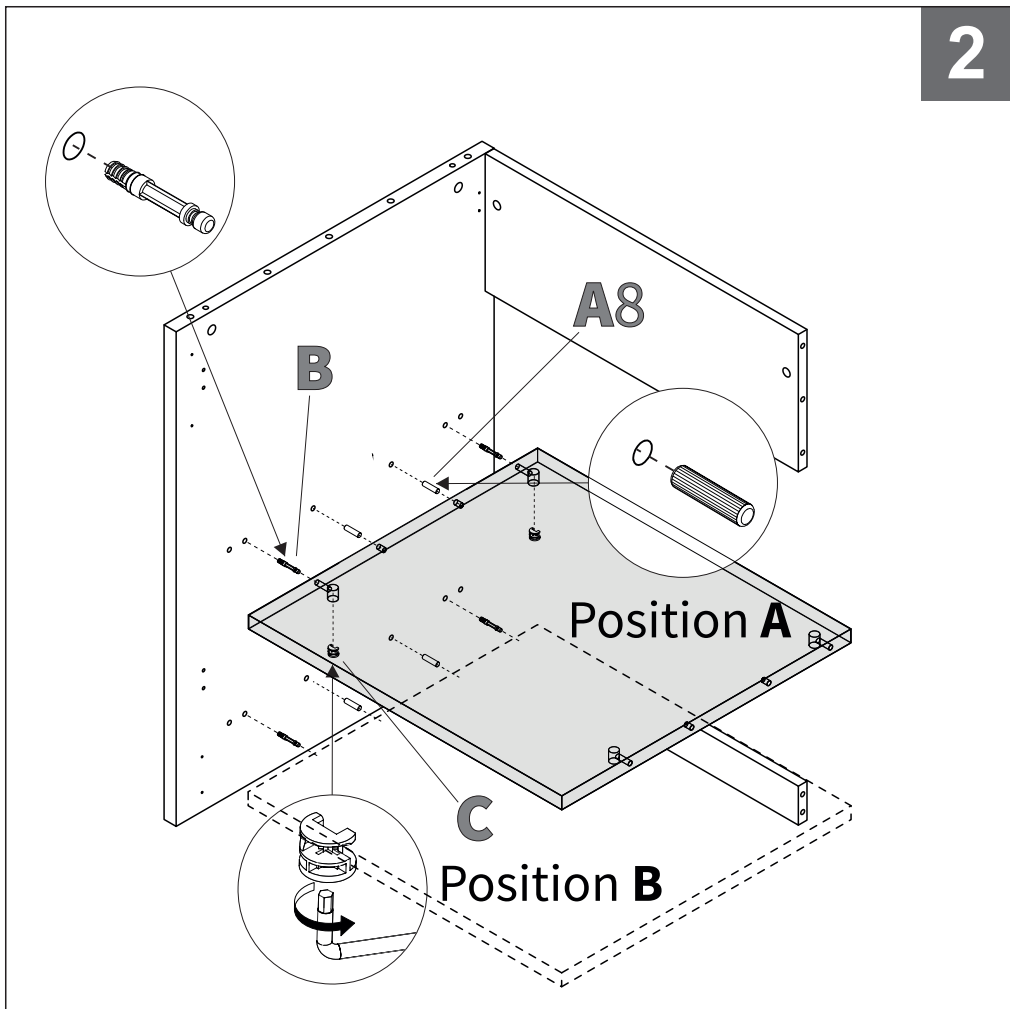
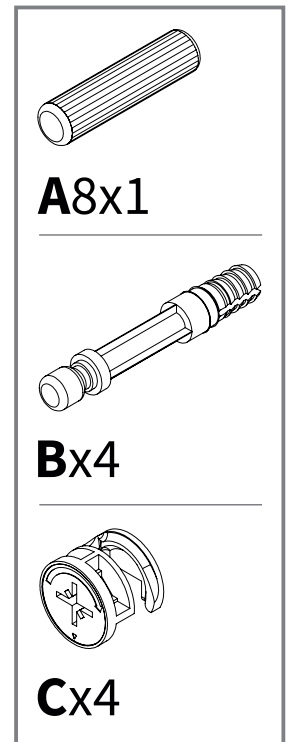

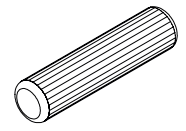
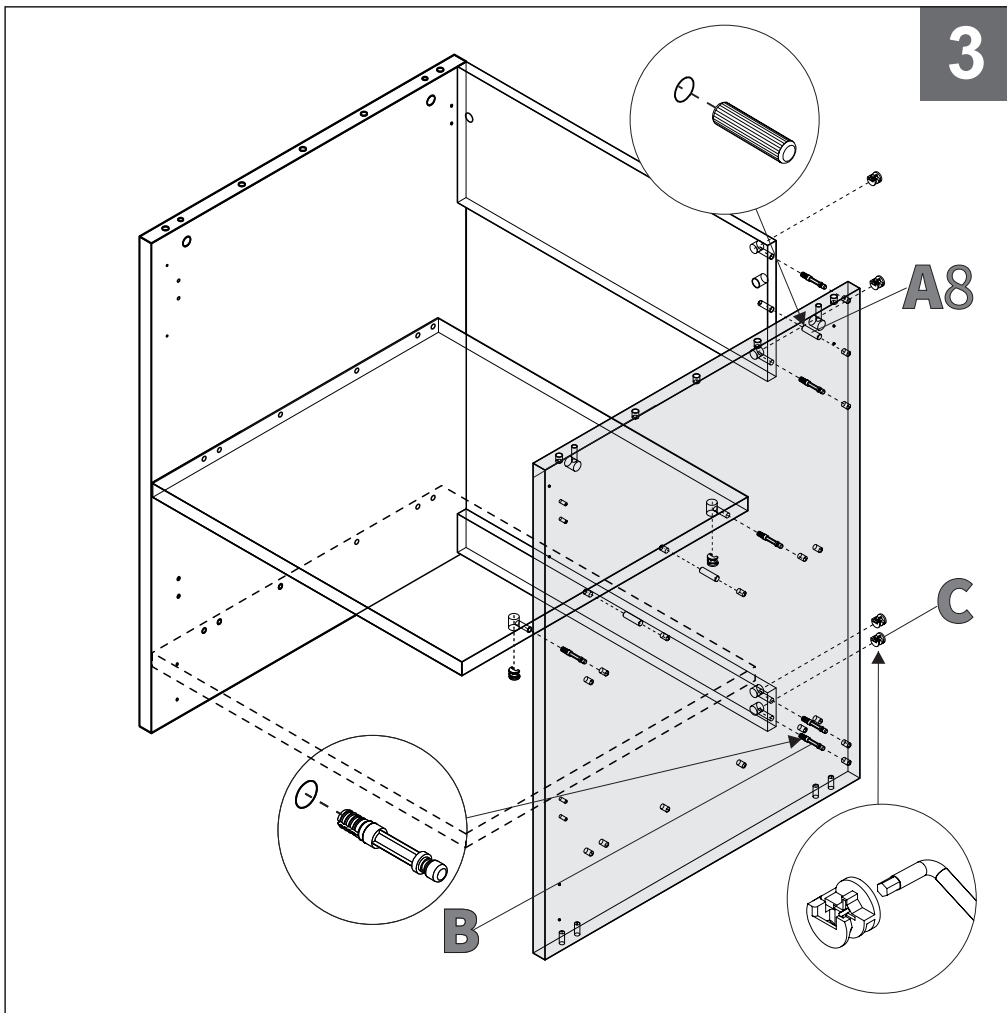

A8x3

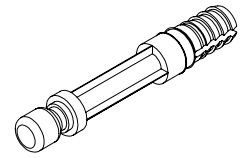

Bx6

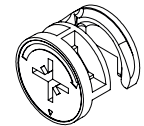

Cx6

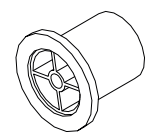
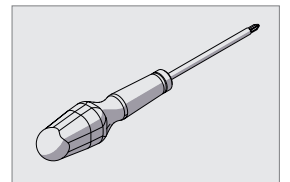
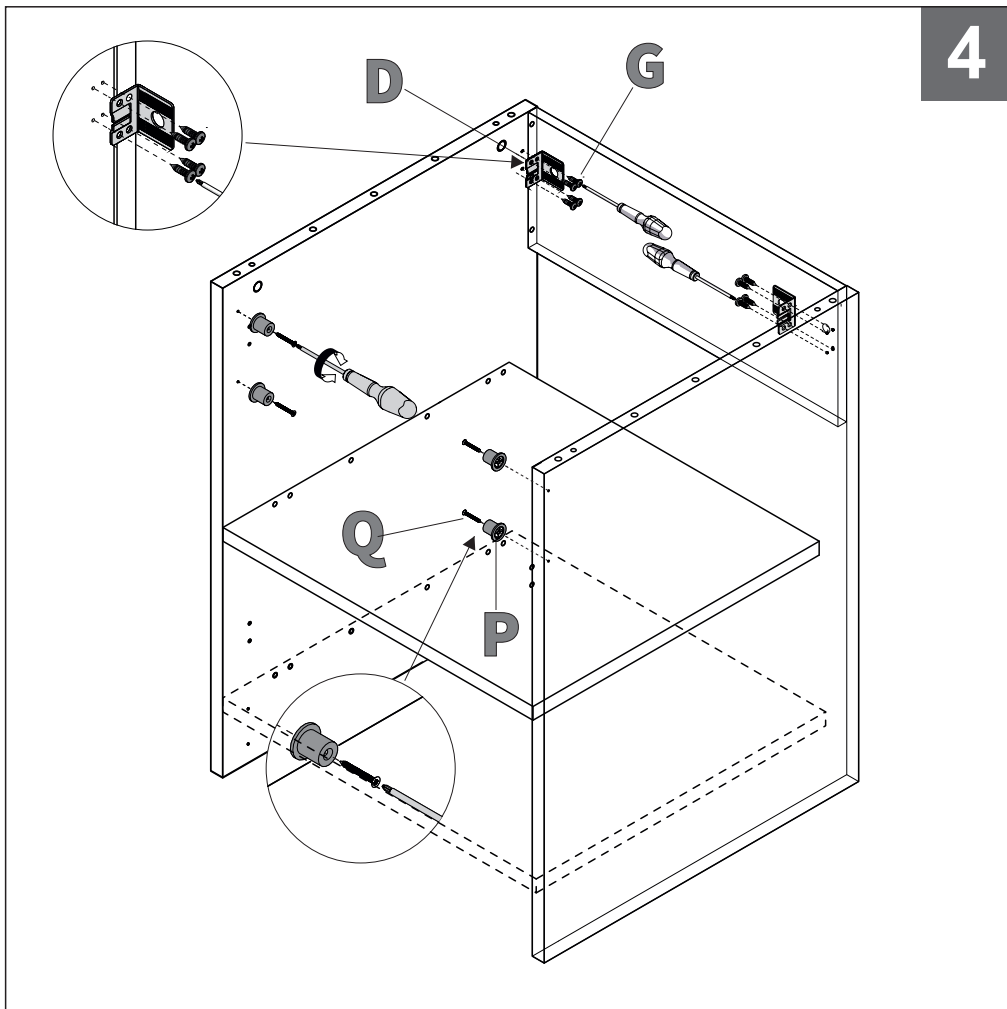
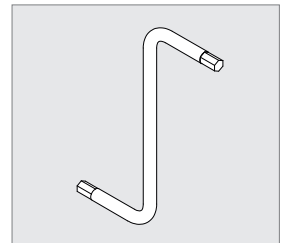

Px4

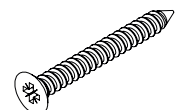

Qx4

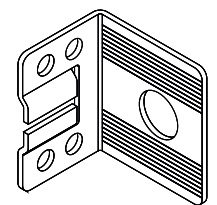

Dx2



Gx8

5

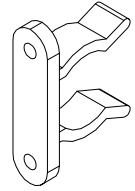
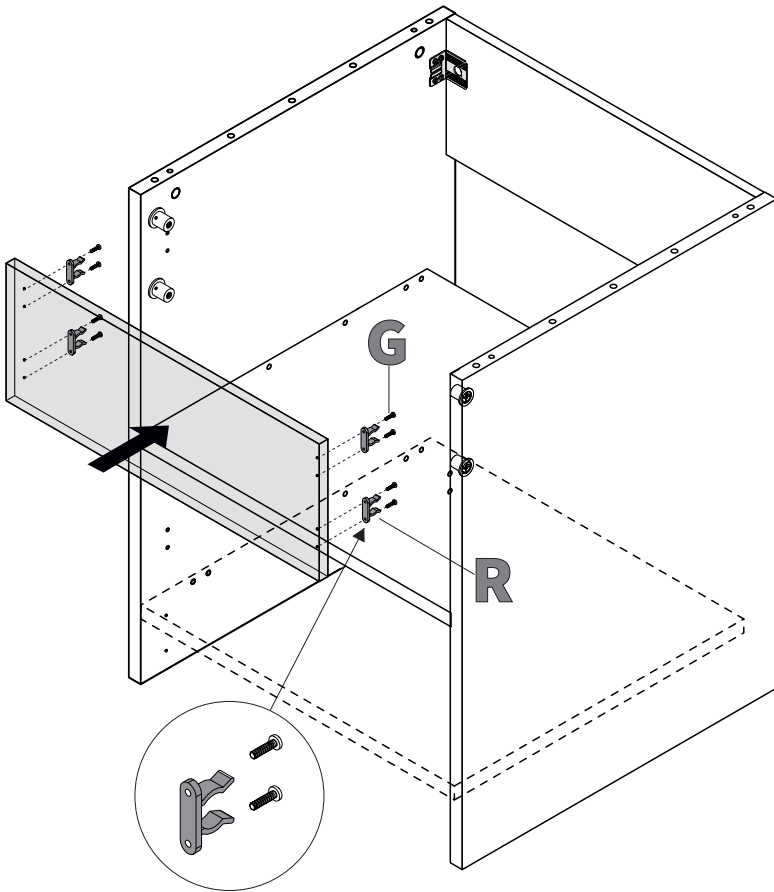

Rx4



Gx8

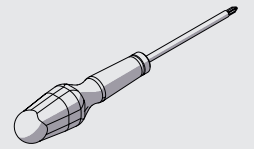

6

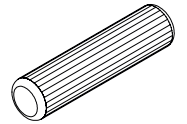
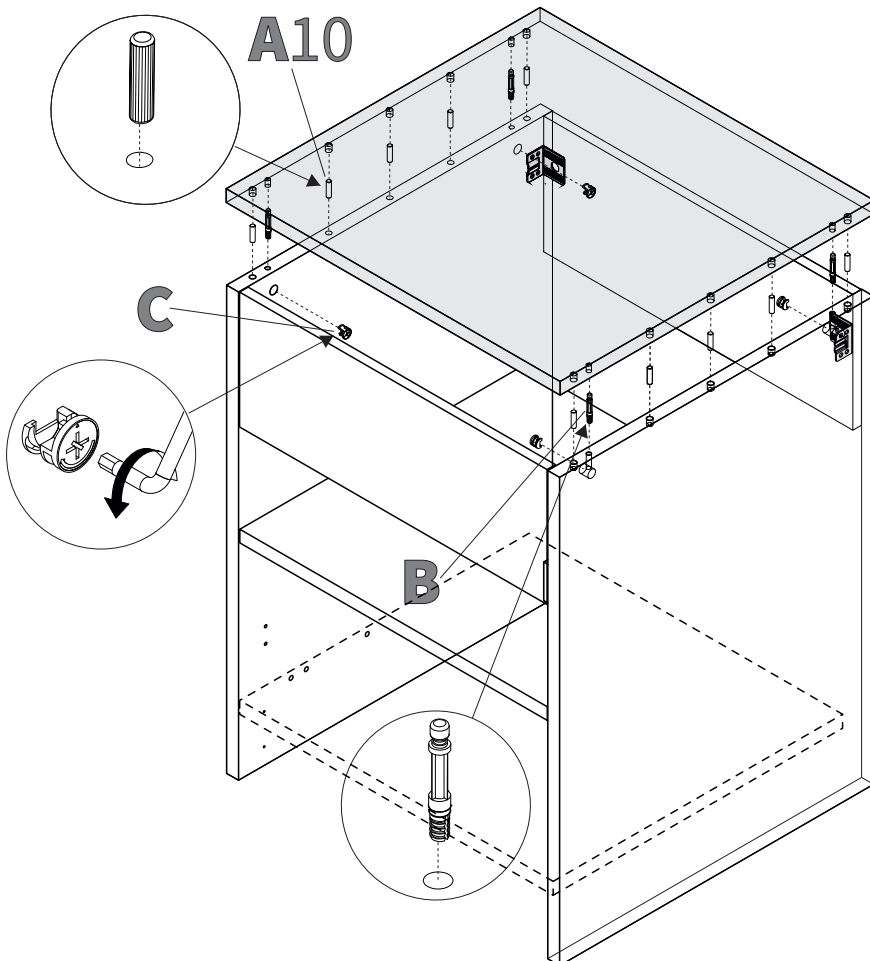

A10x10

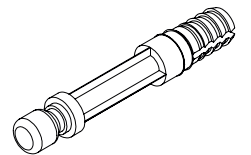

Bx4

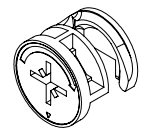

Cx4

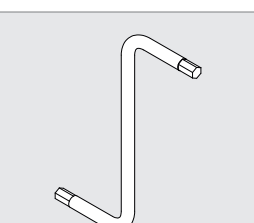

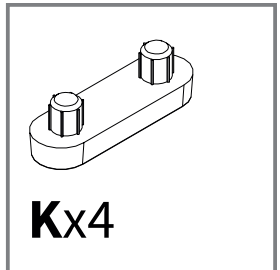
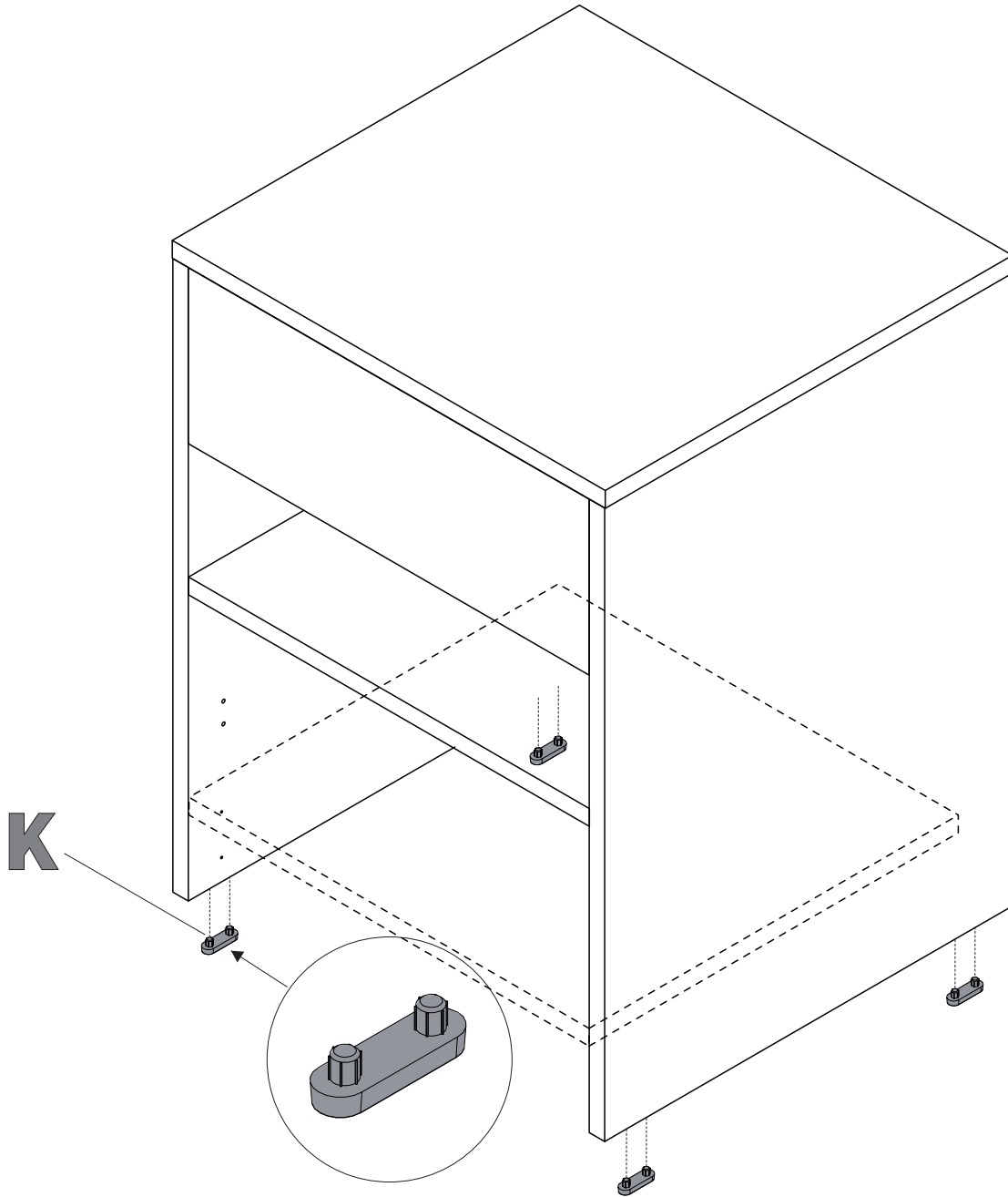

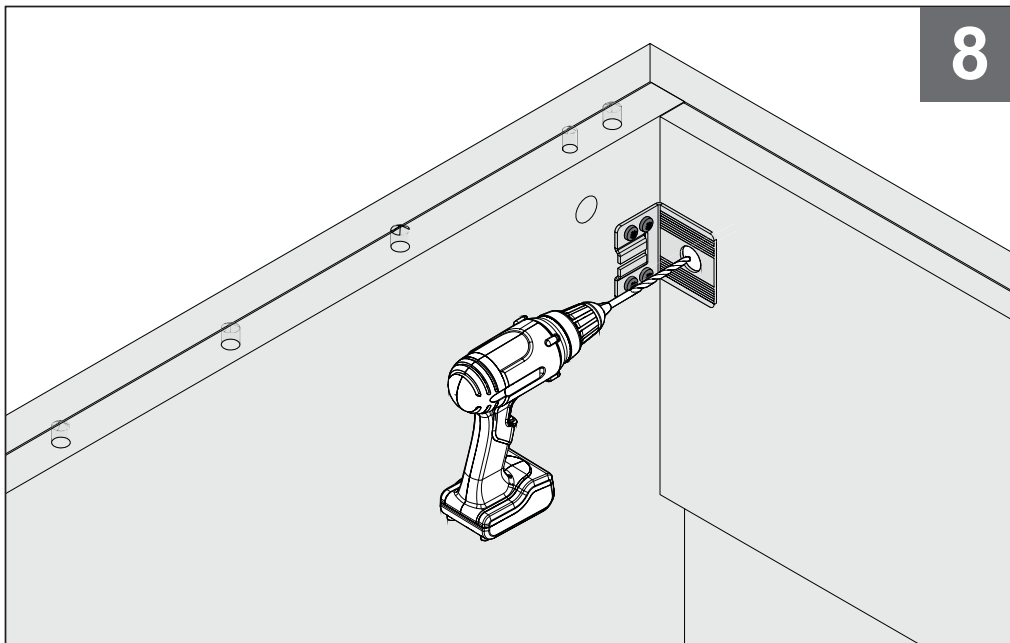

IT-Fissaggio base a parete
 EN-Fixing base unit to wall
 FR-Fixation de base au mur

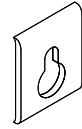

Ex2

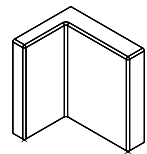

Fx2

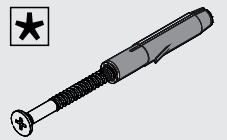
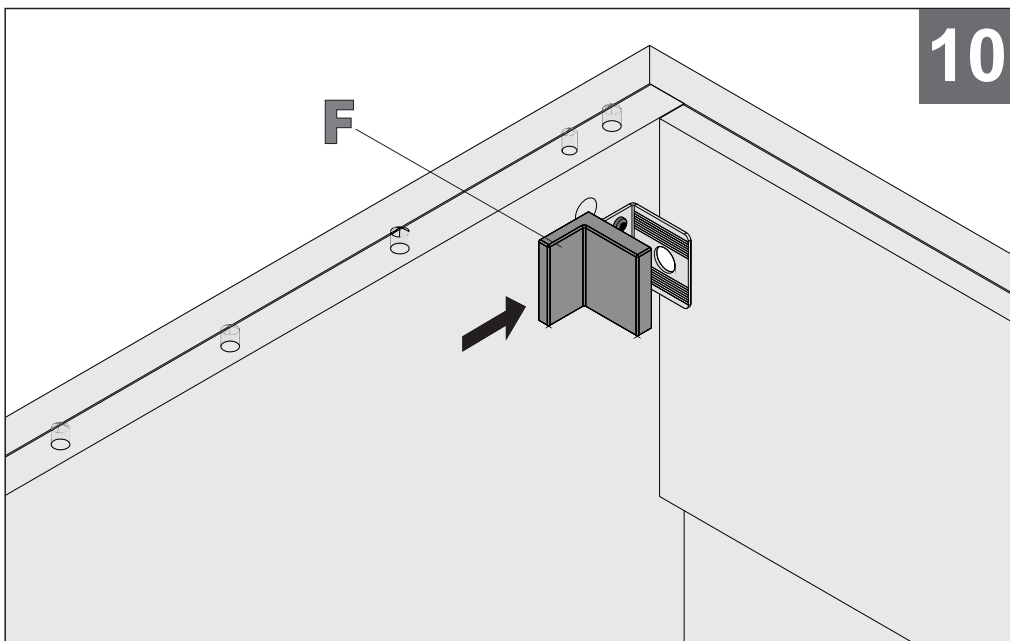
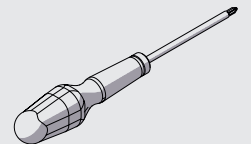
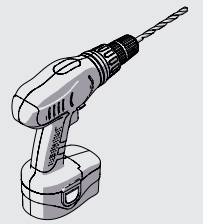
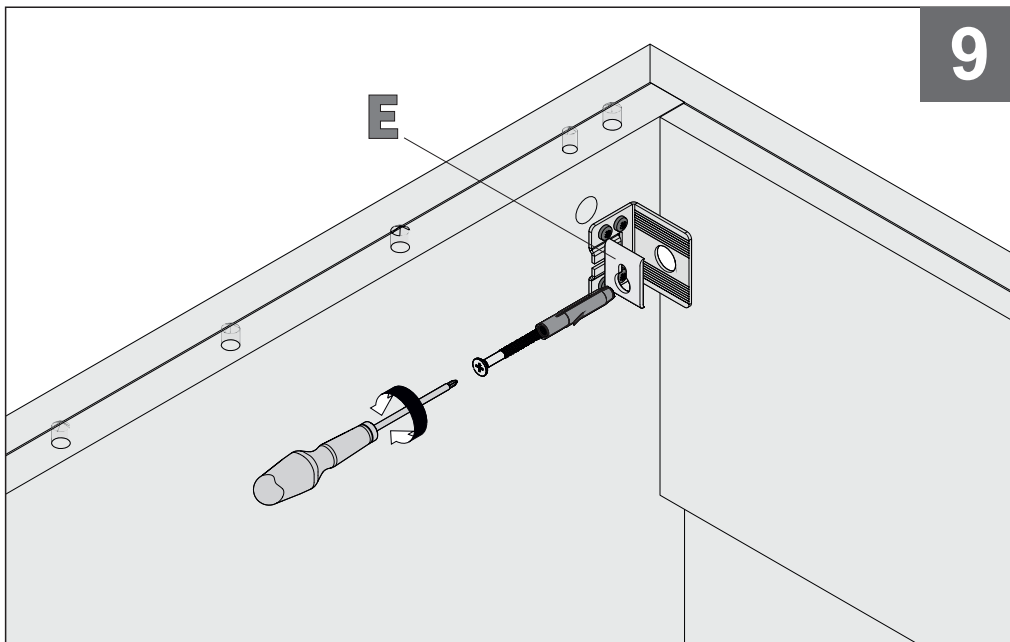

86670376

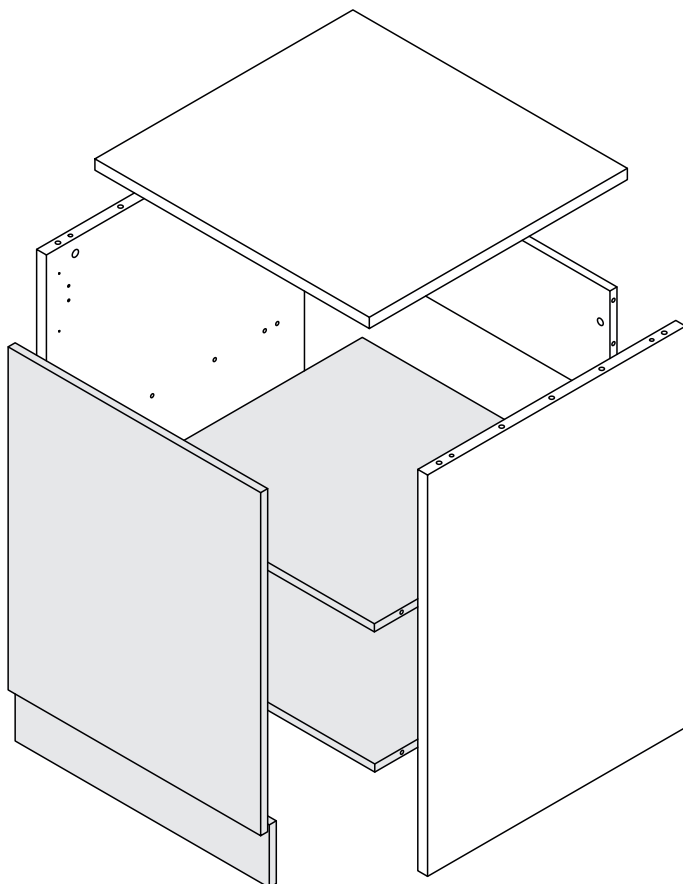

IT-Al fine di evitare il ribaltamento del mobile è obbligatorio il fissaggio dello stesso a parete tramite le apposite attaccaglie.

* Viti e tasselli (non inclusi) devono essere adeguati al tipo di materiale della vostra parete

EN-In order to avoid the furniture overturning, you have absolutely fix it to the wall through the appropriate attachments

* Screws and dowels (not included) must be suitable to the type of material of your wall

FR-Pour éviter tout risque de basculement, le meuble doit être absolument fixé au mur à l'aide des supports de fixation fournis

* Utiliser des vis et chevilles (non fournies) adaptées au type de matériaux de votre mur

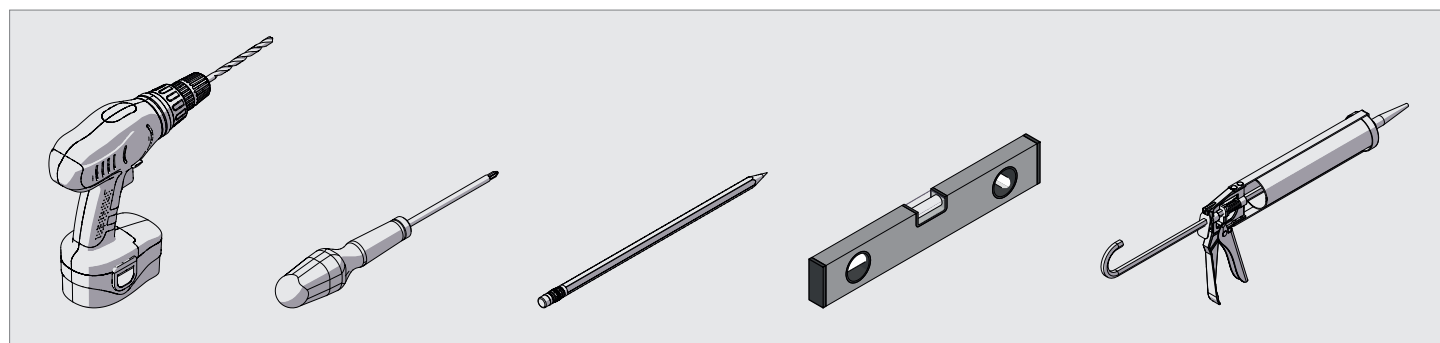
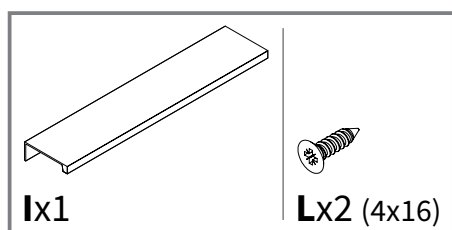
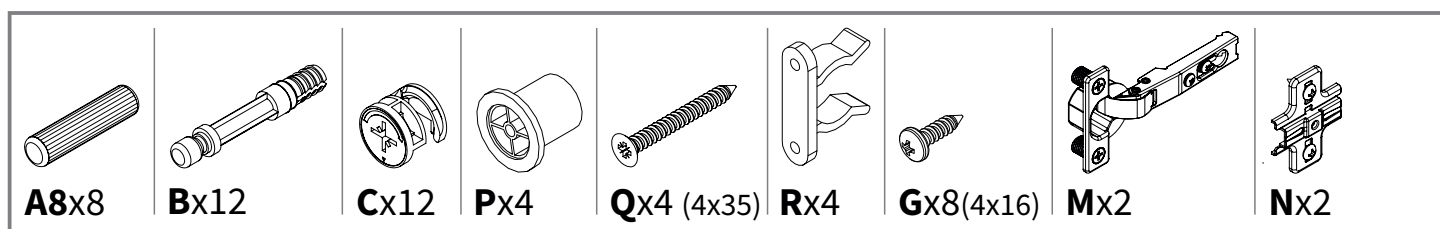

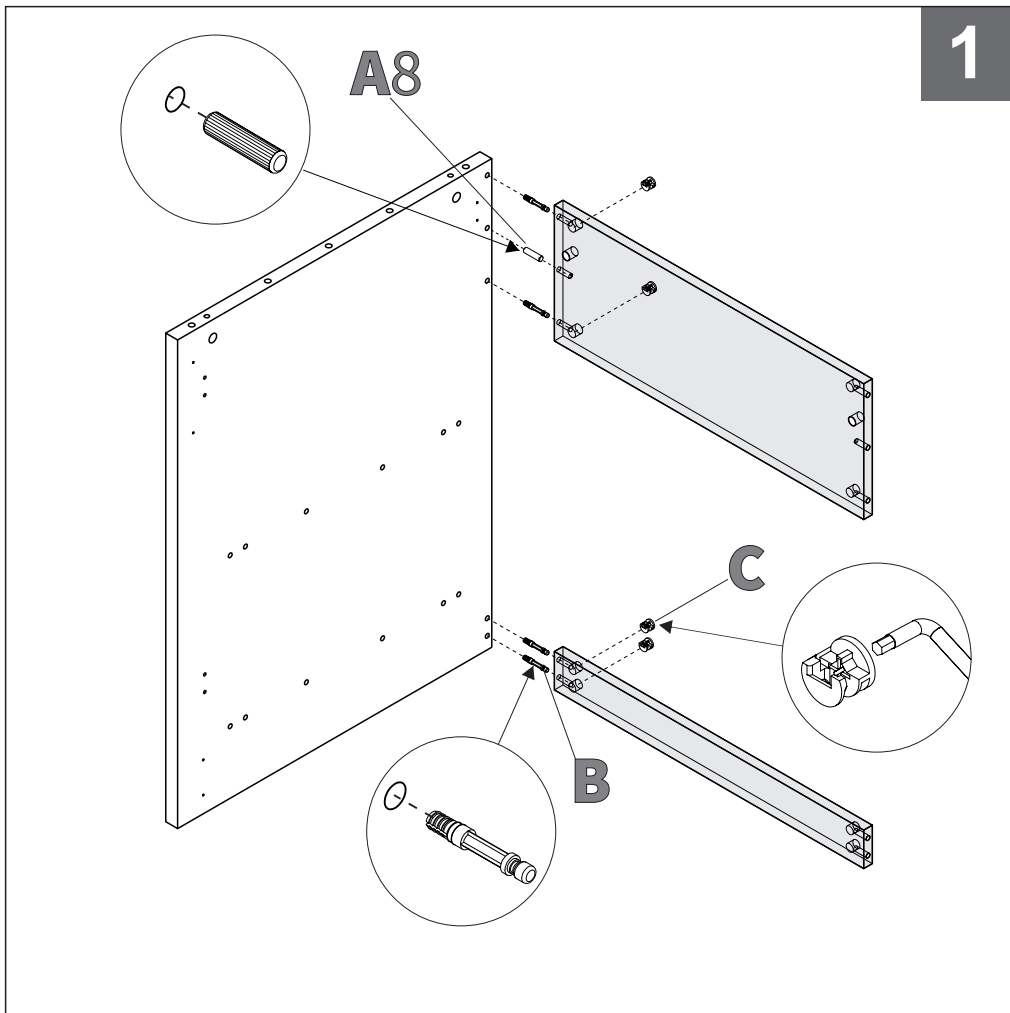

IT-Assemblaggio elementi base
 EN-Assembly base units elements
 FR-Assemblage des éléments de bases

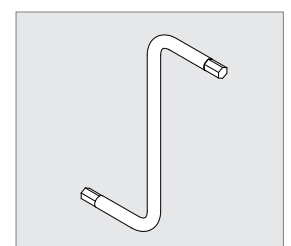
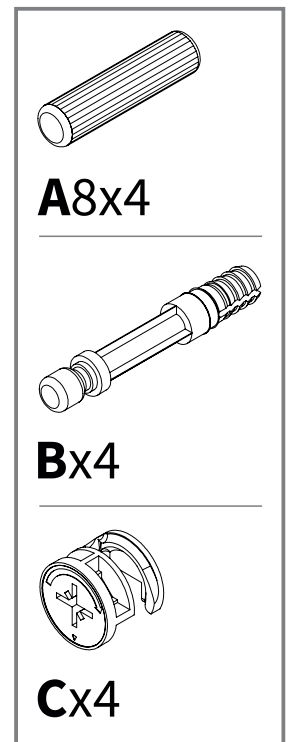
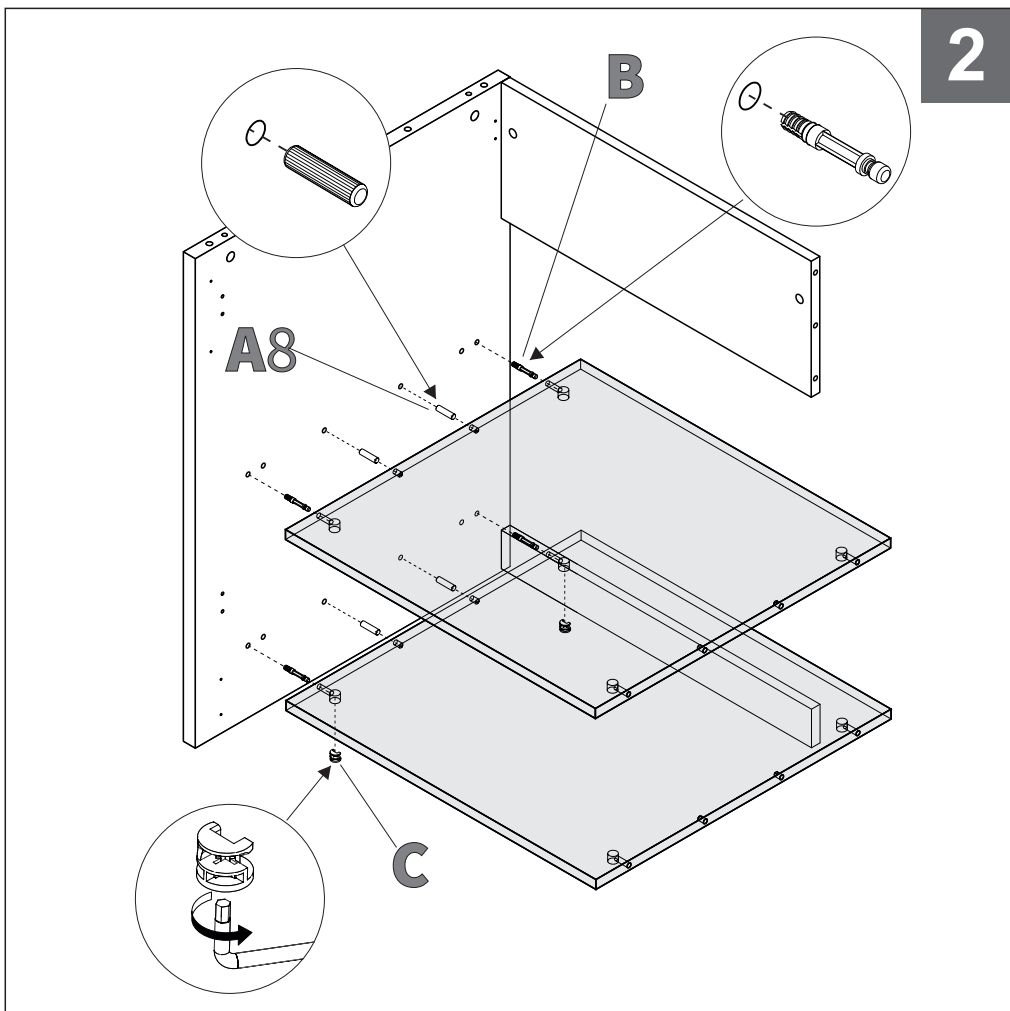
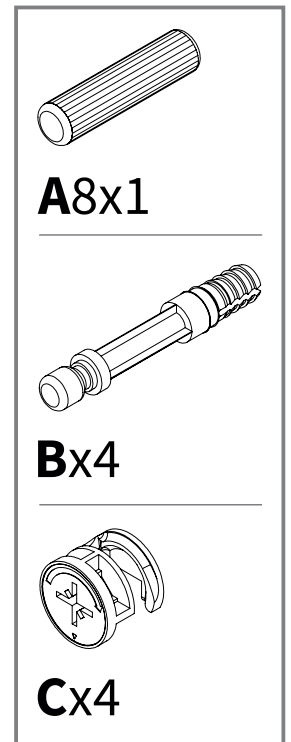

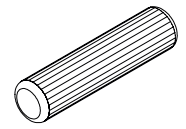
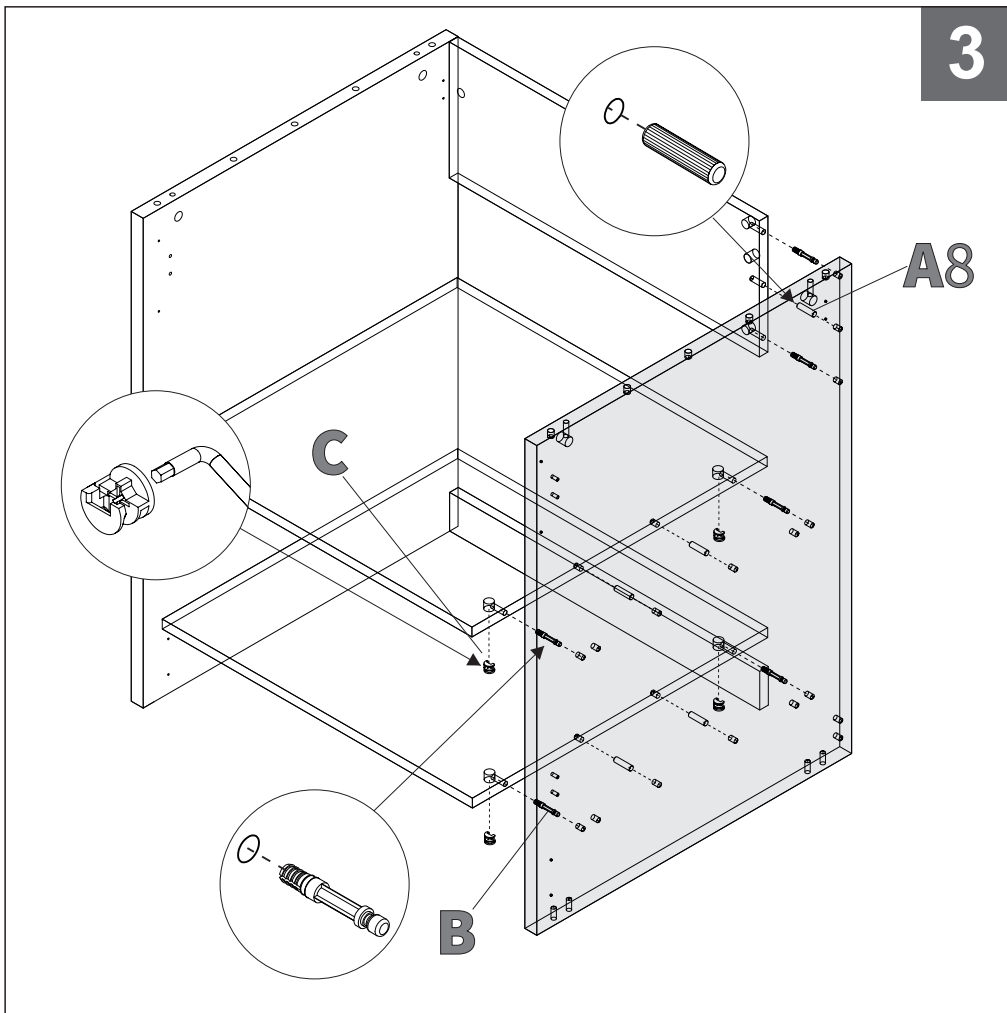

A8x5

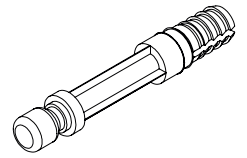

Bx6

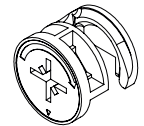

Cx6

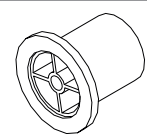
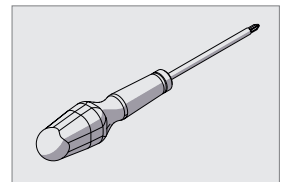
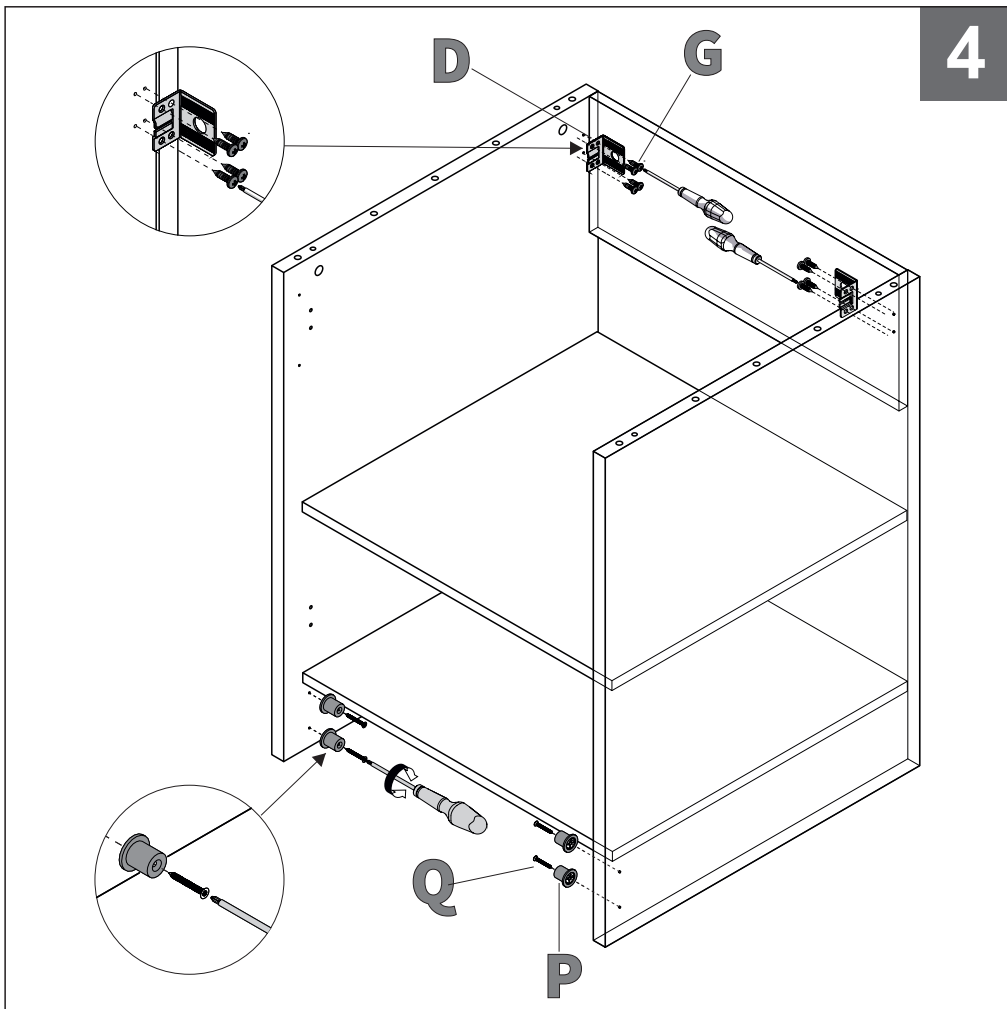
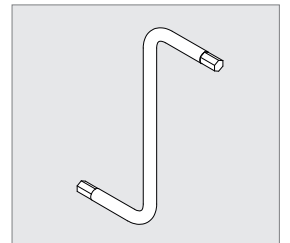

Px4

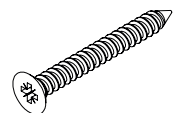

Qx4

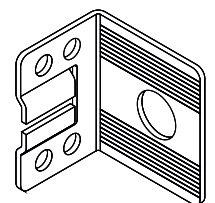

Dx2



Gx8

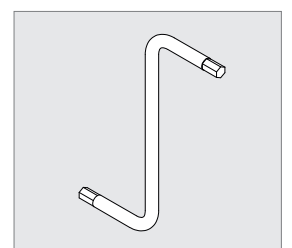
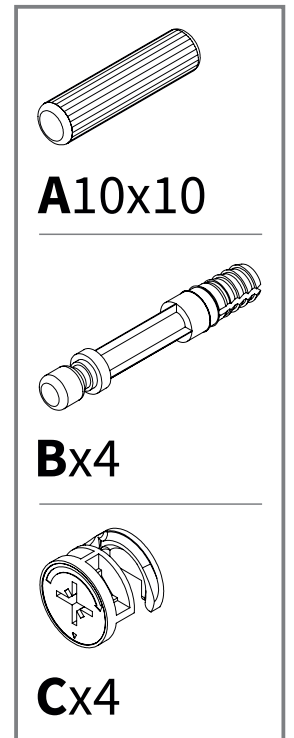
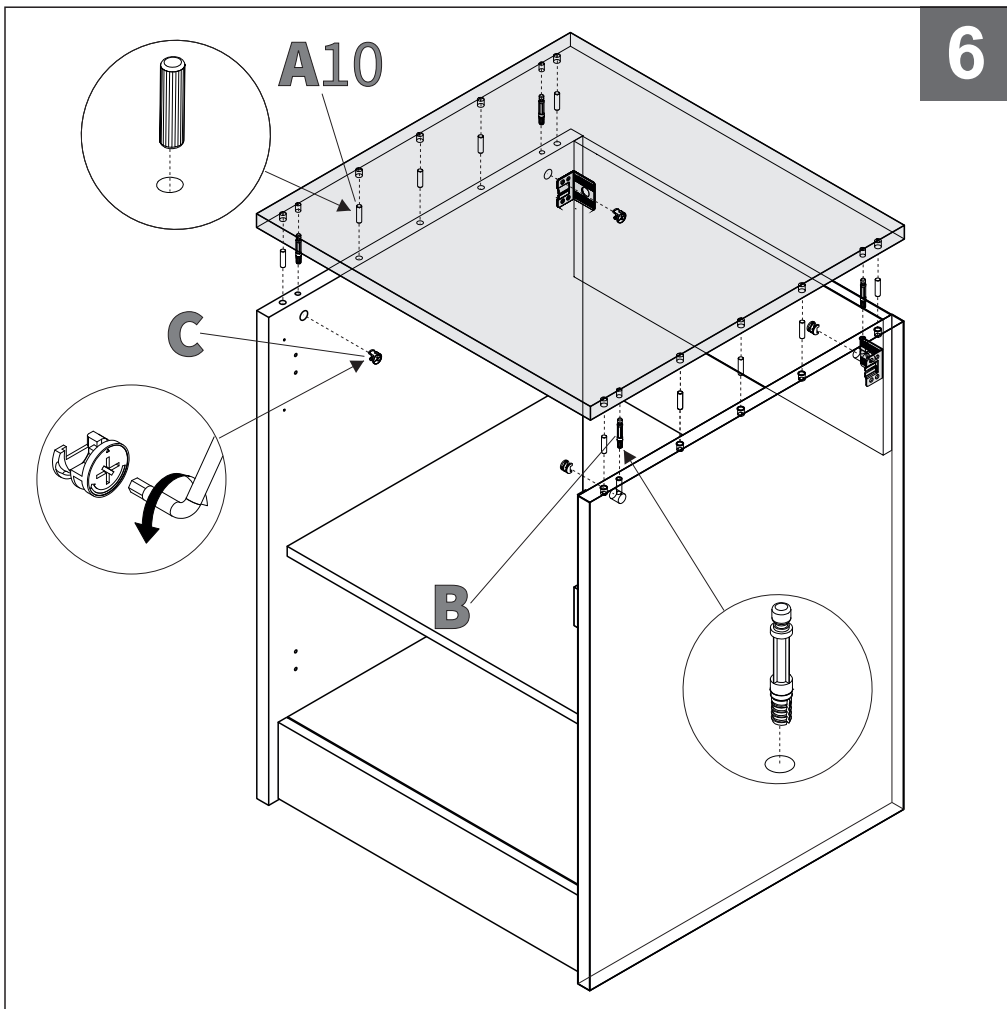
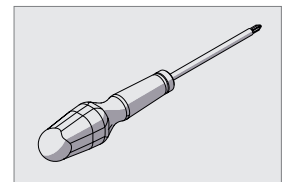
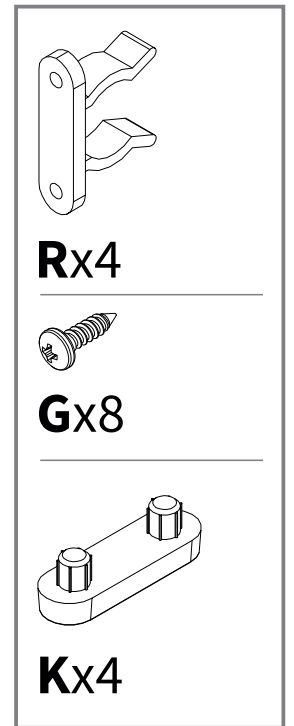
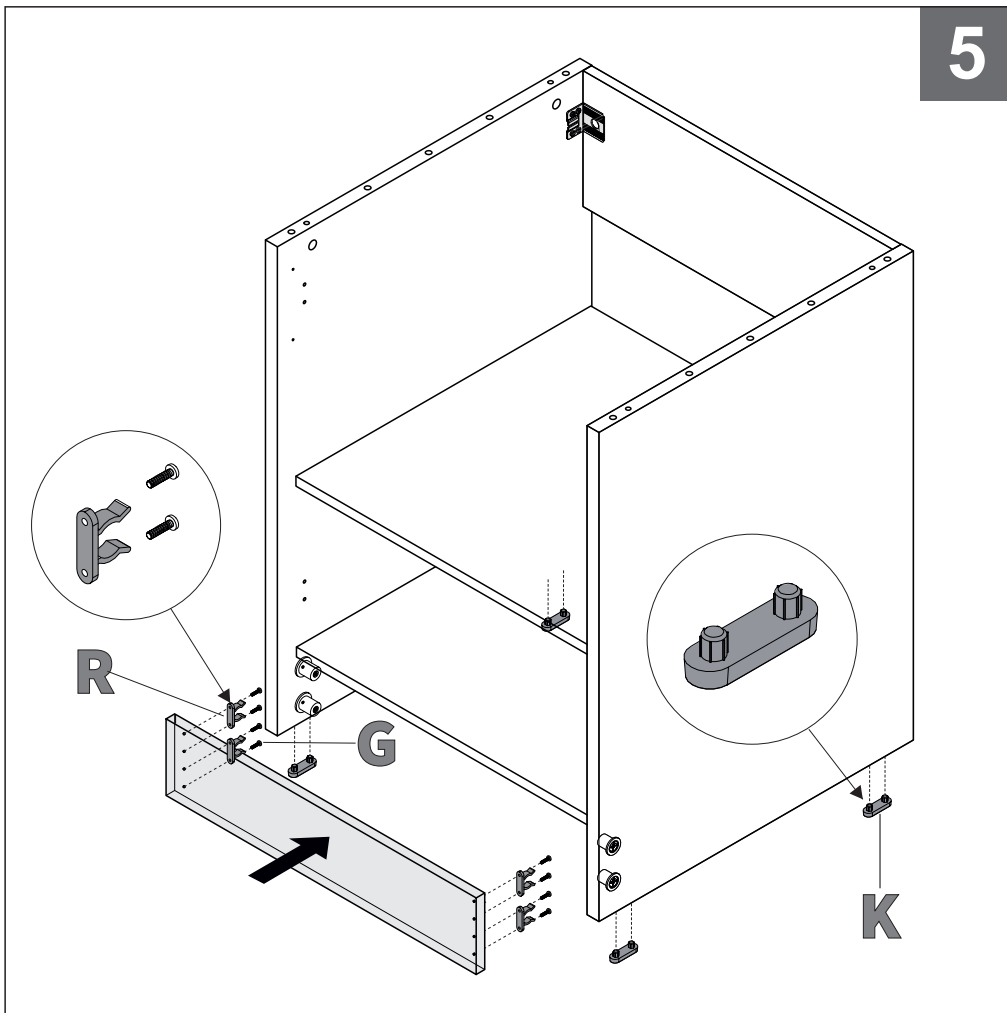

7

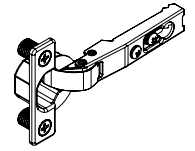
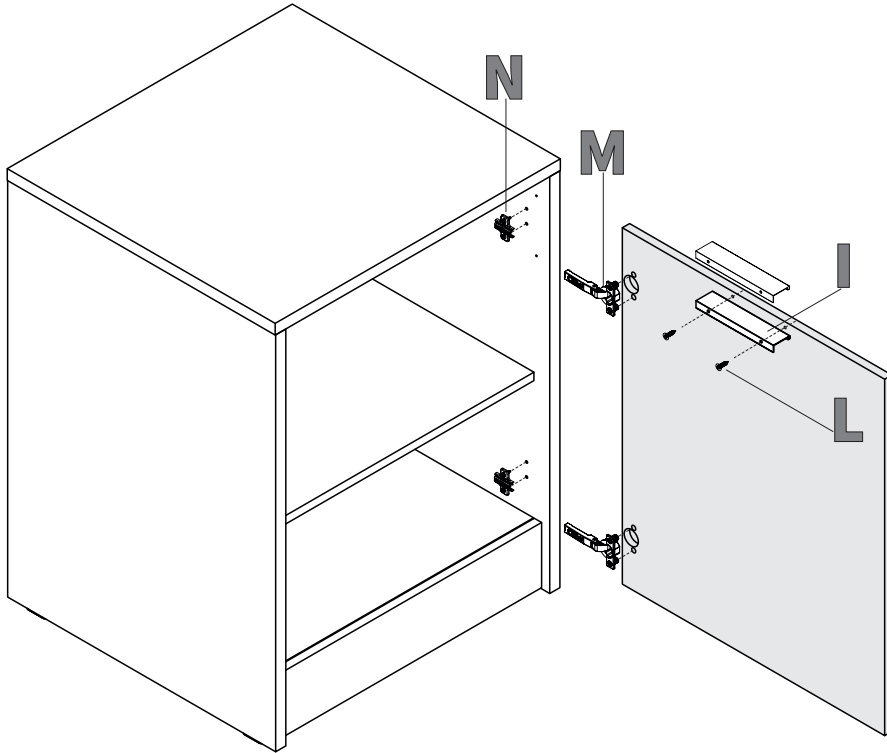

Mx2

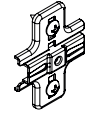

Nx2

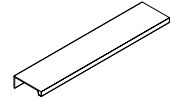

Ix1



Lx2

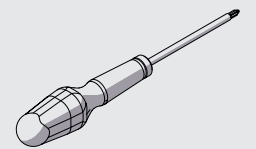

IT-Montaggio anta dx /EN- Door assembly rh/FR-Montage de porte dr

8

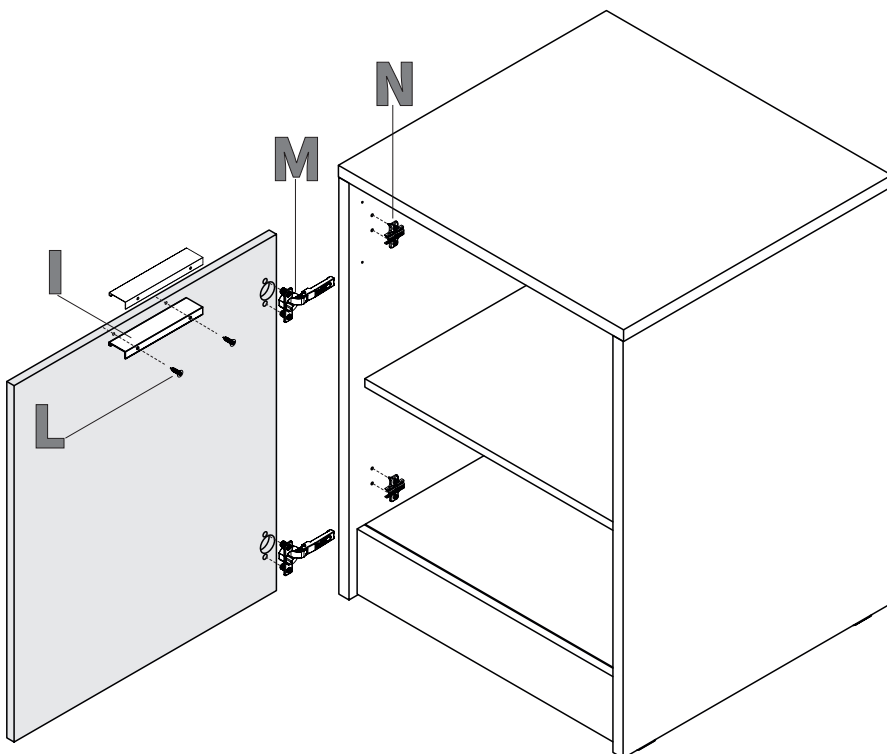

IT-Montaggio anta sx /EN- Door assembly lh/FR-Montage de porte gh

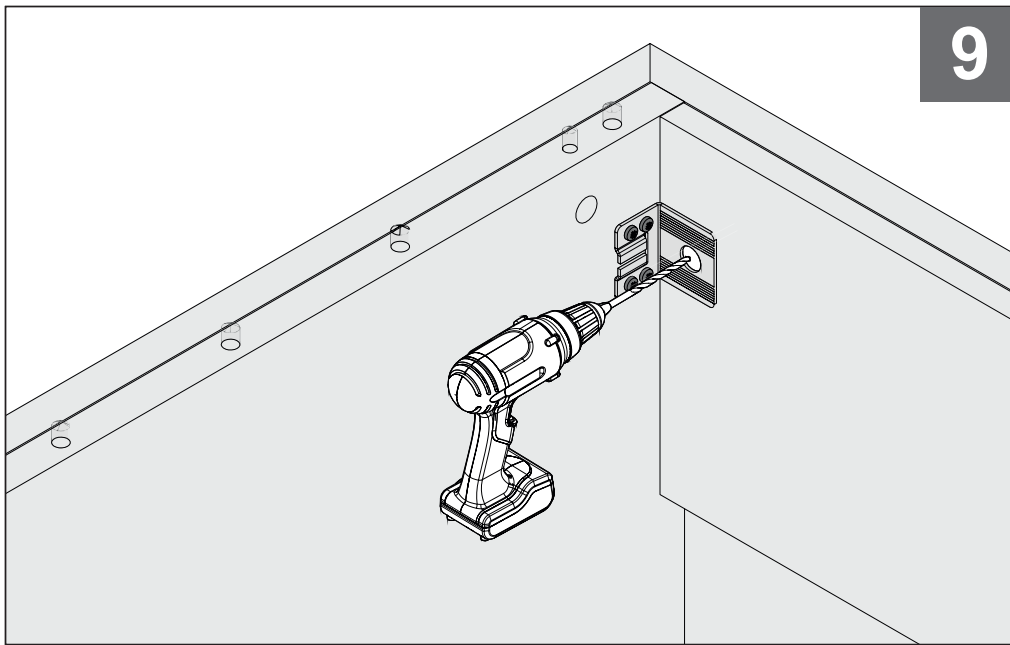

9

IT-Fissaggio base a parete
 EN-Fixing base unit to wall
 FR-Fixation de base au mur

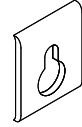

Ex2

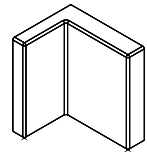

Fx2

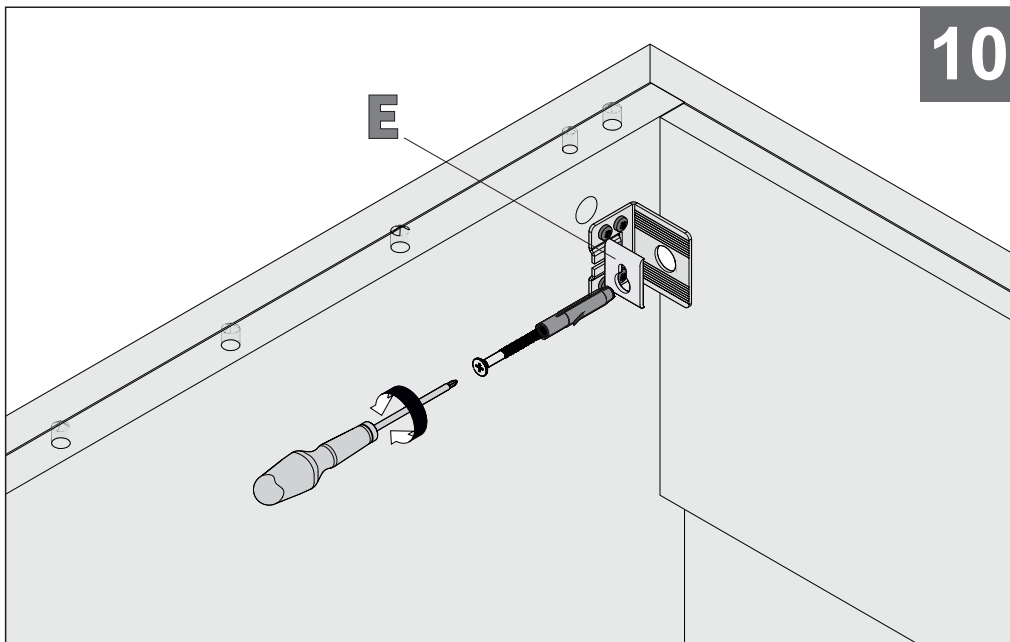

10

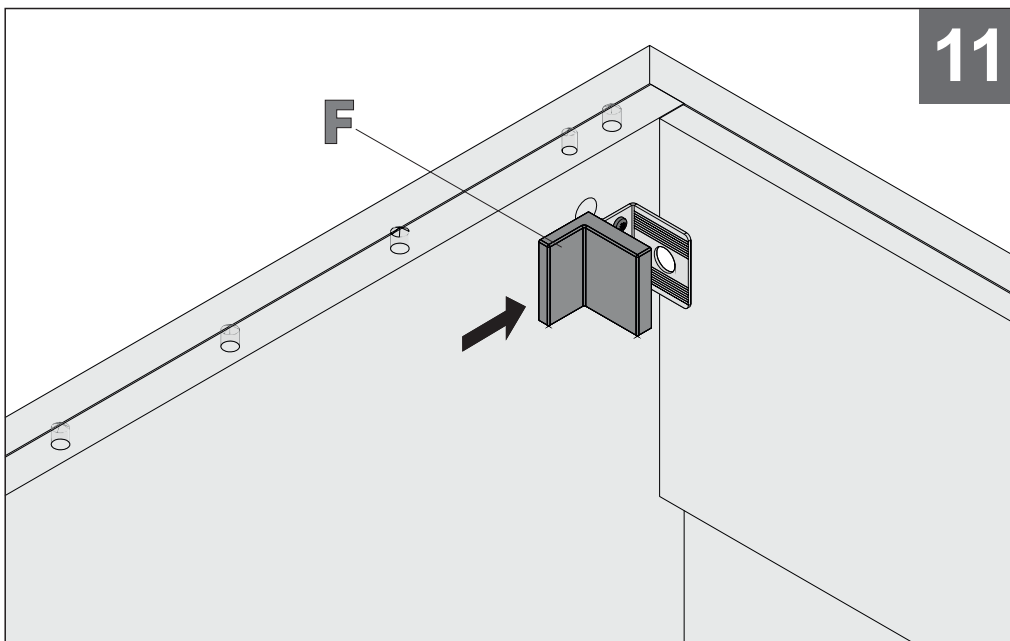
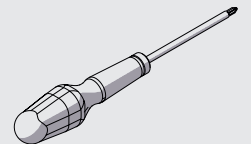
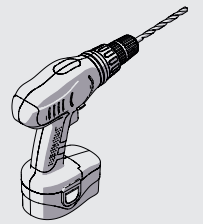

11

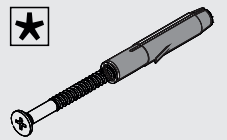

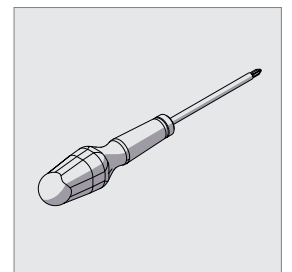
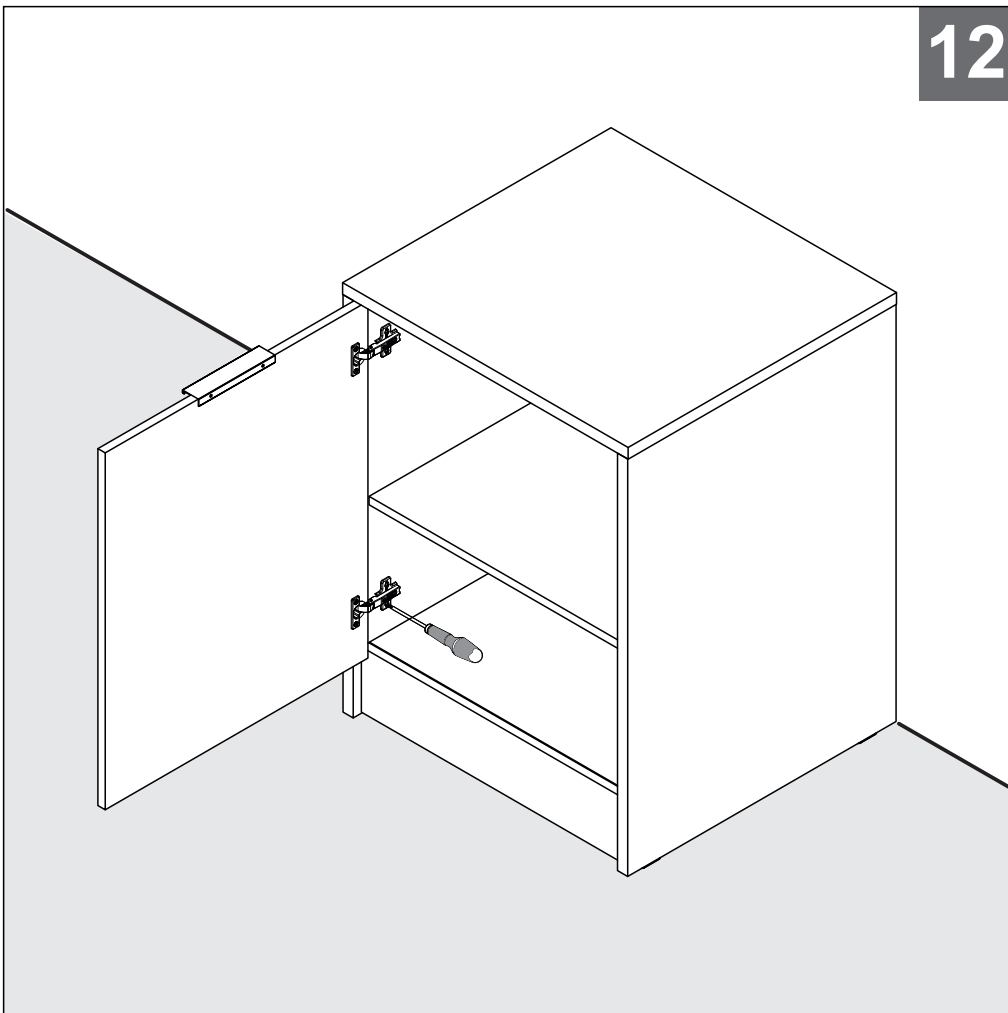

IT-Regolazione laterale
 EN-Lateral adjustment
 FR-Réglage latéral

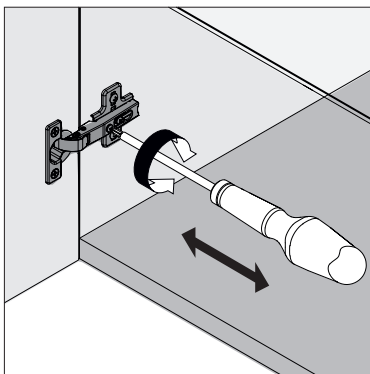

+5mm.

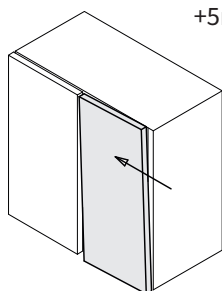

IT-Regolazione altezza
 EN-Vertical adjustment
 FR-Réglage en hauteur

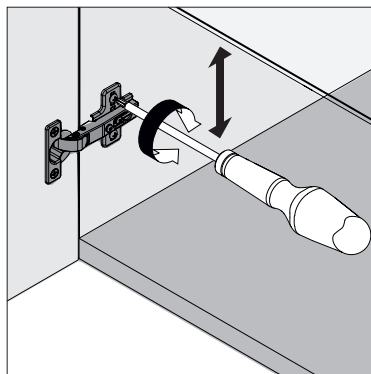

↑+2mm.
 ↓-2mm.

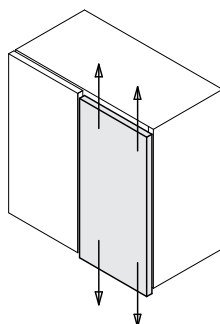

IT-Regolazione dell'inclinazione
 EN-Inclination adjustment
 FR-Réglage de l'inclinaison

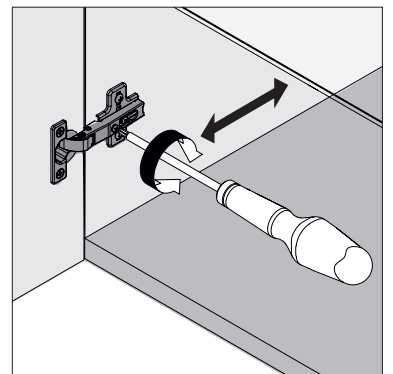

+2.8mm.

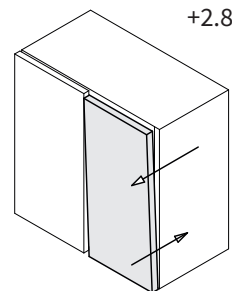

86670395

86670396

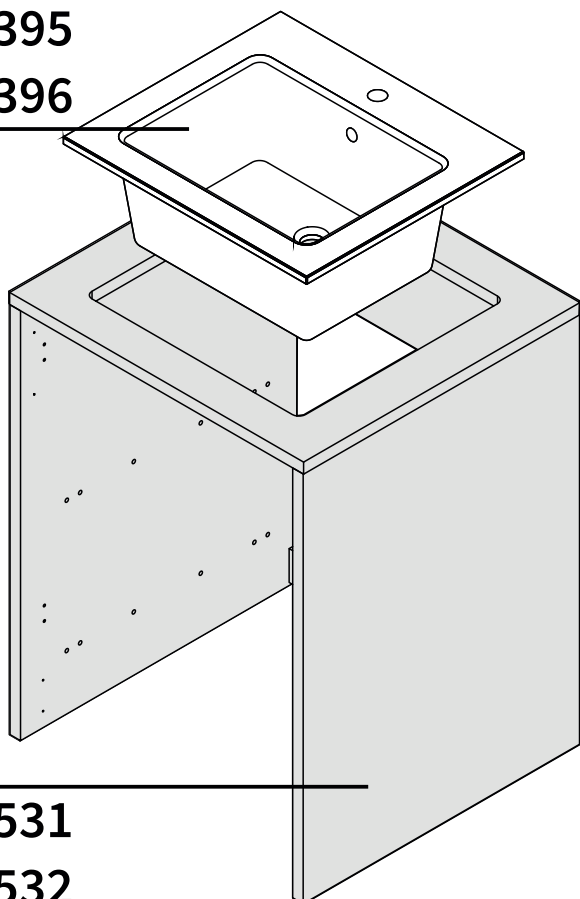

87675531

87675532

IT-Al fine di evitare il ribaltamento del mobile è obbligatorio il fissaggio dello stesso a parete tramite le apposite attaccaglie.

* Viti e tasselli (non inclusi) devono essere adeguati al tipo di materiale della vostra parete
EN-In order to avoid the furniture overturning, you have absolutely fix it to the wall through the appropriate attachments

* Screws and dowels (not included) must be suitable to the type of material of your wall
FR-Pour éviter tout risque de basculement, le meuble doit être absolument fixé au mur à l'aide des supports de fixation fournis

* Utiliser des vis et chevilles (non fournies) adaptées au type de matériaux de votre mur

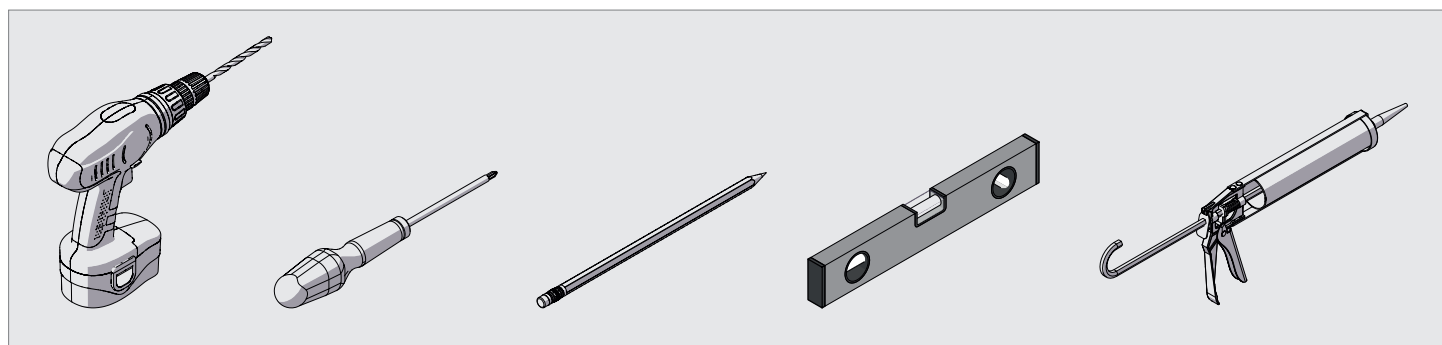

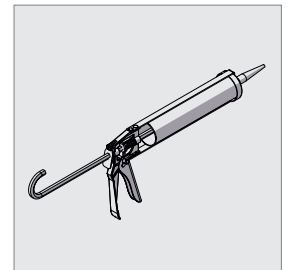
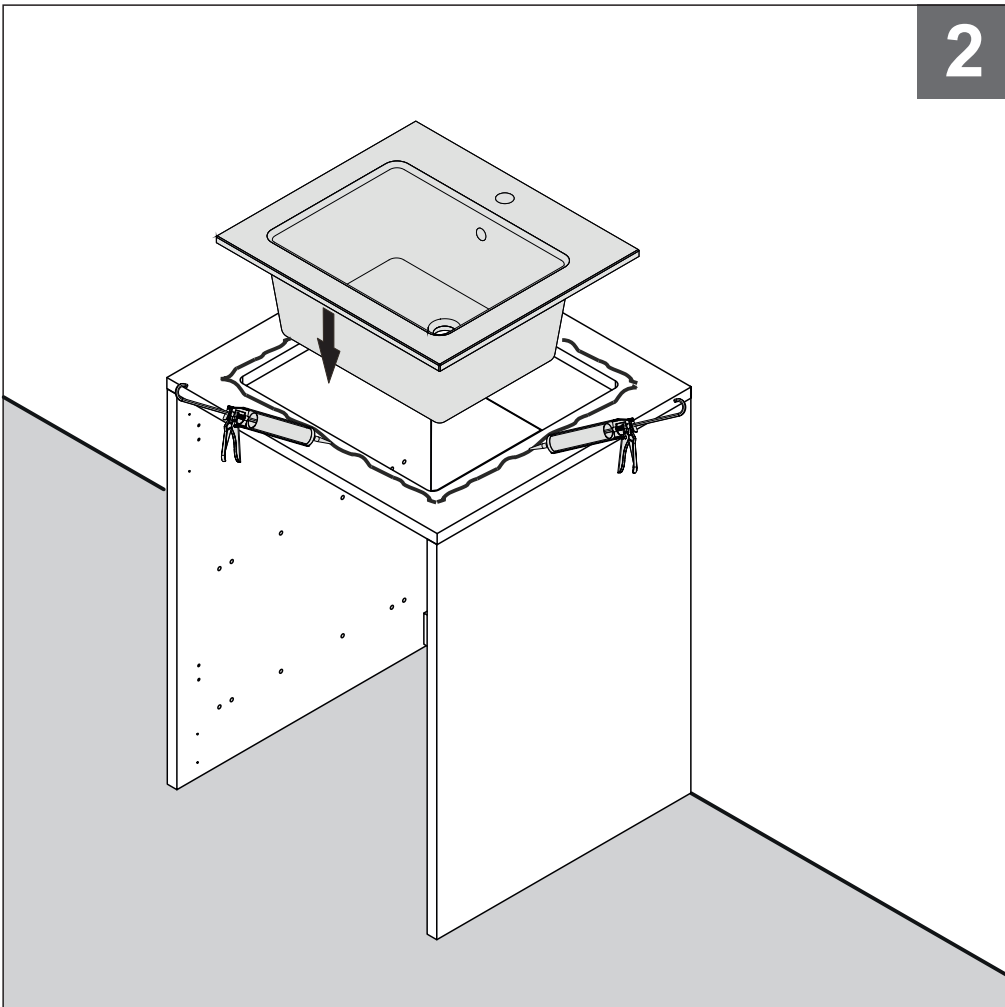
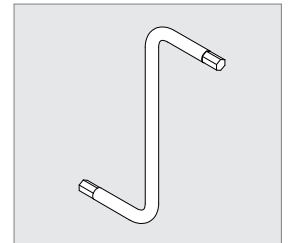
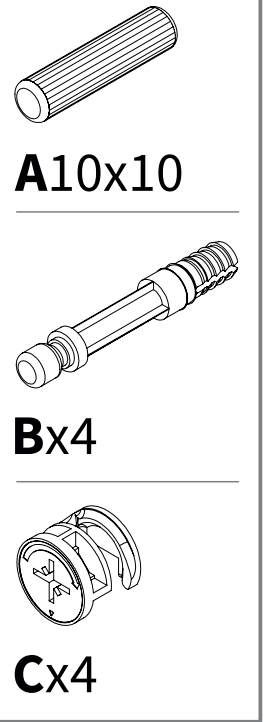
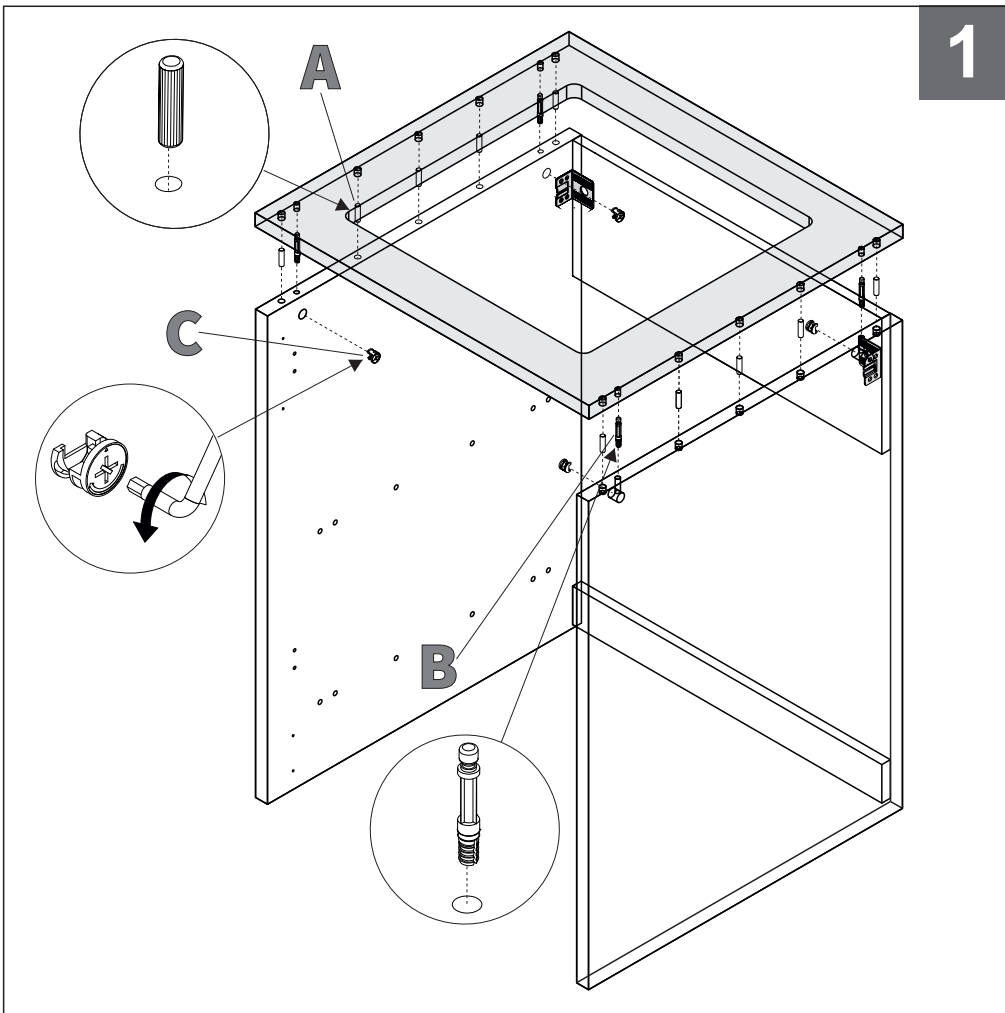

IT-Pulizia e manutenzione

EN-Cleaning and maintenance

FR-Nettoyage et entretien

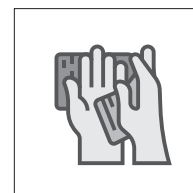
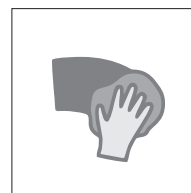

IT-Per la pulizia utilizzare esclusivamente detersivi al sapone e asciugare con un panno morbido. Non utilizzare detersivi abrasivi, corrosivi o contenenti agenti chimici, alcool, acidi o solventi. Evitare anche l'impiego di spugne abrasive, pagliette metalliche etc. che danneggerebbero irrimediabilmente le superfici del prodotto, compromettendone la lucentezza o la satinatura. In presenza di acque calcaree o aggressive asciugare dopo l'uso poiché i depositi potrebbero intaccare la superficie del prodotto.

EVITARE CHE L'ACQUA SCENDA E RISTAGNI SUL MOBILE; NEL CASO QUESTO ACCADA, ASCIUGARLO TEMPESTIVAMENTE.

EN-For cleaning use only soap detergents and dry with a soft cloth.

Do not use abrasive, corrosive or chemical agents, alcohol, acids or solvents.

Also avoid the use of abrasive sponges, metal scourers etc. that would irreparably damage the surfaces of the product, compromising the gloss or the satin finish.

In the presence of calcareous or aggressive waters, dry after use as deposits may affect the surface of the product.

DO NOT LET THE WATER COME DOWN AND STAND ON THE CABINET; IF THIS HAPPENS, DRY IT PROMPTLY.

FR-Pour le nettoyage utiliser seulement des détergents à base de savon et sécher avec un chiffon doux. Ne pas utiliser de détergents abrasifs, corrosifs ou à base de produits chimiques, alcool, acides ou solvants.

Eviter aussi l'utilisation d'éponges abrasives, de produits à récuper etc.

qui endommageraient de façon permanente les surfaces du produit, en compromettant la finition brillante ou satinée.

En présence d'eaux calcaires ou agressives, sécher après l'utilisation car les dépôts pourraient affecter la surface du produit.

EMPÊCHER L'EAU DE DESCENDRE ET DE STAGNER SUR LE MEUBLE ; SI CELA SE PRODUIT, SÉCHEZ-LE RAPIDEMENT.



FR

Donnez ou recyclez
vos meubles.



Association

ou



Magasin

ou



Déchèterie

<https://quefairedemesdechets.fr>

PRODOTTO IN ITALIA
MADE IN ITALY
FABRIQUÉ EN ITALIE