



JNKA

IT-Istruzioni di montaggio

base 2 vani giorno

EN-Assembly instructions

open unit with 2 compartments

FR-Notice de montage

Base 2 élément à jour

86670424

86670425

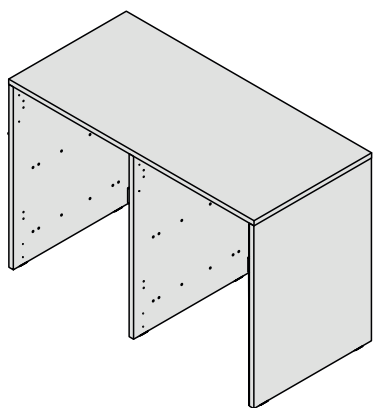

87675533

87675534

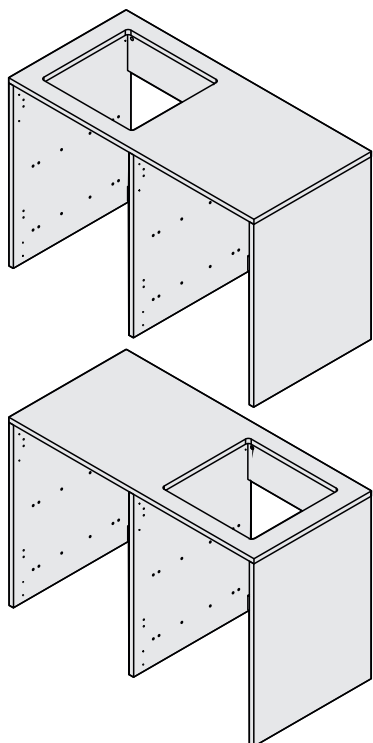

86670395

86670396

opzionale/optional/
optionnel

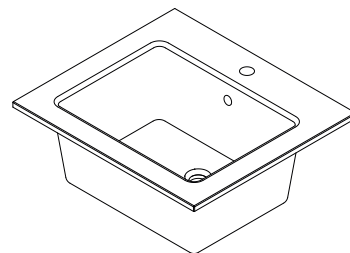

86670391

87675536

opzionale/optional/
optionnel

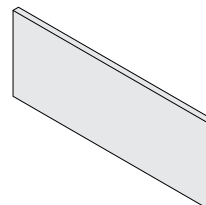

86670392

86670375

opzionale/optional/
optionnel

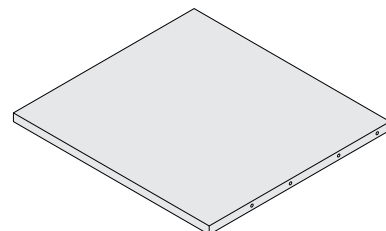

86670376

87675535

opzionale/optional/
optionnel

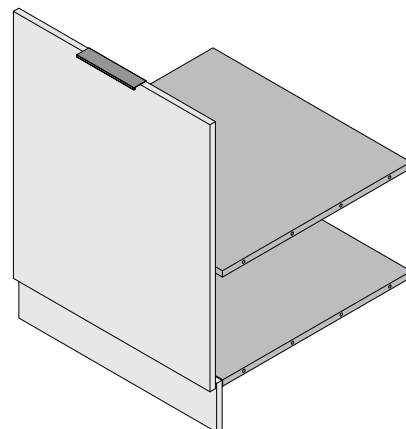

86670424
86670425

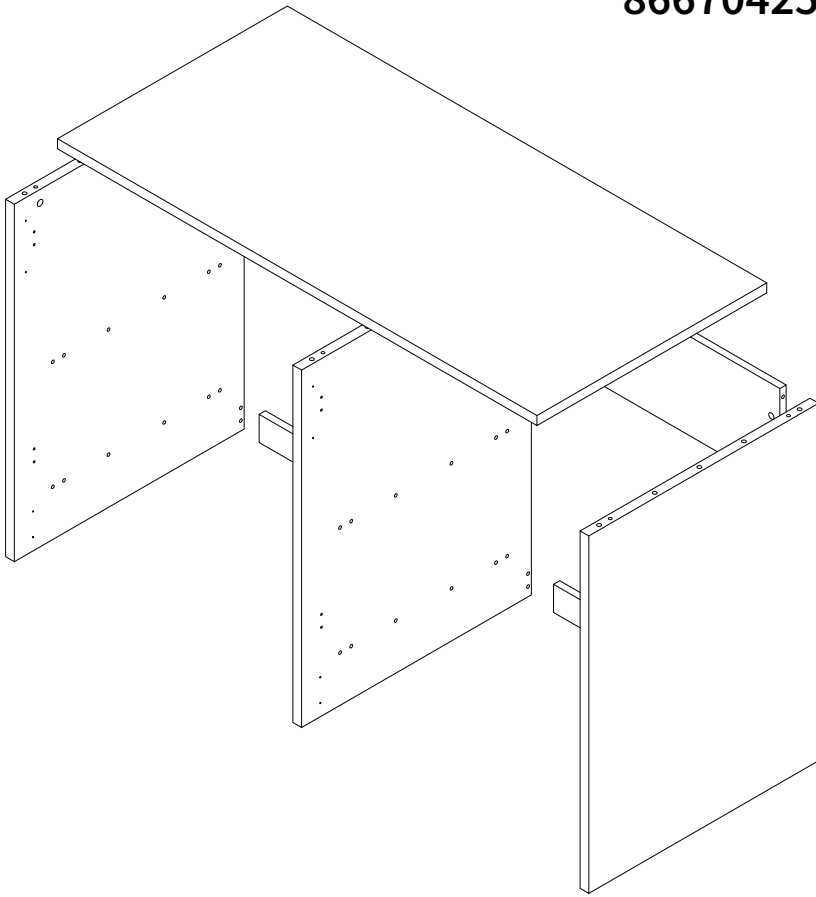

IT-Al fine di evitare il ribaltamento del mobile è obbligatorio il fissaggio dello stesso a parete tramite le apposite attaccaglie.
* Viti e tasselli (non inclusi) devono essere adeguati al tipo di materiale della vostra parete

EN-In order to avoid the furniture overturning, you have absolutely fix it to the wall through the appropriate attachments
* Screws and dowels (not included) must be suitable to the type of material of your wall

FR-Pour éviter tout risque de basculement, le meuble doit être absolument fixé au mur à l'aide des supports de fixation fournis
* Utiliser des vis et chevilles (non fournies) adaptées au type de matériaux de votre mur

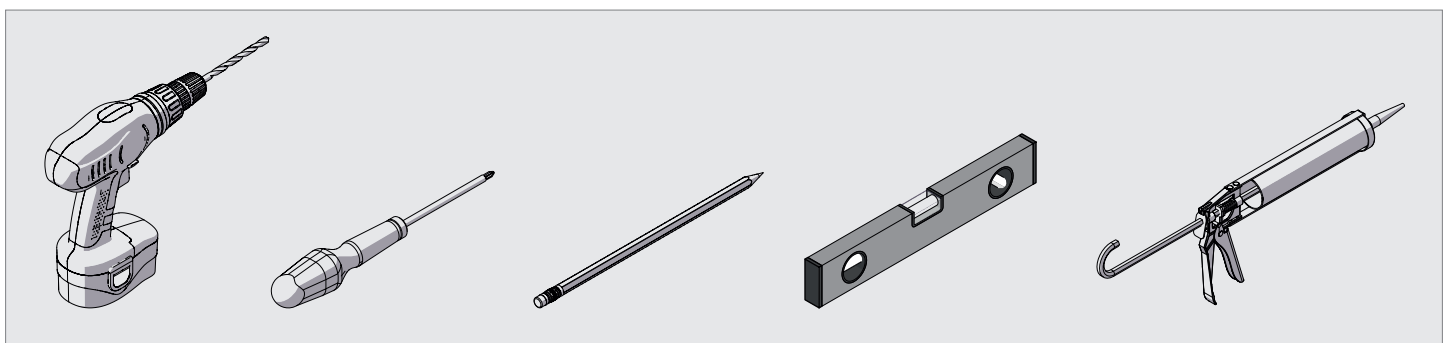
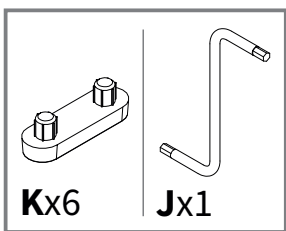
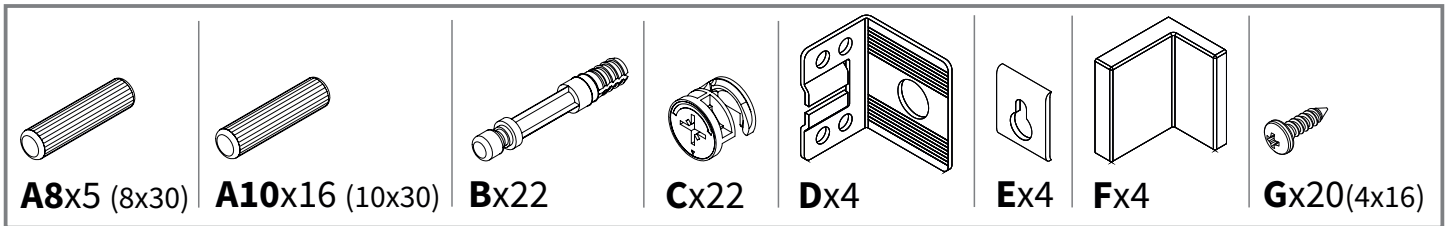

1

IT-Assemblaggio elementi base
EN-Assembly base units elements
FR-Assemblage des éléments de bases

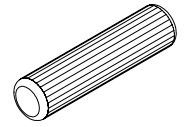
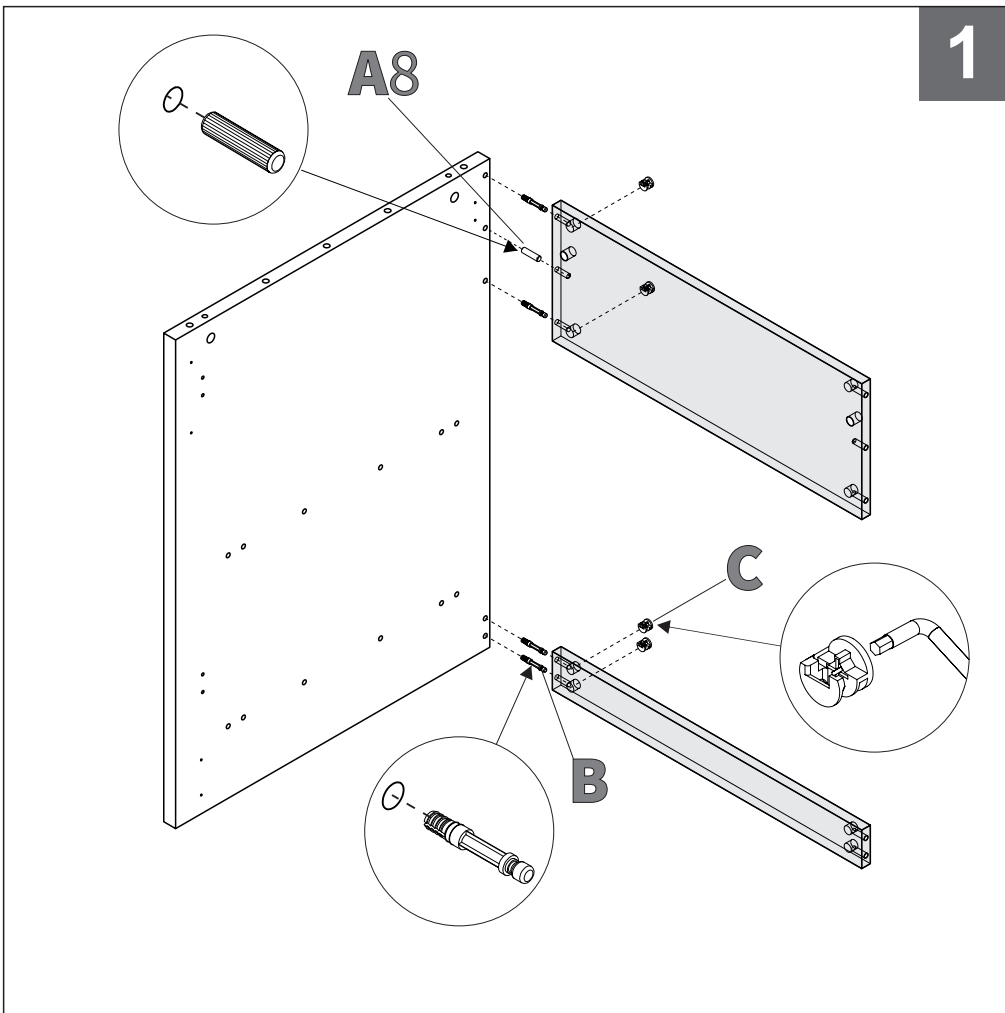

A8x1

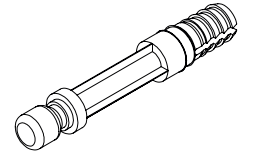

Bx4

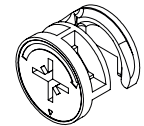

Cx4

2

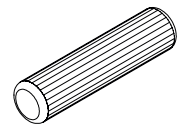
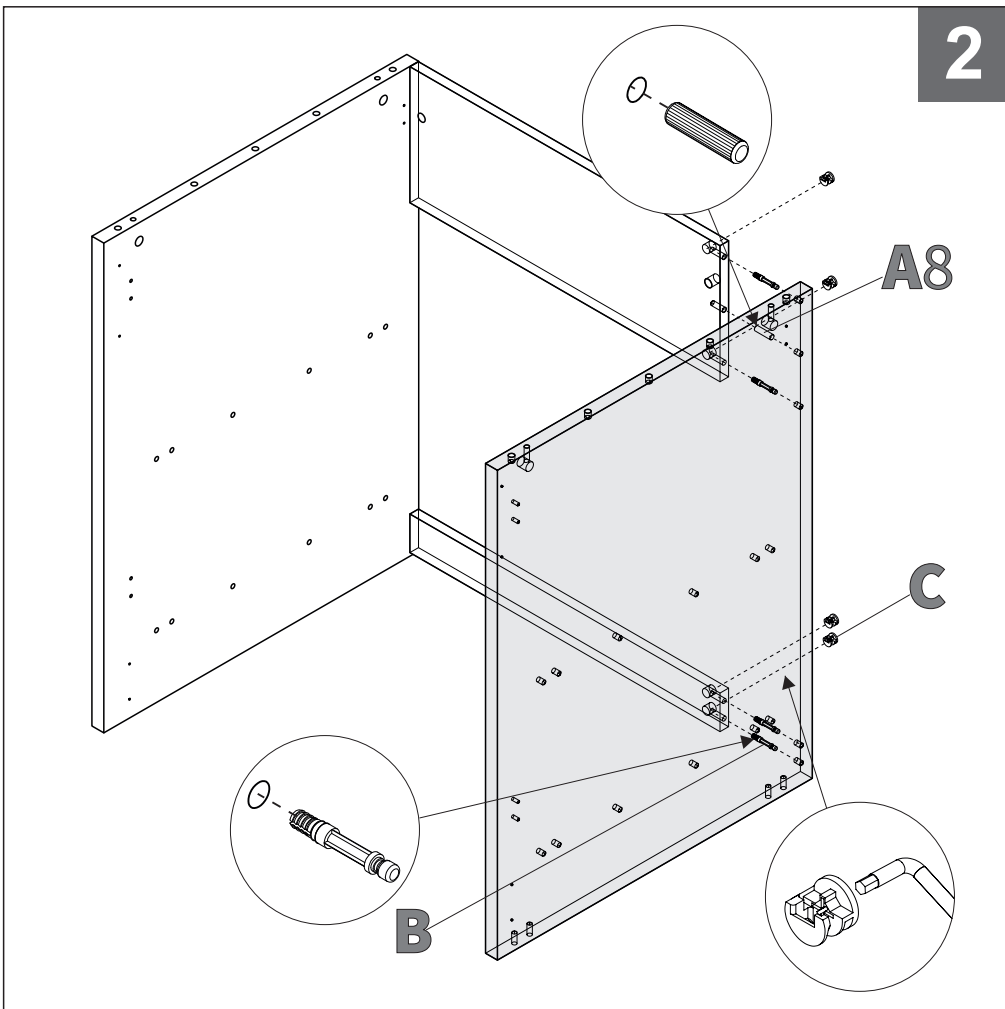

A8x1

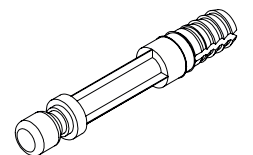

Bx4

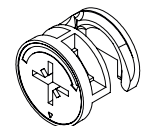

Cx4

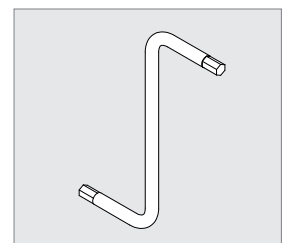

3

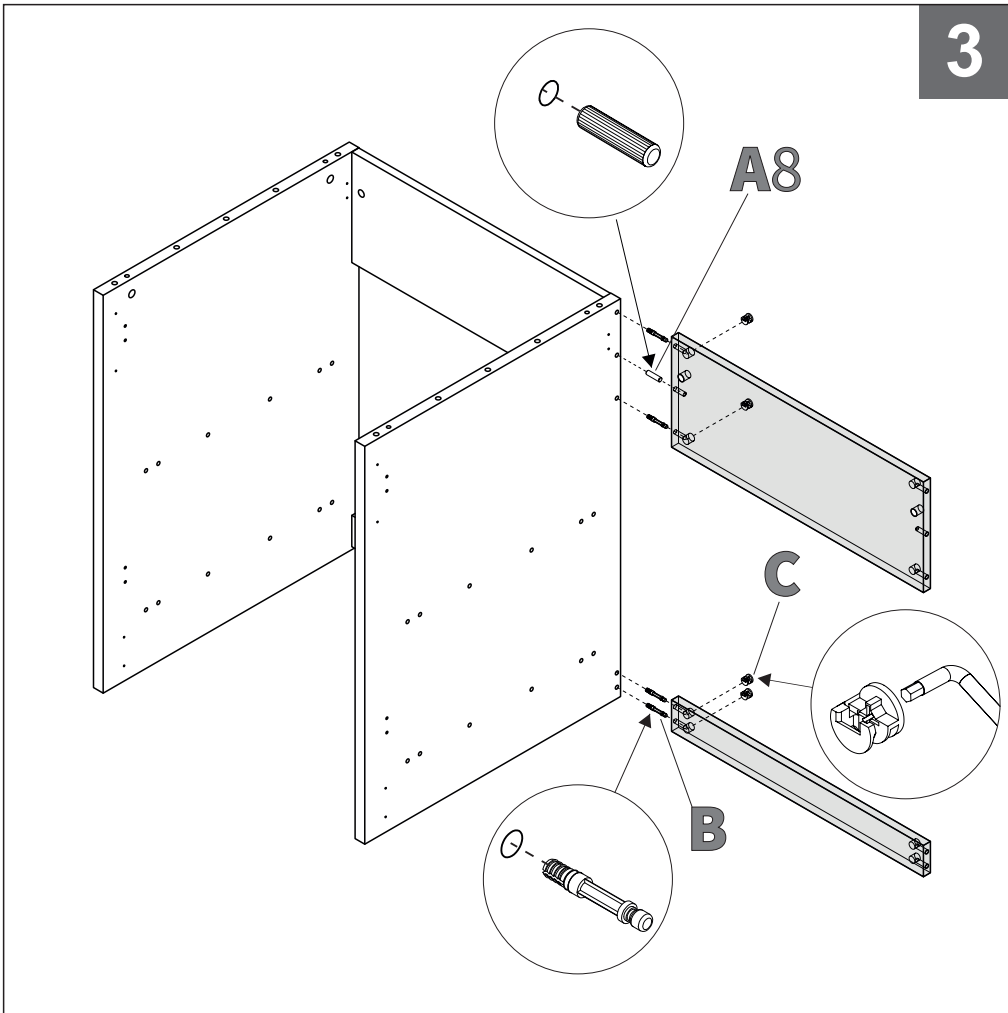

IT-Assemblaggio elementi base
 EN-Assembly base units elements
 FR-Assemblage des éléments de bases

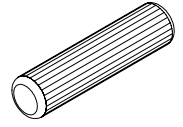

A8x1

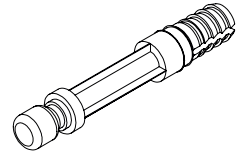

Bx4

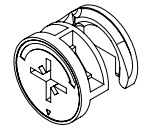

Cx4

4

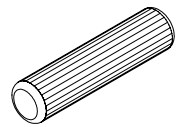
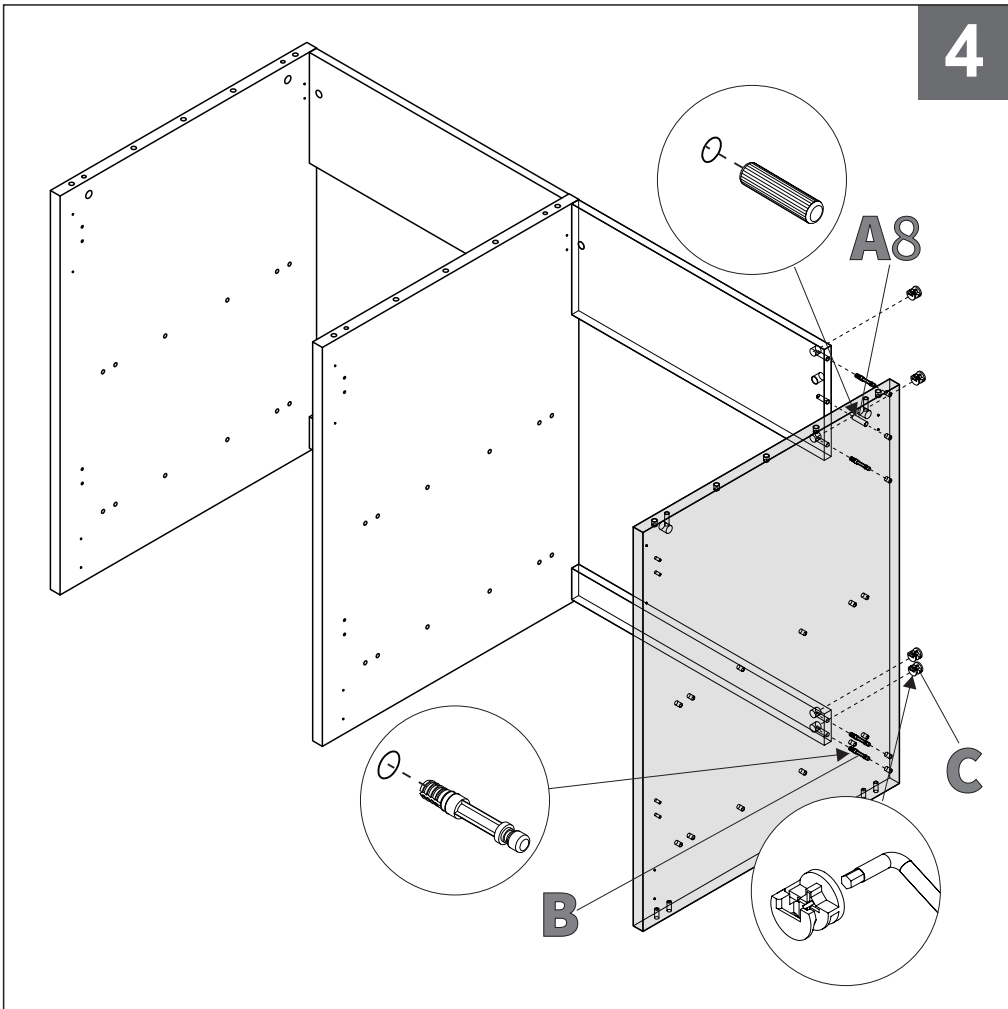

A8x1

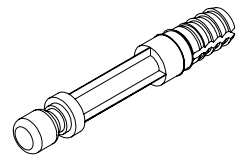

Bx4

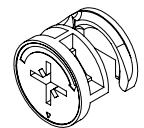

Cx4

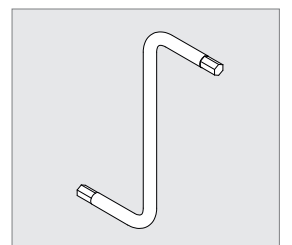

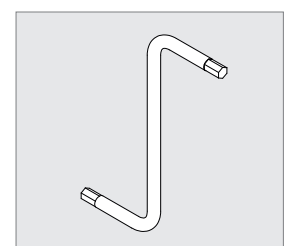
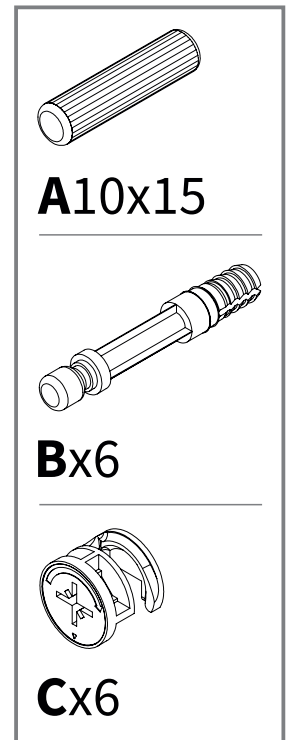
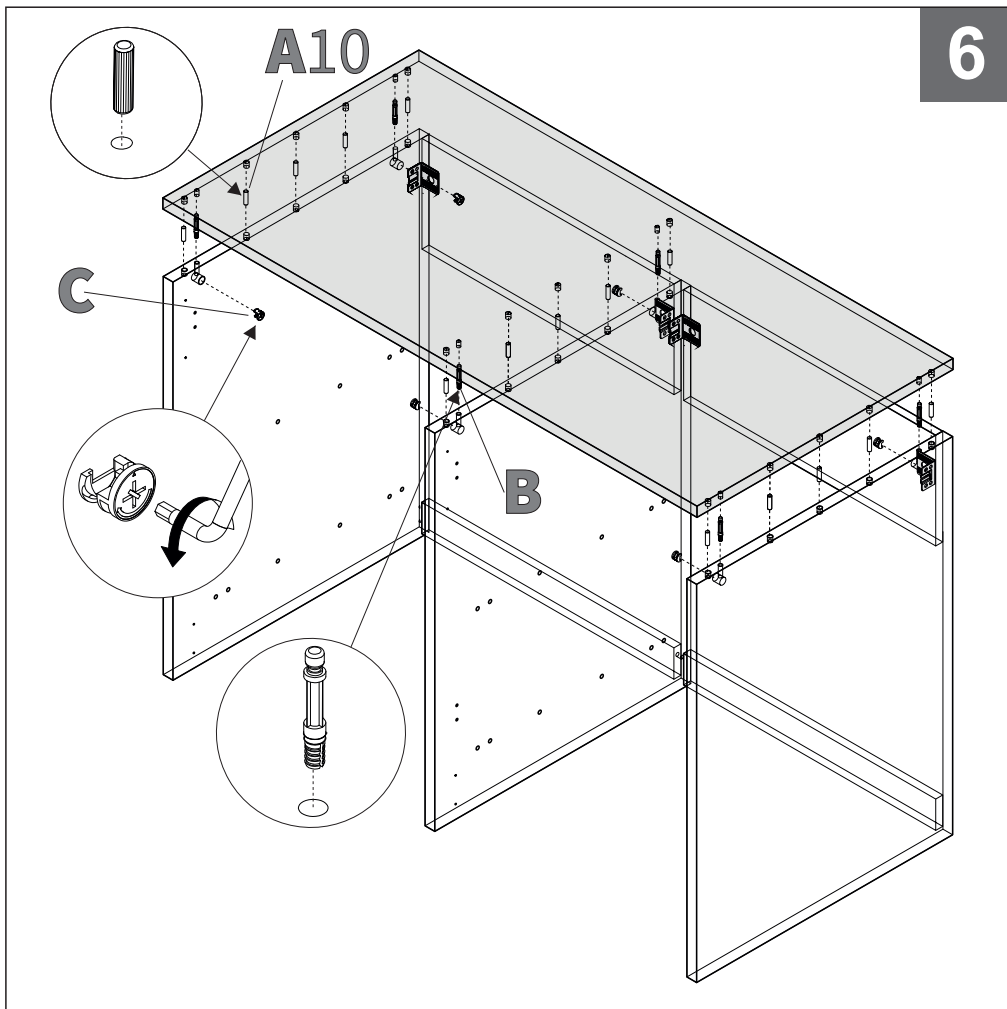
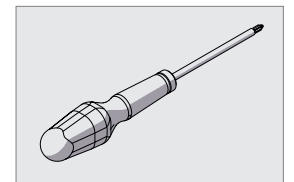
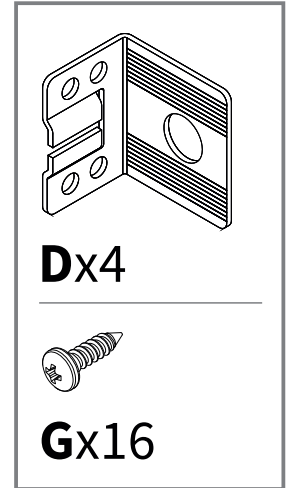
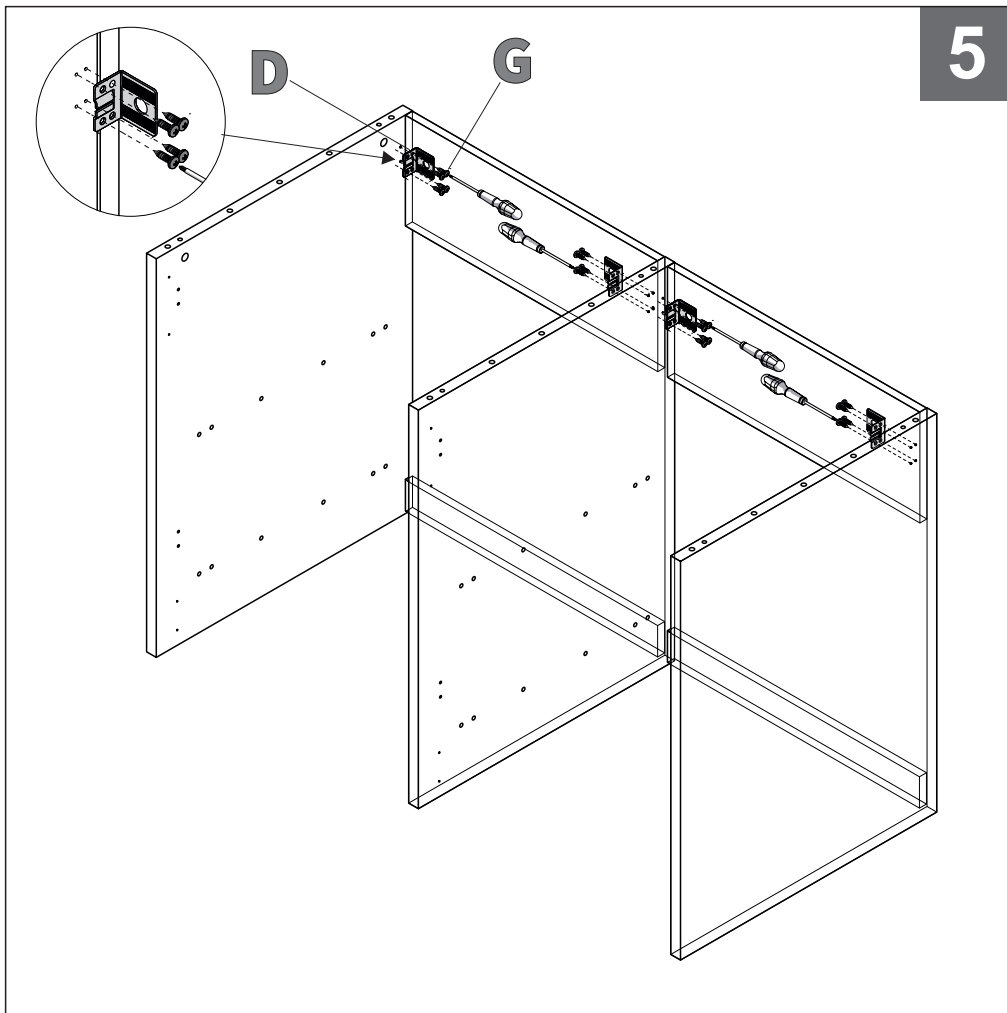

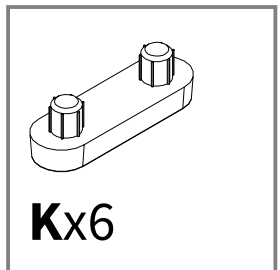
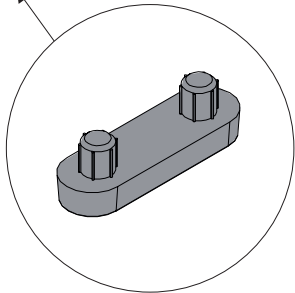
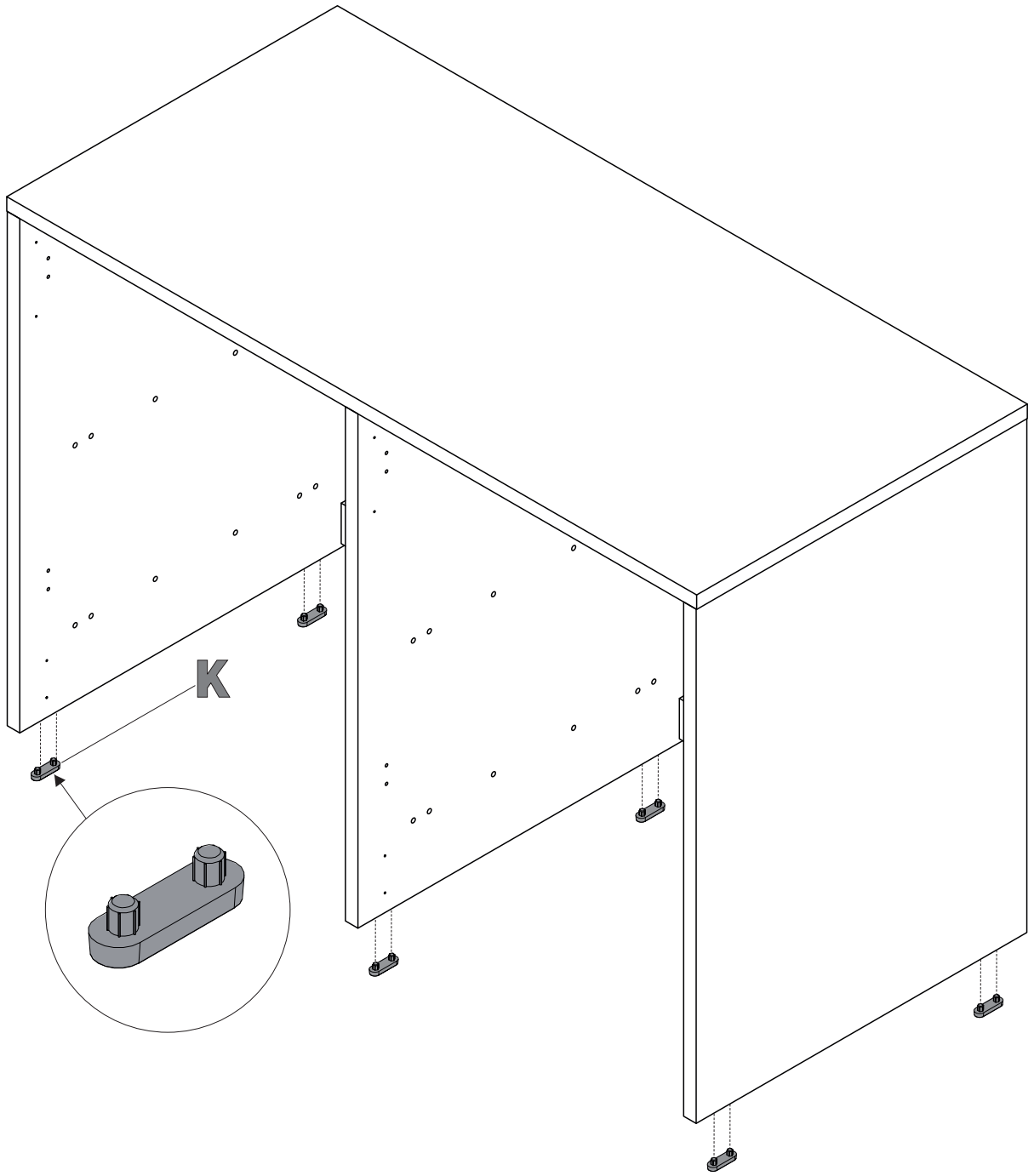

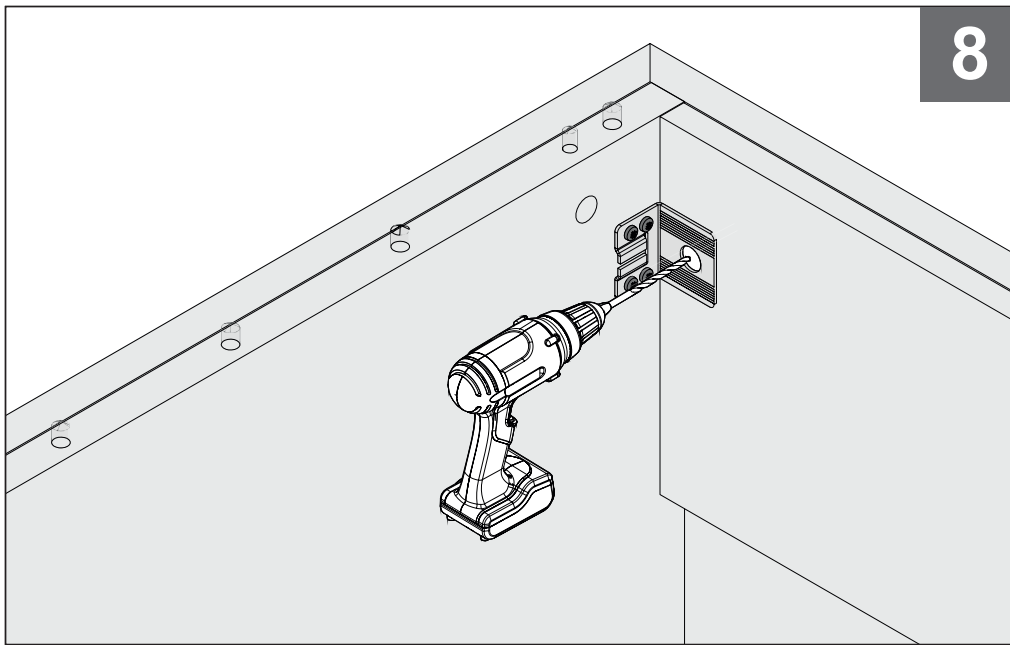

IT-Fissaggio base a parete
 EN-Fixing base unit to wall
 FR-Fixation de base au mur

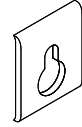

Ex2

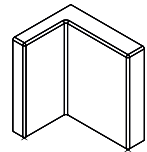

Fx2

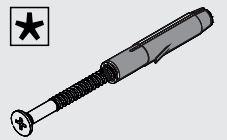
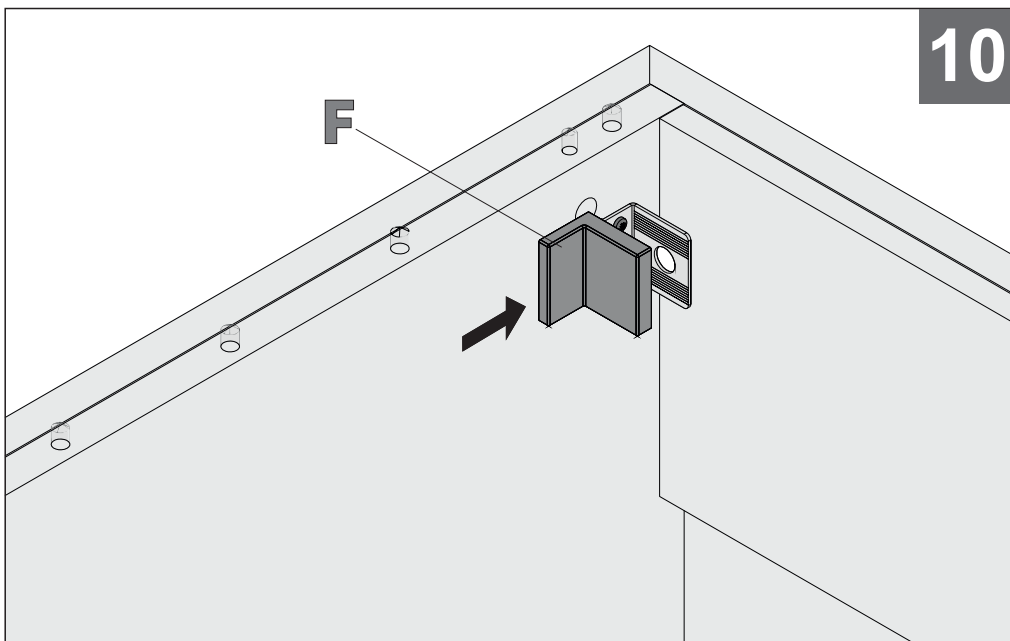
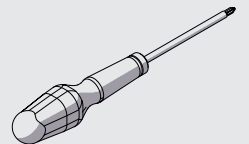
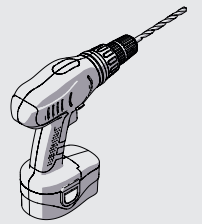
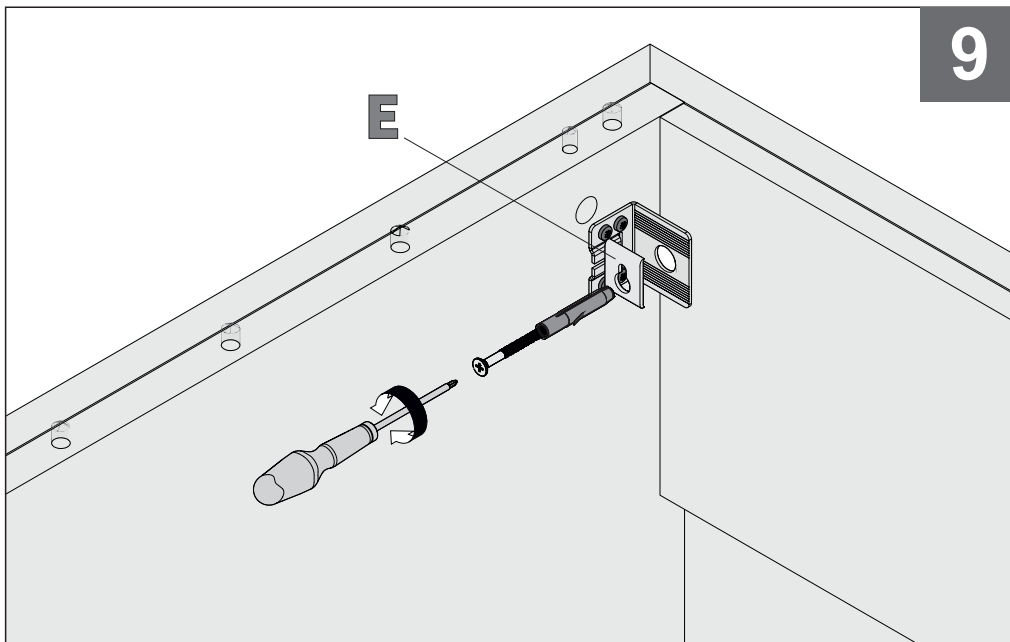

86670391

86670392

86670375

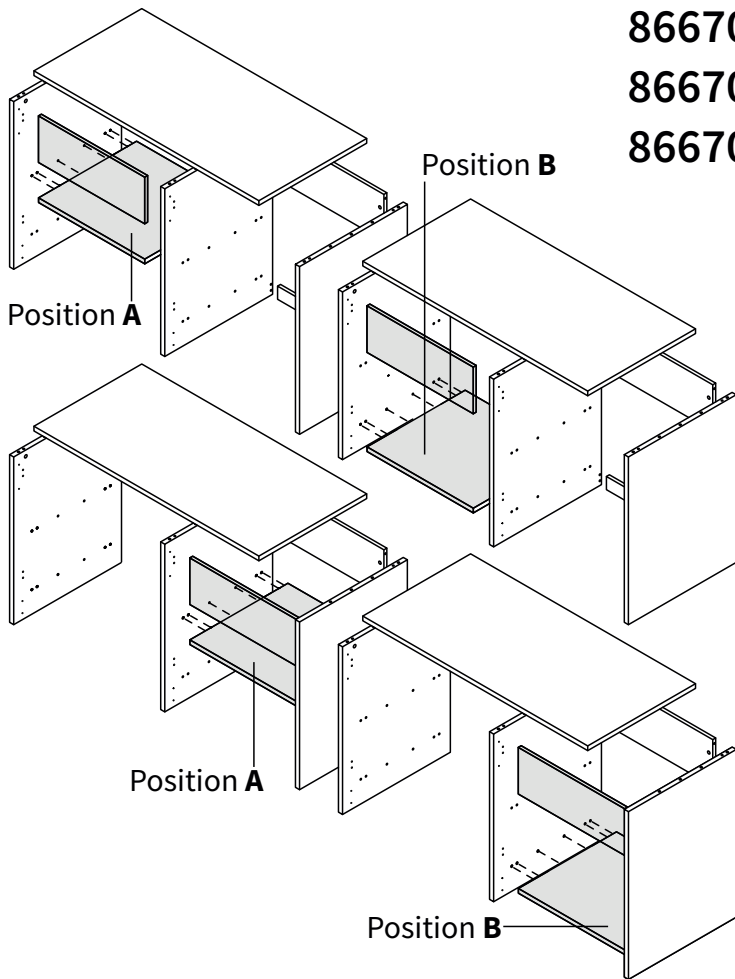

IT-Al fine di evitare il ribaltamento del mobile è obbligatorio il fissaggio dello stesso a parete tramite le apposite attaccaglie.

* Viti e tasselli (non inclusi) devono essere adeguati al tipo di materiale della vostra parete
EN-In order to avoid the furniture overturning, you have absolutely fix it to the wall through the appropriate attachments

* Screws and dowels (not included) must be suitable to the type of material of your wall
FR-Pour éviter tout risque de basculement, le meuble doit être absolument fixé au mur à l'aide des supports de fixation fournis

* Utiliser des vis et chevilles (non fournies) adaptées au type de matériaux de votre mur

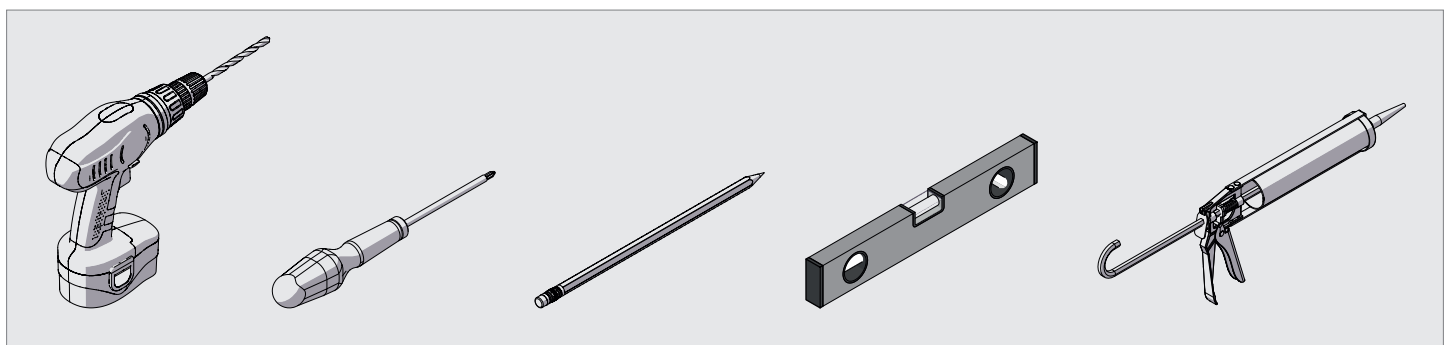
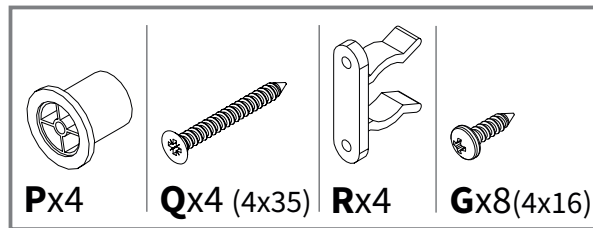
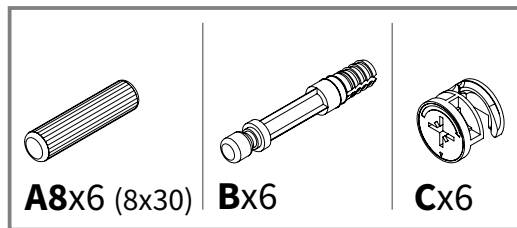

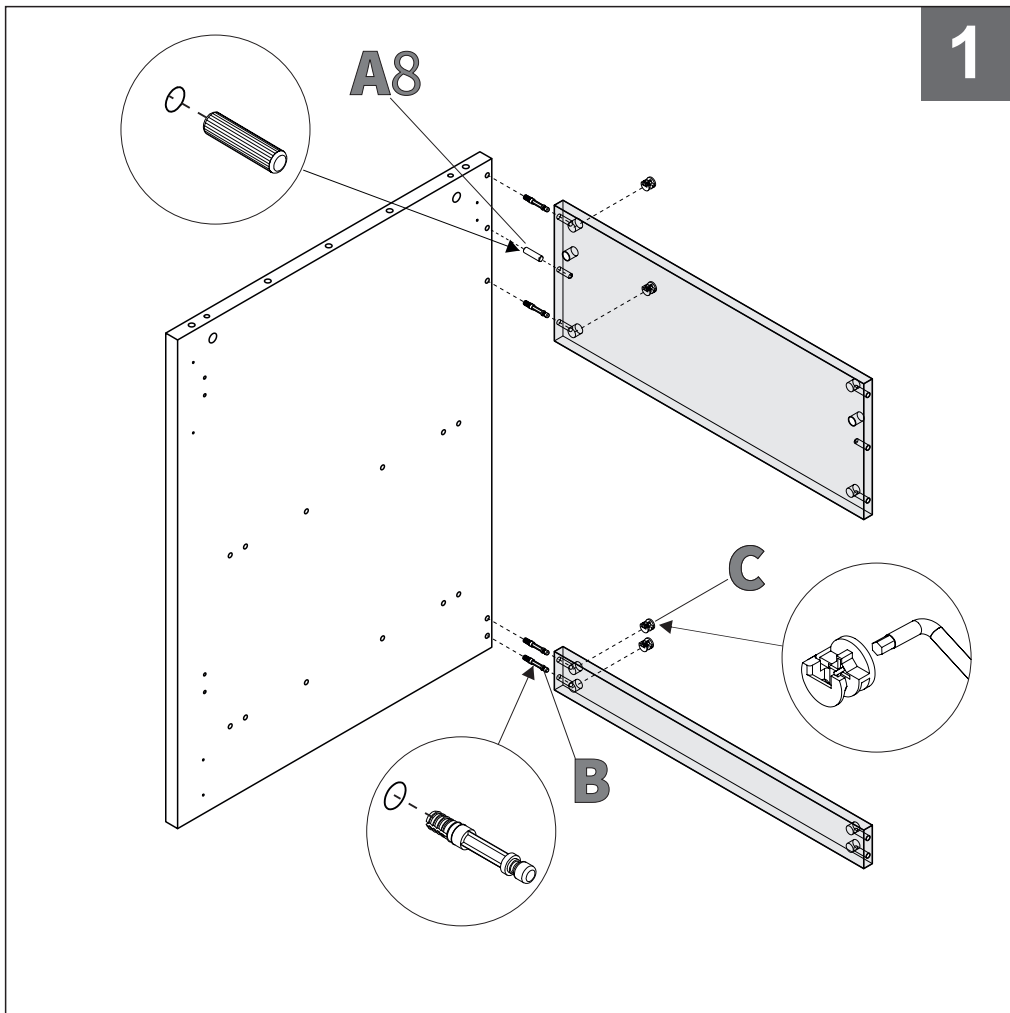

IT-Assemblaggio elementi base
 EN-Assembly base units elements
 FR-Assemblage des éléments de bases

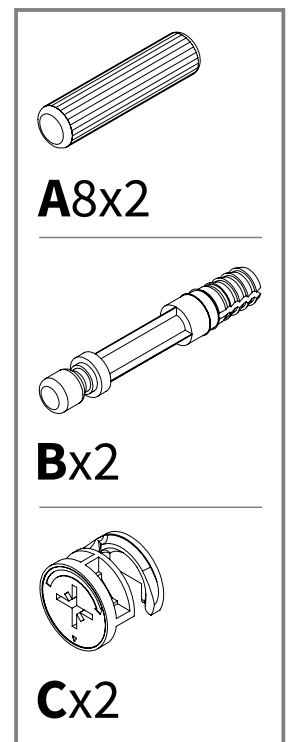
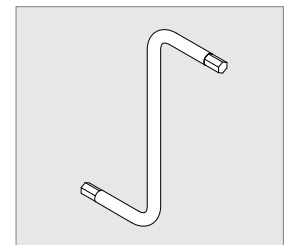
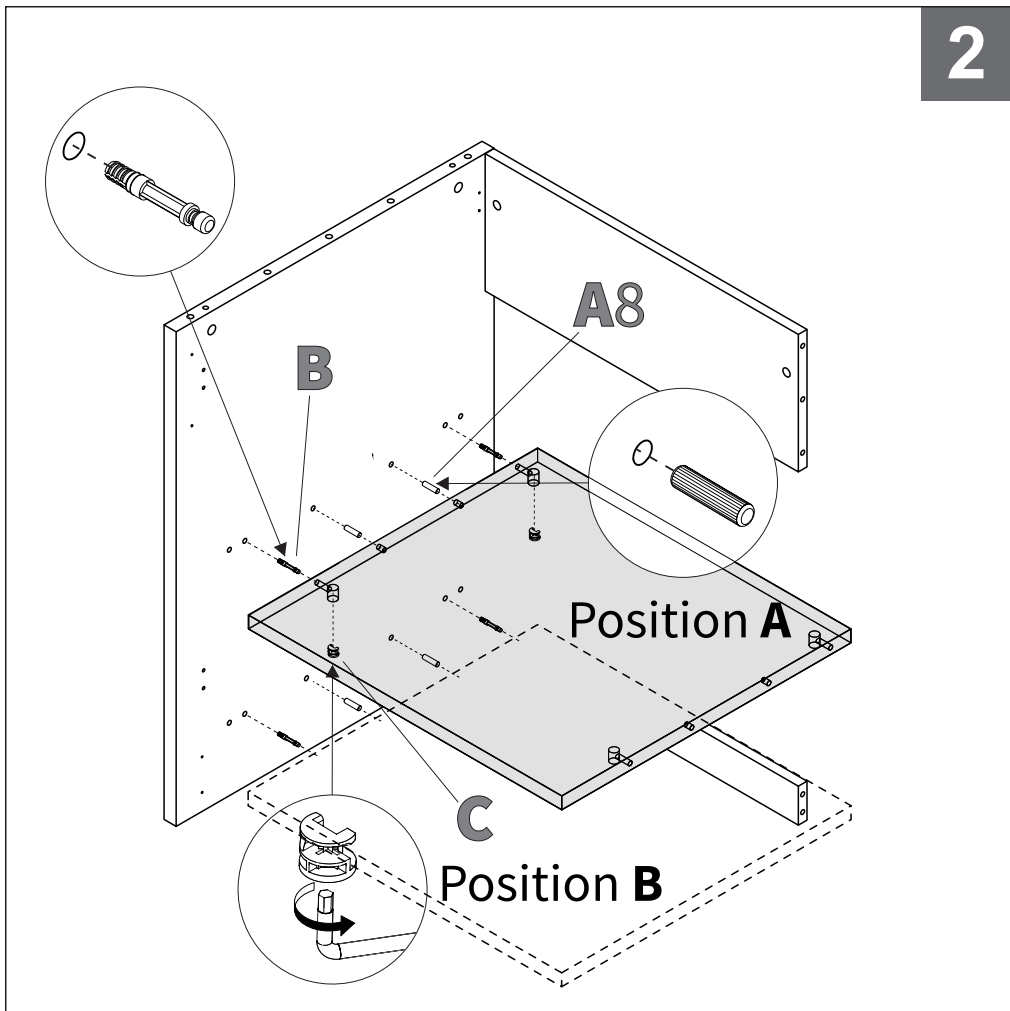
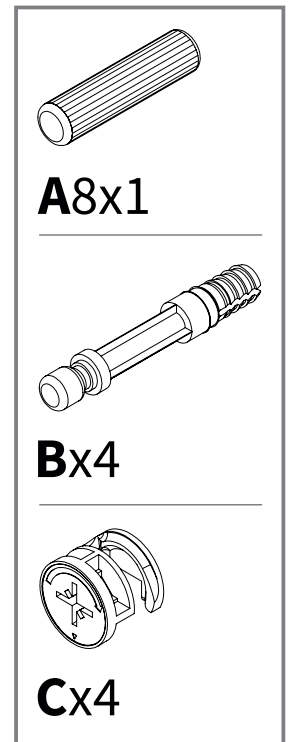

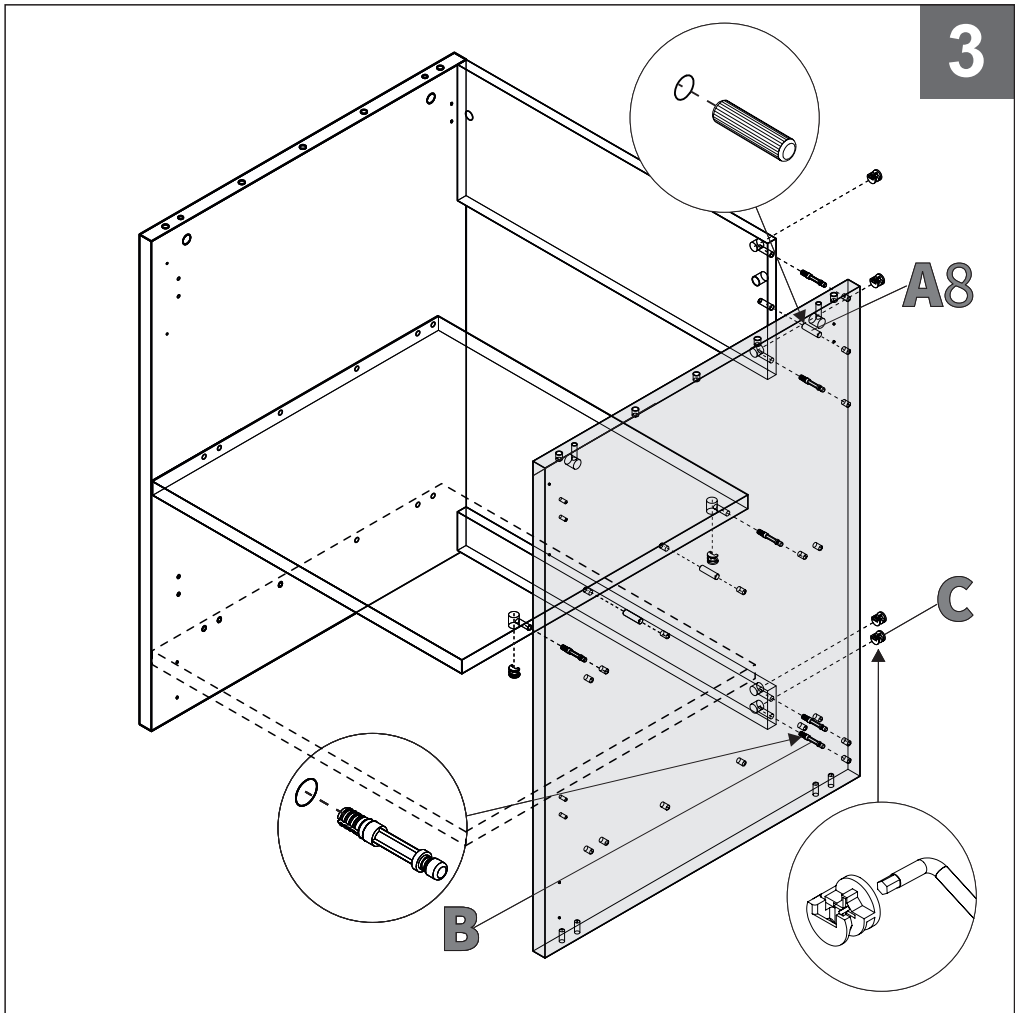

IT-Assemblaggio elementi base
 EN-Assembly base units elements
 FR-Assemblage des éléments de bases

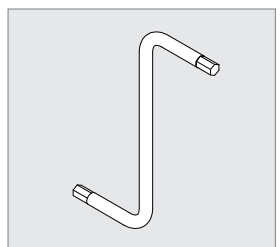
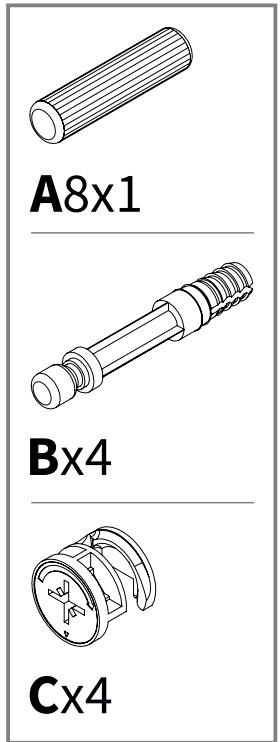
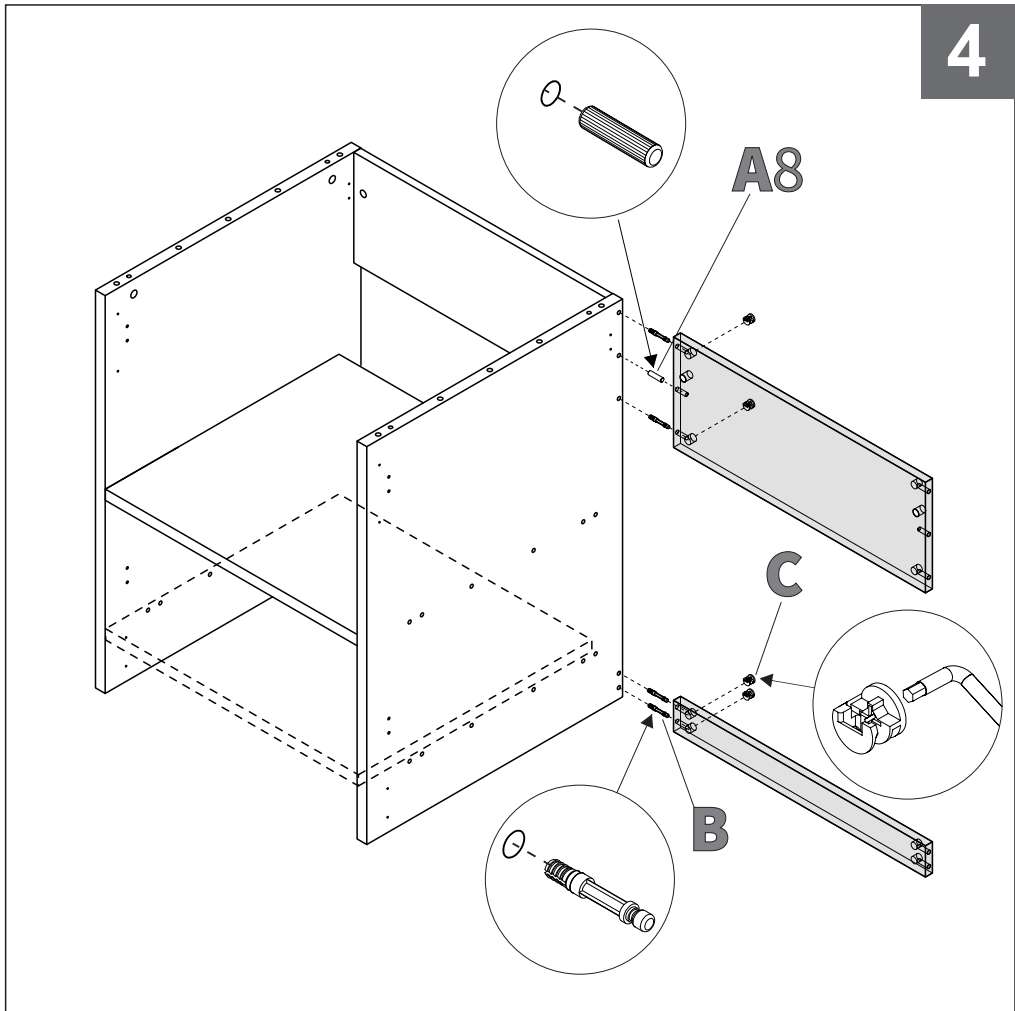
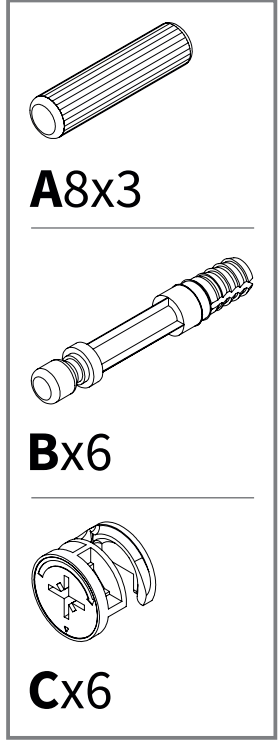

5

IT-Assemblaggio elementi base
EN-Assembly base units elements
FR-Assemblage des éléments de bases

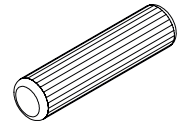
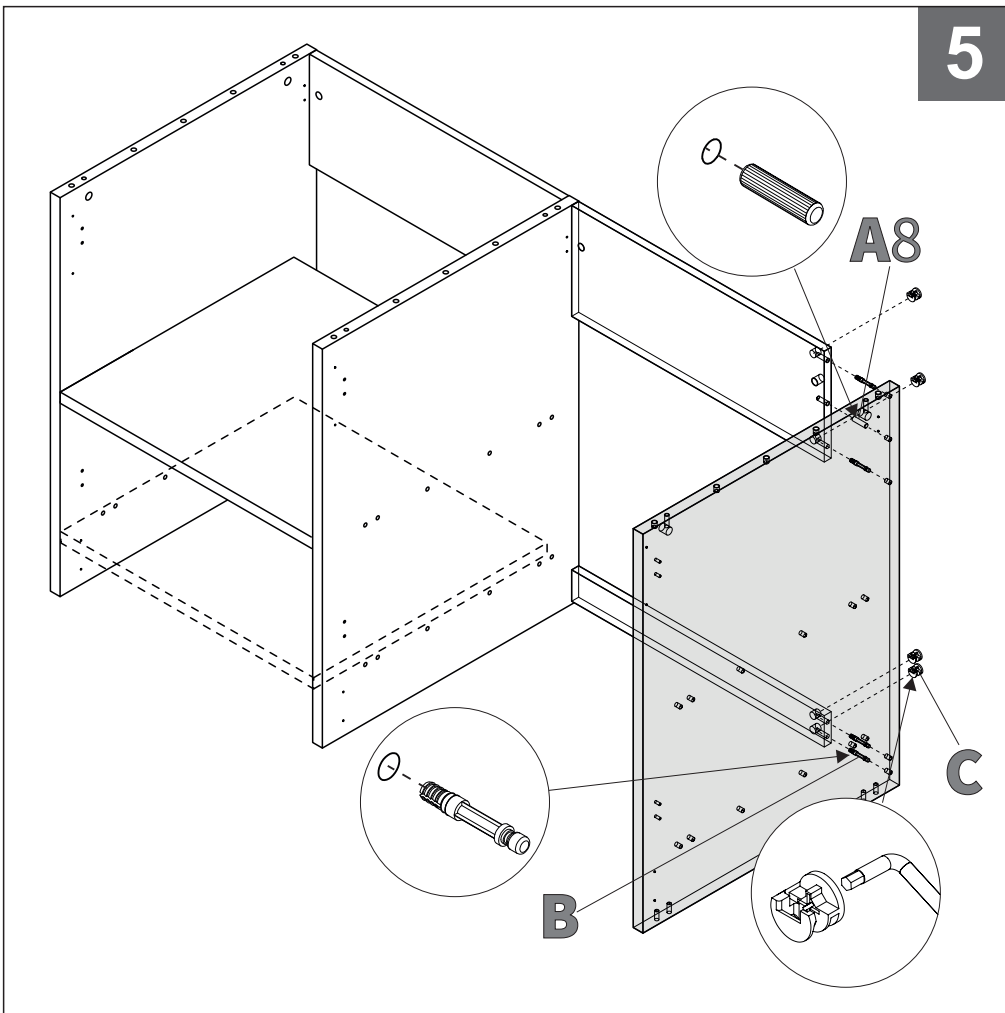

A8x1

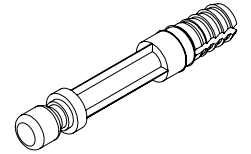

Bx4

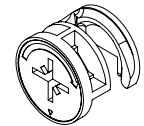

Cx4

6

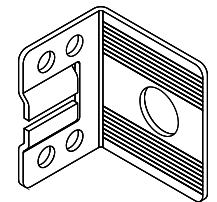
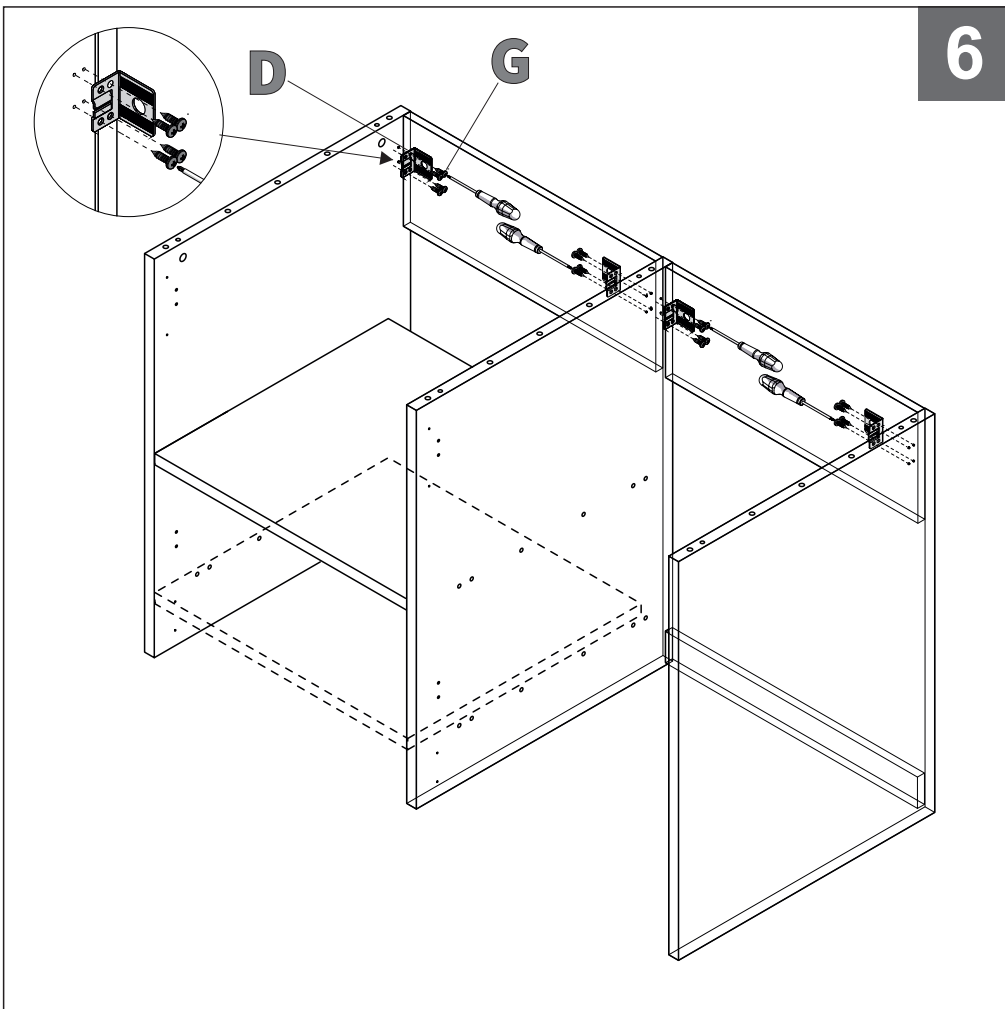

Dx4



Gx16

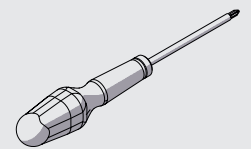

7

IT-Assemblaggio elementi base
EN-Assembly base units elements
FR-Assemblage des éléments de bases

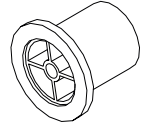
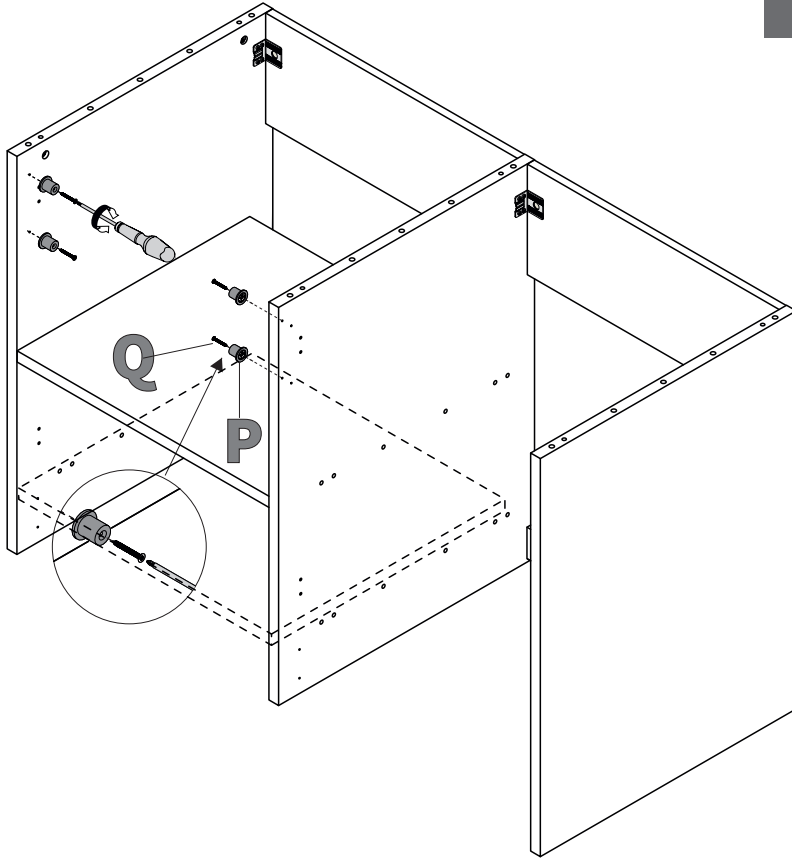

Px4

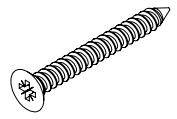

Qx4

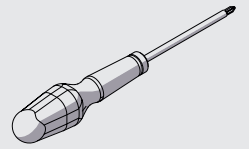

8

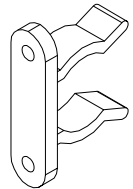
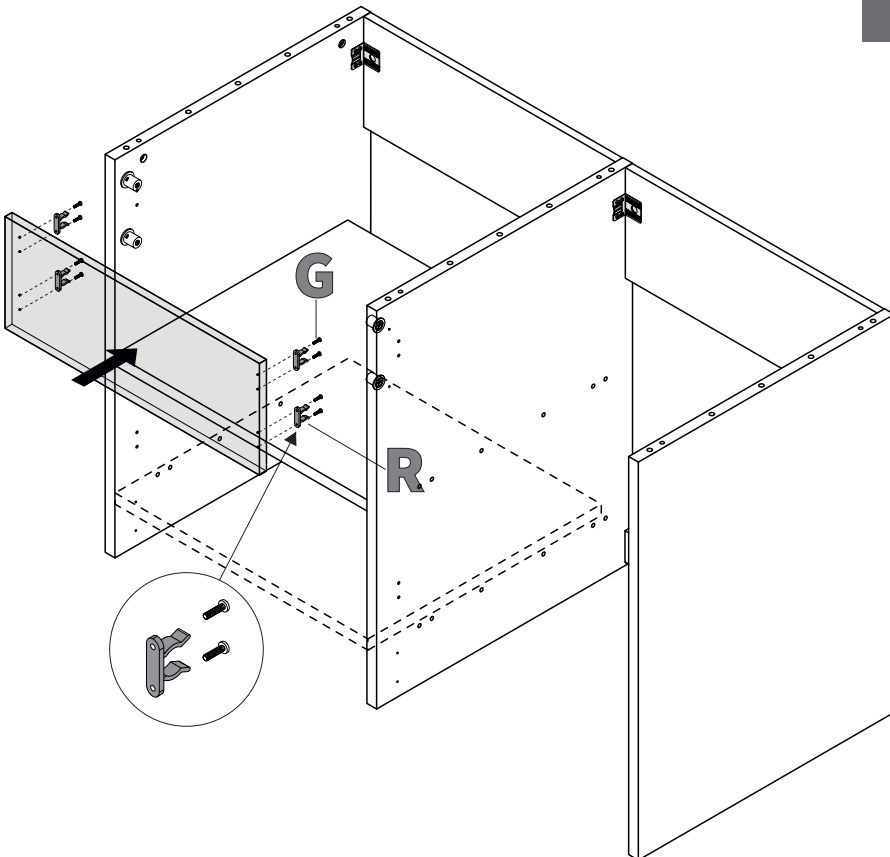

Rx4



Gx8

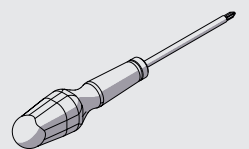

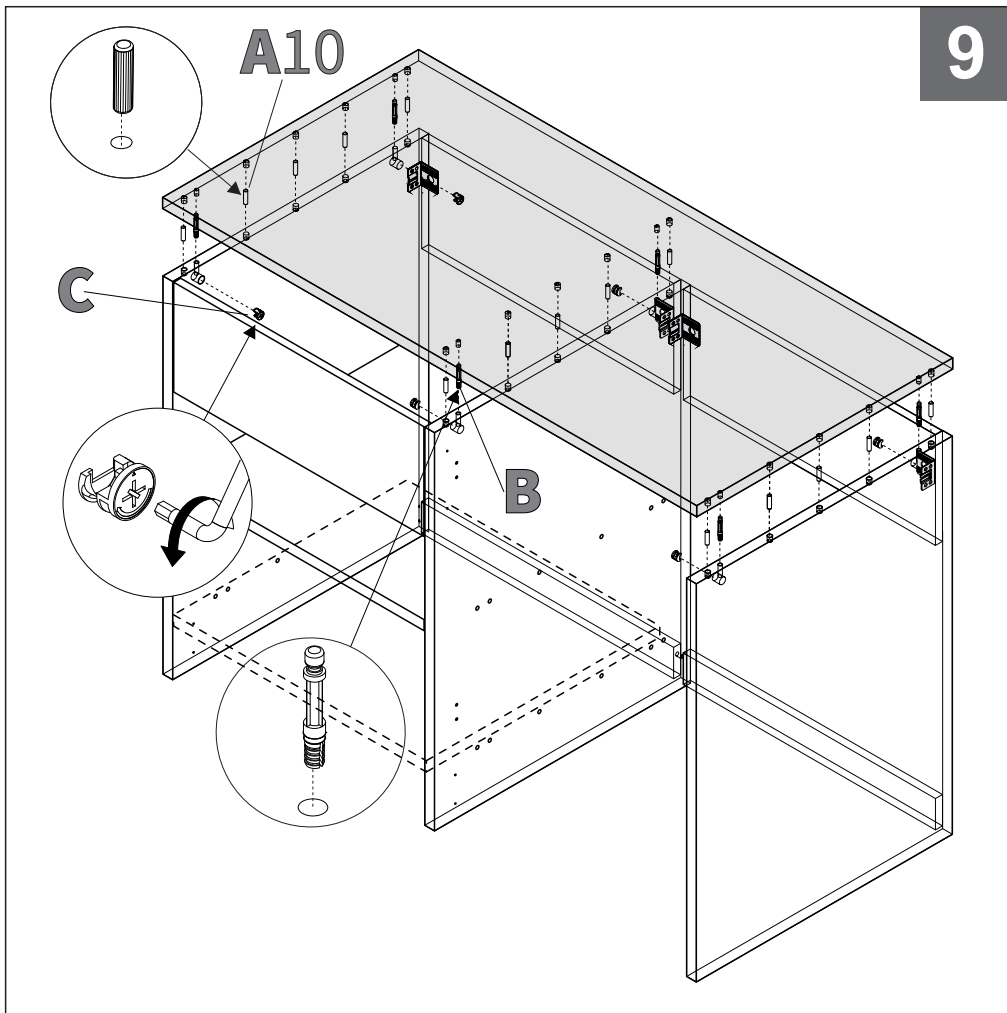

IT-Assemblaggio elementi base
 EN-Assembly base units elements
 FR-Assemblage des éléments de bases

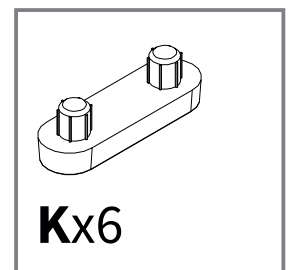
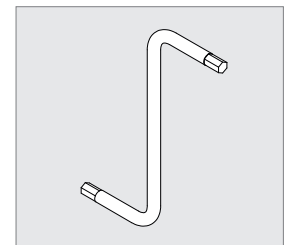
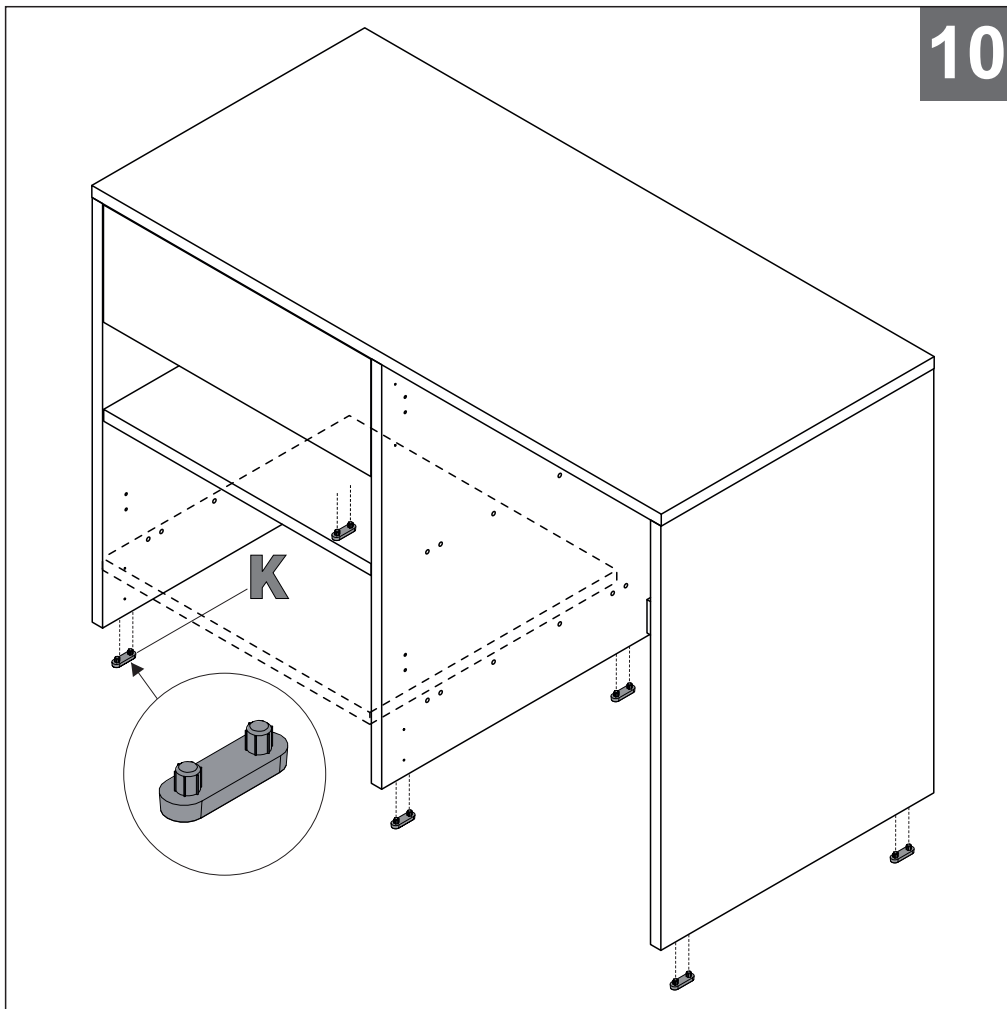
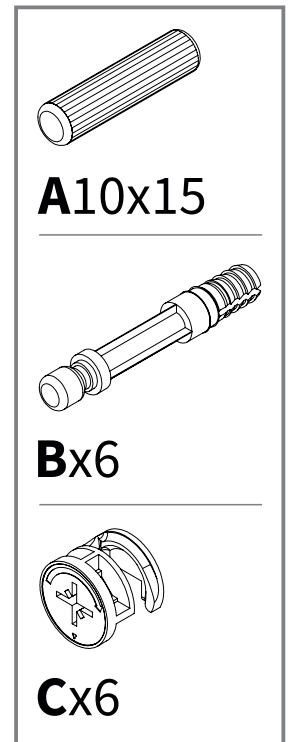

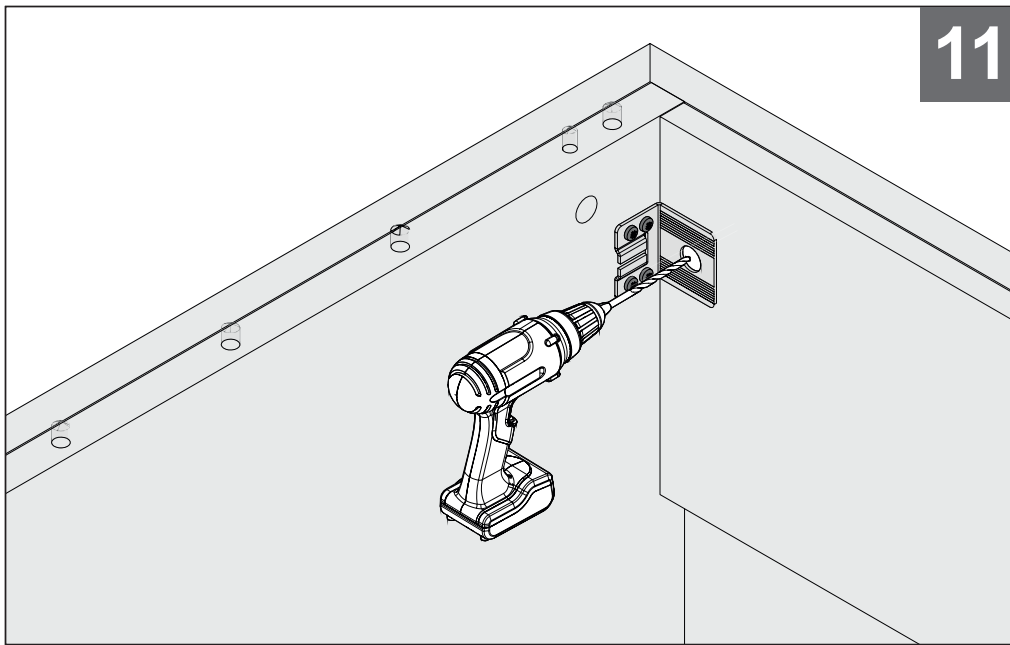

11

IT-Fissaggio base a parete
 EN-Fixing base unit to wall
 FR-Fixation de base au mur

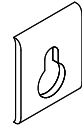

Ex2

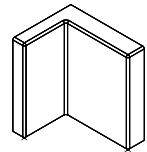

Fx2

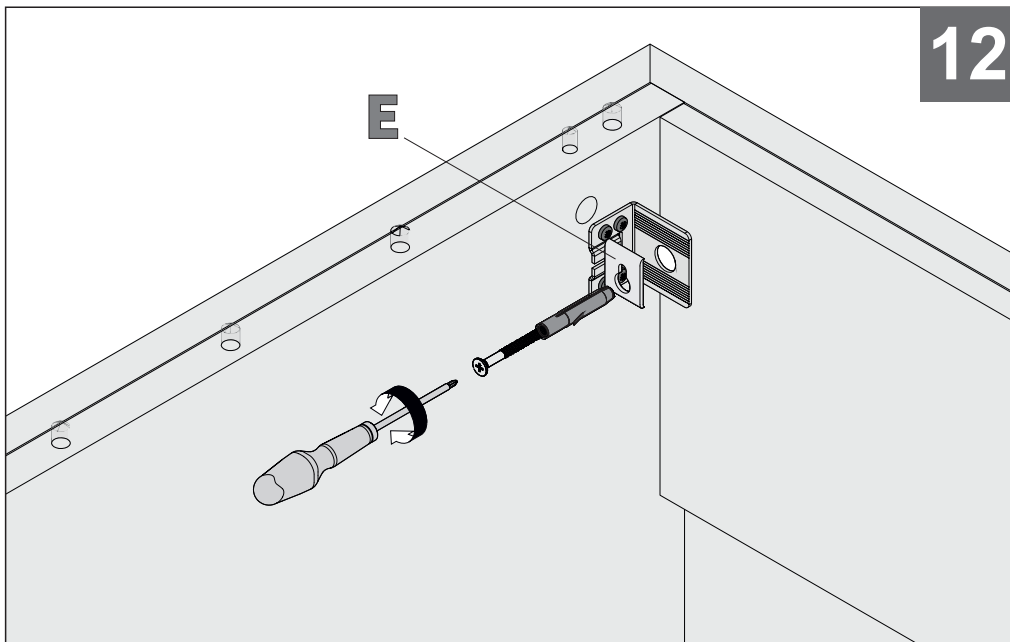

12

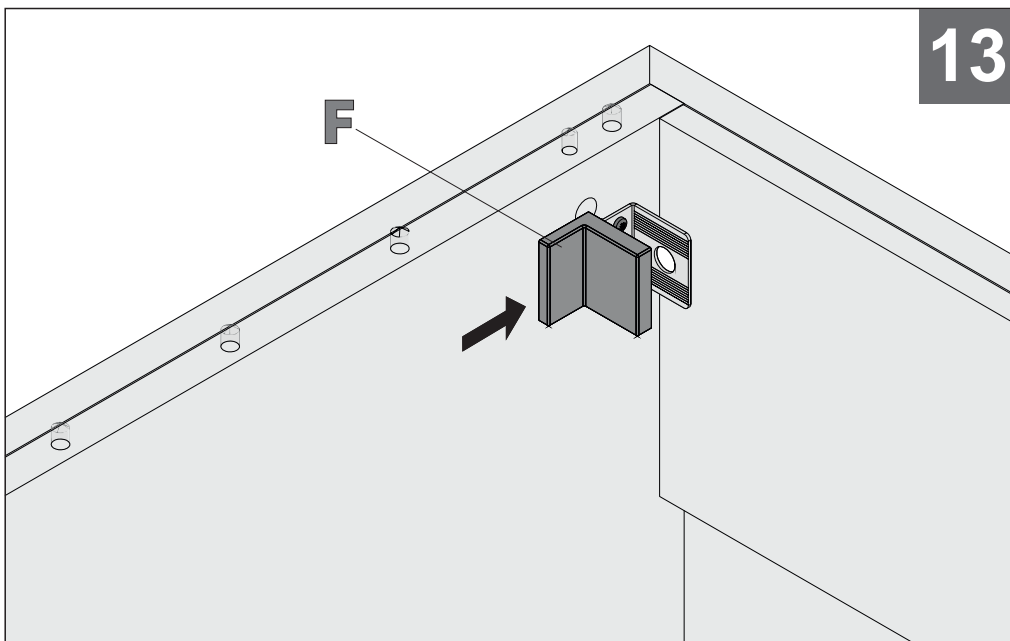
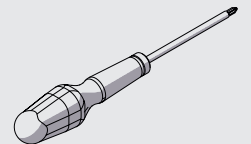
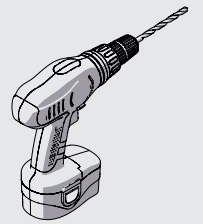

13

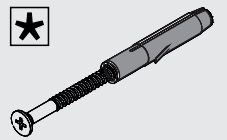

86670376

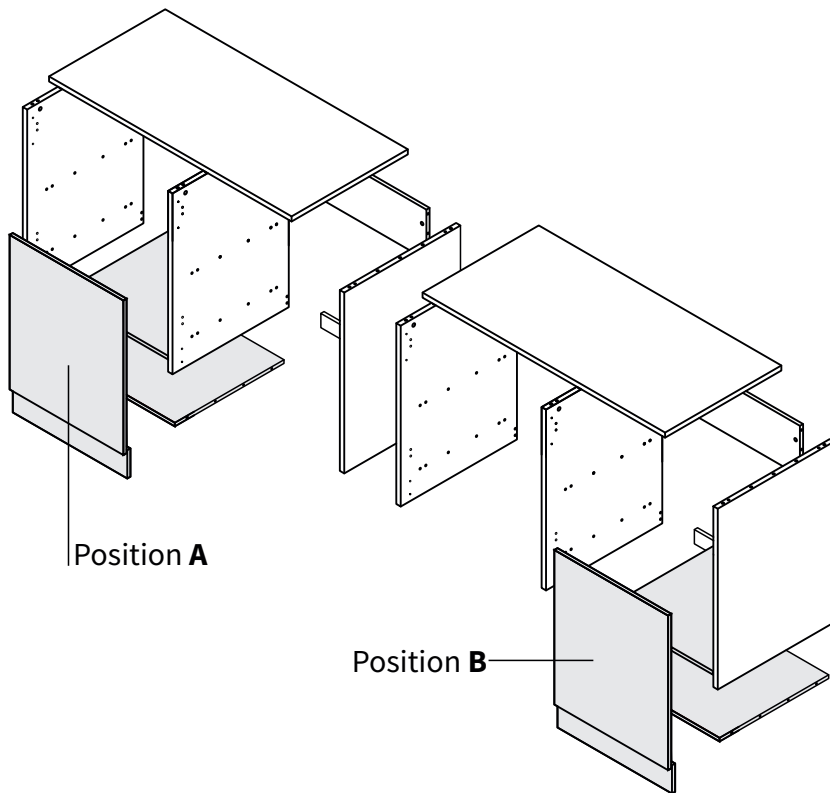

IT-Al fine di evitare il ribaltamento del mobile è obbligatorio il fissaggio dello stesso a parete tramite le apposite attaccaglie.

* Viti e tasselli (non inclusi) devono essere adeguati al tipo di materiale della vostra parete
EN-In order to avoid the furniture overturning, you have absolutely fix it to the wall through the appropriate attachments

* Screws and dowels (not included) must be suitable to the type of material of your wall
FR-Pour éviter tout risque de basculement, le meuble doit être absolument fixé au mur à l'aide des supports de fixation fournis

* Utiliser des vis et chevilles (non fournies) adaptées au type de matériaux de votre mur

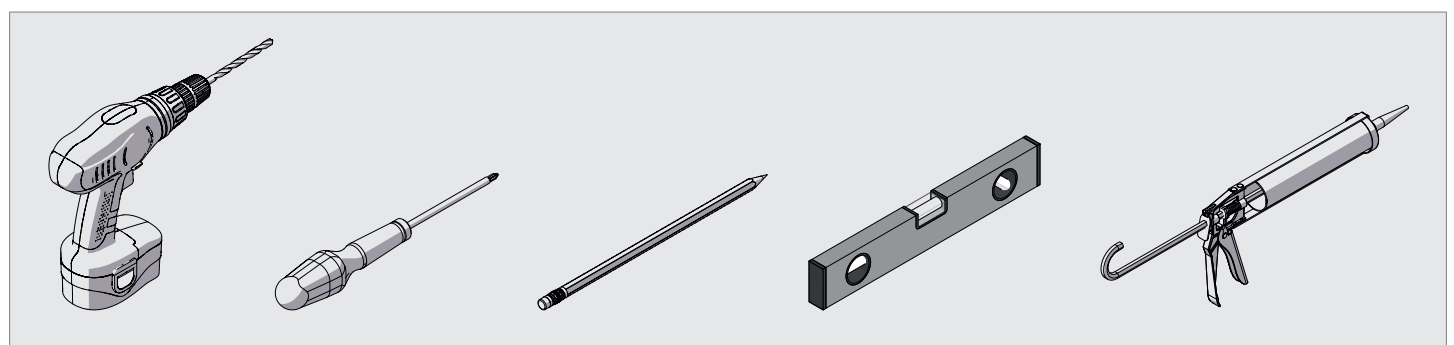
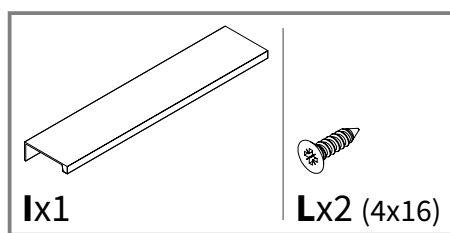
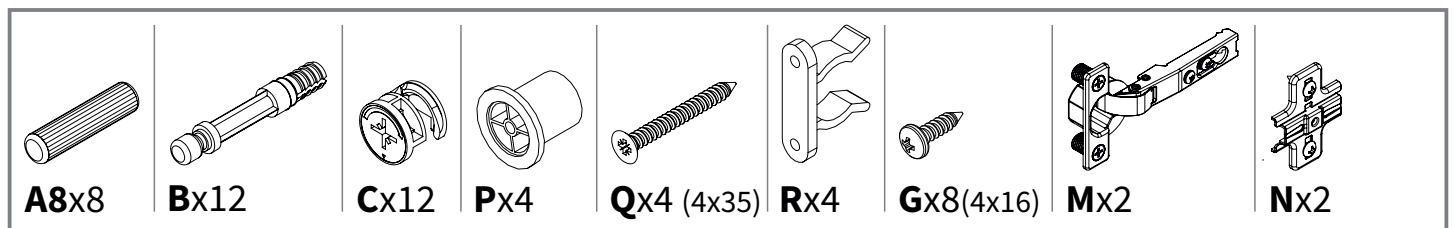

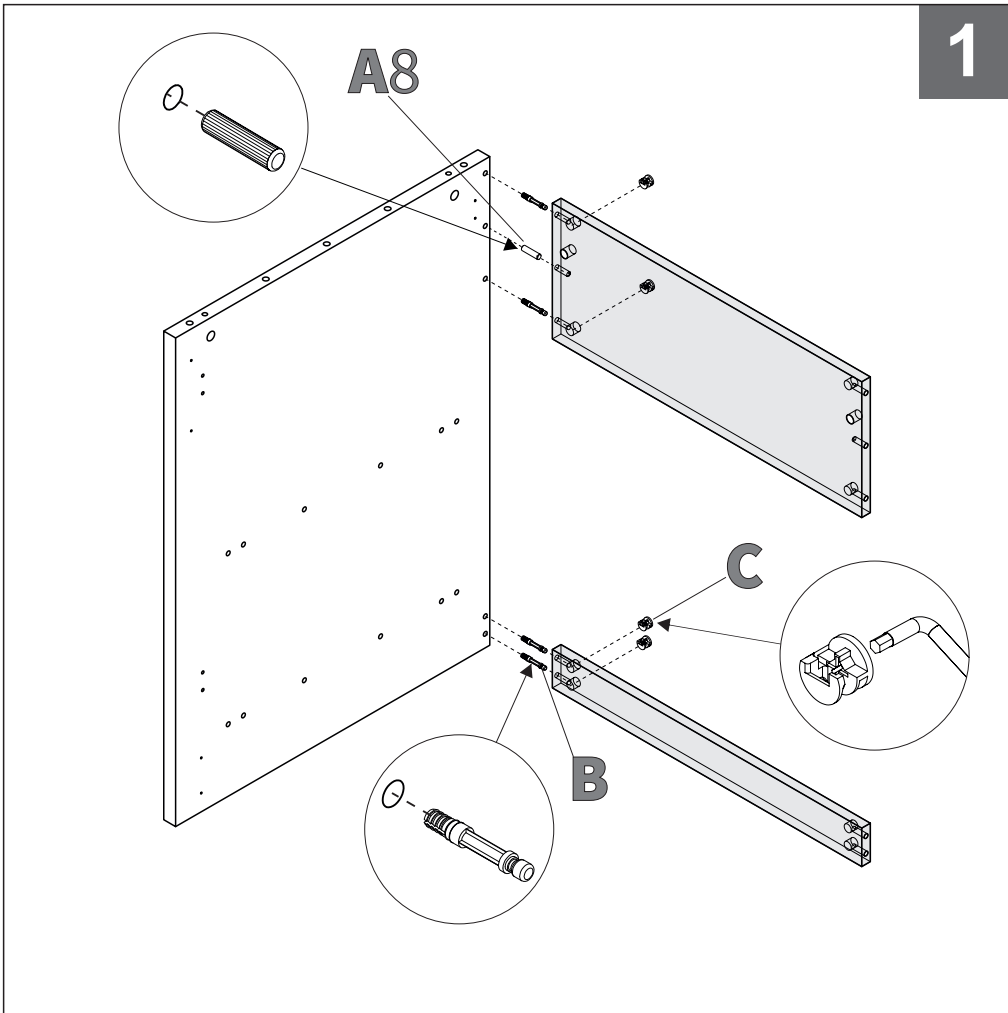

IT-Assemblaggio elementi base
 EN-Assembly base units elements
 FR-Assemblage des éléments de bases

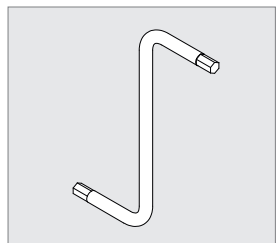
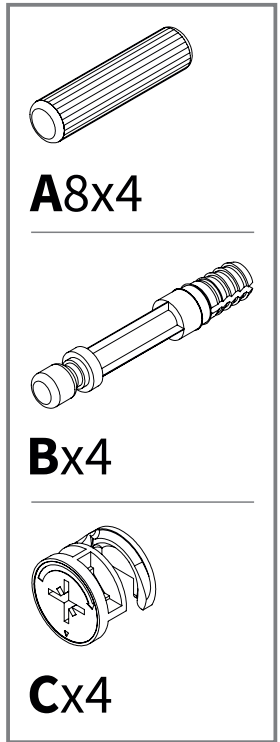
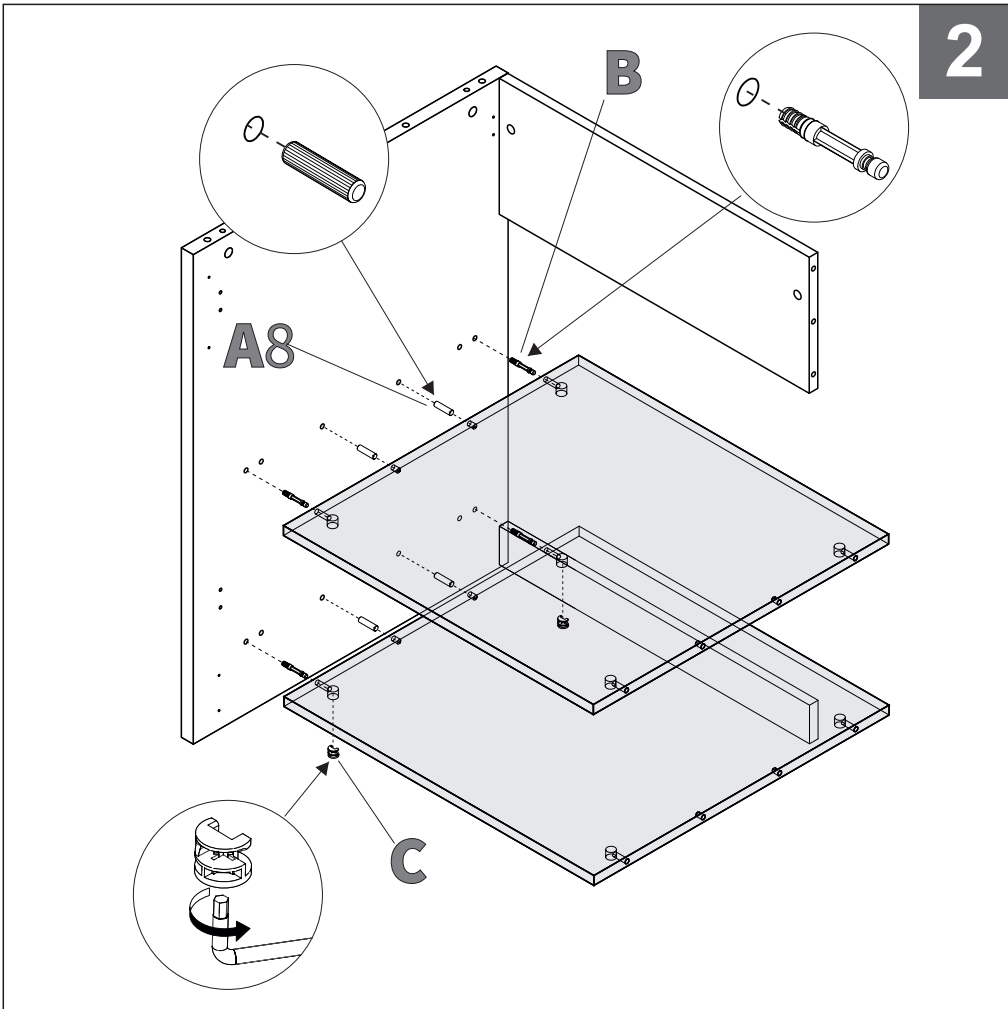
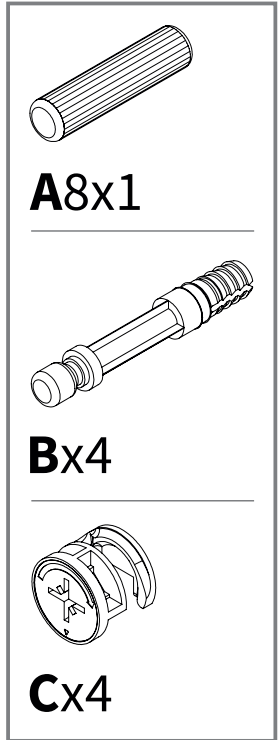

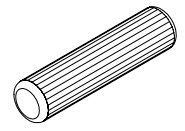
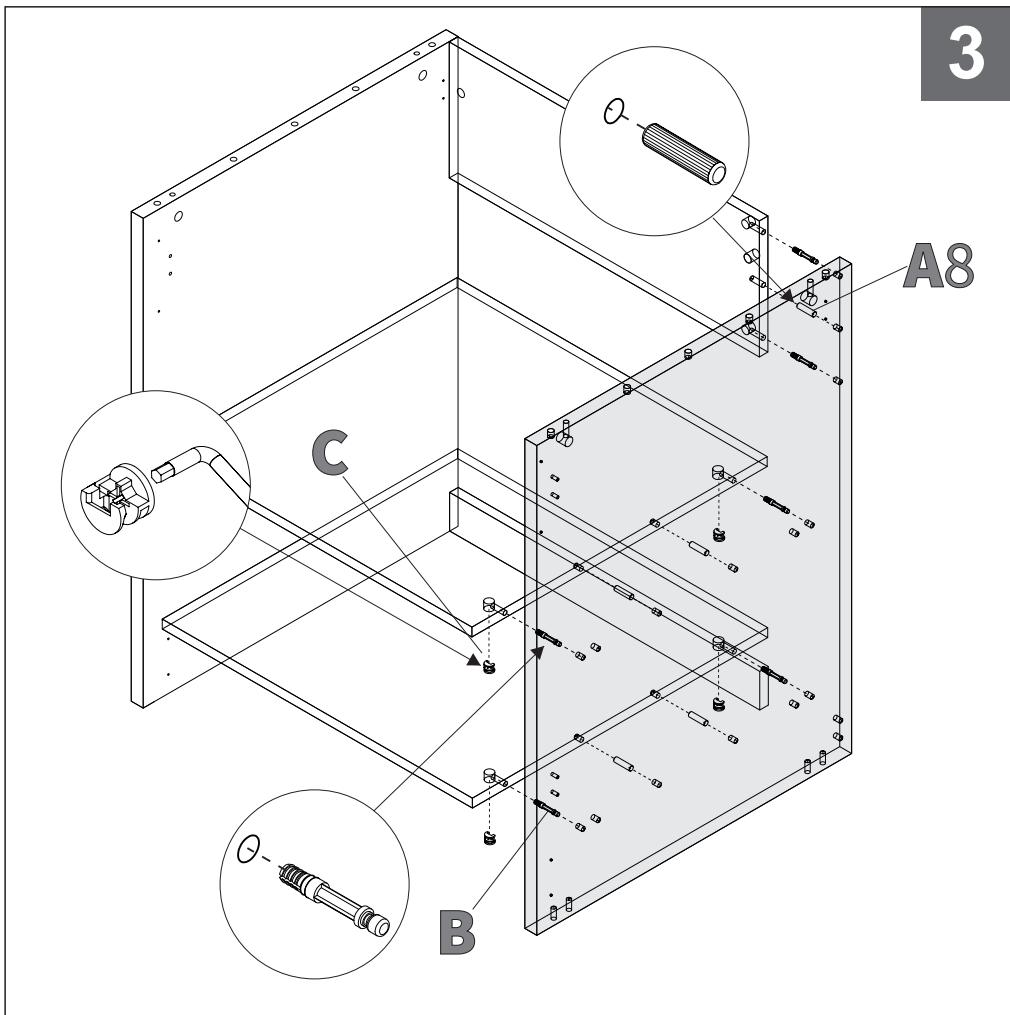

A8x5

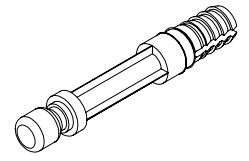

Bx6

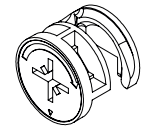

Cx6

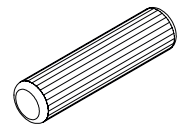
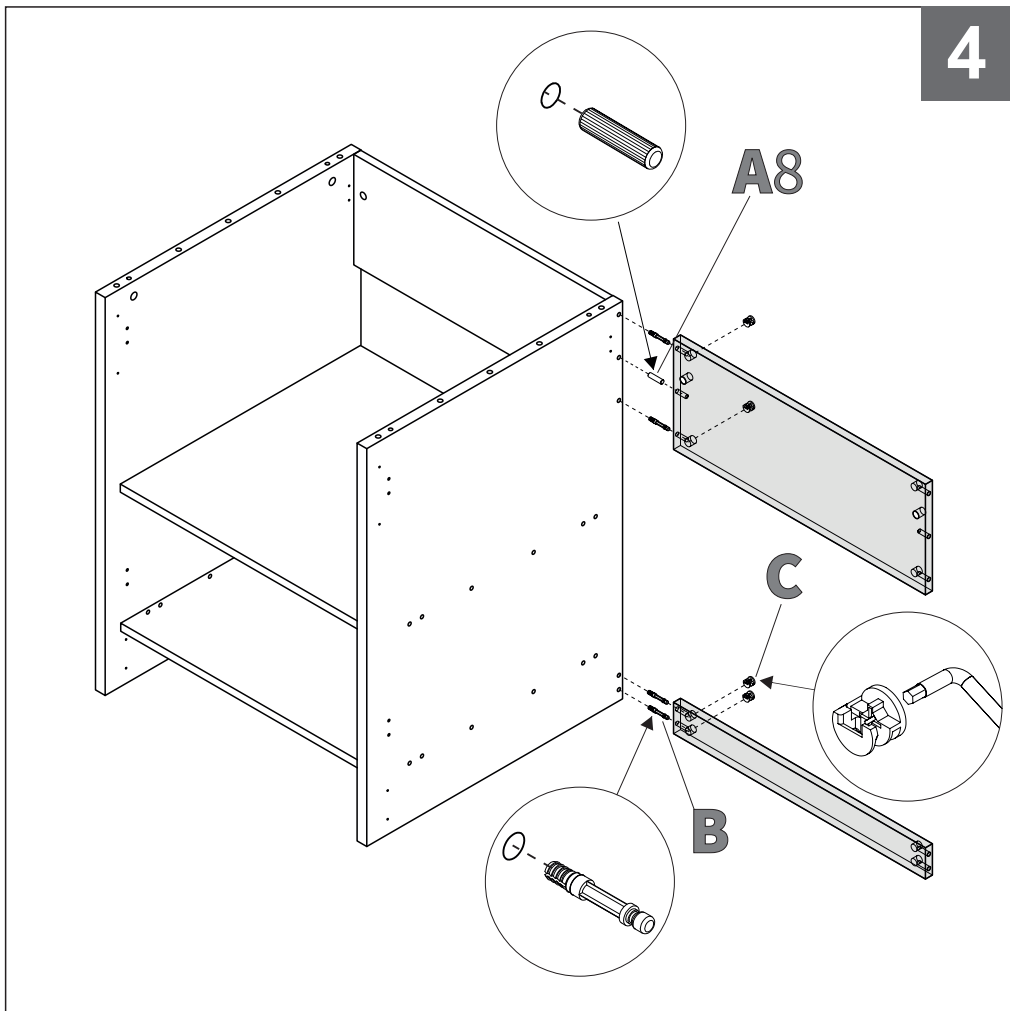
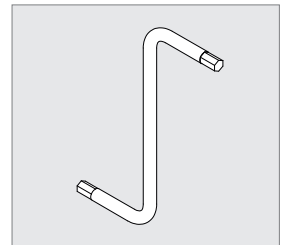

A8x1

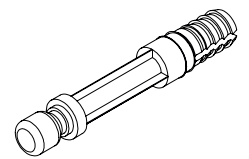

Bx4

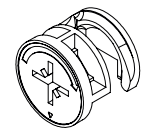

Cx4

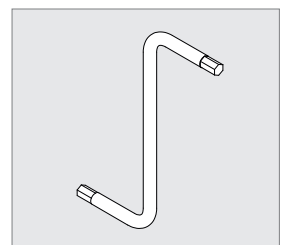

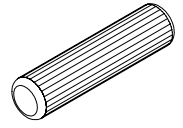
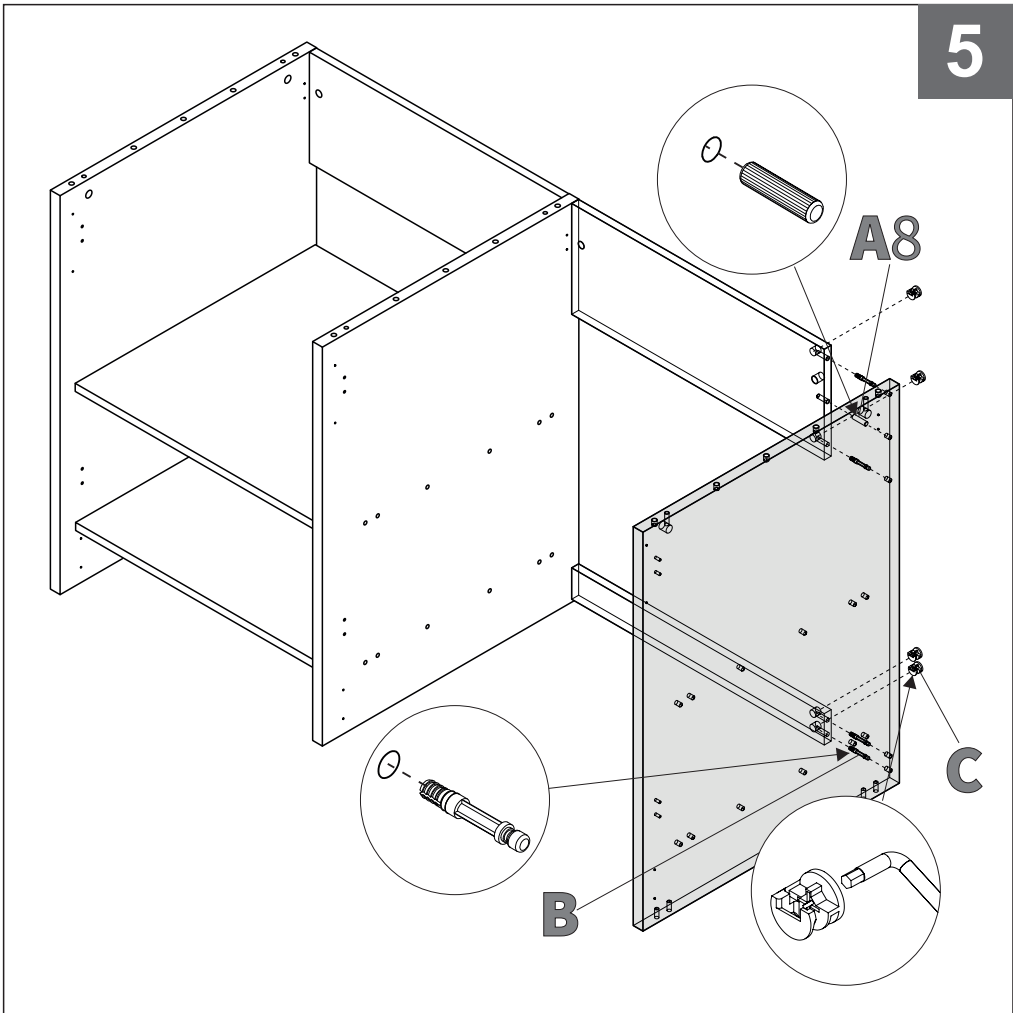

A8x5

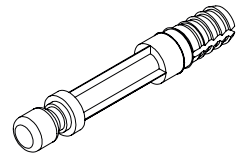

Bx6

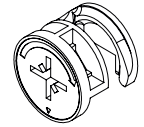

Cx6

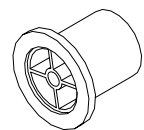
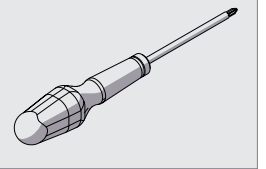
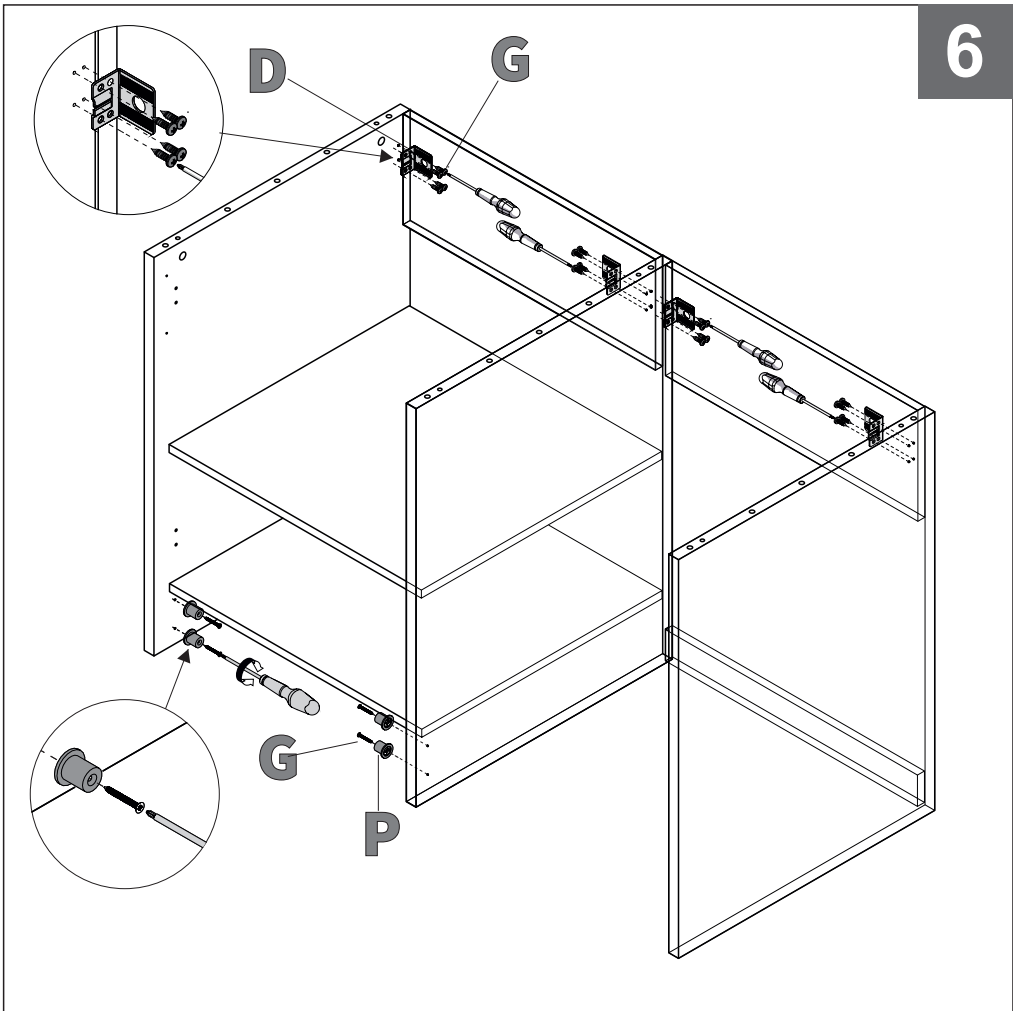
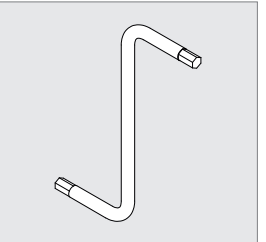

Px4

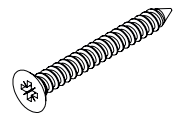

Qx4

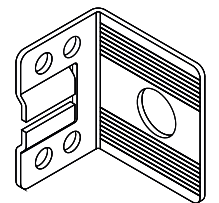

Dx4



Gx16

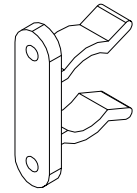
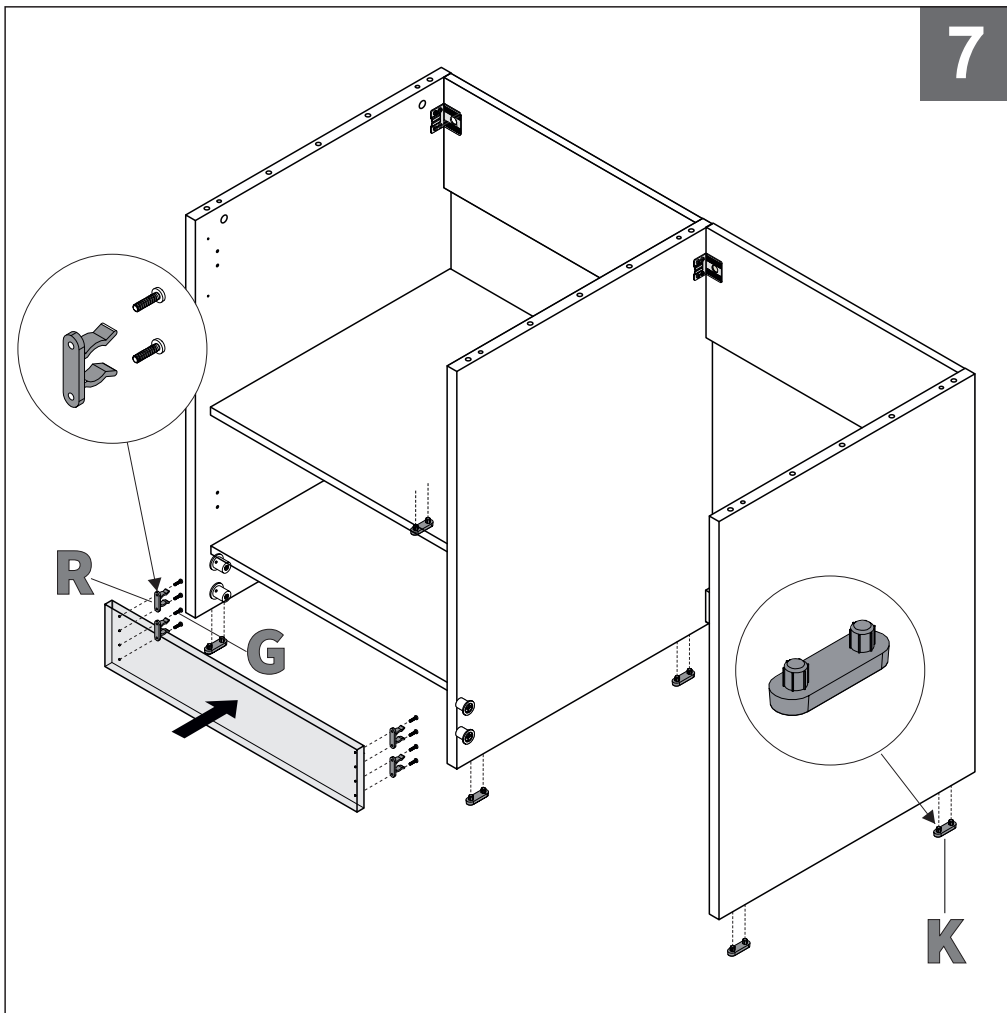

Rx4



Gx8

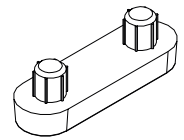

Kx4

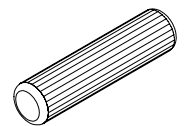
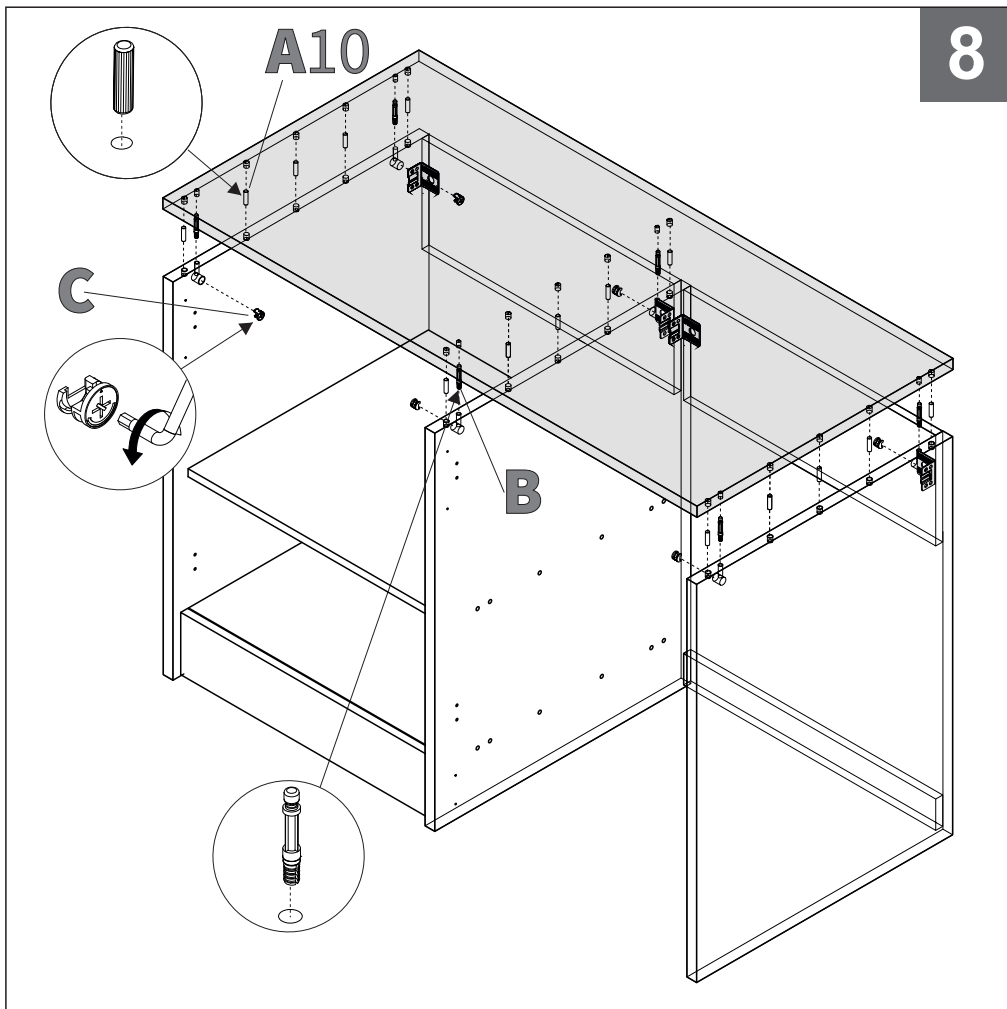
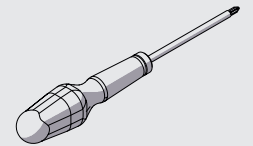

A10x15

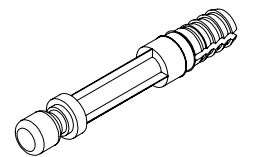

Bx6

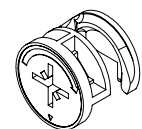

Cx6

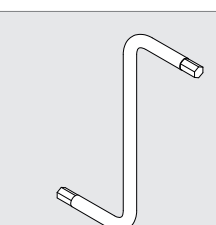

9a

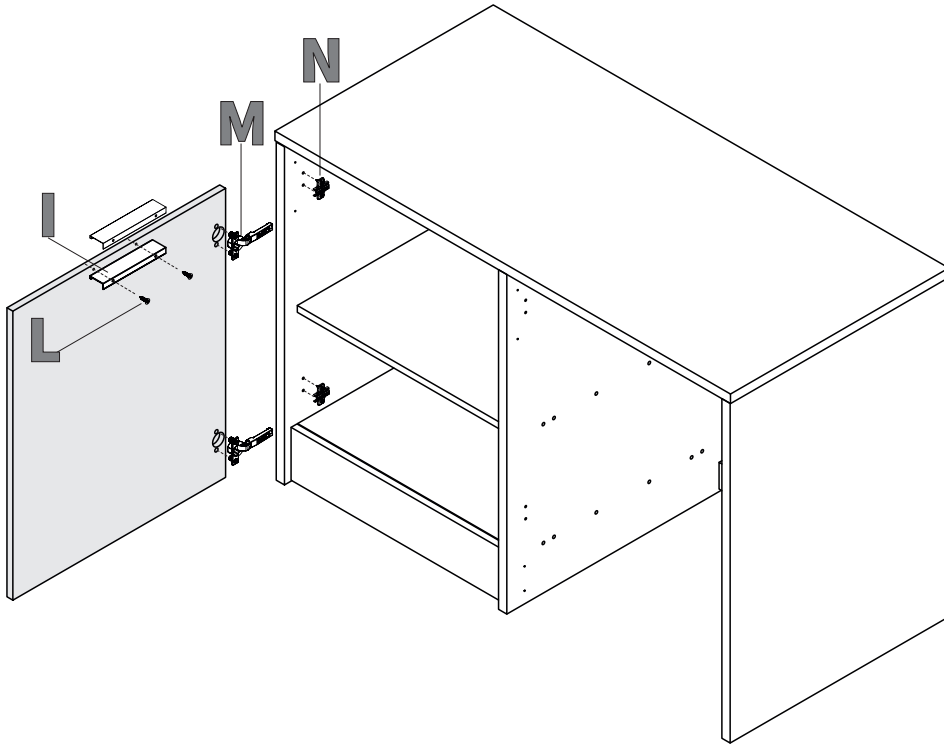

IT-Montaggio anta sx /EN- Door assembly lh/FR-Montage de porte gh

9b

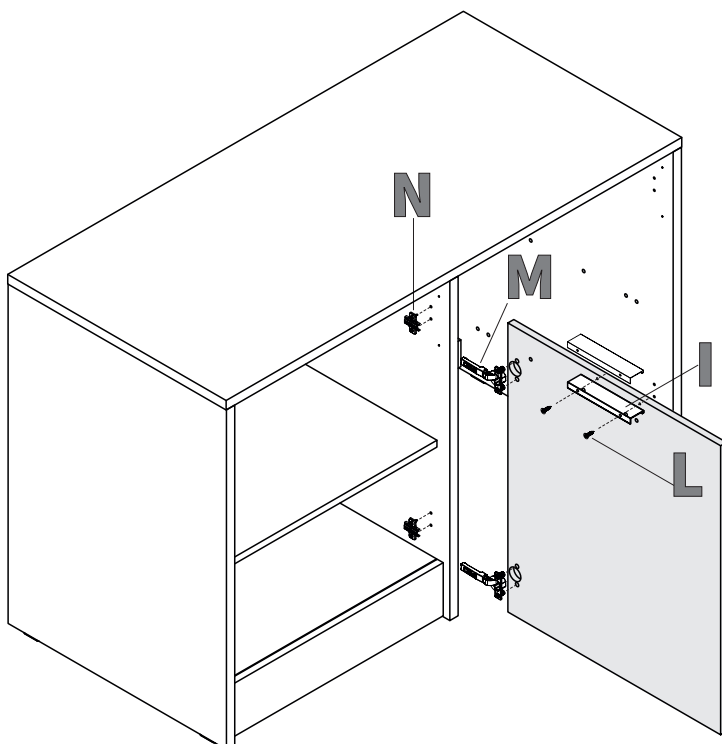

IT-Montaggio anta dx /EN- Door assembly rh/FR-Montage de porte dr

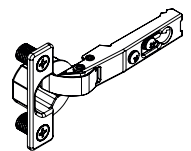

Mx2

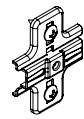

Nx2

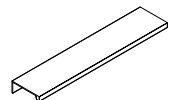

Lx1



Lx2

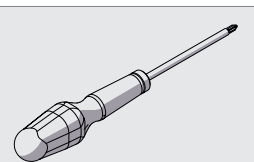

10a

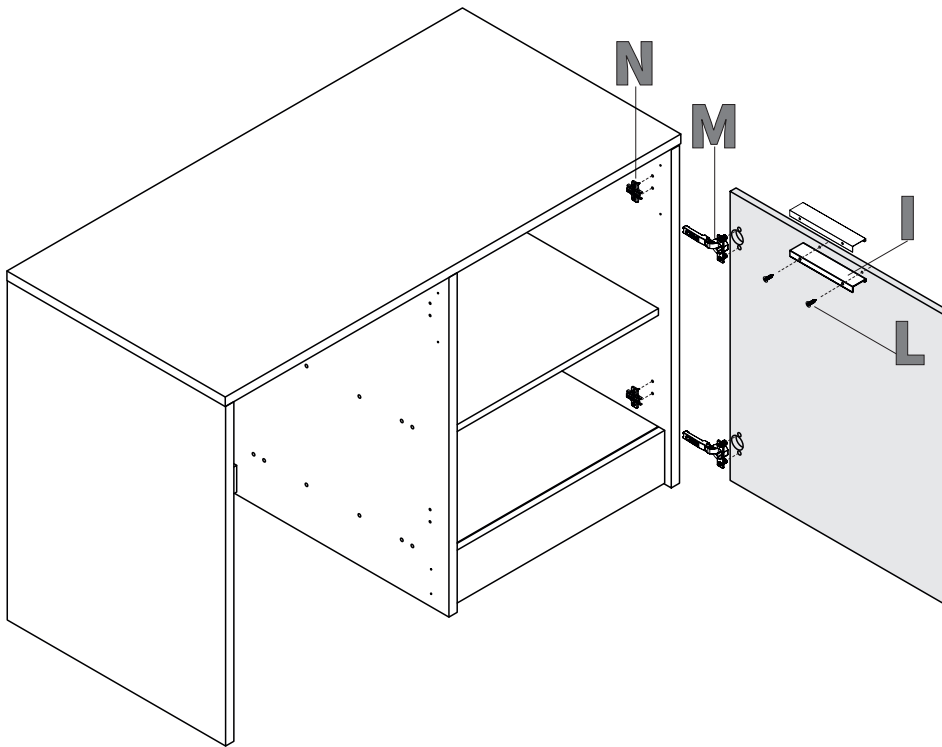

IT-Montaggio anta dx /EN- Door assembly rh/FR-Montage de porte dr

10b

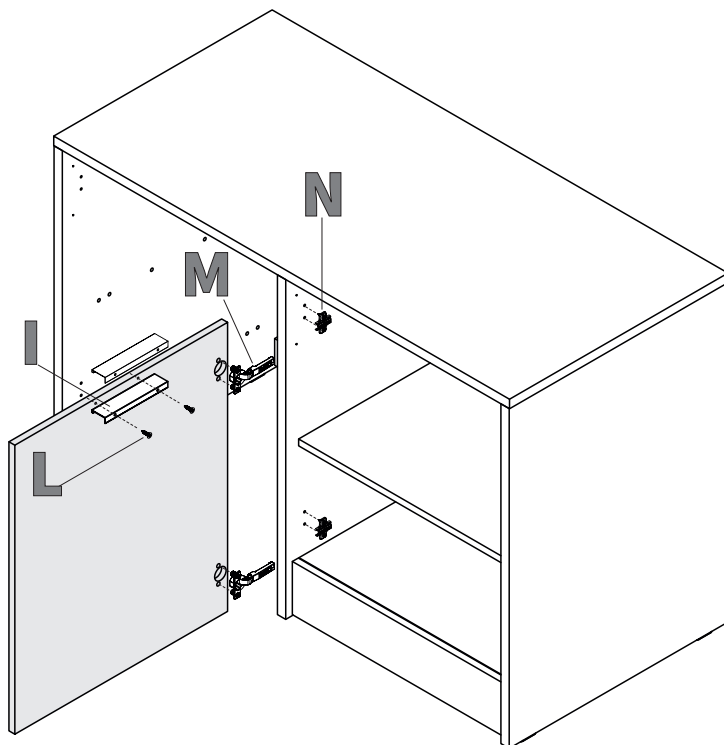

IT-Montaggio anta sx /EN- Door assembly lh/FR-Montage de porte gh

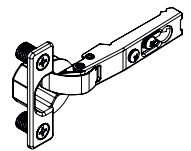

Mx2

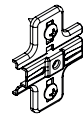

Nx2

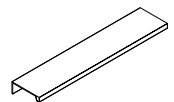

Ix1



Lx2

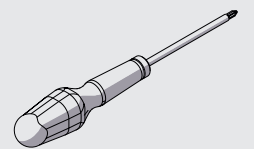

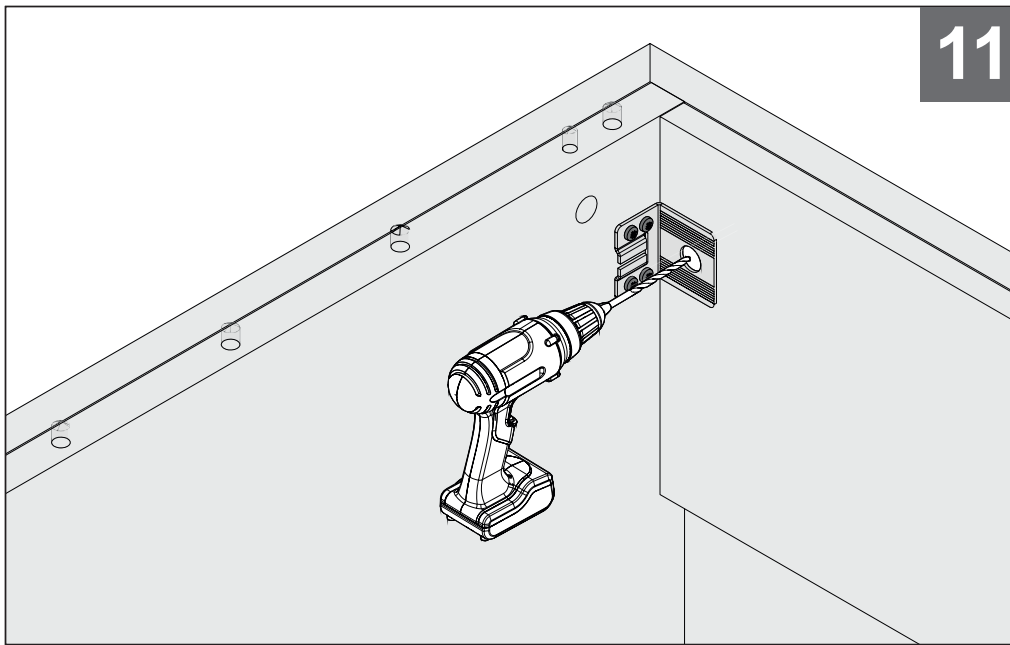

11

IT-Fissaggio base a parete
 EN-Fixing base unit to wall
 FR-Fixation de base au mur

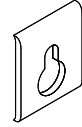

Ex2

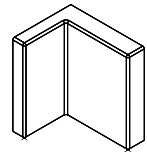

Fx2

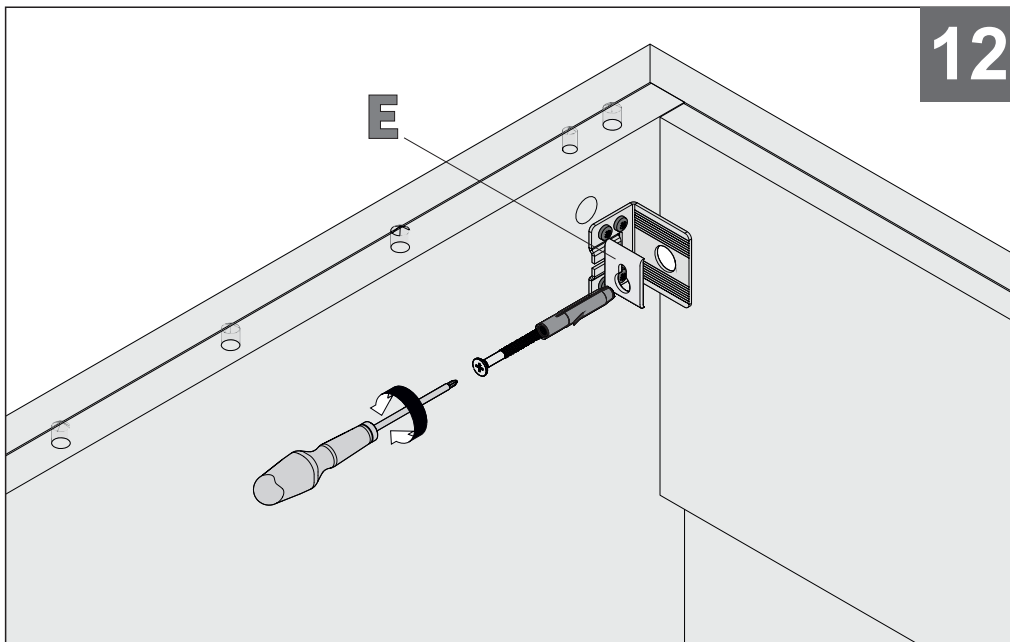

12

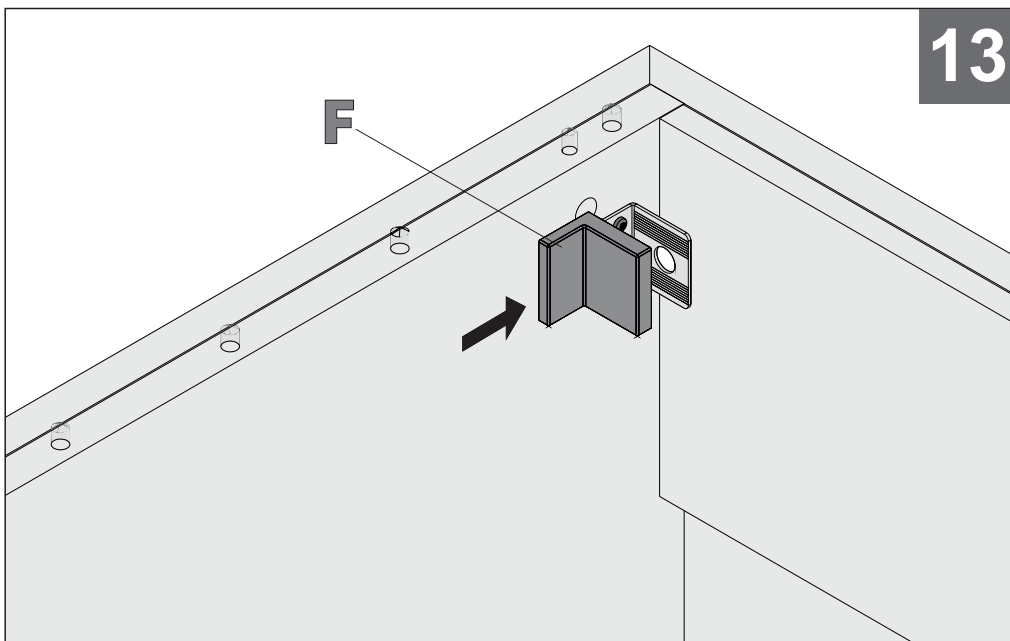
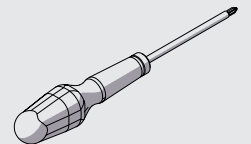
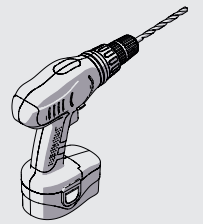

13

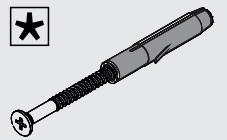

14

IT-Regolazione cerniere
EN-Hinges regulation
FR-Réglage des charnières

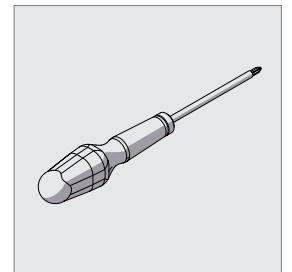
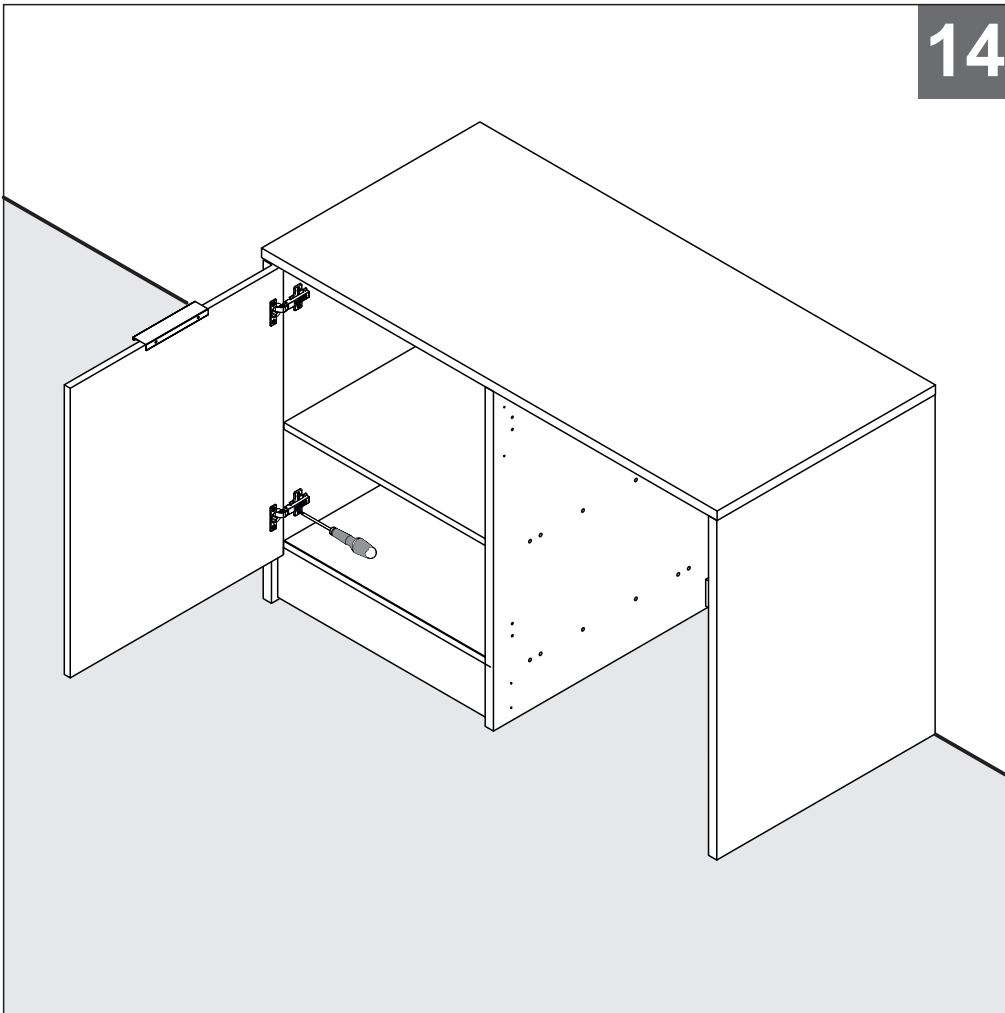

IT-Regolazione laterale
EN-Lateral adjustment
FR-Réglage latéral

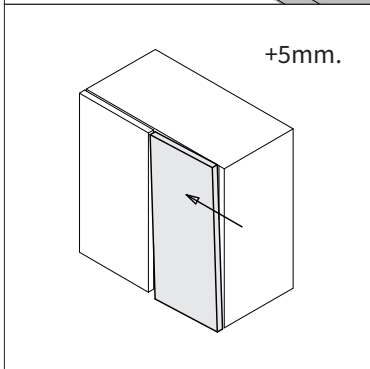
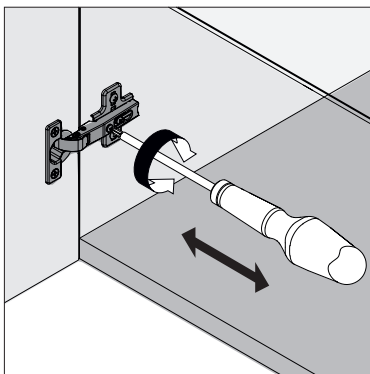

IT-Regolazione altezza
EN-Vertical adjustment
FR-Réglage en hauteur

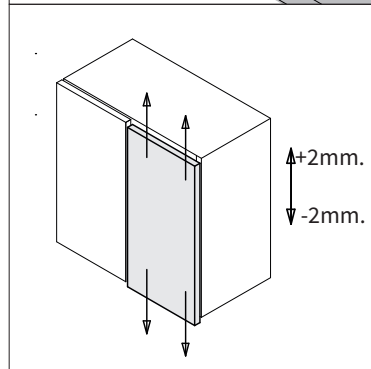
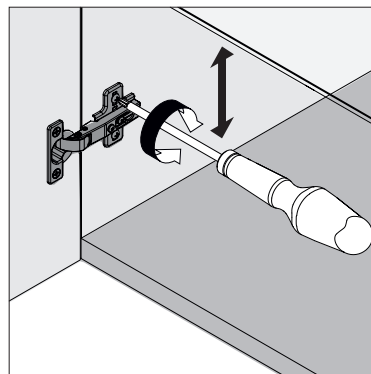

IT-Regolazione dell'inclinazione
EN-Inclination adjustment
FR-Réglage de l'inclinaison

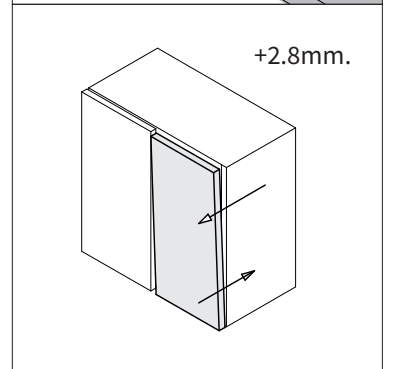
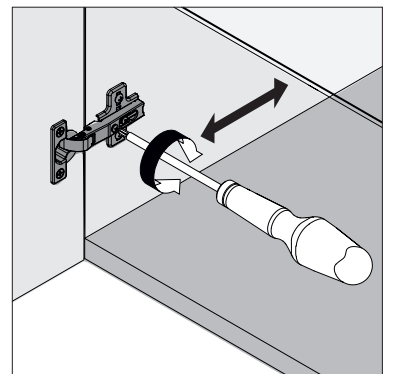

86670395

86670396

Position A/sx/lh/gh

Position B/dx/rh/dr

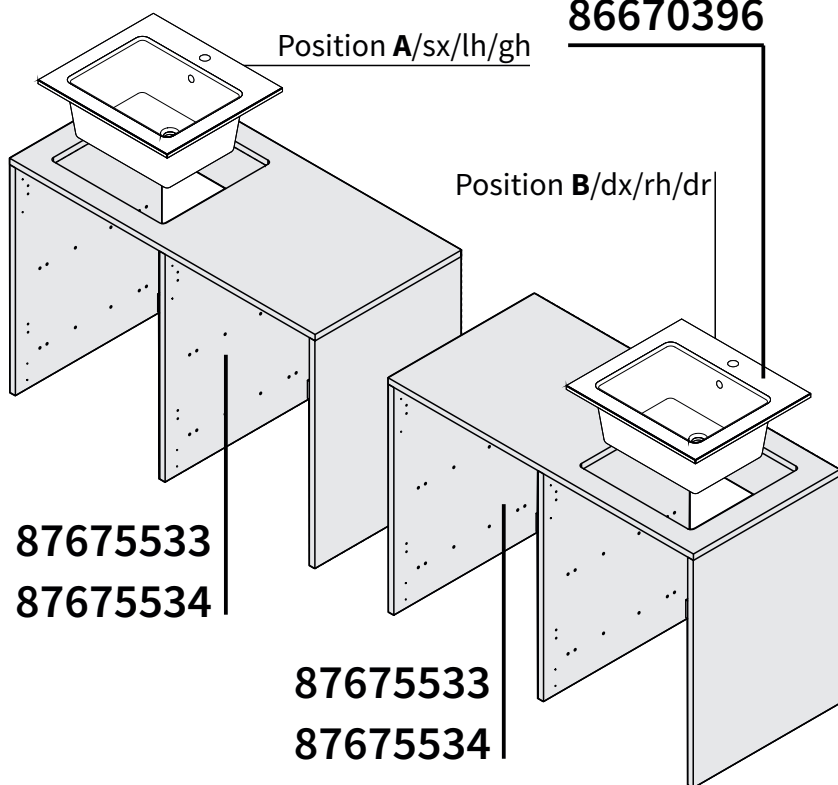

87675533

87675534

87675533

87675534

IT-Al fine di evitare il ribaltamento del mobile è obbligatorio il fissaggio dello stesso a parete tramite le apposite attaccaglie.

* Viti e tasselli (non inclusi) devono essere adeguati al tipo di materiale della vostra parete
EN-In order to avoid the furniture overturning, you have absolutely fix it to the wall through the appropriate attachments

* Screws and dowels (not included) must be suitable to the type of material of your wall
FR-Pour éviter tout risque de basculement, le meuble doit être absolument fixé au mur à l'aide des supports de fixation fournis

* Utiliser des vis et chevilles (non fournies) adaptées au type de matériaux de votre mur

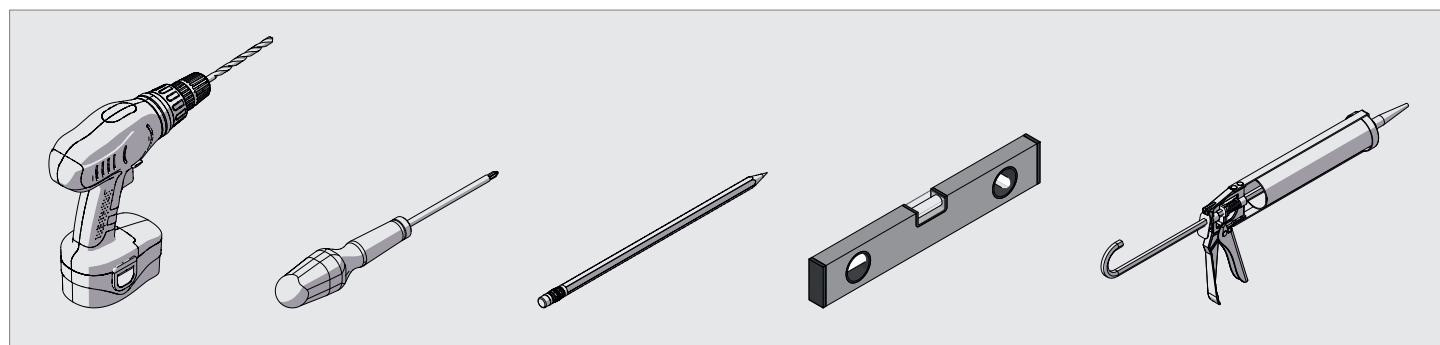

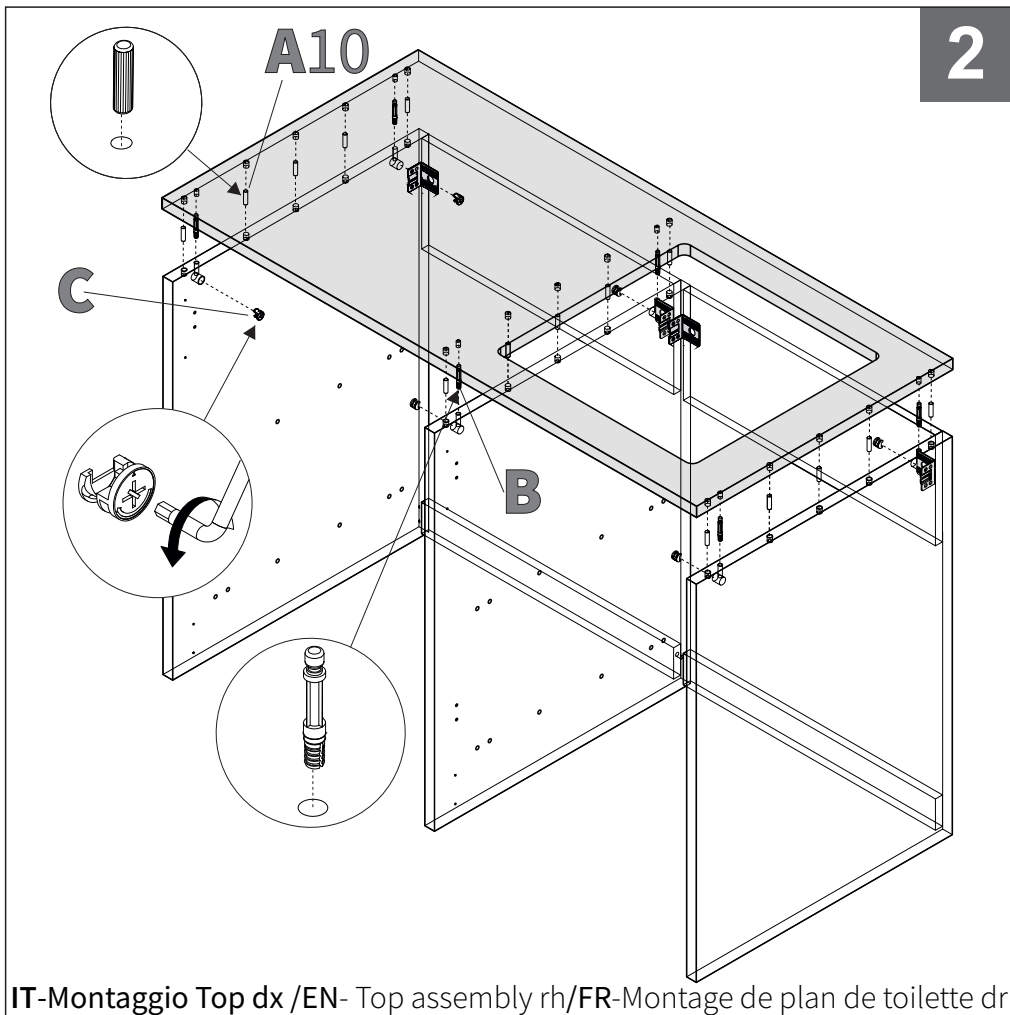
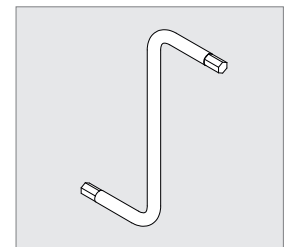
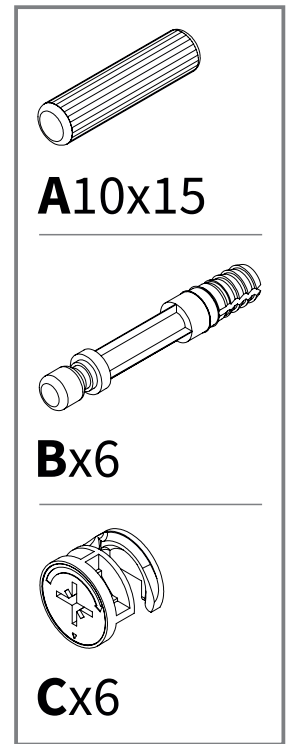
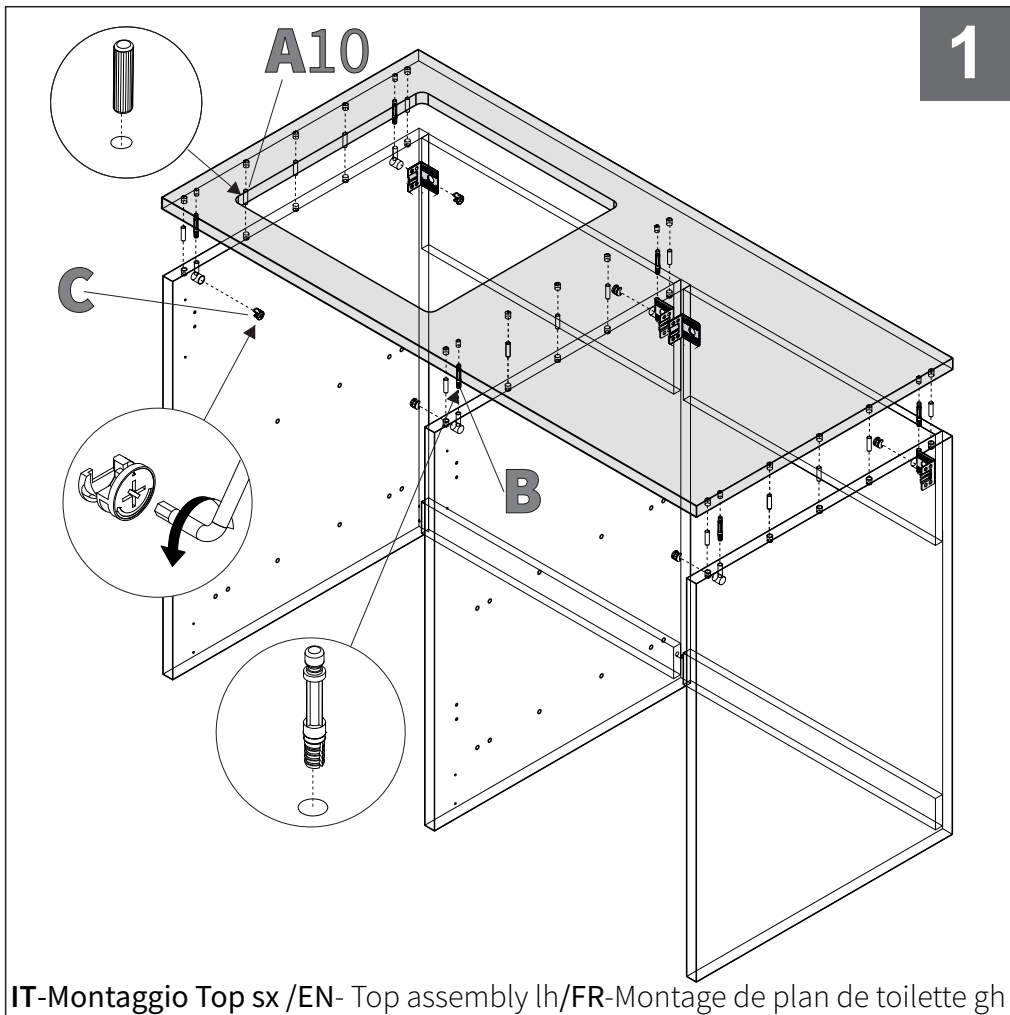

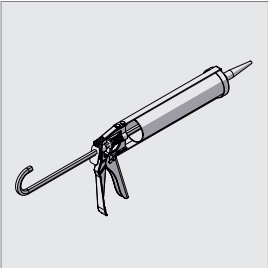
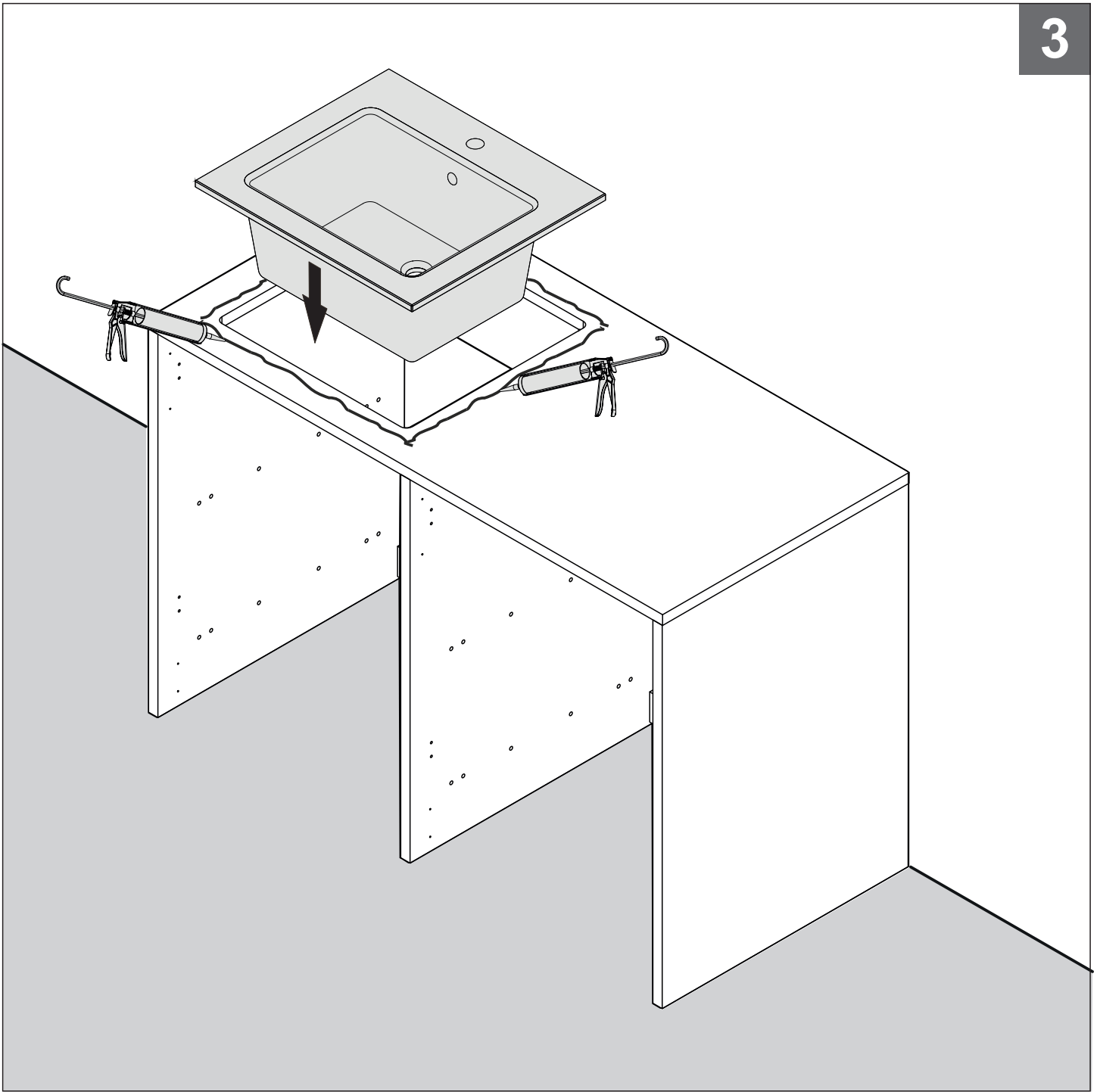

IT-Pulizia e manutenzione

EN-Cleaning and maintenance

FR-Nettoyage et entretien

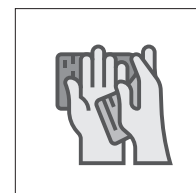
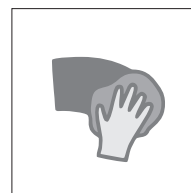

IT-Per la pulizia utilizzare esclusivamente detersivi al sapone e asciugare con un panno morbido. Non utilizzare detersivi abrasivi, corrosivi o contenenti agenti chimici, alcool, acidi o solventi. Evitare anche l'impiego di spugne abrasive, pagliette metalliche etc. che danneggerebbero irrimediabilmente le superfici del prodotto, compromettendone la lucentezza o la satinatura. In presenza di acque calcaree o aggressive asciugare dopo l'uso poiché i depositi potrebbero intaccare la superficie del prodotto.

EVITARE CHE L'ACQUA SCENDA E RISTAGNI SUL MOBILE; NEL CASO QUESTO ACCADA, ASCIUGARLO TEMPESTIVAMENTE.

EN-For cleaning use only soap detergents and dry with a soft cloth.

Do not use abrasive, corrosive or chemical agents, alcohol, acids or solvents.

Also avoid the use of abrasive sponges, metal scourers etc. that would irreparably damage the surfaces of the product, compromising the gloss or the satin finish.

In the presence of calcareous or aggressive waters, dry after use as deposits may affect the surface of the product.

DO NOT LET THE WATER COME DOWN AND STAND ON THE CABINET; IF THIS HAPPENS, DRY IT PROMPTLY.

FR-Pour le nettoyage utiliser seulement des détergents à base de savon et secher avec un chiffon doux. Ne pas utiliser de détergents abrasifs, corrosifs ou à base de produits chimiques, alcool, acides ou solvants.

Eviter aussi l'utilisation d'éponges abrasives, de produits à récurer etc.

qui endommageraient de façon permanente les surfaces du produit, en compromettant la finition brillante ou satinée.

En présence d'eaux calcaires ou agressives, secher après l'utilisation car les dépôts pourraient affecter la surface du produit.

EMPÊCHER L'EAU DE DESCENDRE ET DE STAGNER SUR LE MEUBLE ; SI CELA SE PRODUIT, SÉCHEZ-LE RAPIDEMENT.



FR

Donnez ou recyclez vos meubles.



Association

ou



Magasin

ou



Déchèterie

<https://quefairedemesdechets.fr>

PRODOTTO IN ITALIA
MADE IN ITALY
FABRIQUÉ EN ITALIE