

Step 1: Faucet installation

<p>1</p> <p>PURE HOT COLD</p> <p>PURE HOT COLD</p> <p>G3/8 Female</p>	<p>2</p> <p>10</p>	<p>3</p> <p>Ø35</p> <p>8 9 11</p>
<p>Put the part #7 to the bottom of the main body. And then Assemble the 3 flexible hose to the faucet by hand</p>	<p>Assemble the #10 threading pipe to the bottom body through the 3 inlet hose.</p>	<p>Put the faucet into the installation hole of the basin. Attach the #8 rubber gasket, the #9 steel gasket and the #11 brass nut from the bottom.</p>
<p>4</p> <p>2 3 4 5</p>	<p>5</p> <p>HOT COLD</p>	
<p>Assemble the #2/#3/#4/#5 to the faucet.</p>	<p>Connect the flexible hose to water supply valve(not included), and tighten it with adjustable wrench. DON'T OVER TIGHTENI. Caution: Make sure connect the hot and cold supply lines to the supply valves correctly. Warning: The supply valves are not included. Please purchase them in plumb-shop.</p>	

Step 2: Cleaning and care

Daily cleaning and care are required in order to keep the product shining and properly working.

1. Clean it with water and dry it with soft cloth.
2. Clean the product with gentle liquid or glass cleaner.
3. Don't use acid cleaner.
4. Don't clean with abrasive material, abrasive paper or knife.

Step 3: Parts list

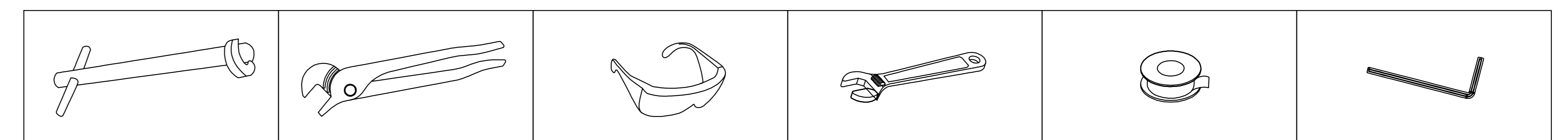
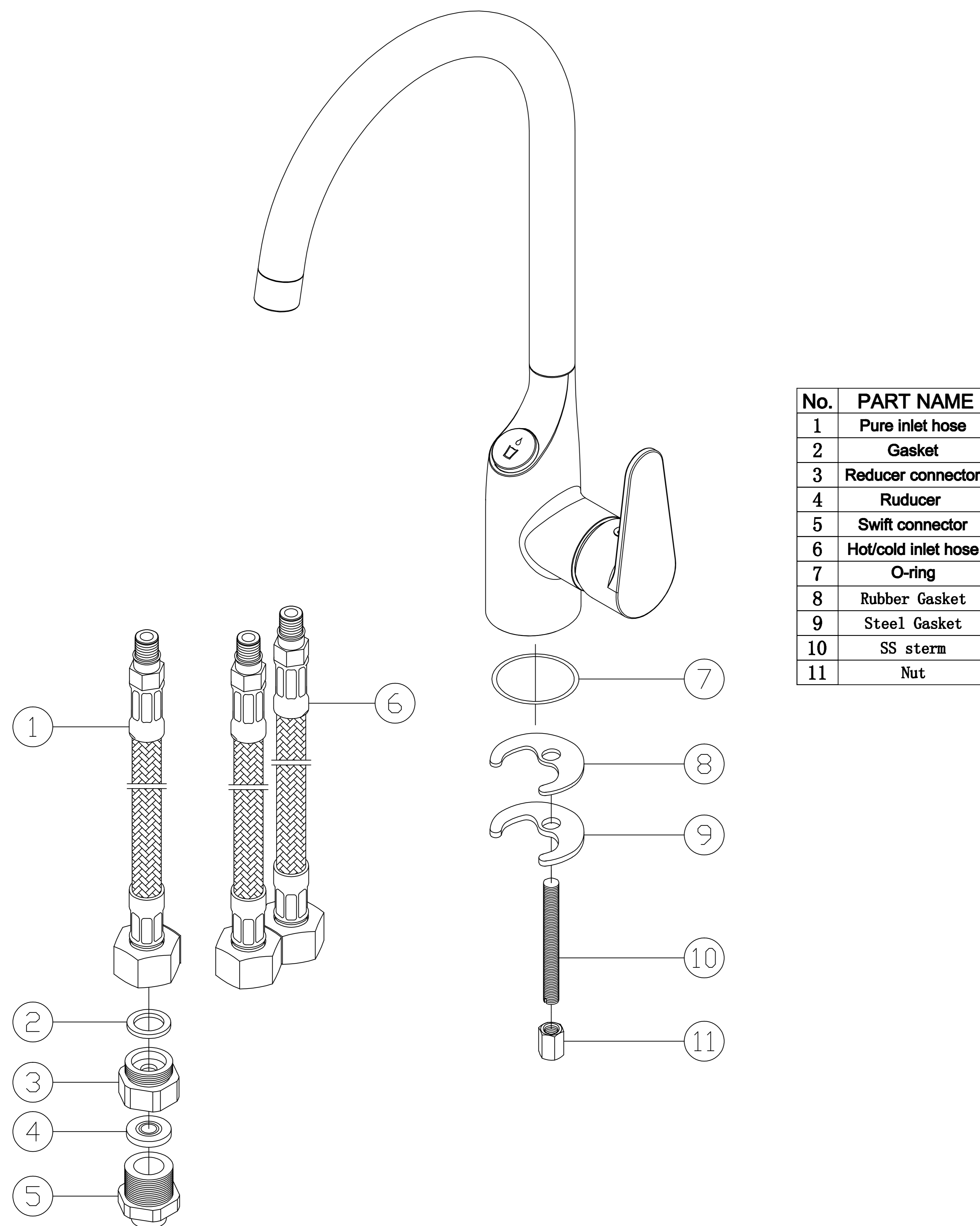

Attention:

For easy installation, you will need:

1. To read all the installation instruction completely before beginning.
2. To read all the warning, attention and maintenance information.
3. To purchase the proper supply lines.