

WARRANTY CERTIFICATE

PART TO BE COMPLETED BY THE CUSTOMER
CUSTOMER NAME/ADDRESS

SURNAME: _____
 NAME: _____
 STREET ADDRESS: _____
 POSTCODE: _____
 CITY/TOWN: _____
 PROVINCE: _____
 REGION/STATE: _____

PART TO BE COMPLETED BY THE AUTHORISED DEALER

DEALER'S STAMP AND SIGNATURE, AND DATE OF PURCHASE (*)

(*) the date of purchase must always be backed by proof of purchase (receipt or invoice)

PRODUCT PART NUMBER, MODEL AND SERIAL NUMBER (**)

(**) see the rating label applied to the water heater

Warranty certificate

TO BE COMPLETED, KEPT AND SHOWN WHEN REQUESTED BY AUTHORISED PERSONNEL. DO NOT POST THIS CERTIFICATE.

THE WARRANTY IS VALID IF:

- ENDORSED BY THE DEALER'S STAMP AND DULY COMPLETED AND SIGNED BY THE USER/OWNER.
- THE APPLIANCE FEATURES THE RATING LABEL INDICATING ITS TECHNICAL SPECIFICATIONS.
- THE APPLIANCE HAS NOT BEEN TAMPERED WITH BY UNAUTHORISED PERSONNEL.
- THE PRESSURE DOES NOT EXCEED 0.8 MPa
- THE APPLIANCE HAS BEEN EARTHED.
- **THE WARRANTY IS ONLY VALID IF THE ANODE IS REPLACED EVERY TWO YEARS.**

This warranty is valid for the number of years indicated on the rating label applied to the water heater from the **date of purchase**, and the number of years and months indicated on the rating label applied to the water heater from the **date of manufacture**, plus a further **6 months**. The warranty exclusively covers manufacturing defects, and therefore excludes all electrical parts, plastic parts and the safety and non-return valves. The warranty does not cover any fault parts following incorrect or improper installation, faults in the electrical system, insufficient water flow and any other causes not attributable to the company. The warranty does not cover any direct or indirect damage to people, animals or things due to faults on the appliance or having to interrupt operation. No parties are authorised to modify the terms of this warranty or issue other verbal or written guarantees. This warranty is only valid in Italy and only applies to the first purchaser/user. In the event of repairs to or replacement of the appliance, the warranty period is not extended beyond the original term. If the appliance is replaced, complete the new warranty certificate as follows:

- 1) Stamp the new certificate.
- 2) Send in the warranty certificate for the faulty appliance, plus a copy of the certificate for the replacement appliance.
- 3) On the new warranty certificate specify the remaining duration of the original warranty for the replaced water heater, in the special space. The company shall repair or replace any faulty parts as long as the appliance is delivered to the factory freight and duty paid, or with the call-out charge of our nearest service centre. Claims made under warranty do not afford the right to suspend payment for the goods.

Ferrolli SpA

Sede legale ed amministrativa: Via Ritonda, 78/A - 37047 San Bonifacio (Vr) - Tel. +39 045 6139411
www.ferrolli.com e-mail: info@ferrolli.it - export@ferrolli.it (international)

Fig.1

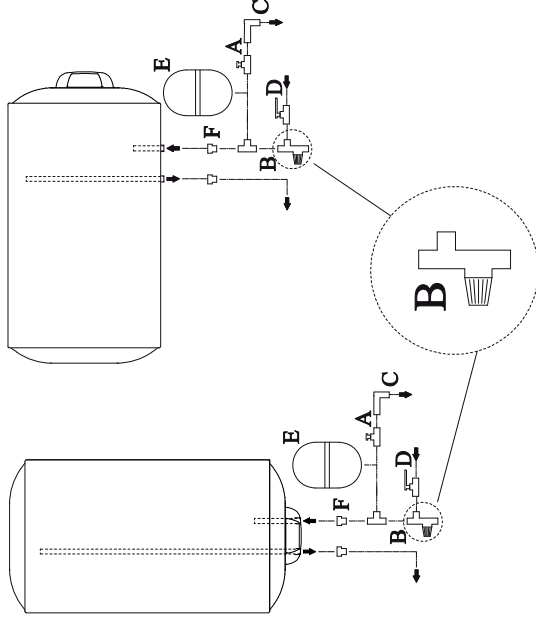

Fig.2

