

Manual de Instruções

Manual de Instrucciones

Manual de Istruções

Manual de Istruții

Instrukcja Obsługi

Istruzione d'uso

Manual de Instrucții

Instrucțiuni Manual

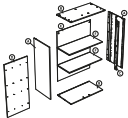







A



B



C

D



E

F





3



4



5

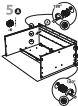

6

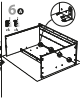



7

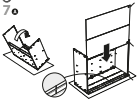



9





10e



11e



12e



13o



14o



15o



16o

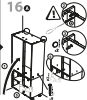



17-30 



17-35 

# 17

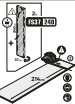

18



19

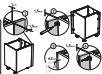

20

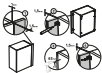

21

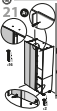

22



23

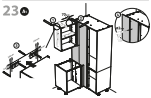





# 26



# i



# 27





28

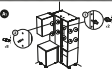

29

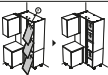

30

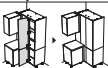

17

17





18



19



20





21

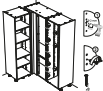



22

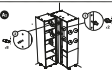

23

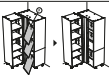

24

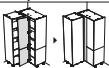



③

3



4



5

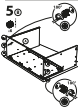

6

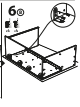

7

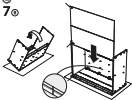



9



⑩

10⑧



⑨



11⑧



12⑧



13



14



15



16



i ⊕



↻ 17-30 ⊕



↻ 17-35 ⊕

17 ⊕



18

18

18



+

3.

FAS 77



19

19



+



H50



20

20



+



H50



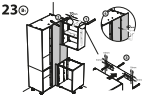
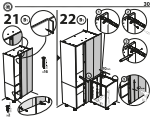

24

24

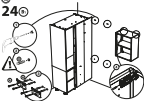

25

25

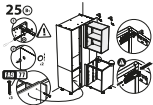

26

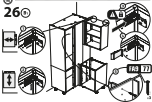

27

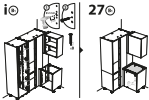

⑧

28 ⑧

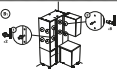

29 ⑧

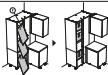

30 ⑧

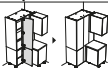

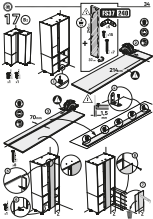

18

18

+

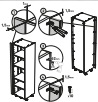

19



20





# 21

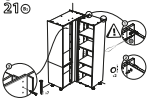

# 22

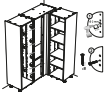

22

22

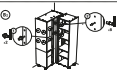

23

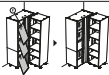

24

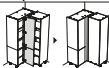





FR / IMPORTANT, À CONSERVER POUR CONSULTATION ULTÉRIEURE : À LIRE ATTENTIVEMENT\_ES / IMPORTANTE, CONSERVAR PARA CONSULTAR ULTERIOR: LEER ATENTAMENTE\_PT / IMPORTANTE CONSERVAR PARA FUTURAS CONSULTAS: POR FAVOR, LEIA COM ATENÇÃO\_IT / IMPORTANTE, DA CONSERVARE PER ULTERIORE CONSULTAZIONE: DA LEGGERE ATTENTAMENTE\_EL / IHMANTIKOI KPATHETE TO GIA MEΛANTIKH ANAGNΩΦA, & IABATE TO ΠΡΟΞΕΚΤΙΚΑ\_PL / WAŻNE, PRZECZYTAĆ UWAGAŃIE I ZACHOWAĆ NA PRZYSZŁOŚĆ\_RU / IMPORTANT, A SE PASTRA PENTRU CONSULTAREA ULTERIOARA: CITIȚI CU ATENȚIE\_EN / IMPORTANT, TO BE RETAINED FOR FUTURE REFERENCE: PLEASE READ CAREFULLY



- 1. Read carefully before use
- 2. Do not use if the seal is broken
- 3. Do not use if the expiry date has expired
- 4. Do not use if the product is damaged

- 5. Do not use if the product is expired
- 6. Do not use if the product is damaged
- 7. Do not use if the product is damaged
- 8. Do not use if the product is damaged
- 9. Do not use if the product is damaged
- 10. Do not use if the product is damaged

- 11. Do not use if the product is expired
- 12. Do not use if the product is damaged
- 13. Do not use if the product is damaged
- 14. Do not use if the product is damaged
- 15. Do not use if the product is damaged
- 16. Do not use if the product is damaged



- 17. No Alcohol
- 18. No Sugar
- 19. No Lactose
- 20. No Gluten
- 21. No Alcohol
- 22. No Sugar
- 23. No Lactose
- 24. No Gluten

© 2023 Nestlé • All Rights Reserved  
 Nestlé is a registered trademark of Nestlé  
 and other marks are the property of their respective owners.

Imported by Nestlé South Africa (Pty) Ltd, 1st Floor, 100, Main Road, Durban, KwaZulu-Natal, South Africa  
 Tel: +27 31 5400000 | Email: [contact@nestle.co.za](mailto:contact@nestle.co.za)

