

Manual | Istruzioni

Manual de Instrucciones

Manual de Instruções

Manualul Instrucțiilor

Instrukcja Obsługi

Instruções de Montagem

Manual de Instrucții

Instrucțiuni Manual









A



B



C

C



D

D







**3**



**4**

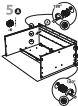

**5**

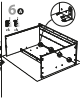

**6**



7

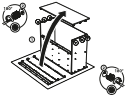
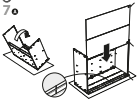



9





10e



11e



12e



13o



14o



15o



16o

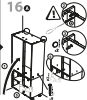



17-30 

17-35 

# 17

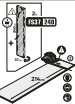

18



19

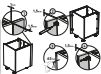

20

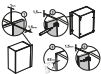

21

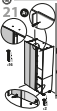

22



23

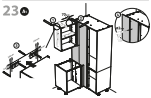



26

26

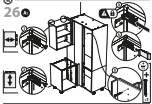

i

27

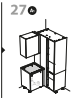



28

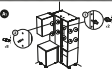

29

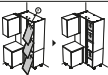

30

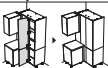

17



18



19



20

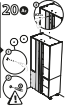



21

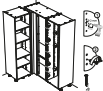



22

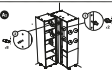

23

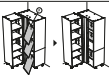

24

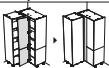

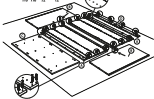
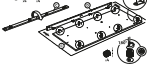
**1**

**2**

③

3



4



5

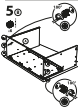

6

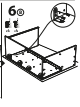

7 ⑧

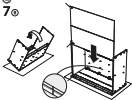



9



⑩

10⑧



⑨



11⑧



12⑧



13 Ⓢ



14 Ⓢ



15 Ⓢ



16 Ⓢ

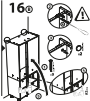



i ⑩



17-30 ⑪



17-35 ⑫

17 ⑬



⑧

18 ⑧



19 ⑧



20 ⑧



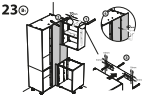
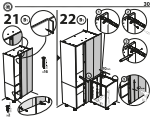

24

24

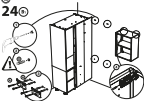

25

25

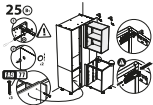

26

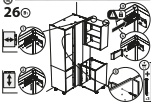

27

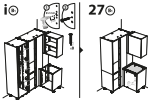

28

28

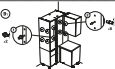

29

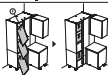

30

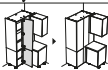

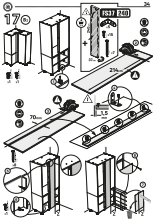

18

18

18

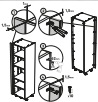

19



20



21

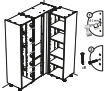

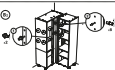

22

22

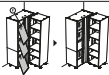

23



24

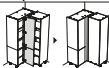





FR / IMPORTANT, À CONSERVER POUR CONSULTATION ULTÉRIEURE : À LIRE ATTENTIVEMENT\_ES / IMPORTANTE, CONSERVAR PARA CONSULTAR ULTERIOR: LEER ATENTAMENTE\_PT / IMPORTANTE CONSERVAR PARA FUTURAS CONSULTAS: POR FAVOR, LEIA COM ATENÇÃO\_IT / IMPORTANTE, DA CONSERVARE PER ULTERIORE CONSULTAZIONE: DA LEGGERE ATTENTAMENTE\_EL / IHMANTIKOI KPATHETE TO GIA MEΛANTIKH ANAGNΩΦA, & IABATE TO ΠΡΟΞΕΚΤΙΚΑ\_PL / WAŻNE, PRZECZYTAĆ UWAGNIE I ZACHOWAĆ NA PRZYSZŁOŚĆ\_RU / IMPORTANT, A SE PASTRA PENTRU CONSULTAREA ULTERIOARA: CITIȚI CU ATENȚIE\_EN / IMPORTANT, TO BE RETAINED FOR FUTURE REFERENCE: PLEASE READ CAREFULLY



- 1. Read carefully before use
- 2. Do not use if the seal is broken
- 3. Do not use if the expiry date has expired
- 4. Do not use if the product is damaged

- 5. Do not use if the product is expired
- 6. Do not use if the product is damaged
- 7. Do not use if the product is damaged
- 8. Do not use if the product is damaged
- 9. Do not use if the product is damaged
- 10. Do not use if the product is damaged

- 11. Do not use if the product is expired
- 12. Do not use if the product is damaged
- 13. Do not use if the product is damaged
- 14. Do not use if the product is damaged
- 15. Do not use if the product is damaged
- 16. Do not use if the product is damaged



- 17. No Alcohol
- 18. No Sugar
- 19. No Lactose
- 20. No Gluten
- 21. No Alcohol
- 22. No Sugar
- 23. No Lactose
- 24. No Gluten

© 2023 Nestlé • All Rights Reserved  
 Nestlé is a registered trademark of Nestlé  
 and other marks are the property of their respective owners.

Imported by Nestlé South Africa (Pty) Ltd, 1st Floor, 100, Main Road, Durban, KwaZulu-Natal, South Africa  
 Tel: +27 31 4400000 | Email: contact@nestle.co.za

