

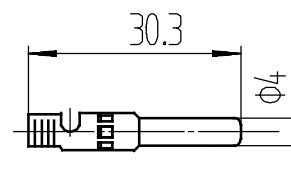

Item	Model No	Picture	Specification
NO.1	MC4D	A photograph showing several MC4D electrical connectors. There are two long, black, cylindrical connectors with red and black pins protruding from one end. There are also two shorter, black, cylindrical connectors with red and black pins protruding from one end. The connectors are arranged in a cluster.	<p>1.Contact: Tin-plated copper</p> <hr/> <p>2.Waterproof: IP67</p> <hr/> <p>3.Housing material: 100% GE PPO.</p> <hr/> <p>4. Rated Voltage: TUV1500V DC</p> <hr/> <p>5.pin Dimension: 4.0mm</p> <hr/> <p>6.Temperature Range: -40°C~+90°C</p> <hr/> <p>7.Flame Class:UL94V-0</p> <hr/> <p>8.Resistance: $\leq 5\text{m}\Omega$</p> <hr/> <p>9.Pollution degree:2</p> <hr/> <p>10.Protection Class: Class II</p>

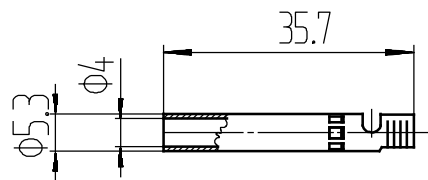
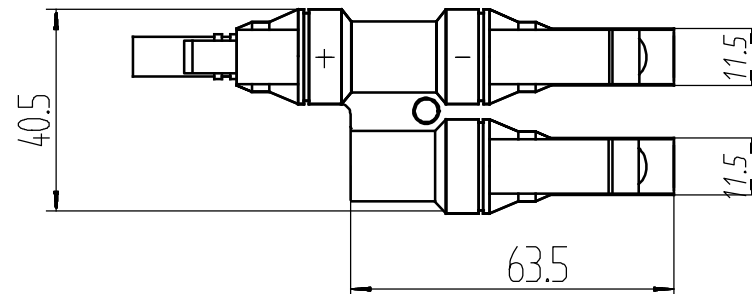
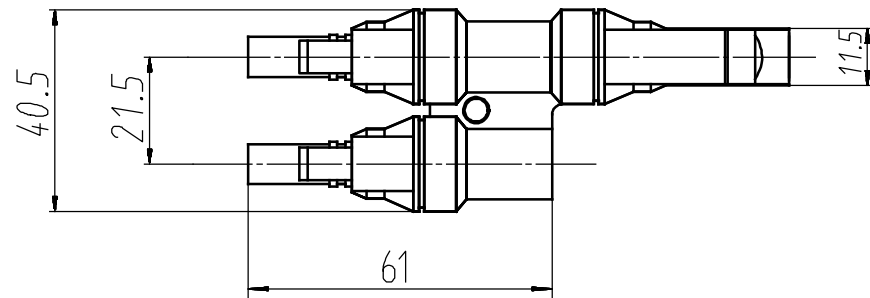

LQ-1T