

# ECS6-550 (6V550Ah)

## Especificaciones

|                                       |  |
|---------------------------------------|--|
| Voltaje                               | 6V   |
| Capacidad (20Hr)                      | 450 AH   |
| Tamaño                                | Largo 295±2mm (11.62inches)<br>Ancho 180±2mm (7.05inches)<br>Altura del contenedor 406±2mm (15.92inches)<br>Altura total 428±2mm (16.71inches)   |
| Peso                                  | 57kg aprox (125lbs)  |
| Terminal                              | T5/DT  |
| Material del contenedor               | ABS  |
| Capacidad                             | 550.0A/4.6A (100hr, 1.80V/Cell, 25°C/77°F)<br>450.0A/20.0A (20hr, 1.80V/Cell, 25°C/77°F)<br>380.0A/38.0A (10hr, 1.80V/Cell, 25°C/77°F)<br>345.0A/69.0A (5hr, 1.75V/Cell, 25°C/77°F)<br>270.0A/90.0A (3hr, 1.75V/Cell, 25°C/77°F)<br>210.0A/210A (1hr, 1.60V/Cell, 25°C/77°F) |
| Corriente de descarga máx.            | 3000A (5s)   |
| Resistencia interna                   | 2.0mΩ aprox.   |
| Rango de temp. operativa              | Descarga: -20~55°C (-4~131°F)<br>Carga: 0~40°C (32~104°F)<br>Almacenamiento: -20~50°C (-4~122°F)   |
| Rango de temp. operativa nominal      | 25± 3°C (77±5°F)   |
| Carga en absorción                    | Corriente de carga inicial menor que 83.0A.<br>7.2~7.5 a 25°C (77°F) Coef. Temp. -15mV/°C  |
| Carga en flotación                    | Sin límite de corriente de carga inicial.<br>6.75~6.9 a 25°C (77°F) Coef. Temp. -15mV/°C   |
| Capacidad afectada por la temperatura | 40°C (104°F) 100%<br>25°C (77°F) 100%<br>0°C (32°) 86%   |
| Autodescarga                          | Las baterías NPM se pueden almacenarse hasta 10 meses a 25°C (77°F) y luego hacer una carga de renovación. A temperaturas más altas, el intervalo de tiempo será más corto.  |

**ecobat**  
BATTERY



## Aplicaciones

- ◆ Ferrocarril y sistemas marítimos
- ◆ Herramientas eléctricas
- ◆ Vehículos de movilidad personal
- ◆ Cortadoras de césped
- ◆ Carritos de golf
- ◆ Juguetes electrónicos
- ◆ Energía portátil
- ◆ Sillas de ruedas
- ◆ Equipamiento médico
- ◆ Solar / Eólico



ISO9001 ISO14001

### Corriente de descarga constante (amperios) a 25°C (77°F)

| F.V/Time   | 15min | 20min | 30min | 45min | 1h    | 2h    | 3h    | 4h   | 5h   | 6h   | 8h   | 10h  | 20h  |
|------------|-------|-------|-------|-------|-------|-------|-------|------|------|------|------|------|------|
| 1.85V/cell | 412.0 | 370.8 | 306.7 | 243.2 | 199.6 | 119.9 | 92.7  | 76.1 | 64.8 | 56.6 | 45.6 | 38.2 | 20.3 |
| 1.80V/cell | 468.0 | 412.8 | 329.1 | 255.9 | 212.0 | 126.5 | 97.2  | 79.5 | 67.5 | 59.1 | 47.4 | 40.0 | 21.0 |
| 1.75V/cell | /     | 445.0 | 348.5 | 269.0 | 221.2 | 131.7 | 100.8 | 82.2 | 69.6 | 60.5 | 48.3 | 40.4 | 21.2 |
| 1.70V/cell | /     | 475.9 | 365.7 | 279.2 | 228.9 | 135.6 | 103.5 | 84.0 | 70.8 | 61.6 | 49.0 | 40.8 | 21.4 |
| 1.65V/cell | /     | /     | 383.6 | 291.3 | 237.2 | 139.7 | 105.7 | 85.8 | 72.3 | 62.7 | 49.7 | 41.3 | 21.7 |
| 1.60V/cell | /     | /     | 396.8 | 299.2 | 242.8 | 143.0 | 108.0 | 87.0 | 73.4 | 63.5 | 50.4 | 41.8 | 21.9 |

### Potencia de descarga constante (Wattios) a 25°C (77°)

| F.V/Time   | 15min | 20min | 30min | 45min | 1h    | 2h    | 3h    | 4h    | 5h    | 6h    | 8h   | 10h  | 20h  |
|------------|-------|-------|-------|-------|-------|-------|-------|-------|-------|-------|------|------|------|
| 1.85V/cell | 780.1 | 705.3 | 586.2 | 467.6 | 386.1 | 233.2 | 181.1 | 149.3 | 127.7 | 111.8 | 90.5 | 76.0 | 40.3 |
| 1.80V/cell | 874.8 | 776.9 | 623.9 | 488.7 | 407.8 | 244.9 | 189.1 | 155.4 | 132.4 | 116.4 | 93.7 | 79.4 | 41.7 |
| 1.75V/cell | /     | 827.8 | 655.6 | 510.9 | 423.6 | 254.0 | 195.6 | 160.1 | 136.0 | 118.8 | 95.2 | 80.1 | 42.1 |
| 1.70V/cell | /     | 877.8 | 682.2 | 526.4 | 436.1 | 260.4 | 200.0 | 163.0 | 138.0 | 120.7 | 96.6 | 80.9 | 42.5 |
| 1.65V/cell | /     | /     | 710.2 | 546.3 | 449.3 | 267.1 | 203.5 | 165.9 | 140.4 | 122.4 | 97.8 | 81.8 | 43.0 |
| 1.60V/cell | /     | /     | 727.3 | 555.8 | 456.7 | 271.7 | 206.7 | 167.5 | 141.9 | 123.7 | 98.8 | 82.6 | 43.4 |

## EDC6-550 (6V550Ah)

### Dimensiones

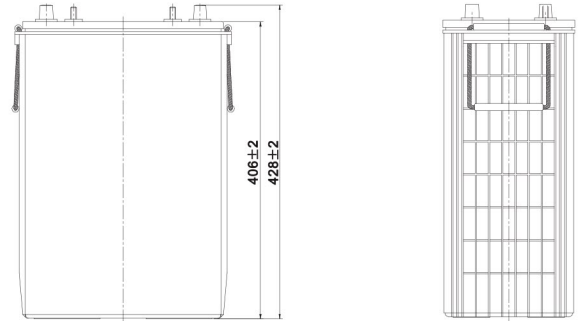
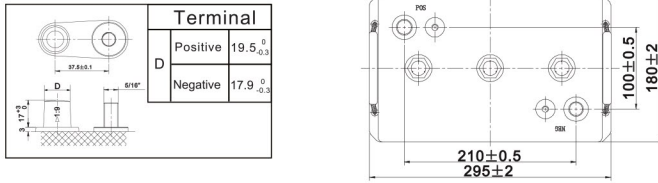

### Características de descarga

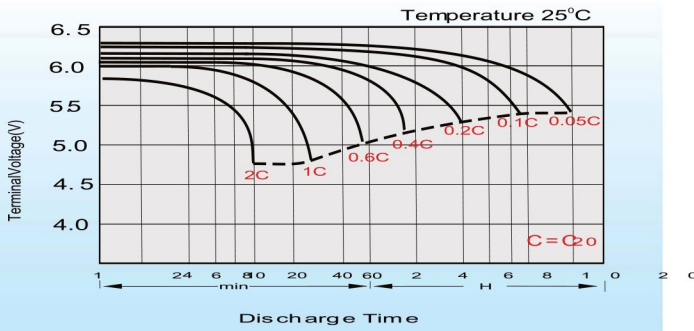

### Características de carga (absorción)

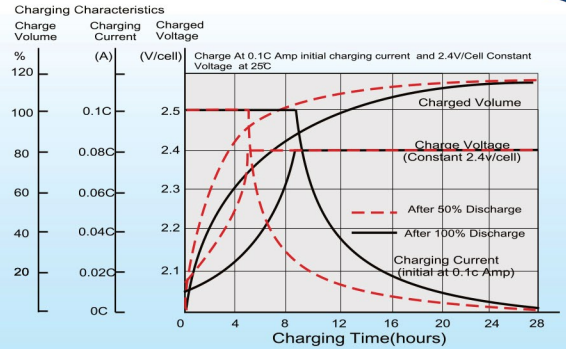

### Efectos de la temperatura en la capacidad

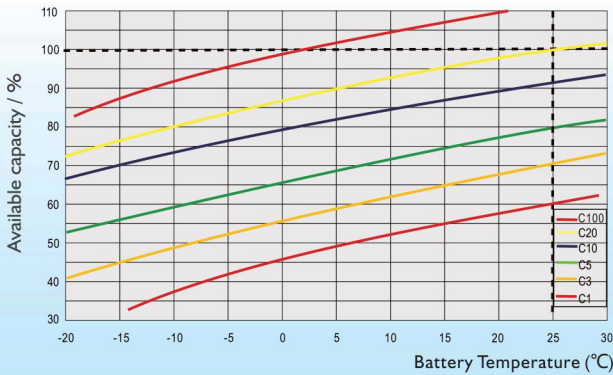

### Ciclos de vida en relación a la profundidas de descarga

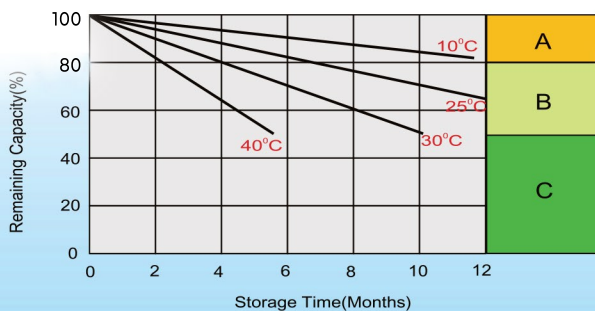
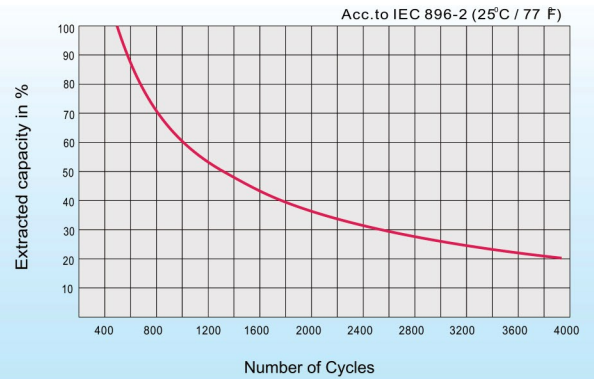

### Características de autodescarga

- A** No supplementary charge required  
(Carry out supplementary charge before use if 100% capacity is required.)
- Supplementary charge required before use. Optional charging way as below:
- B**
  1. Charged for above 3 days at limited current 0.25CA and constant volatge 2.25V/cell.
  2. Charged for above 20hours at limited current 0.25CA and constant volatge 2.45V/cell.
  3. Charged for 8~10hours at limited current 0.05CA .
- C** Supplementary charge may often fail to recover the capacity.  
The battery should never be left standing till this is reached.