

Installation manual for toilet seat and cover

Note: this installation instruction is made for the final user.
In order to use the product well, please install it correctly.

The direction for the customer:

Thank you for using our products. In order to install our product easily, please take a close look to the manual book. prepare all the needed tools and materials for installation.

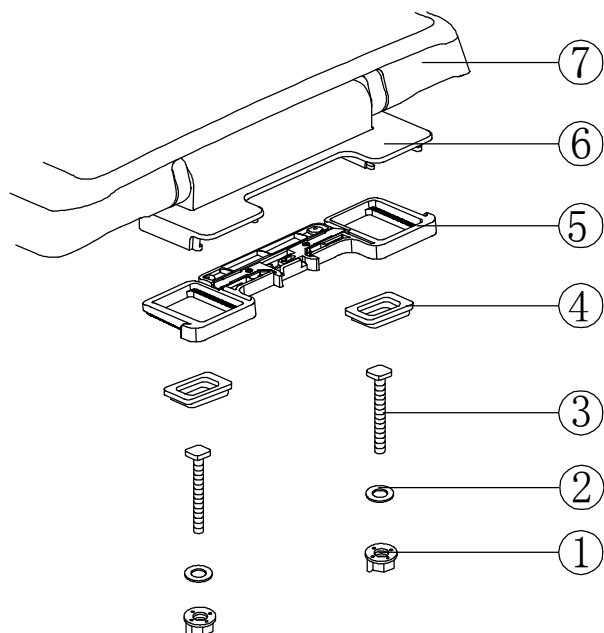

①	nut	⑤	hinge base
②	washer	⑥	hinge
③	screw	⑦	toilet seat
④	adjustment sheet		

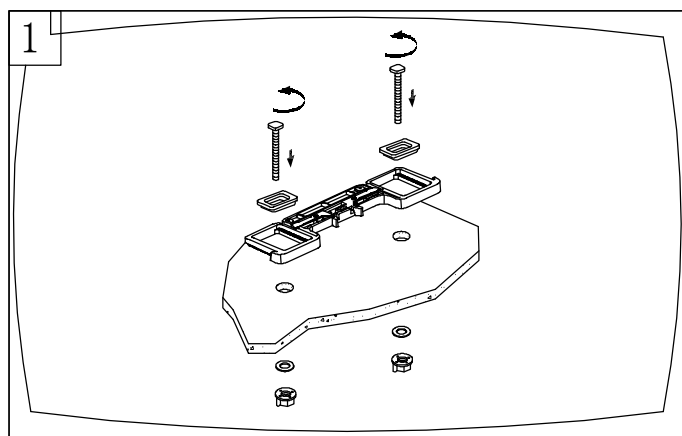

1. Please take out the accessories of ⑦.
First, install ③ together with ④ into the mounting holes of ⑤, then tighten the ①.

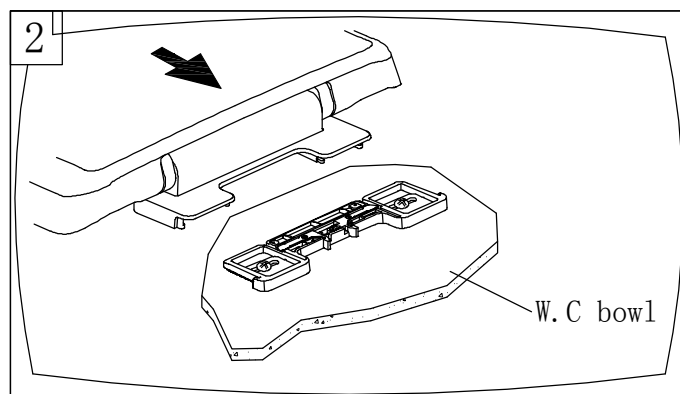

2. After finish steps shown in figure 1, install the ⑦ to the card slot of ⑤ at the direction of arrow. After install well, there will be a voice of "snap".

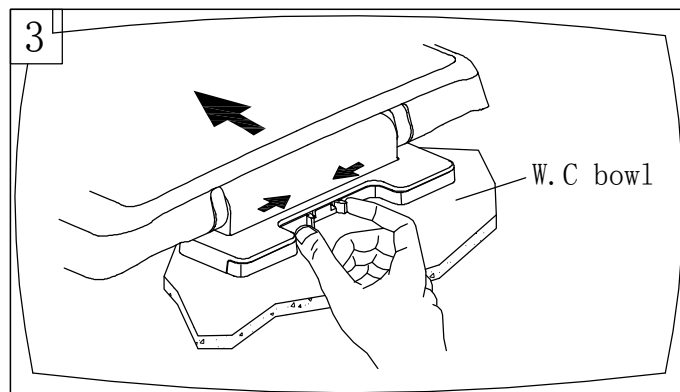

3. Disassemble: As shown in the figure, tightly pinch the fixture block at the direction of arrow, then take out the ⑦ at the direction of arrow.

Note:

1. Before installation, please check if all the fittings are all complete or not. If not, please contact with your local supplier.

2. Please take out all the fittings from the carton box and keep them together before installation to avoid missing.

3. After installation, check if the seat and cover are firmly fixed or not. Do not wash with corrosive solvent, gasoline and turpentine or any other sharp and coarse material to the finished and fixed product.