



Owner's manual

Original instructions

WR303E WR305E WR365E WR308E WR365E.1

WR304E WR306E WR310E

WR304E.1 WR306E.1

WR312E WR318E WR330E

WR340E WR341E WR342E WR344E

LANDROID
UNMANNED
MOWING
VEHICLE

TABLE OF CONTENTS

	Welcome
p. 04	Contact information
	Safety instruction
p. 05	Important safety instructions
	Get familiar with Vision Cloud
p. 10	How Vision Cloud works
p. 13	What's in the box
p. 15	Getting to know the mower
p. 19	Getting to know power supply
	Getting started
p. 20	Intended use
p. 20	Preparation and planning
p. 21	Install the charging station
p. 23	Power on Vision Cloud
p. 25	Connecting Vision Cloud to the internet
p. 27	Upgrade the firmware
p. 28	RadioLink (optional)
p. 30	Create map
	Start working
p. 36	One Time Cutting
p. 36	Smart Trim
	Machine setting
p. 37	Change PIN code
	Maintenance
p. 38	Keep it sharp
p. 38	Keep it clean
p. 39	Keep it charged
p. 39	Keep it updated
p. 39	Remove the charging station

TABLE OF CONTENTS

Quick reference

p. 40	Error messages
p. 41	Trouble shooting
p. 42	Environmental protection
p. 42	Network interface description
p. 43	Technical data
p. 47	Technical data for 4G (WR330E / WR344E only)
p. 47	Technical data for 4G-GPS
p. 47	Noise data
p. 48	Accessories
p. 49	Declaration of conformity

Thank you for purchasing a Worx Landroid Robot Mower.

Totally autonomous, fully configurable, agile and efficient, Landroid manicules your grass and gives you the best lawn ever. This manual will help you get set up.

We're here to help:



Support

<https://eu.worx.com/en/support-for-landroid/>

Landroid Owner's Site

<https://account.worxlandroid.com/login>

PRODUCT SAFETY

GENERAL & ADDITIONAL SAFETY INSTRUCTIONS

⚠ WARNING: Read all safety warnings and all instructions. Failure to follow the warnings and instructions may result in electric shock, fire and/or serious injury.

Carefully read the instructions for the safe operation of the machine.

Save all warnings and instructions for future reference.

- This appliance is not intended for use by persons (including children) with reduced physical, sensory or mental capabilities, or lack of experience and knowledge, unless they have been given supervision or instruction concerning use of the appliance by a person responsible for their safety.

- Children should be supervised to ensure that they do not play with the appliance.

WARNING: For the purposes of recharging the battery, only use the detachable supply unit provided with this appliance.

WARNING: To reduce the risk of injury to persons and damage to the machine, do not remove battery pack before switching off the machine.

IMPORTANT

READ CAREFULLY BEFORE USE

KEEP FOR FUTURE REFERENCE

Safe operation practices

Training

- a) Read the instructions carefully. Make sure you understand the instructions and be familiar with the controls and the proper use of the appliance.
- b) Never allow people unfamiliar with these instructions or children to use the appliance. Local regulations can restrict the age of the operator.
- c) The operator or user is responsible for accidents or hazards occurring to other people or their property.

Preparation

- a) Ensure the correct installation of the automatic perimeter delineation system as instructed. This machine works without boundary wire or virtual boundary. It can automatically identify the working area and non-working area through the camera. Once the machine is turned on, the camera will automatically turn on and work at the same time. The machine recognizes that the lawn is the working area through the camera, and the non-working area that is not the lawn. When the machine walks to the boundary between lawn and non-lawn, it will automatically turn to return to the working area. Add a magnetic strip to separate it from the neighbor's lawn. The machine returns when it encounters a magnetic strip while mowing. Return along the magnetic strip when returning.
- b) Periodically inspect the area where the appliance is to be used and remove all stones, sticks, wires, bones, and other foreign objects. Periodically inspect and clean the boundaries between grass and non-grass. Clearing boundaries helps the lawnmower to identify the working area.
- c) Periodically visually inspect to see that the blades, blade bolts and cutter assembly are not worn or damaged. Replace worn or damaged blades and bolts in sets to preserve balance.
- d) On multi-spindle appliances, take care as rotating one blade can cause other blades to rotate.
- e) **WARNING!** The lawnmower shall not be operated without the guard in place.

Operation

1. General

- a) Never operate the appliance with defective guards, or without safety devices, for example deflectors, in place.
- b) Do not put hands or feet near or under rotating parts. Keep clear of the discharge opening at all times.
- c) Never pick up or carry an appliance while the motor is running.
- d) Operate the disabling device from the appliance.
 - Before clearing a blockage;
 - Before checking, cleaning or working on the appliance;
 - After striking a foreign object to inspect the machine for damage;
 - If the machine starts to vibrate abnormally, and to check for damage before restarting.
- e) It is not permitted to modify the original design of robotic lawnmower. All modifications are made at your own risk.
- f) Start robotic lawnmower according to the instructions. When the power key is switched on, make sure you keep your hands and feet away from the rotating blades. Never put your hands and feet under the mower.
- g) Never lift up robotic lawnmower or carry it when the power key is switched on.
- h) Do not let persons who do not know how robotic lawnmower works and behaves use the mower.
- i) Do not put anything on top of robotic lawnmower or its charging station.

- j) Do not allow robotic lawnmower to be used with a defective blade disc or body. Neither should it be used with defective blades, screws, nuts or cables.
- k) Always switch off robotic lawnmower when you do not intend to use the mower. Robotic lawnmower can only start when the power key is switched on and the correct PIN code has been entered.
- l) Keep your hands and feet away from the rotating blades. Never place your hands or feet close to or under the body when robotic lawnmower is in operation.
- m) To avoid using the machine and its peripherals in bad weather conditions especially when there is a risk of lightning.
- n) Do not touch moving hazardous parts before these have come to a complete stop.
- o) For machines used in public areas, that warning signs shall be placed around the working area of the machine. They shall show the substance of the following text:
Warning! Automatic lawnmower! Keep away from the machine! Supervise children!
- p) To avoid the risk of injury, please stop the mower and carry out the mower to another lawn to be mowed. Never drag or pull the mower on operation when you change the lawn to be mowed.

2. Additionally when the appliance is operating automatically

- a) Do not leave the machine to operate unattended if you know that there are pets, children or people in the vicinity.
- b) Please set the smart phone to automatically lock the screen after 30 s to prevent the APP from being misused by others.

Maintenance and storage

⚠ WARNING! When the mower is turned upside down the power key must always be switched off.

The power key should be switched off during all work on the mower's underframe, such as cleaning or replacing the blades.

- a) Keep all nuts, bolts and screws tight to be sure the appliance is in safe working condition.
- b) Inspect the robotic lawnmower each week and replace worn or damaged parts for safety.
- c) Check especially that the blades and blade disc are not damaged. Replace all blades and screws at the same time if necessary so that the rotating parts are balanced.
- d) Ensure that only replacement cutting means of the right type are used.
- e) Ensure that batteries are charged using the correct charger recommended by the manufacturer. Incorrect use may result in electric shock, overheating or leakage of corrosive liquid from the battery.
- f) In the event of leakage of electrolyte flush with water/neutralizing agent, seek medical help if it comes into contact with the eyes etc.
- g) Servicing of the appliance should be according to manufacturers' instructions.
- h) In order to obtain the best performance, please pay attention to the following ambient temperature range, do not charge, use, or store in the case of exceeding the following temperature range:
 - a) Charging temperature range: 0°C~40°C
 - b) Discharge temperature range: -20°C~55°C
 - c) Storage temperature range: -20°C~75°C
- i) Leaking battery fluid can cause skin and eye irritation or chemical burns.
 - a) Avoid contact with skin and eyes.
 - b) If liquid gets in eyes: Do not rub. Flush open eyes with water for at least 15 minutes, and seek medical advice.
 - c) In case of accidental contact, wash the contact area immediately and thoroughly with mild soap and water.
 - d) Use an inert absorbent such as sand on spilled liquid.

Recommendation

To connect the machine and/or its peripherals only to a supply circuit protected by a residual current device (RCD) with a tripping current of not more than 30 mA.

Residual risks

To avoid injuries, wear protective gloves when replacing the blades.

Transport

The original packaging should be used when transporting robotic lawnmower over long distances.

To safely move form or within the working area:

- a) Press the STOP button to stop the mower.
You select the four digit PIN code when you start the mower for the first time.
- b) Always switch off robotic lawnmower if you intend to carry the mower.
- c) Carry the mower by the handle at the front under the mower. Carry the mower with the blade disc away from the body.

RF exposure requirements

To satisfy RF exposure requirements, a separation distance of 200mm or more should be maintained between this device and persons during device operation.

To ensure compliance, operations at closer than this distance is not recommended. The antenna used for this transmitter must not be co-located in conjunction with any other antenna or transmitter.

This is a class III appliances and it must only be supplied at safety extra low voltage corresponding to the marking on the appliance.

WARNING: For the purposes of recharging the battery, only use the detachable supply unit provided with this appliance.

SAFETY WARNINGS FOR BATTERY PACK

- a) **Do not dismantle, open or shred cells or battery pack.**
- b) **Do not short-circuit a battery pack. Do not store battery packs haphazardly in a box or drawer where they may short-circuit each other or be short-circuited by conductive materials.** When battery pack is not in use, keep it away from other metal objects, like paper clips, coins, keys, nails, screws or other small metal objects, that can make a connection from one terminal to another. Shorting the battery terminals together may cause burns or a fire.
- c) **Do not expose battery pack to heat or fire. Avoid storage in direct sunlight.**
- d) **Do not subject battery pack to mechanical shock.**
- e) **In the event of battery leaking, do not allow the liquid to come into contact with the skin or eyes. If contact has been made, wash the affected area with copious amounts of water and seek medical advice.**
- f) **Keep battery pack clean and dry.**
- g) **Wipe the battery pack terminals with a clean dry cloth if they become dirty.**
- h) **Battery pack needs to be charged before use. Always refer to this instruction and use the correct charging procedure.**
- i) **Do not maintain battery pack on charge when not in use.**
- j) **After extended periods of storage, it may be necessary to charge and discharge the battery pack several times to obtain maximum performance.**
- k) **Recharge only with the charger specified by Worx. Do not use any charger other than that specifically provided for use with the equipment.**
- l) **Do not use any battery pack which is not designed for use with the equipment.**
- m) **Keep battery pack out of the reach of children.**
- n) **Retain the original product literature for future reference.**
- o) **Remove the battery from the equipment when not in use.**
- p) **Dispose of properly.**
- q) **Do not mix cells of different manufacture, capacity, size or type within a device.**
- r) **Keep the battery away from microwaves and high pressure.**
- s) **Warning! Do not use non-rechargeable batteries.**

USER MANUAL REQUIREMENTS FOR WIRELESS PRODUCT

- a) Operation of this device is subject to the following two conditions:
 - (1) This device may not cause harmful interference, and
 - (2) this device must accept any interference received, including interference that may cause undesired operation.
- b) Caution: Changes or modifications to this unit not expressly approved by the party responsible for compliance could void the user's authority to operate the equipment.
- c) NOTE: This equipment generates, uses and can radiate radio frequency energy and, if not installed and used in accordance with the instructions, may cause harmful interference to radio communications. However, there is no guarantee that interference will not occur in a particular installation. If this equipment does cause harmful interference to radio or television reception, which can be determined by turning the equipment off and on, the user is encouraged to try to correct the interference by one or more of the following measures:
 - Reorient or relocate the receiving antenna.
 - Increase the separation between the equipment and receiver.
 - Connect the equipment into an outlet on a circuit different from that to which the receiver is connected.
 - Consult the dealer or an experienced radio/TV technician for help.

SAFETY WARNINGS FOR CARRY THE MOWER (only for Worx Landroid Vision Cloud 4WD)

Please follow the following instructions to carry the mower.

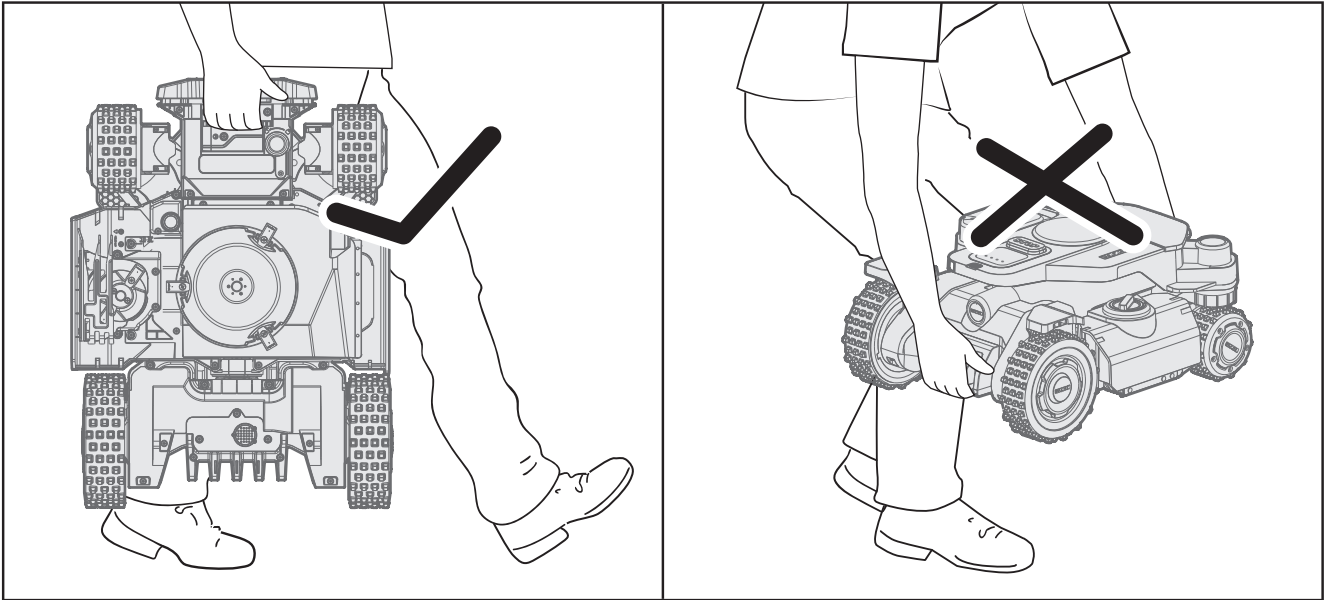

INFORMATION ON THE MOWER



WARNING – robotic lawn mower can be dangerous if incorrectly used. Read through the Operator’s manual carefully and understand the content before using your robotic lawn mower.



WARNING - Keep a safe distance from the machine when operating.



WARNING – Operate the disabling device before working on or lifting the machine.



WARNING - Do not ride on the machine.



Li-Ion battery. This product has been marked with a symbol relating to ‘separate collection’ for all battery packs and battery pack. It will then be recycled or dismantled in order to reduce the impact on the environment. Battery packs can be hazardous for the environment and for human health since they contain hazardous substances.



Do not burn



Batteries may enter water cycle if disposed improperly, which can be hazardous for ecosystem. Do not dispose of waste batteries as unsorted municipal waste.



Prohibit disassembling the machine without authorization



Waste electrical products must not be disposed of with household waste. Please recycle where facilities exist. Check with your local authorities or retailer for recycling advice.



Class III appliance



Read operator's manual



Detachable supply unit

Your mower can be used with other Worx functional accessories. Visit www.worxlandroid.com to learn more about these available accessory options.

HOW VISION CLOUD WORKS

In the following section, we would like to help you better understand how Vision Cloud works.

In this chapter, we will help you better understand how Vision Cloud operates. Vision Cloud is equipped with an AI (Artificial Intelligence) camera sensor that enables it to work fully autonomously. It can distinguish lawn-covered areas from non-lawn areas, knows when it needs to return to its charging station, detects rain, stops itself when an issue occurs, and turns around when it sees something blocking its path. To prevent accidents, Vision Cloud will automatically stop the blade disc from rotating if it is lifted off the ground or if any other safety issue occurs.

Auto Mapping

Vision Cloud greatly reduces manual operation and no longer requires a remote control. It automatically identifies the lawn boundary and builds a map (for single areas with clear boundaries only). For multi-zone lawns, you can guide the robot to the next area via remote control after the previous zone is mapped, and then start Auto Mapping again once it enters the new area.

RTKⁿ without installation

This is the most advanced positioning solution in the robotic lawn mower industry, offering superior stability, precision, and simplicity. Powered by commercial-grade high-precision RTKⁿ technology, your lawn stripes can be as beautifully even as those on a football field. Even in shaded areas or near buildings, the robot completes its tasks efficiently through integrated V-SLAM fusion positioning technology. Most excitingly, no additional base stations are required—it works straight out of the box.

AI Obstacle Detection and Avoidance

Using its AI camera and an ever-expanding image database, Vision Cloud detects objects ahead in real time. Non-grass objects such as tree stumps, water pipes, or balls will be identified and automatically avoided.

RadioLink

Vision Cloud is equipped with the RadioLink wireless communication system, featuring long-range and low-interference connectivity. Even in gardens with limited or no Wi-Fi coverage, it ensures a stable connection across the entire working area. Its low-power design enhances connection reliability without compromising battery life, effectively extending the mower's operating range in areas without Wi-Fi coverage.

Smart Trim

With Smart Trim enabled, Vision Cloud uses AI algorithms to optimize its edge-cutting performance. As it travels along the lawn edge, the robot automatically determines the best distance to minimize uncut grass along borders. When you select the edge-cutting mode in the app, the robot follows the lawn boundary and adjusts its approach based on real conditions, delivering cleaner and more complete edge-cutting results.

Cutting pattern

The cutting pattern feature allows you to choose your preferred mowing style in the app. You may select the random cutting mode for a more natural lawn appearance, or the planned cutting mode to create neat, aesthetically pleasing stripes. In planned cutting mode, you can also customize the cutting angle of the stripes to match your aesthetic preference or garden layout.

Cut to Zero module (optional)

The revolutionary Cut to Zero module provides the best edging performance in the industry, significantly reducing the need for manual trimming. Mounted on the side of the robot, the module enables the blade to reach as close as possible to lawn edges or obstacles, leaving little or no trimming work for you. The flexible auxiliary blade can be adjusted to different cutting heights to meet various needs.

All-Day cutting (optional)

With the optional FiatLux module, Vision Cloud can operate even at night while remaining friendly to nocturnal animals such as hedgehogs.

Find my Landroid

Find my Landroid is a security module designed specifically for theft protection, providing an enhanced level of safety for your Vision Cloud. The series includes two different versions to meet varying security needs. Among them, the 4G version is equipped with an independently powered 4G communication module, which enables continuous real-time tracking even when the robot is powered off or switched off, ensuring you always know the location of your Vision Cloud.

Easy cleaning

Vision Cloud has an IPX6 waterproof rating and can be cleaned using a regular garden hose. Do not use any cleaning methods other than a hose with normal water pressure (e.g., pressure washers, steam cleaners, or hoses fitted with high-pressure nozzles), as these may cause damage or malfunctions.

Rain sensor & Rain delay

Vision Cloud is 100% weather proof and happy to be outside. But mowing wet grass does not give you the best result. Vision Cloud is equipped with a rain sensor which detects rain and tells Vision Cloud to stop mowing and go back to its charging station. Vision Cloud then re-starts mowing when the grass is no longer wet. The default Rain Delay time is 180 minutes. You can change the Rain Delay time setting via the Vision Cloud app.

Cutting height

Before starting your Vision Cloud at the first time, make sure your grass is not longer than 10 cm. If it isn't, use a regular mower to cut it before operating Vision Cloud. If you want to drastically shorten the height of your grass, it is recommended that you do so progressively, by adjusting the cutting height in steps.

Extreme weather

During thunderstorms, unplug the charging station and ensure the robot is not allowed to charge. In winter, especially in very cold or snowy conditions, store Vision Cloud indoors. Some countries offer winter servicing to keep your Vision Cloud in optimal condition for the next growing season. Please contact your dealer or check online for details.

Security & PIN protection

To prevent unauthorized use, Vision Cloud is protected by a PIN code that you can easily set. In addition, an auto-lock function prevents children or others from accessing the settings.

WHAT'S IN THE BOX (WR303E WR305E WR365E WR308E WR365E.1)

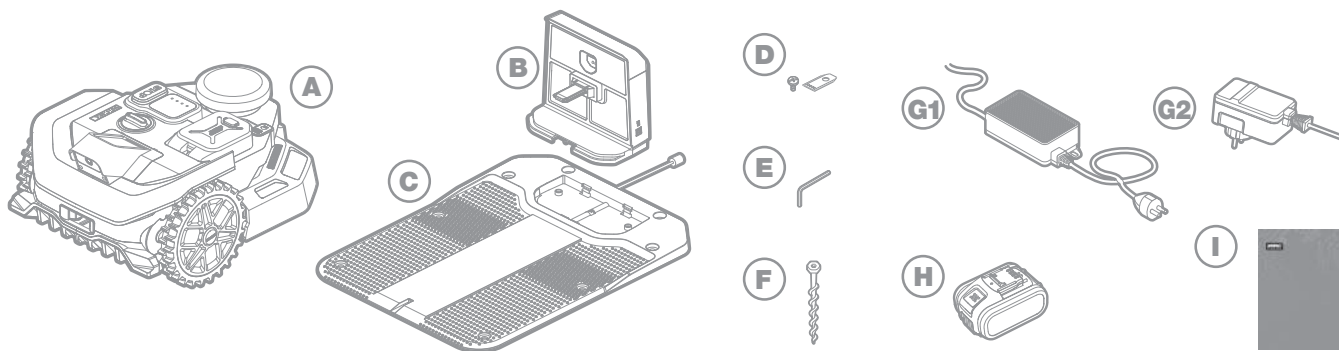

- | | | | |
|---|----------------------------|----|--|
| A | Worx Landroid Vision Cloud | F | Screws |
| B | Charging tower | G1 | Power supply (not applicable for WR303E model) |
| C | Charging base plate | G2 | Power supply (only for WR303E) |
| D | Spare blades kits | H | 20V battery |
| E | Hex key | I | Manuals |

WHAT'S IN THE BOX (WR304E WR306E WR310E)

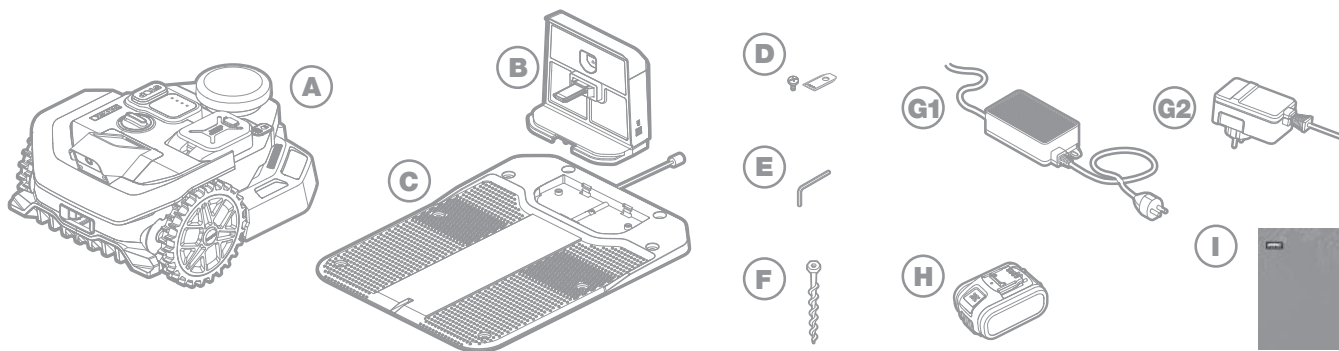

- | | | | |
|---|----------------------------|----|--|
| A | Worx Landroid Vision Cloud | F | Screws |
| B | Charging tower | G1 | Power supply (not applicable for WR304E model) |
| C | Charging base plate | G2 | Power supply (only for WR304E) |
| D | Spare blades kits | H | 20V battery |
| E | Hex key | I | Manuals |



APP



VIDEO



SUPPORT



WHAT'S IN THE BOX (WR312E WR318E WR330E)

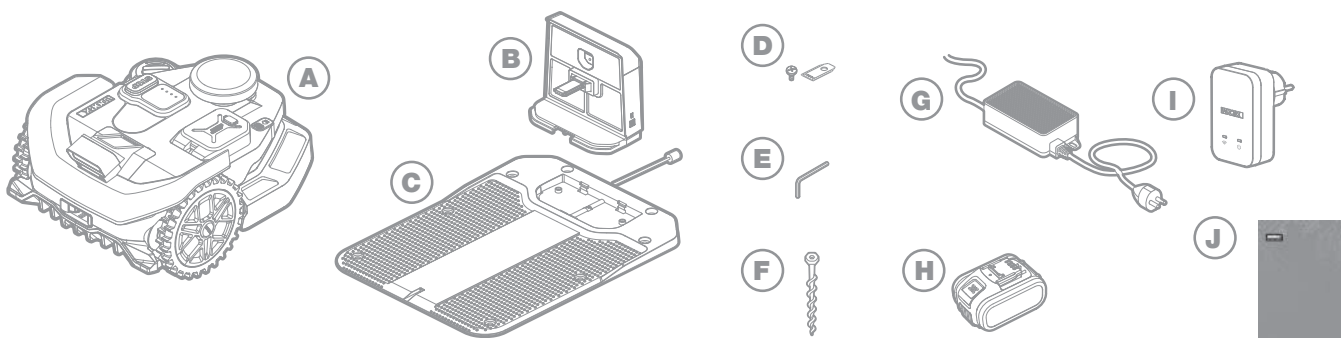

- | | | | |
|---|----------------------------|---|--|
| A | Worx Landroid Vision Cloud | F | Screws |
| B | Charging tower | G | Power supply |
| C | Charging base plate | H | 20V battery |
| D | Spare blades kits | I | RadioLink (standard only with WR312E/WR318E) |
| E | Hex key | J | Manuals |

WHAT'S IN THE BOX (WR340E WR341E WR342E WR344E)

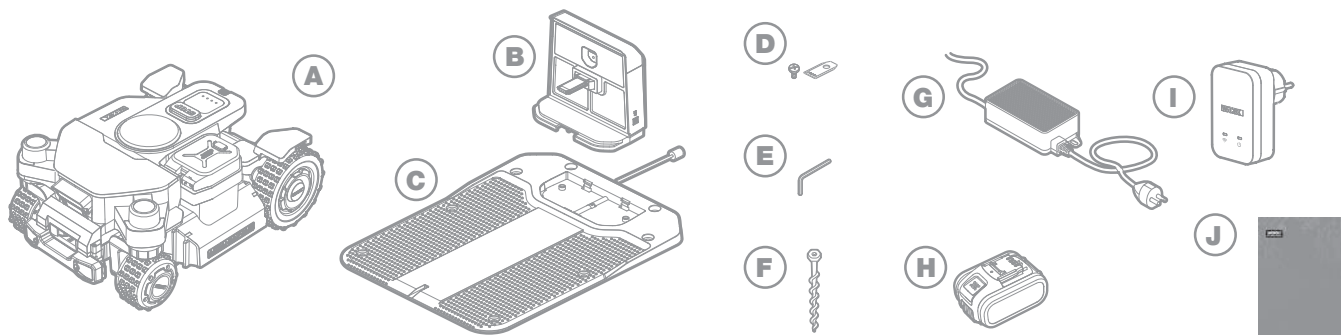

- | | | | |
|---|--------------------------------|---|---------------------------------------|
| A | Worx Landroid Vision Cloud 4WD | F | Screws |
| B | Charging tower | G | Power supply |
| C | Charging base plate | H | 20V battery |
| D | Spare blades kits | I | RadioLink (standard only with WR342E) |
| E | Hex key | J | Manuals |



APP



VIDEO



SUPPORT



GETTING TO KNOW THE MOWER (WR303E & WR305E & WR365E)

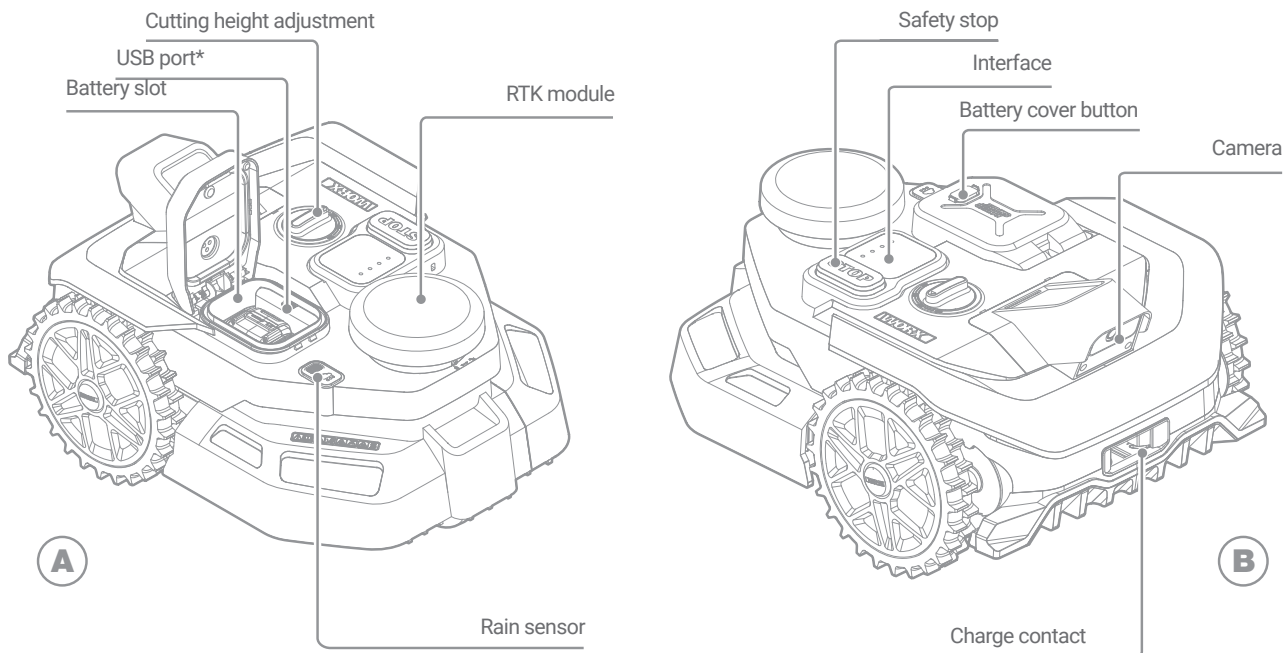

*USB port: Used for exporting log files and performing manual firmware upgrades.

GETTING TO KNOW THE MOWER (WR365E.1 & WR308E)

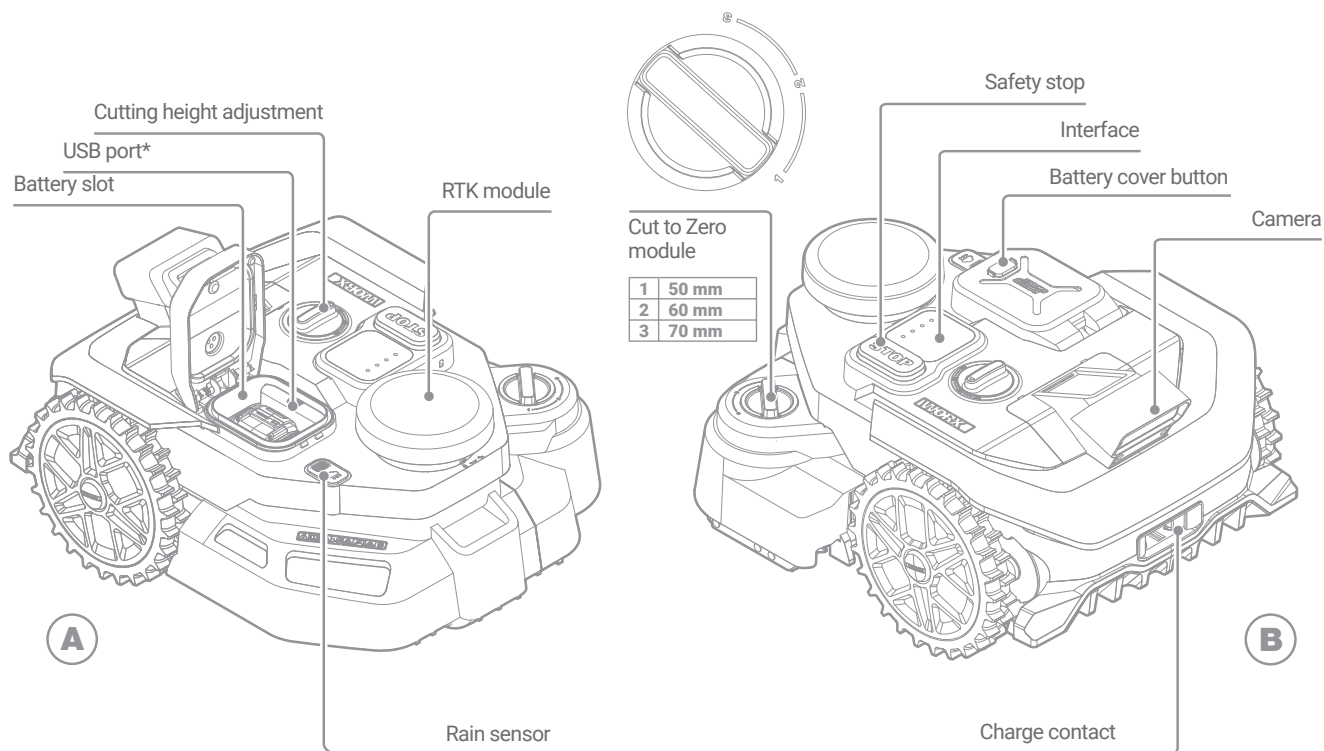

*USB port: Used for exporting log files and performing manual firmware upgrades.

The picture is only for reference

GETTING TO KNOW THE MOWER (WR304E)

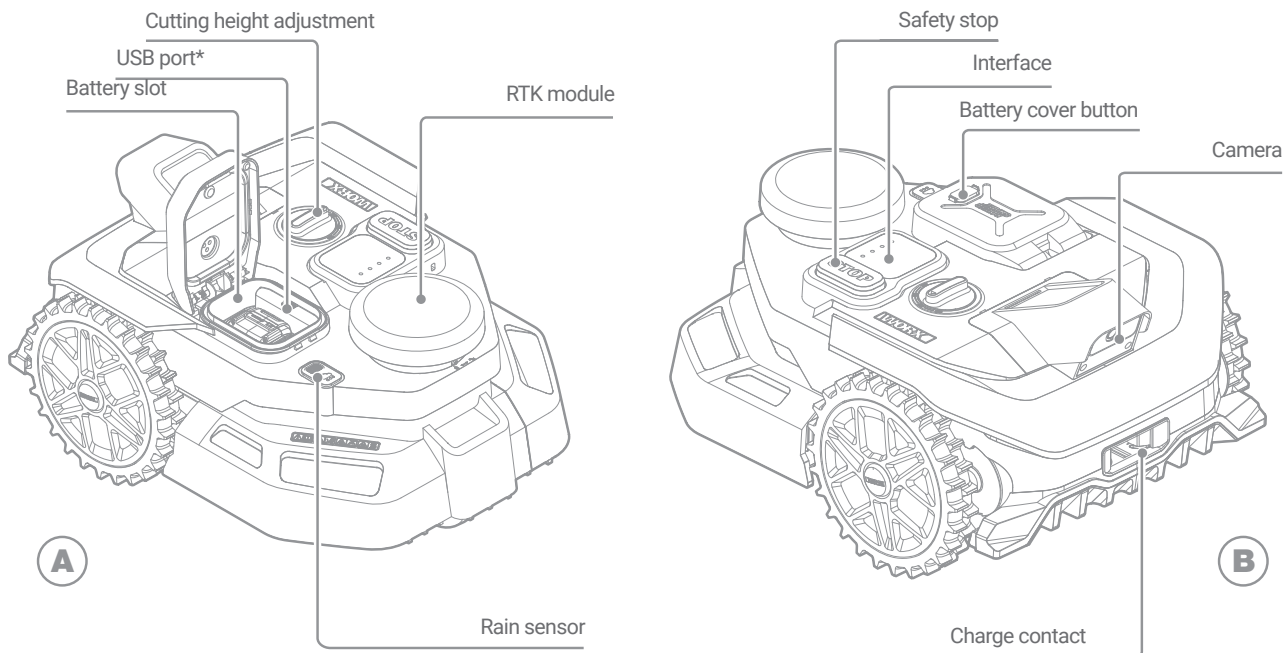

*USB port: Used for exporting log files and performing manual firmware upgrades.

GETTING TO KNOW THE MOWER (WR306E)

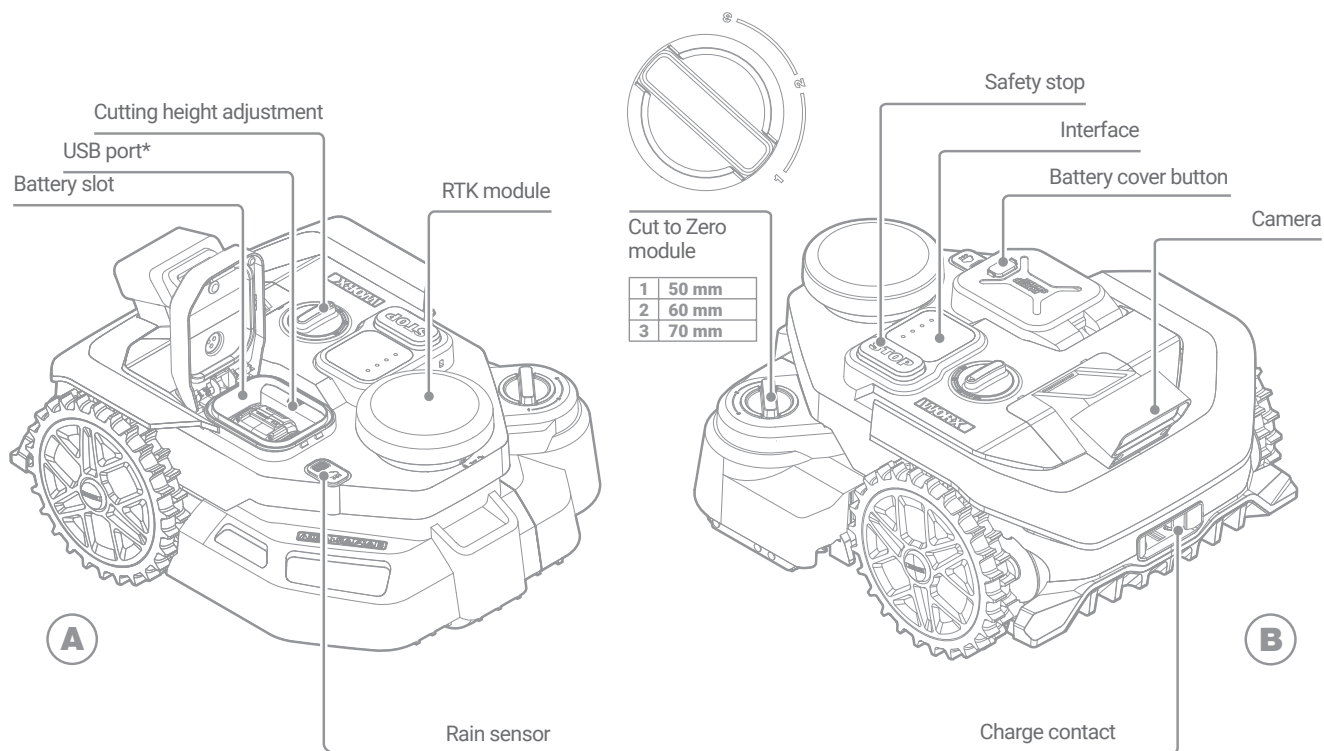

*USB port: Used for exporting log files and performing manual firmware upgrades.

The picture is only for reference

GETTING TO KNOW THE MOWER (WR310E)

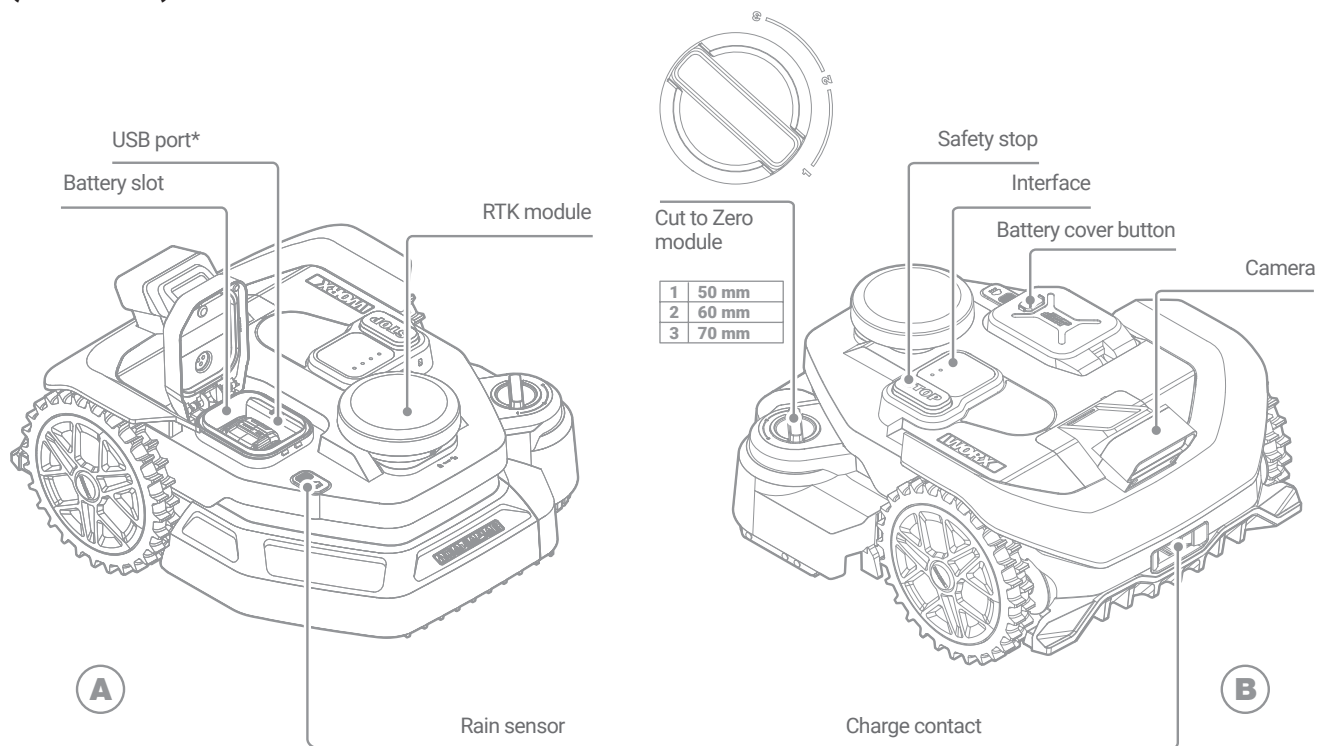

*USB port: Used for exporting log files and performing manual firmware upgrades.

GETTING TO KNOW THE MOWER (WR312E WR318E WR330E)

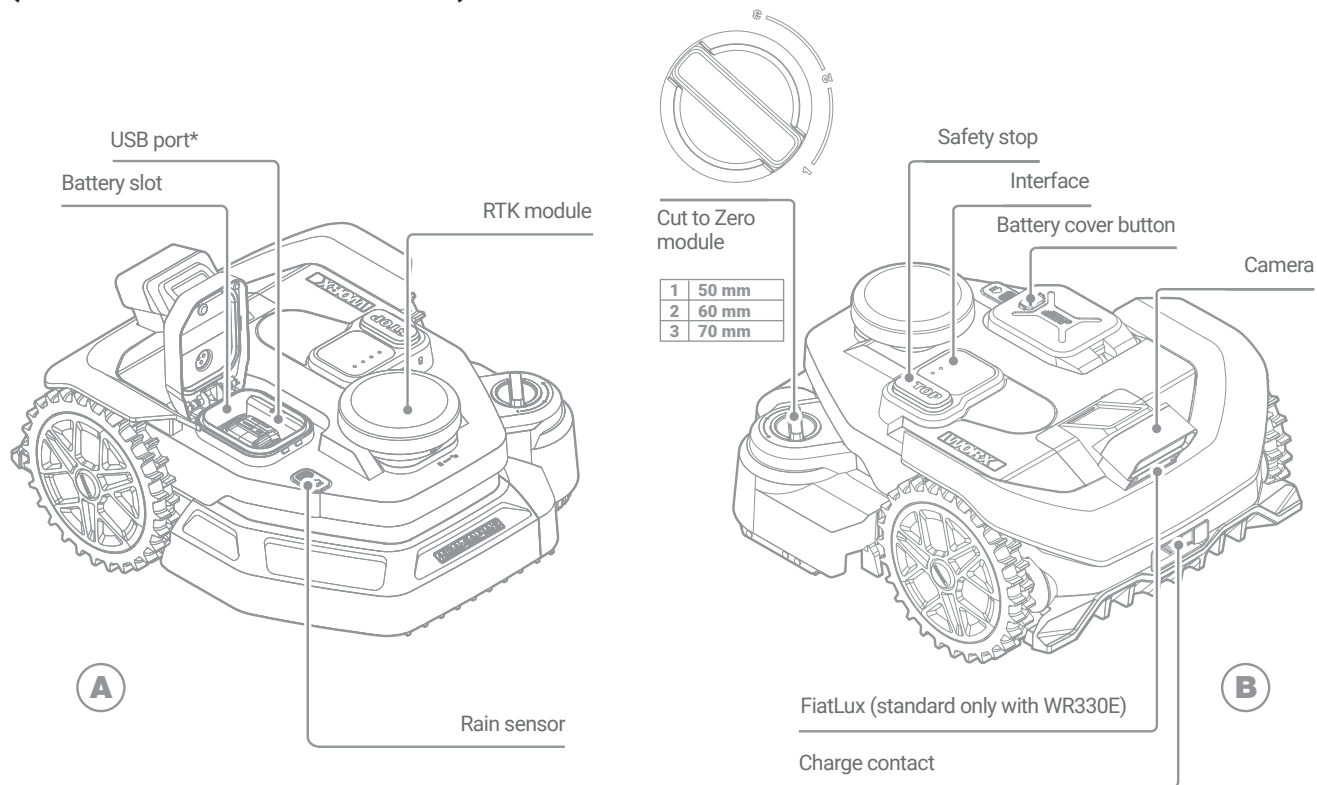

*USB port: Used for exporting log files and performing manual firmware upgrades.

The picture is only for reference

GETTING TO KNOW THE MOWER (WR340E & WR341E & WR342E)

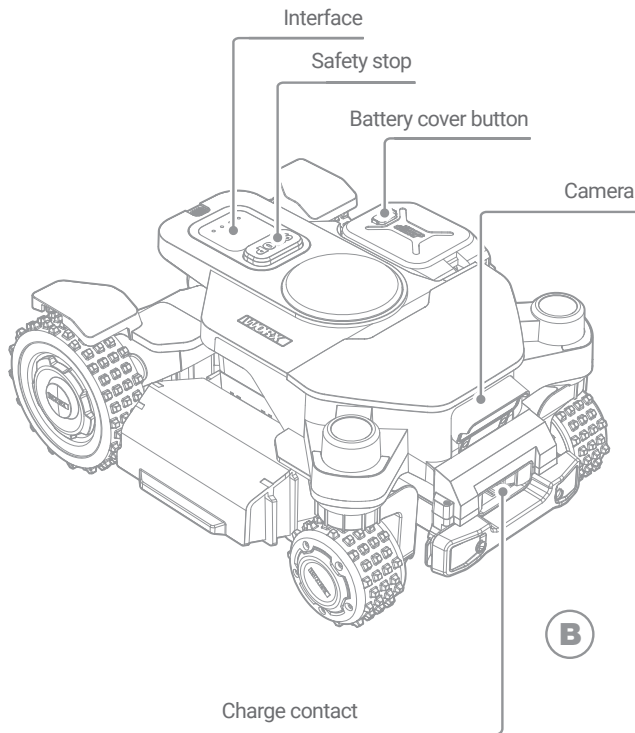
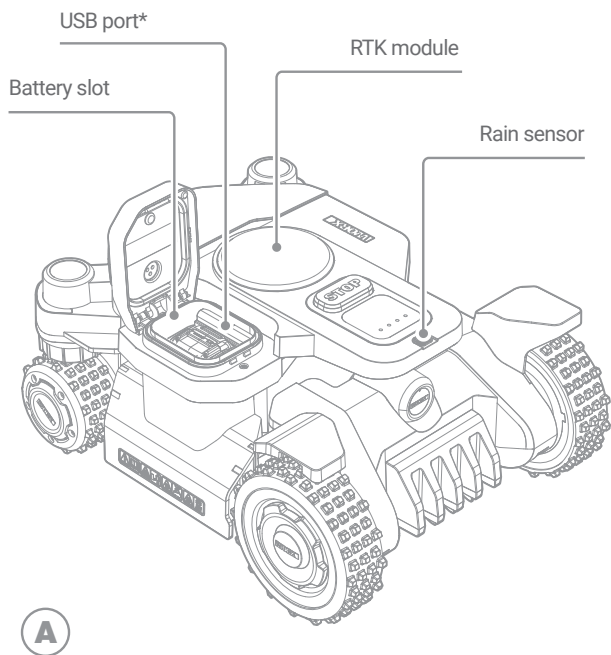

*USB port: Used for exporting log files and performing manual firmware upgrades.

GETTING TO KNOW THE MOWER (WR344E)

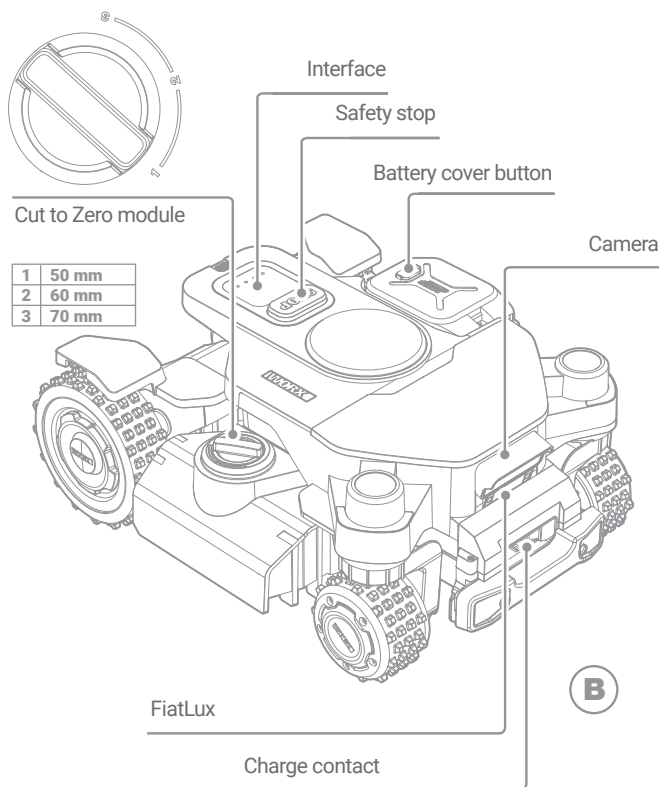
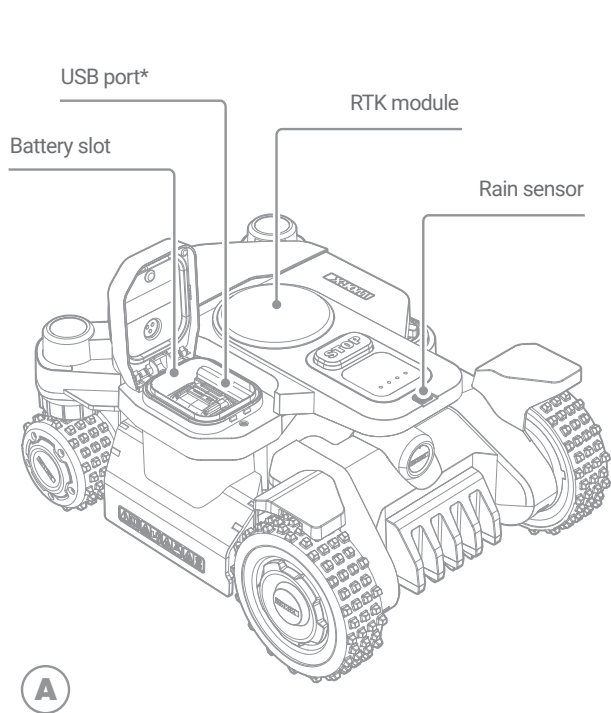

*USB port: Used for exporting log files and performing manual firmware upgrades.

The picture is only for reference

GETTING TO KNOW POWER SUPPLY (only with charging station)

After installing and powering on the charging station, the indicator lights on the charging station have the following meanings:

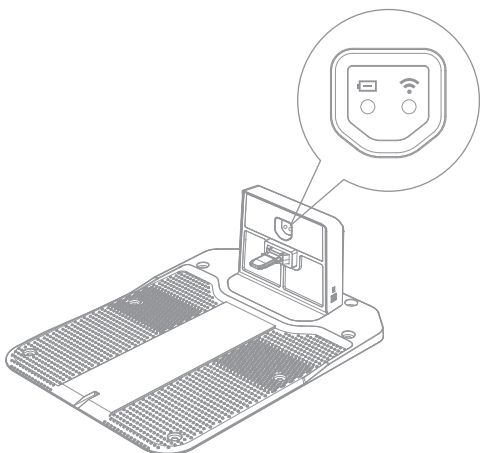

Icon	Type	Function Description
🔋	Green	Solid: Charging function normal
		Breathing: Charging in progress
	Red	Solid: Charging fault
		Flashing: Battery polarity short-circuit fault
Off	No power supply.	
📶	Green	It's working normally.
	Blue	It's working abnormally. Please refer to the Troubleshooting section or contact Customer Service for further assistance.

GETTING TO KNOW POWER SUPPLY (with charging station and RadioLink)

After installing and powering on the charging station and RadioLink, the indicator lights on the charging station and RadioLink have the following meanings:

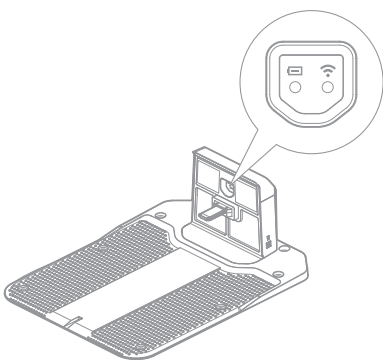

Icon	Type	Function Description	
		Charging Station	RadioLink
🔋	Green	Solid: Charging function normal	Solid: Function normal
		Breathing: Charging in progress	/
🔌	Red	Solid: Charging fault	/
		Flashing: Battery polarity short-circuit fault	/
	Off	No power supply.	

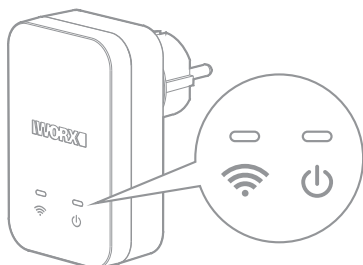

Icon	Indicator Light Combination		Function description
	Charging Station	RadioLink	
📶	Green	Blue	It's working normally.
	Blue	Green	It's working normally.
	Blue	Blue	It's working abnormally. Please check the Wi-Fi signal at the locations of the charging station and Radiolink.

INTENDED USE

The garden product is intended for domestic lawn mowing. It is designed to mow often, maintaining a healthier and better looking lawn than ever before. Depending on the size of your lawn, your mower may be programmed to operate at any time or frequency. It is not intended for digging, sweeping or snow clearing.

PREPARATION AND PLANNING

1. PATROL YOUR LAWN TO PLAN INSTALLATION

A. Cutting height

To improve visual recognition, driving stability, and cutting efficiency, reduce risks during first-time use, and ensure the robotic mower operates under optimal conditions, it is recommended to pre-cut the lawn before initial operation.

It is recommended that the cutting height is lower than 10 cm at the first Vision Cloud do the cut.

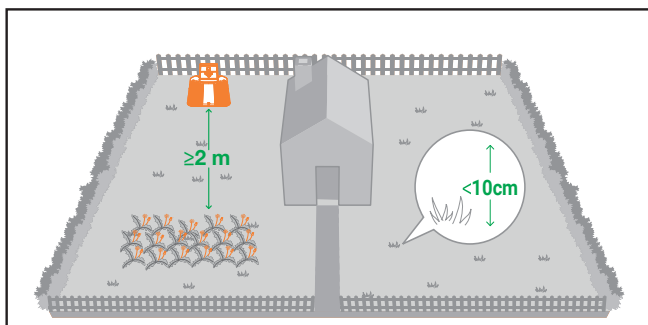

B. Piles of things

We suggest you to clean up the things such as leaves and wildflowers on the lawn, otherwise Vision Cloud will see them as obstacles and avoid cutting this area.

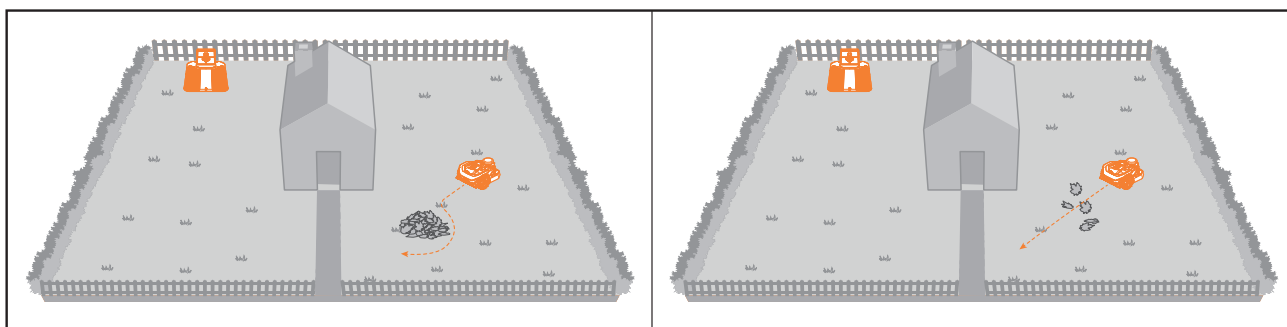

1.1 Plan for the charging station position

The charging station composed of charging station plate and charging tower, is where your Vision Cloud goes to have its battery recharged. It's also the parking lot where it rests in between one mowing session and the next.

Locate a proper position for it, bearing in mind:

- The charging station needs to sit on flat land to ensure effective docking.

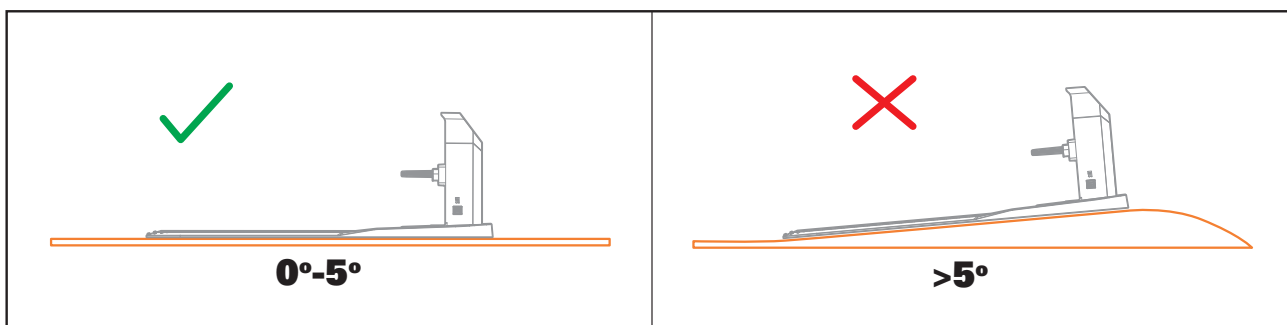

- It needs 2 m straight driving path in front to make sure Vision Cloud can successfully dock.
- It needs to be correctly connected to power supply.
- The position of the charging station must be covered by 2.4G Wi-Fi signal. As the Vision Cloud needs to access internet while OTA in the station.
- If possible, choose a shaded position as batteries and chargers don't like over-heating.
- Avoid places close to irrigation sprinklers.

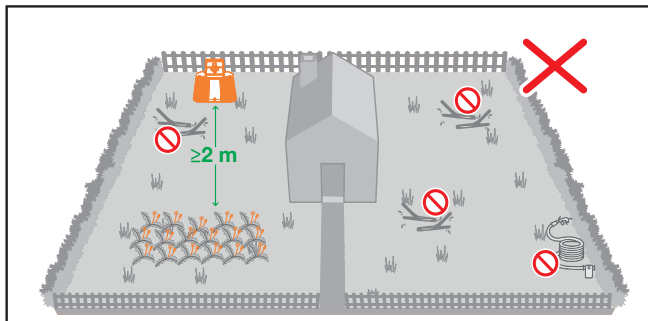

2. INSTALL THE CHARGING STATION

Insert charging tower into charging station plate. And make sure the QR code on the charging tower is clear.

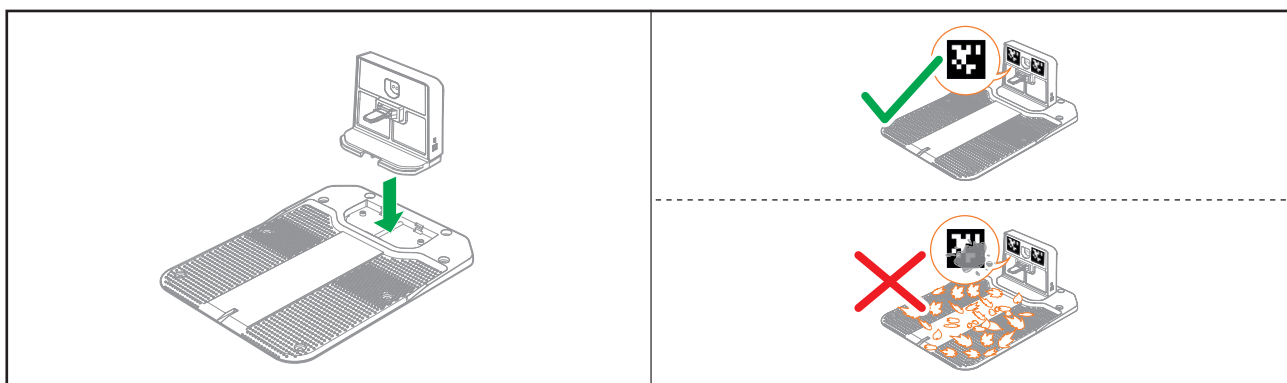

PLACE THE CHARGING STATION

- Check the Wi-Fi coverage using your phone. Make sure the position you want to place the station is covered by good signal. Otherwise robot may suffer from poor signal issues, or OTA failure.

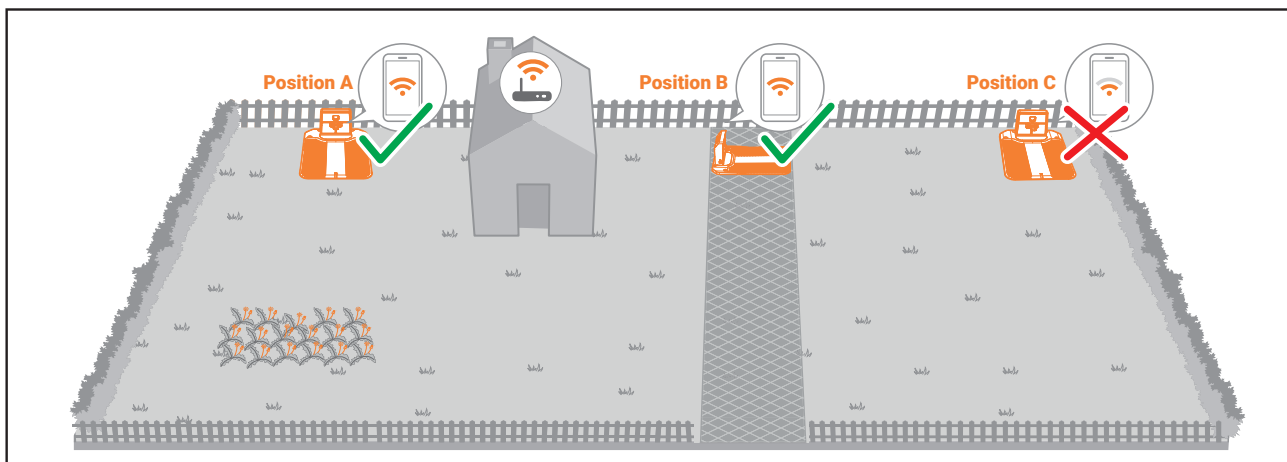

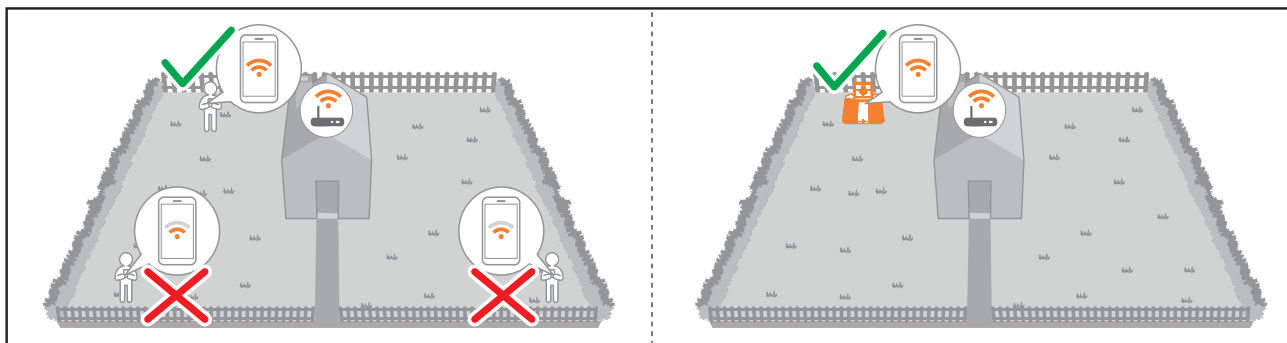

- Please keep the following in mind: First, place the charging station near a power outlet. Second, orient the charging station so it faces the lawn, not away from it; otherwise, the robot may not be able to enter or exit the station correctly.

Keep at least 5 cm of clearance between the right side of the charging station and any wall or fence.

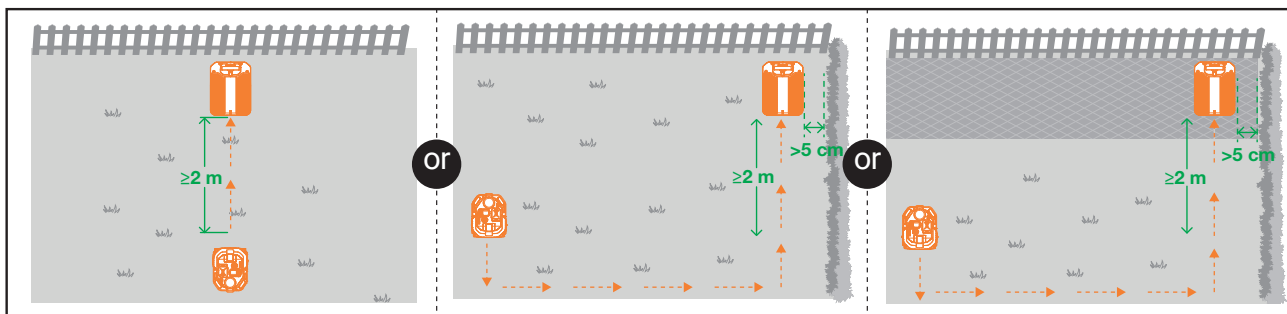

Fix the charging station in the selected location

Fix the charging station to the ground by means of the supplied screws, using the supplied hex key. If you position the station on hard surface, fix it with plug and screw fixings.

NOTE: It is recommended to assemble the charging station on a flat and hard surface.

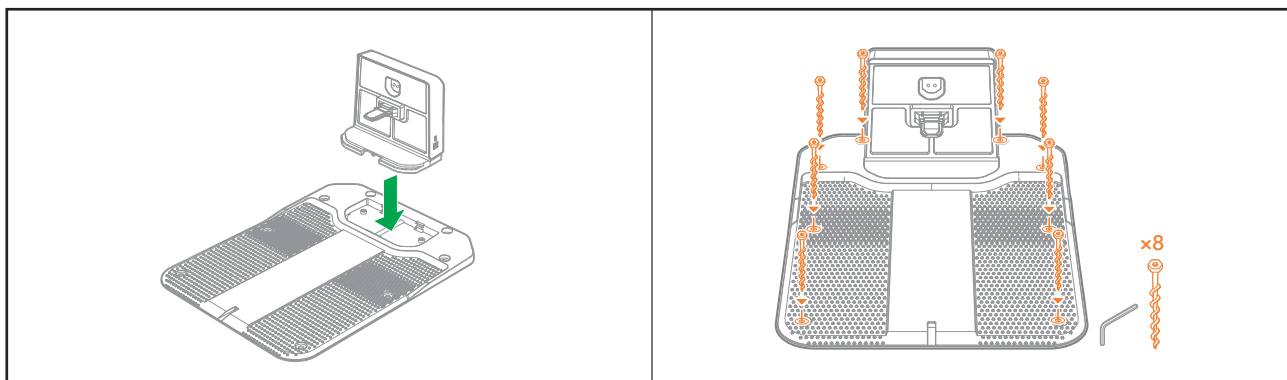

Charging station checklist:

- within reach of AC mains
- in shade (if possible)
- no obstacles, and no area of sparse grass within the 2 m straight path to the charging station
- flat or level location
- no irrigation sprinklers nearby

Charge the Vision Cloud

Connect the charger to an AC mains outlet.

Place Vision Cloud onto the charging station and ensure proper contact.

Check whether the power indicator on the charging station shows a solid green light. If so, the charging station is operating correctly.

Next, start pairing your robot via the Landroid app.

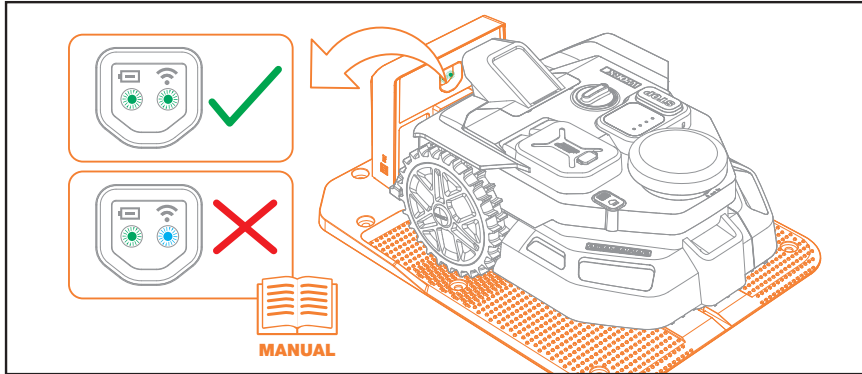

3. POWER ON VISION CLOUD

3.1 Get familiar with the control panel

Vision Cloud's control panel provides the key functions in a minimalistic design. For advanced functions, the free Landroid app provides further options in a richer interface: your smartphone.

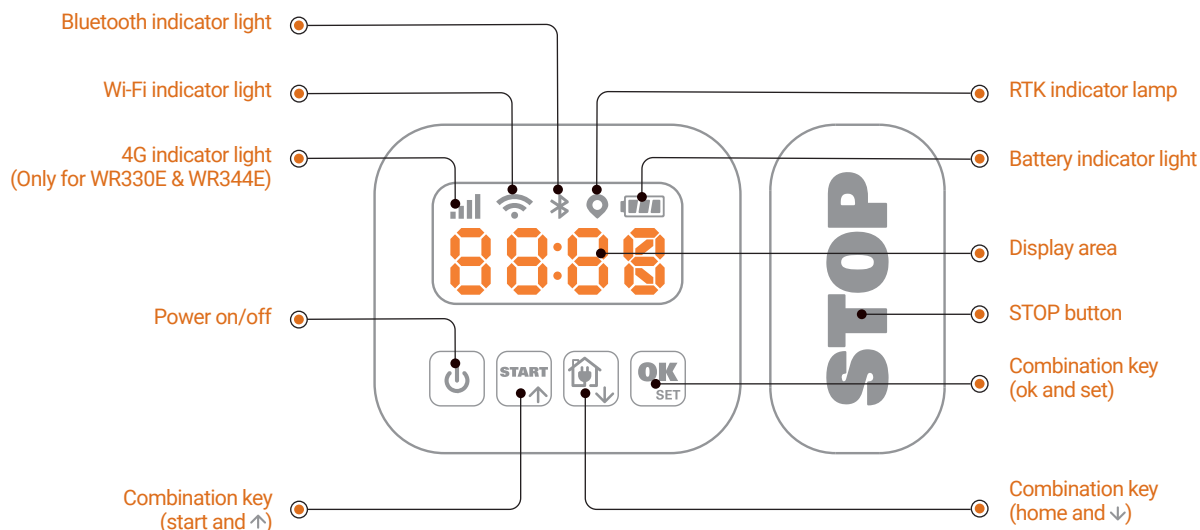

NOTICE: The display "Idle" or "37PI" simply means the mower is in **standby mode**.

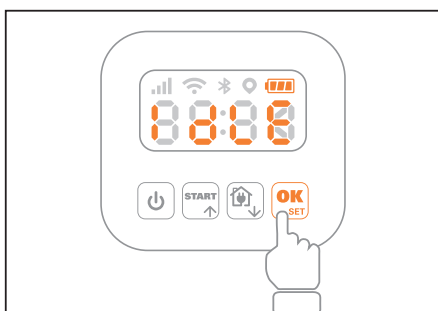

3.2 Power on Vision Cloud

- After position Vision Cloud in the charging station and get it charged, press and hold down **Power on/off** for 5 seconds until the display lights up.
- Enter the default PIN code "0000" by pressing **OK SET** four times. The screen shows "00:00" once the PIN code is correctly entered.

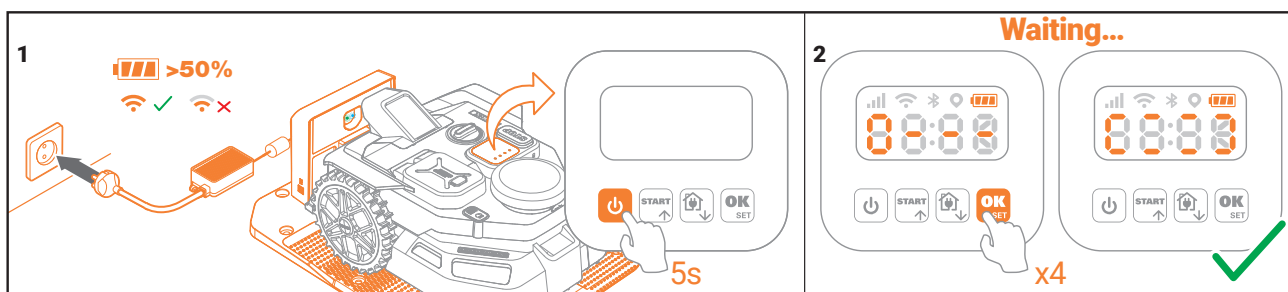

4. CONNECTING VISION CLOUD TO THE INTERNET

Why connect Vision Cloud

Vision Cloud is an IoT (Internet of Things) device. To get full functionality out of your Vision Cloud and keep it always updated to the latest software, it is recommended to be connected to the internet via your Wi-Fi network. The more Vision Cloud mows your lawn, it will become smarter when connected to the internet.

BEFORE YOU START

4.1 Download the app

Download the free Landroid app from the Android or Apple app stores. Register for an account and log in via the app, or sign in with an existing account.

4.2 Ensure you have:

- Your Wi-Fi network password/Bluetooth function enabled on your smartphone.
- The Vision Cloud Serial Number: it can be found on the label under the rear bonnet of the machine.

If you prefer not to manually enter the 20-digit serial number, you can scan the QR code using your smartphone's camera.

4.3 Check your settings

Wi-Fi connection

- Vision Cloud supports 2.4GHz Wi-Fi signals.
- Make sure your Vision Cloud is in the same Wi-Fi router environment as your smartphone.
- During the connection process, ensure the distance between your Vision Cloud, your smartphone, and your router is kept as short as possible.

Bluetooth function

- Ensure the Bluetooth function on your smartphone is activated.
- Make sure your Vision Cloud is within the Bluetooth connectable range.

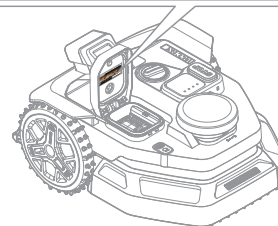
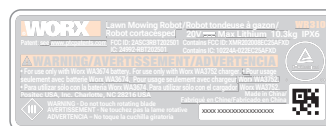

4.4 Activate the "Internet Pairing" state

After Vision Cloud is successfully powered on, press and hold for 5s to enter the "Internet pairing" mode. You can see the "-APP-" sign flashes on the screen.

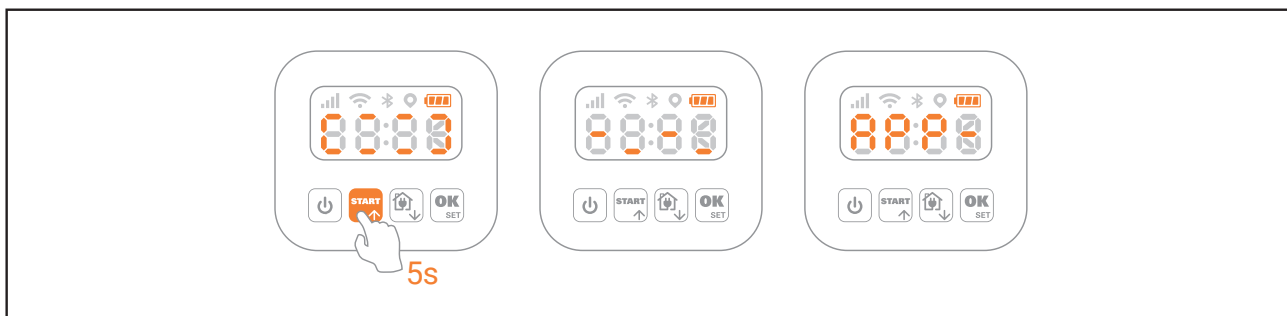

4.5 Setting up Wi-Fi connection via the app

- Before starting the network setup, ensure that Bluetooth and Wi-Fi are enabled on your smartphone, and that it is connected to a 2.4GHz network (5GHz is not supported).
 - Open the Landroid app, tap “Add Landroid”, and scan the QR code located under the battery cover to enter the Wi-Fi setup interface. Then close the battery cover.
- NOTE: Please check that the displayed Wi-Fi name is the network you want to connect to.
- Enter the password for your home 2.4 GHz Wi-Fi network and tap “Connect”.
 - When the screen shows “Connected”, tap “OK” to confirm.

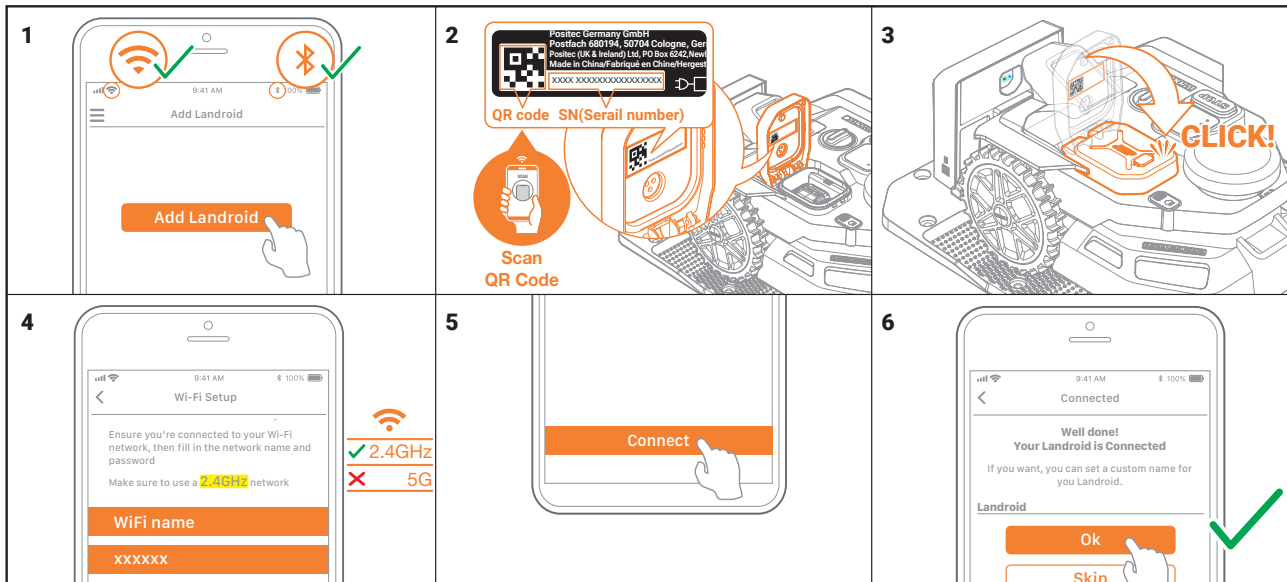

- When both indicator lights on the charging tower turn green, the Wi-Fi connection has been successfully established.

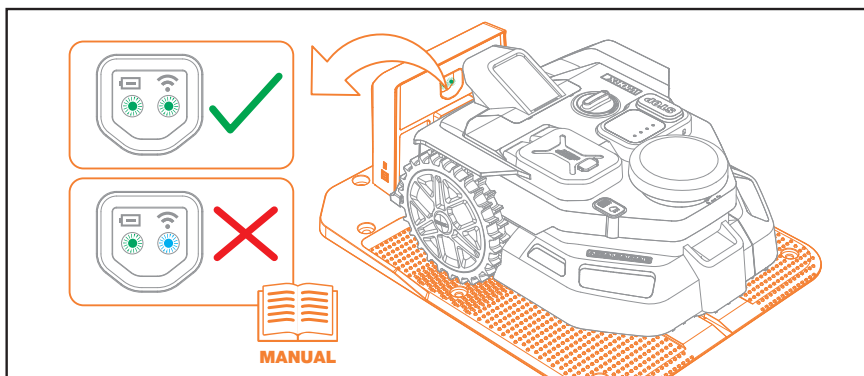

5. UPGRADE THE FIRMWARE

5.1 Check the current firmware version of the Vision Cloud in the app:

- Tap the sidebar icon in the top left corner.
- Select "Firmware Update".
- The screen will display "Current Version." The small grey text below indicates the firmware version currently installed.

5.2 Update the mower's firmware via the app:

- Tap the sidebar icon in the top left corner.
- Select "Firmware Update".
- Tap "Update." The app will send a firmware update request. If the mower is properly connected to Wi-Fi, the update will start. Please wait patiently until the process is complete.

NOTE: During the firmware upgrade process, please make sure Vision Cloud is on the Wi-Fi connection state.

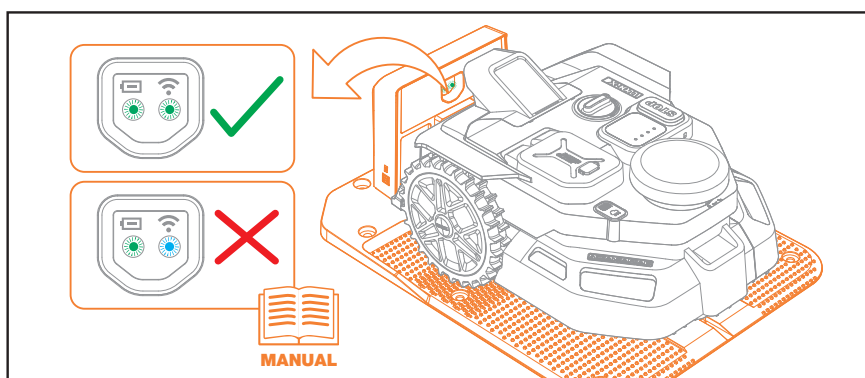
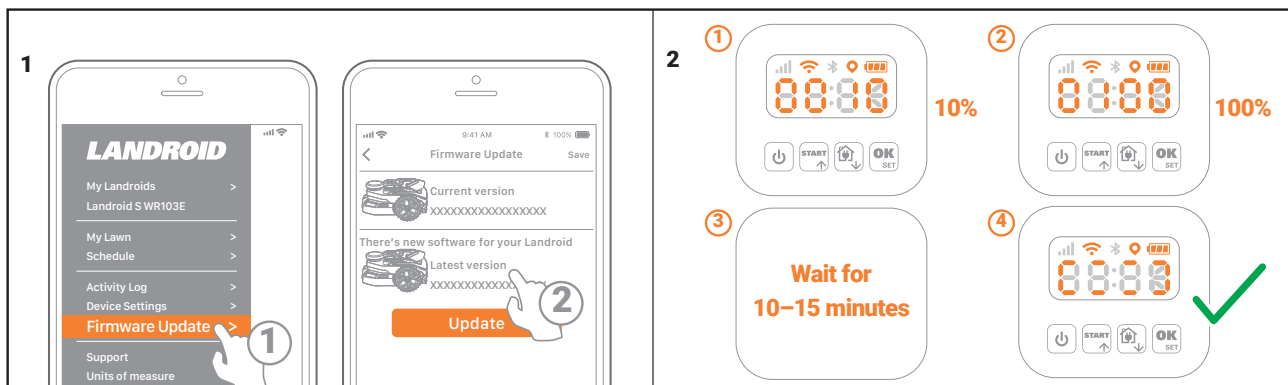

Manual updates

- If your Vision Cloud is not connected to your Wi-Fi network, you can still update it to the latest software version with a USB stick.
- Regularly visit the Vision Cloud website to check if any new version is available. If you subscribed to Vision Cloud email list, you will be notified when a new version is available.
- Download the latest software version at our website.
- Take a blank USB stick formatted in **FAT32**.
- Save the file and extract the content to your USB stick.
- Make sure your Vision Cloud is getting charged.
- Place Vision Cloud on a secure and level surface.
- Keep Vision Cloud power on.
- Open the battery cover of the Vision Cloud to access the USB port.
- Insert the USB stick in the port.
- Place Vision Cloud on the lawn again, inside the working area.
- Without lifting Vision Cloud, remove the USB stick when "USB" is displayed.
- The update will begin automatically and may take a while. Vision Cloud will restart automatically after the update is completed.

NOTE: Make sure Vision Cloud is charging or the battery capacity has reached 50% prior to starting the firmware update.

6. RadioLink (optional)

What is the RadioLink?

RadioLink is a long-range, low-interference wireless communication system built into Vision Cloud.

Even in gardens with limited or no Wi-Fi coverage, it ensures a stable connection across the entire working area. Simply install the RadioLink in a location with Wi-Fi access to extend signal coverage effectively and maintain reliable communication over larger mowing areas.

Typical Scenarios Requiring RadioLink (WR312E / WR318E / WR342E come standard with RadioLink)

To help you determine whether RadioLink installation is necessary, the following sections describe **scenarios where RadioLink is generally not needed** and **typical scenarios where installing RadioLink is recommended**.

6.1 Scenarios where RadioLink is usually not required

In the following cases, installing an additional RadioLink is generally unnecessary:

- The lawn area is relatively small
- Home Wi-Fi coverage is stable across the entire working area
- There are no significant buildings or obstructions within the working area
- The model is equipped with a built-in 4G module

Under these conditions, the Vision Cloud can maintain a normal and stable connection via home Wi-Fi, the built-in 4G module, or the charging station's communication module.

6.2 Typical scenarios where installing RadioLink is recommended

For large lawn areas, the working range is wider and the environment is more complex. In such cases, relying solely on the charging station's communication module may not provide sufficient coverage. Therefore, WR312E / WR318E / WR342E are supplied with **a dedicated Radio-Link module** to extend communication coverage.

Installing RadioLink is recommended if any of the following conditions apply:

- **Large lawn area**
When the working area extends beyond home Wi-Fi coverage and Vision Cloud cannot maintain a stable connection in certain zones.
- **Signal obstruction by buildings**

Houses, garages, or walls may block the signal between Vision Cloud and the charging station or Wi-Fi network, resulting in unstable communication.

- **Complex garden layout or divided lawn areas**

Lawns with front and rear sections or other separated zones may create communication blind spots.

In the above scenarios, installing RadioLink is recommended to extend and supplement signal coverage, ensuring stable communication across the entire working area and reliable operation of Vision Cloud.

Install the RadioLink

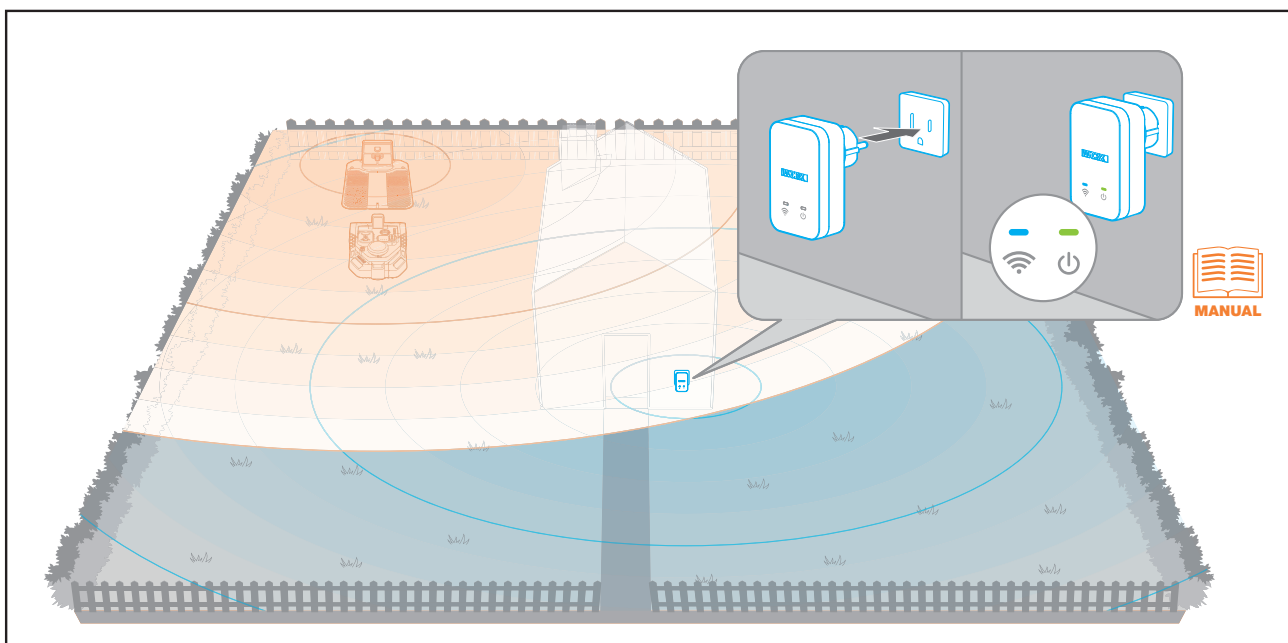

Position 1: Charging station located in the middle of one side of the house

For example, the charging station is installed at a central position on the left side of the house. Due to the house structure, multiple walls may lie between the charging station and the working area on the right side, causing signal attenuation as the signal passes through these walls.

When Vision Cloud is operating on the lawn on the right side of the house, communication with the charging station may become unstable or insufficient. In this case, it is recommended to install a RadioLink in a central location on the right side of the house to enhance and extend communication coverage.

Position 2: Incomplete coverage caused by building obstructions

In this layout, the house or other buildings are located between Vision Cloud and the charging station. Even if the straight-line distance between them is short, the signal may still be weakened due to obstructions.

Explanation:

Buildings can attenuate or block wireless signals, resulting in incomplete or unstable communication coverage. In such cases, installing a RadioLink is recommended to bypass obstructions and extend the effective communication range.

Position 3: Signal blind spots caused by distance or garden layout

In this layout, the working area is large or the garden structure is complex, and the communication range of the charging station cannot reach all working areas.

Distant lawn sections or divided zones (such as front and rear lawns) may form communication blind spots.

Explanation:

Due to increased distance or structural features of the garden, a single communication point may not provide full coverage. Installing a RadioLink can effectively supplement signal coverage, ensuring stable communication throughout the entire working area.

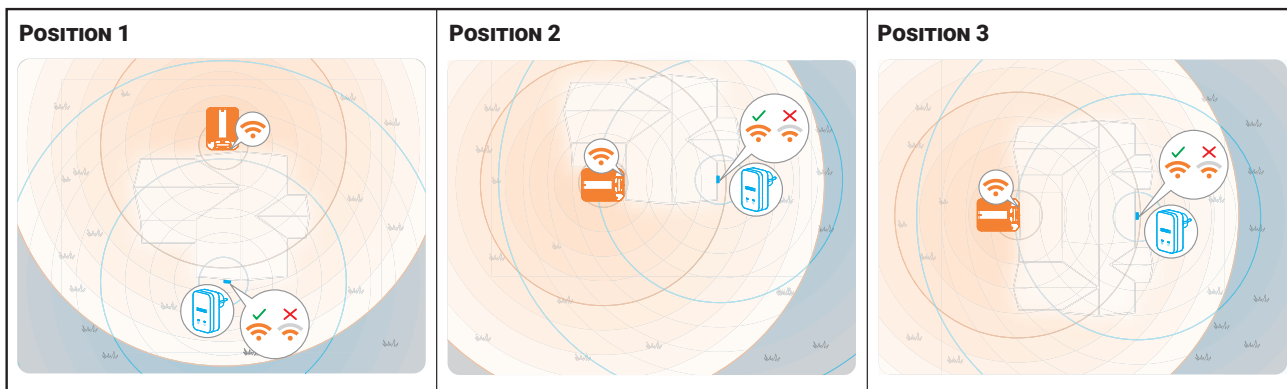

7. CREATE MAP

Before starting mapping, place Vision Cloud on the charging station and ensure proper contact.

Check the indicator lights on the charging station. When both the Wi-Fi signal indicator and the power indicator on the RadioLink turn green, the connection is successful and the system is ready for use.

Single Zone Mapping and No-Go Zone Setup

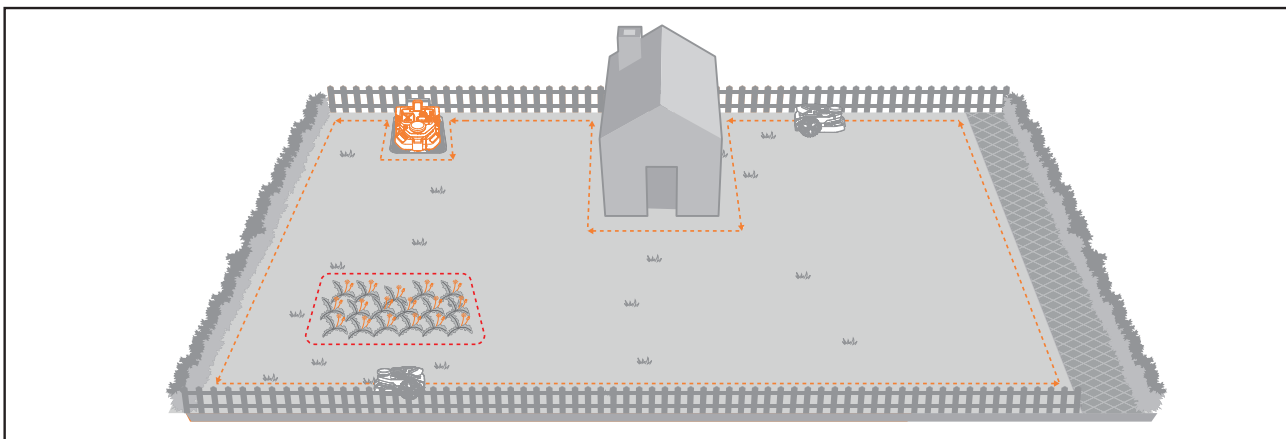

Single Zone Mapping

- Open the app and tap "Create Map".
- Tap "Start". Vision Cloud leaves the charging station and drives once around the lawn edge. If Vision Cloud encounters an overhanging obstacle and detours, switch to Manual Mapping. Vision Cloud will reverse and clear the previous track. Use manual control to guide Vision Cloud close to the clear boundary, then switch back to Auto Mapping.

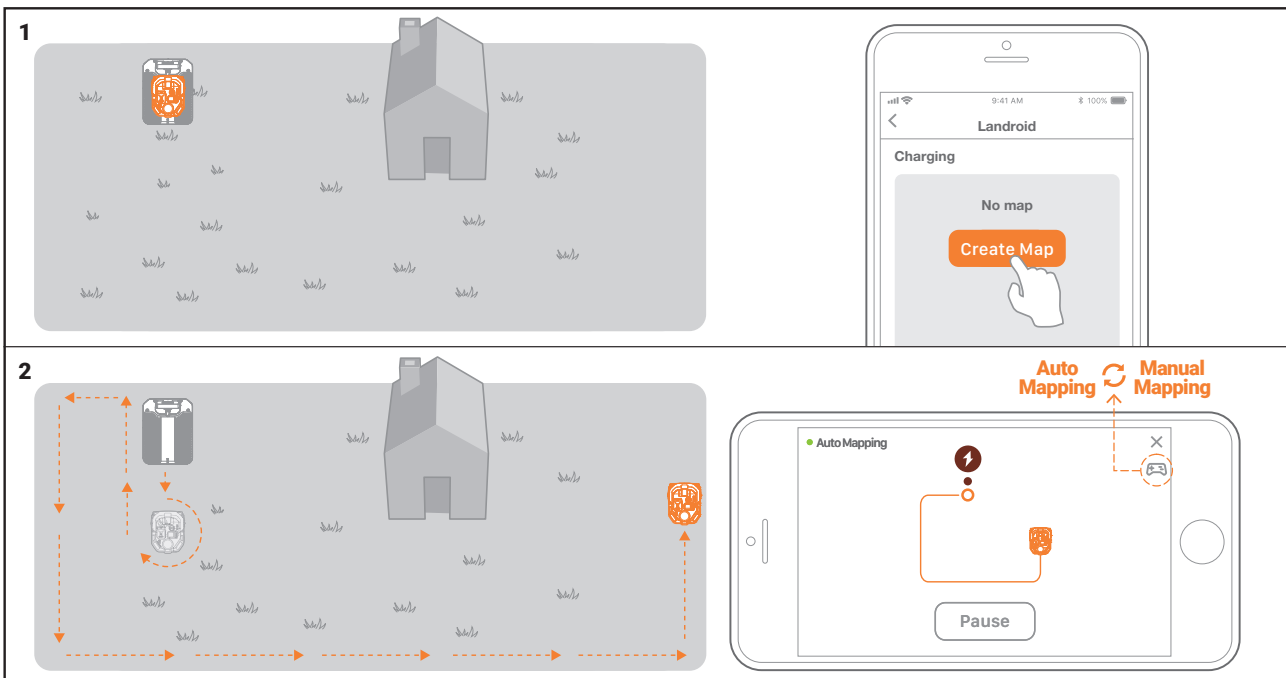

- After tapping "Done", tap "Complete Mapping" to finish mapping procedure, or tap "Add More" to continue mapping the next area.

NOTE: If the charging station is far from the lawn, Vision Cloud may move a short distance and stop after you tap "Create Map". In this case, switch to Manual Mapping, drive Vision Cloud onto the lawn, then switch back to Auto Mapping to start mapping.

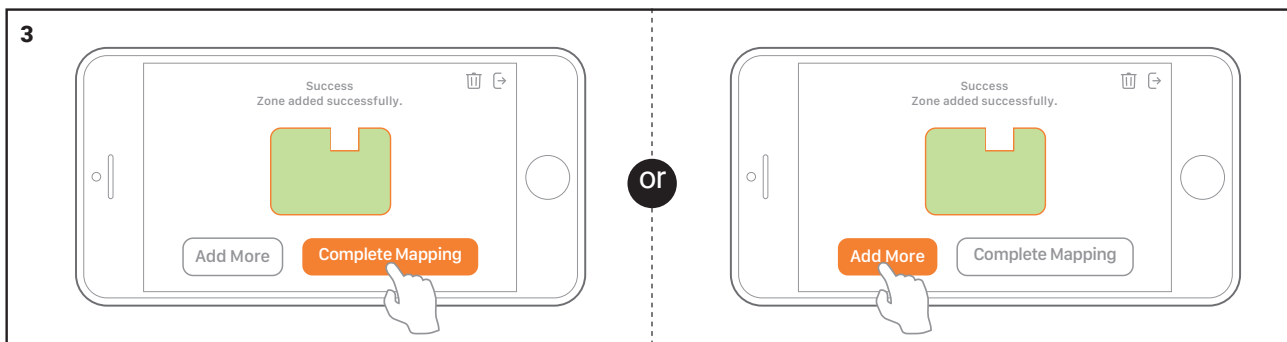

Map editing after mapping completion

If the boundary changes after the map has been created (for example, a flower bed is removed), you can correct the map using the "Map Edit" function in the app.

- Tap "Map", then go to the "My Map" page.
- Tap "Edit" in the top-right corner to enter editing mode.
- Select the area you want to modify and tap "Modify".
- Enter the "Boundary Modify" page.
- Tap the icon in the bottom-right corner to manually adjust the map boundary.

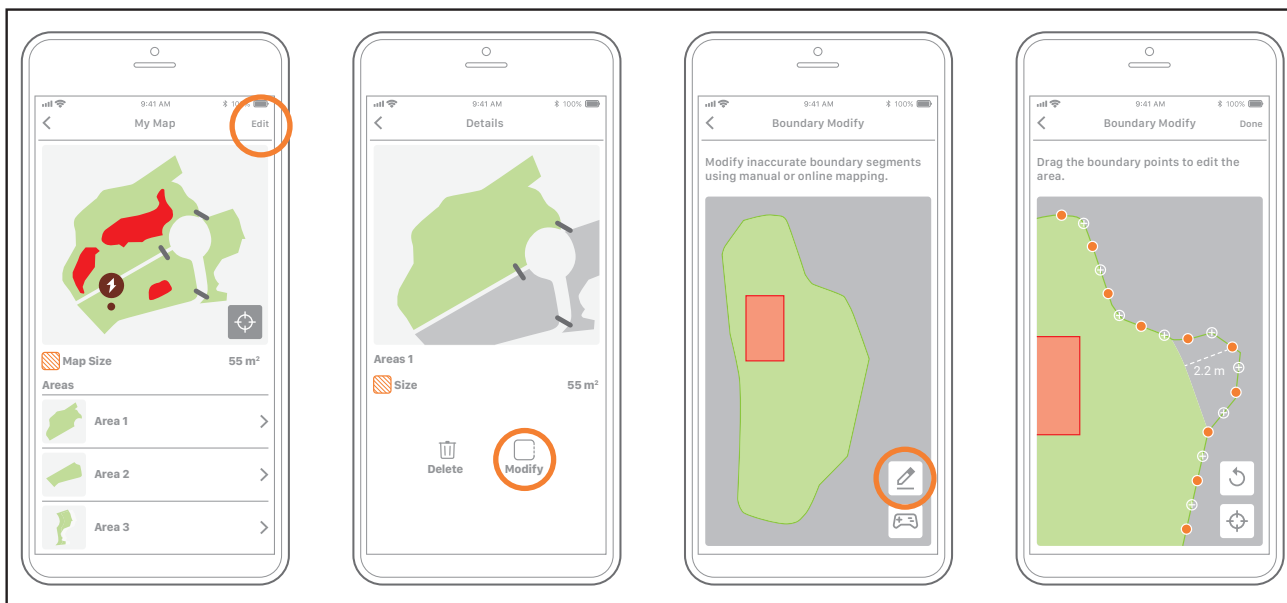

- Tap the  icon in the bottom-right corner to manually adjust the map boundary.



- Manually drive Vision Cloud to the area that needs correction.
- Tap "Start", then manually guide Vision Cloud from the starting point to the ending point.
- Tap "Confirm". The newly created section will replace the previous map segment.

No-Go Zone Setup

If you want to protect areas such as flower beds and prevent Vision Cloud from entering them, you can define these areas as No-Go Zones in the app.

- In the app, tap "Add More" and select "No-Go Zone".
- Manually drive Vision Cloud to the boundary of the area to be restricted and tap "Reached Start Point".

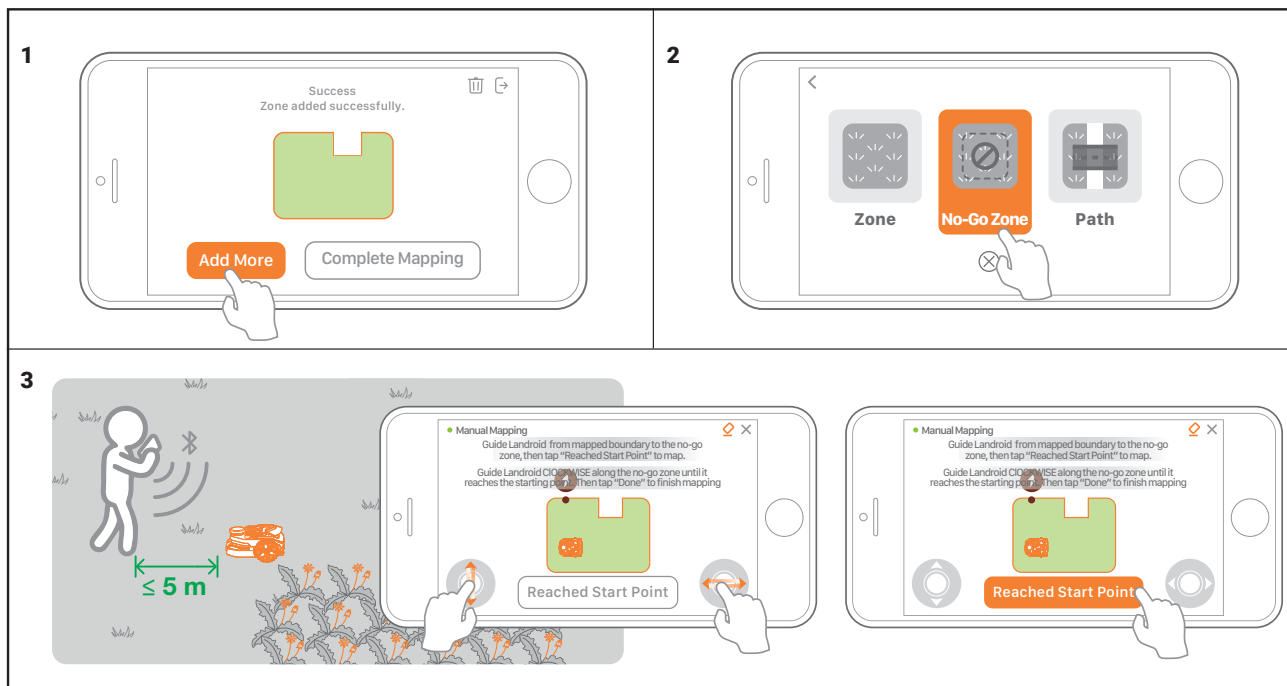

- Then use the app to guide Vision Cloud clockwise around the perimeter of the zone.
- Once the loop is completed, tap "Done". After confirming the boundary, tap "Complete Mapping" to save the No-Go Zone, or tap "Add More" to continue mapping the next area.

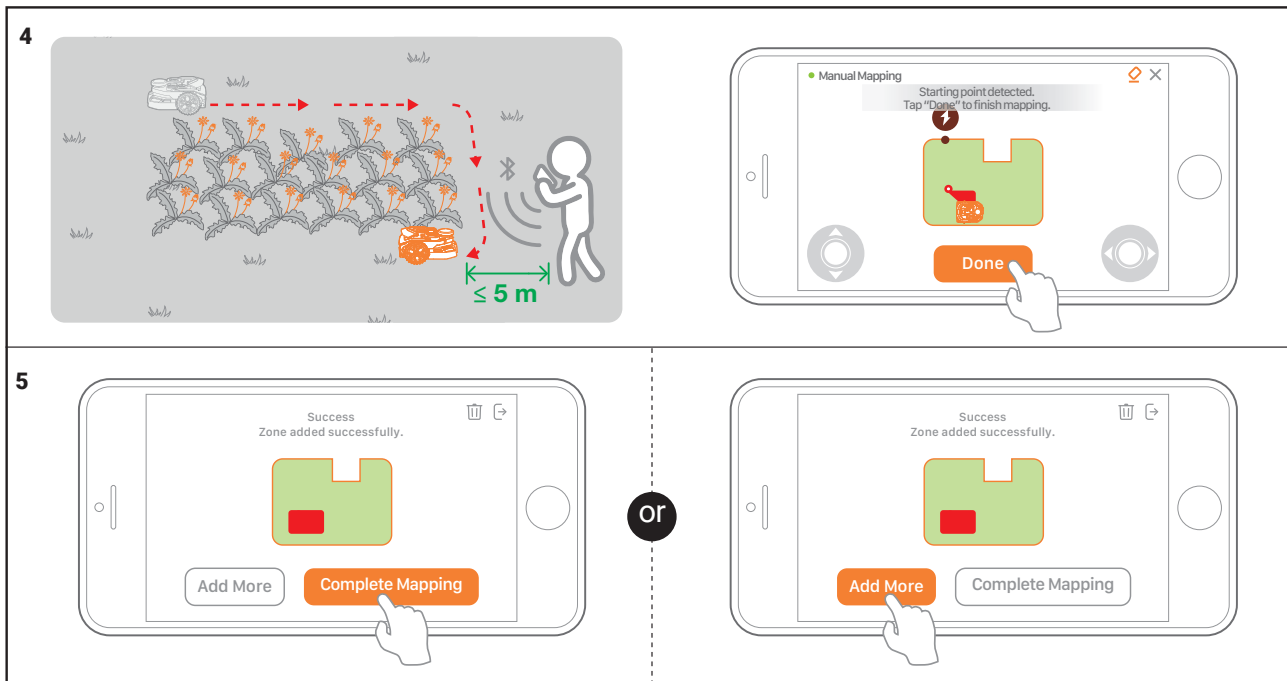

- After mapping is completed, you may tap "Mow now" to start mowing, or tap "Go home" to send Vision Cloud back to the charging station.

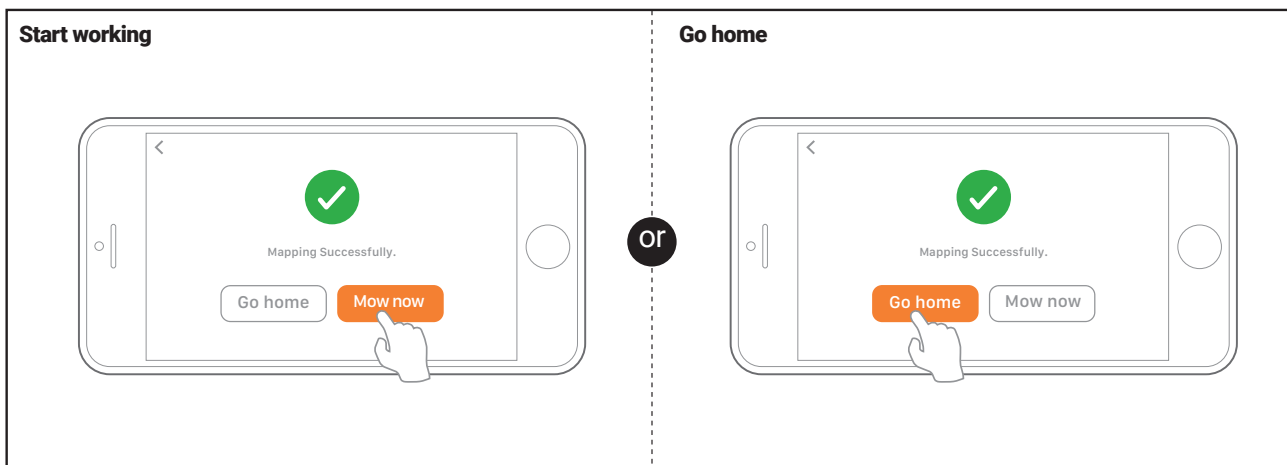

Multi-Zone Mapping

If your garden contains multiple lawn areas, you can create maps for each area using the same steps. It is recommended to first create paths between the areas, and then map each lawn area.

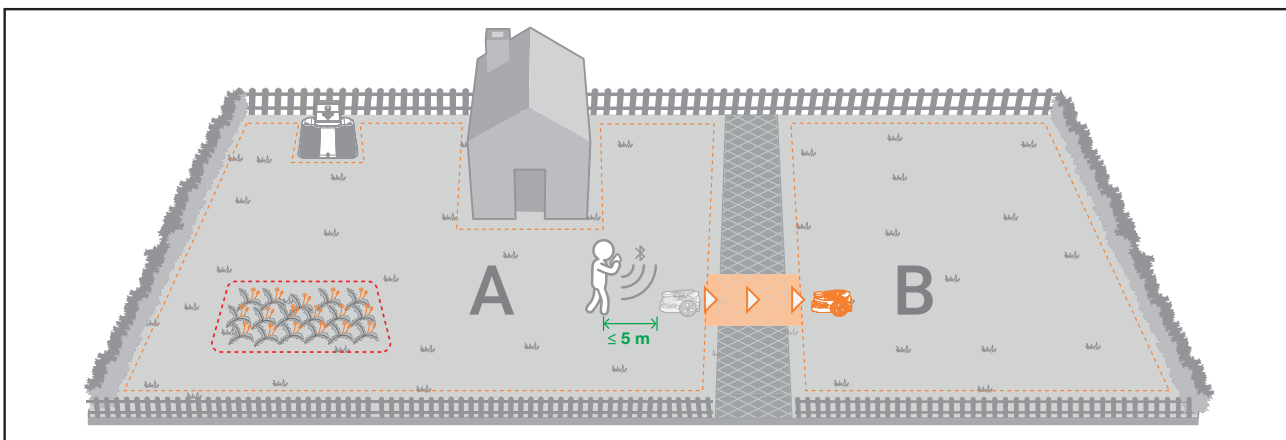

Path

- In the app, tap "Add More" and select "Path".
- Manually drive Vision Cloud to the starting point of the path and tap "Reached Start Point". Then guide Vision Cloud along the passage from one lawn area to the next.

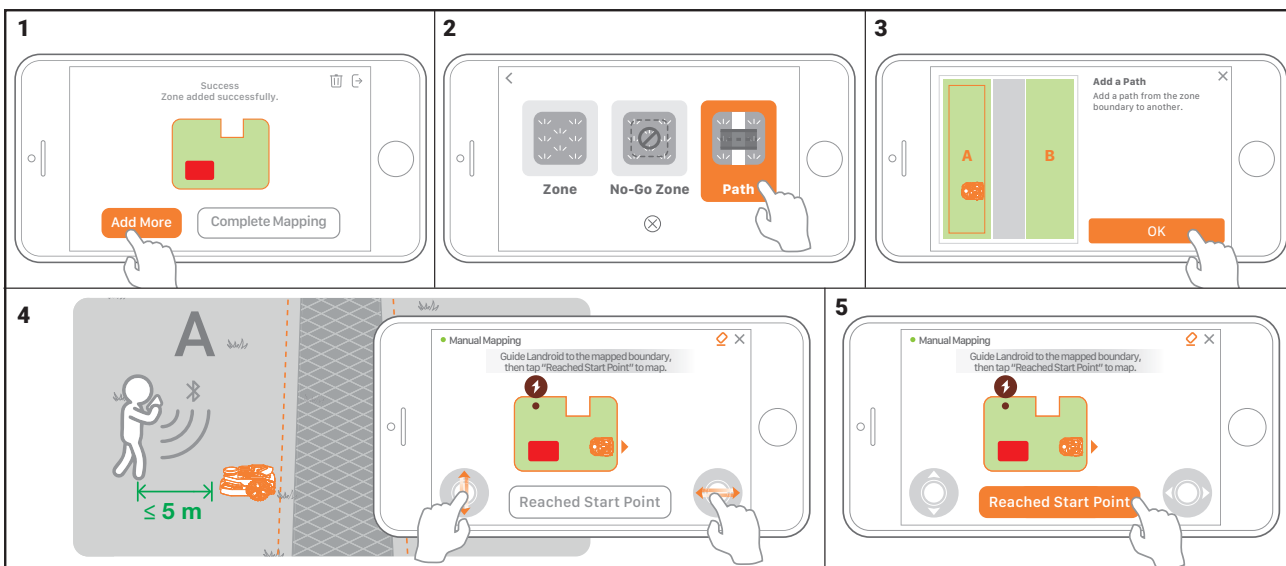

- Then guide Vision Cloud along the passage from one lawn area to the next. When the path is completed, tap "Done" to save it.

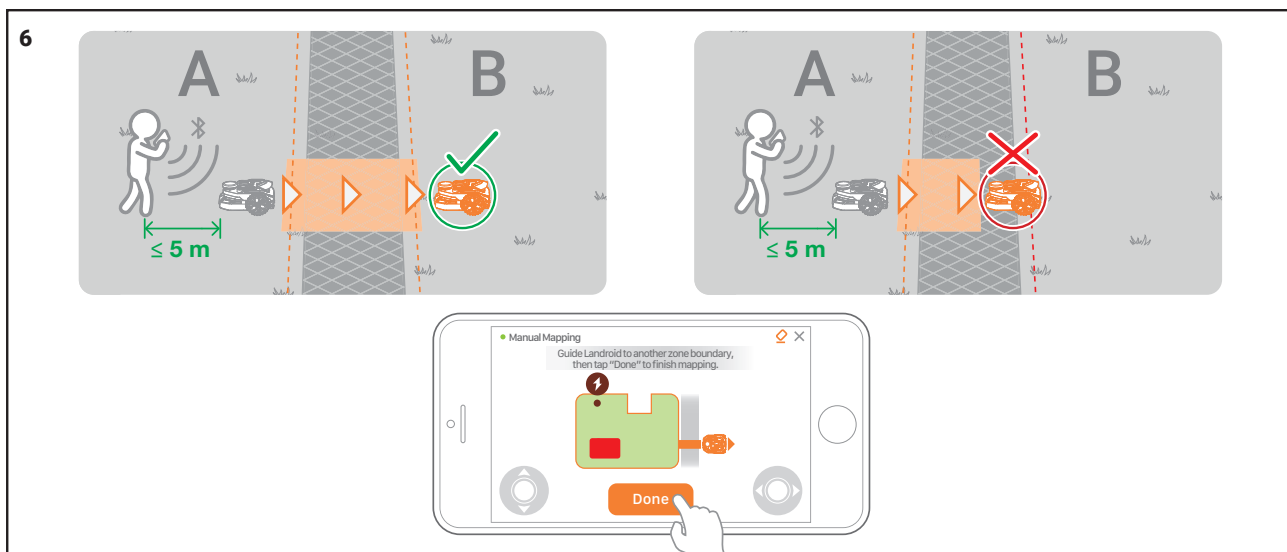

Multi-Zone

- Tap "Add More" again and select "Zone" to start auto mapping for the new area.
- If the auto mapping is not satisfactory, tap the joystick icon to switch to Manual Mapping and control Vision Cloud manually.
- Vision Cloud will automatically map the boundary of the new zone and return to the starting point. You can tap "Complete Mapping" to finish, or tap "Add More" to continue adding paths or additional zones.

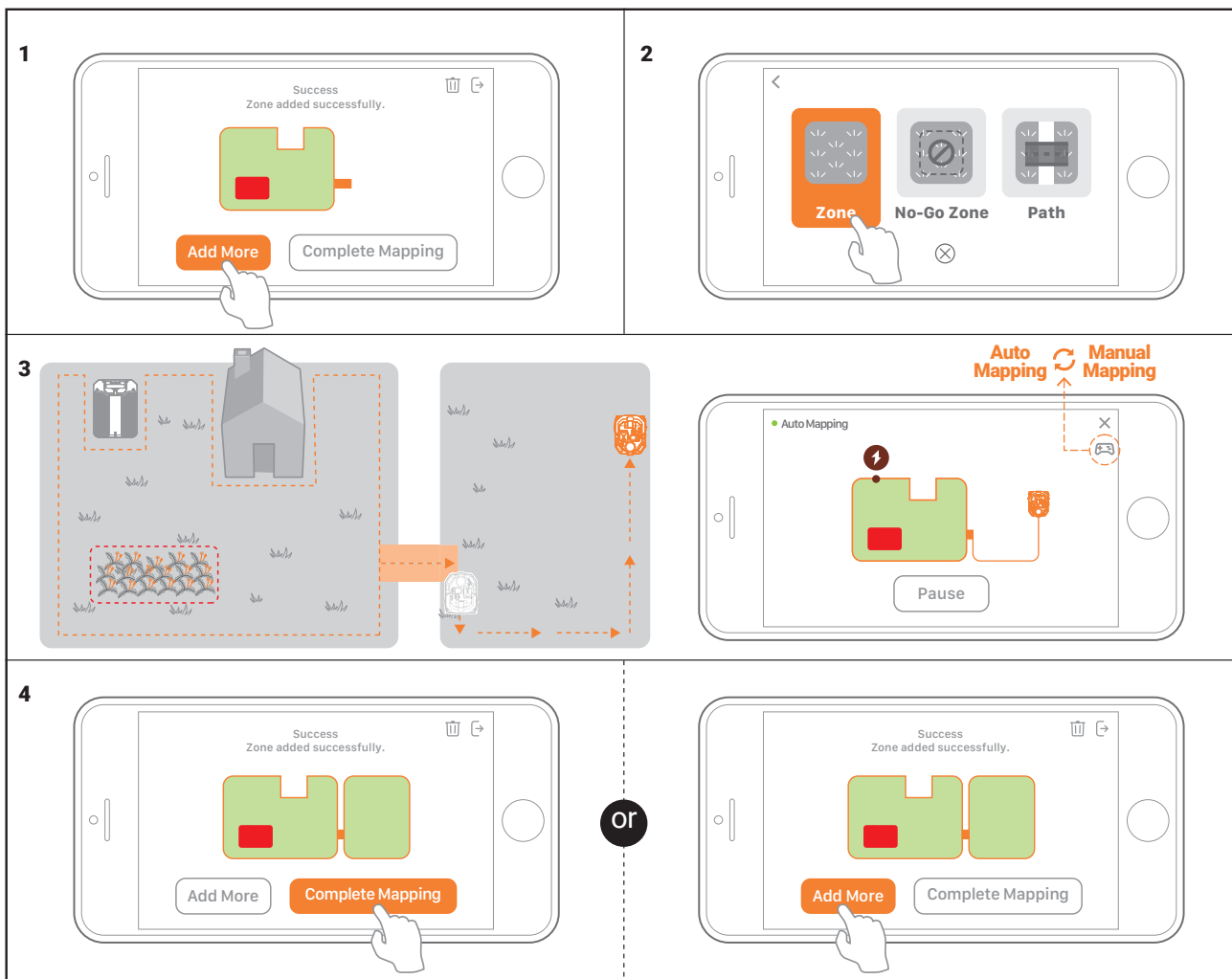

- Once all mapping is completed, tap "Mow now" in the app to start full-area mowing, or tap "Go home" to send Vision Cloud back to the charging station.

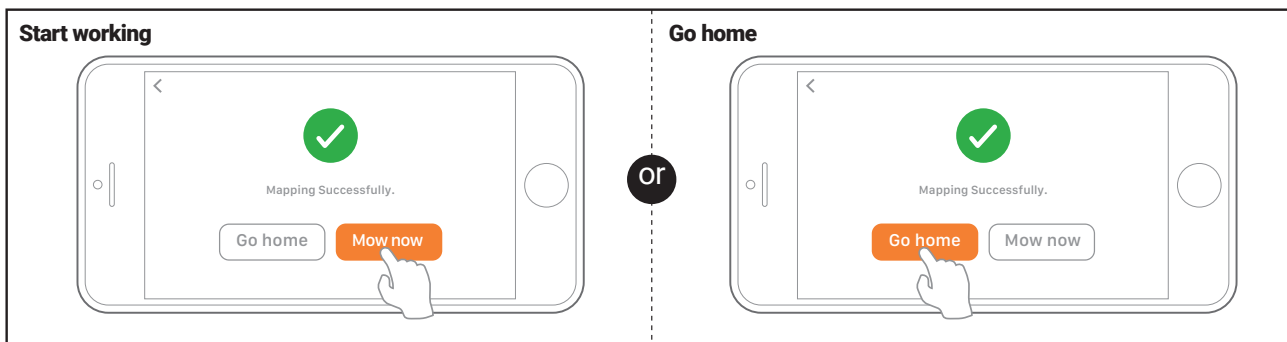

One Time Cutting

You can select a specific zone in the app to perform a one-time localized mowing task. Vision Cloud will automatically navigate to the selected zone and complete the mowing task.

- Select the zone where you want to perform a one-time mowing task.
- If you want Vision Cloud to run an edge routine after completing the mowing of this zone, tap "Edge Routine".
- Tap "Start" to begin the operation.

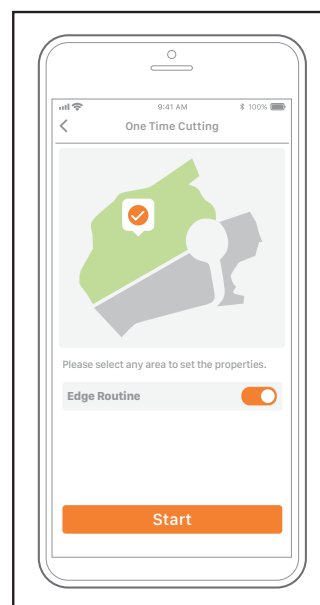

Smart Trim (Intelligent Edge Trimming)

Smart Trim is an intelligent edge-trimming feature designed to deliver cleaner, neater lawn edges.

In standard mowing mode, grass along lawn boundaries may be left uncut due to limited edge coverage. When Smart Trim is enabled, the mower intelligently optimizes its trimming path to improve edge-cutting performance while maintaining safe operation.

With Smart Trim enabled, the mower will:

- Drive closer to lawn boundaries.
- Automatically perform cross-edge trimming when conditions are safe.
- Reduce uncut grass along edges, resulting in a cleaner and more polished lawn appearance.

How to Enable Smart Trim

- Tap Smart Trim.
- Turn Enable on.
- If you want certain edges to be cut strictly according to the mapped boundary, exclude those edges from Smart Trim.

Note: Smart Trim is applicable only to boundaries with a height difference of within 3 cm.



MACHINE SETTING

Start mowing

Press **START** button once, then press **OK SET** button once.
The mower will emit four beeps and begin a one-time mow.

Return to the charging station

When the battery runs low during mowing, Vision Cloud will automatically locate the charging station and return to recharge. Once fully charged, it will resume and complete the previously unfinished mowing task.

We can also manually send Vision Cloud back to the charging station for recharging:

Press the **HOME** button, then press the **OK SET** button to confirm.
Vision Cloud will automatically locate and start going to the charging station.

Change PIN code

- Press and hold **START** and **HOME** at the same time for 5 seconds. The message "PIN" will scroll across the screen. You will now be prompted to enter the old PIN code. (The default PIN is "0000".)
- The first digit will start flashing. Use **START** and **HOME** to choose the number and short press **OK SET** to confirm. The cursor will automatically move to the next digit. Repeat the same process for the remaining digits.
- After entering the old PIN code, the message "PIN 1" will scroll across the screen. You will now be prompted to set a new PIN code. As with the step for entering the old PIN, use **START** and **HOME** to select the digits, then press **OK SET** to confirm. Repeat the process until all four digits of the new PIN code are set.
- After the first input, the message "PIN 2" will appear, prompting you to re-enter the new PIN code.
- Once the second input is complete, the screen will scroll and display the new PIN code (for example: PIN 2342), indicating the change was successful.

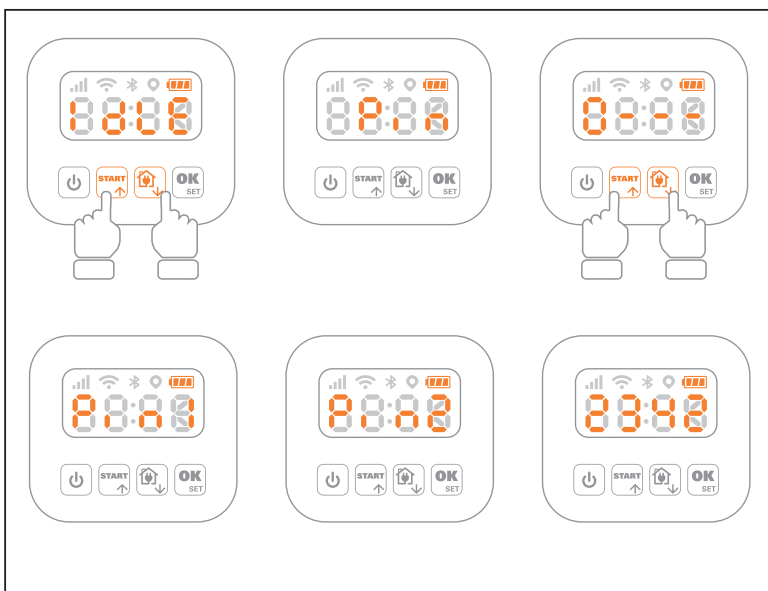

MAINTENANCE

Your mower works hard and needs to be cleaned and checked from time to time. This section of our guide helps you keep your mower in good shape so it can last for years without trouble. Here's how to take care of your mower. Switch off the mower before carrying out any service or maintenance.

KEEP IT SHARP

⚠ WARNING! Before cleaning, adjusting, or replacing the blades, turn your mower OFF and remove the battery. Always wear protective gloves.

Replacing the Blades

- Remove the battery and gently flip the mower over.
- Take the screws off the blades with a screwdriver.
- Firmly screw on the new blades.

Caution: If the Cut to Zero blade assembly needs to be replaced, follow the same replacement procedure as for the main unit blade. If you need to replace the blade located on the inner side near the protective cover, simply rotate the blade disc to turn the inner blade outward for removal. Always wear protective gloves and take appropriate safety precautions to avoid injury.

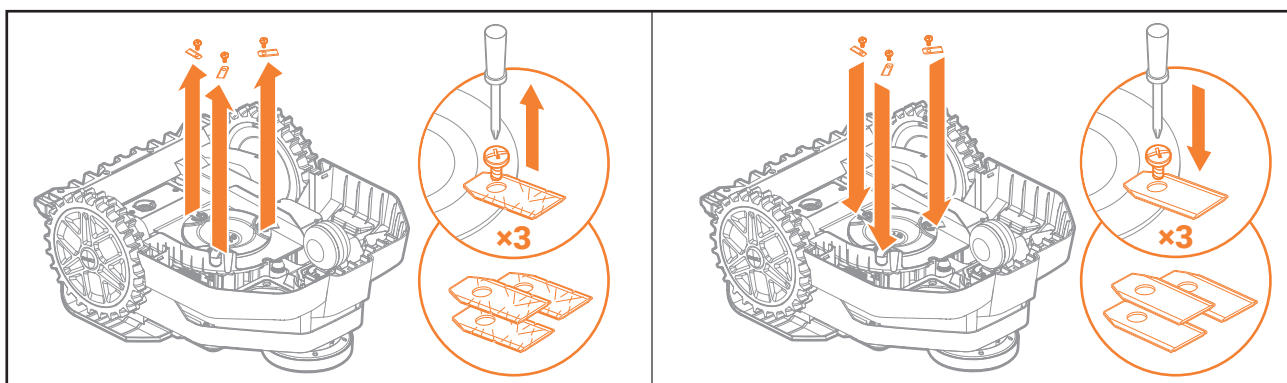

⚠ Attention: When fitting new blades, make sure you replace ALL the blades. Always use new screws when fitting blades. This is important to ensure blade retention and balance the blade turning disc. Failure to use new screws could cause serious injury. Important: After screwing the blade to the blade disc, make sure the blade is able to spin freely.

KEEP IT CLEAN

Your mower should be cleaned regularly. This helps keep it in good condition, especially removing dirt, debris and the build-up of grass clippings from daily mowing. Turn your mower off before cleaning it. For extra safety, remove the battery.

⚠ Attention: Make sure the battery pack cover is closed when washing your mower.
⚠ WARNING! YOUR MOWER can only be washed by using a hose! DO NOT use high pressure washer on your mower. High pressure water can go inside the sealings and damage electronic and mechanical parts.

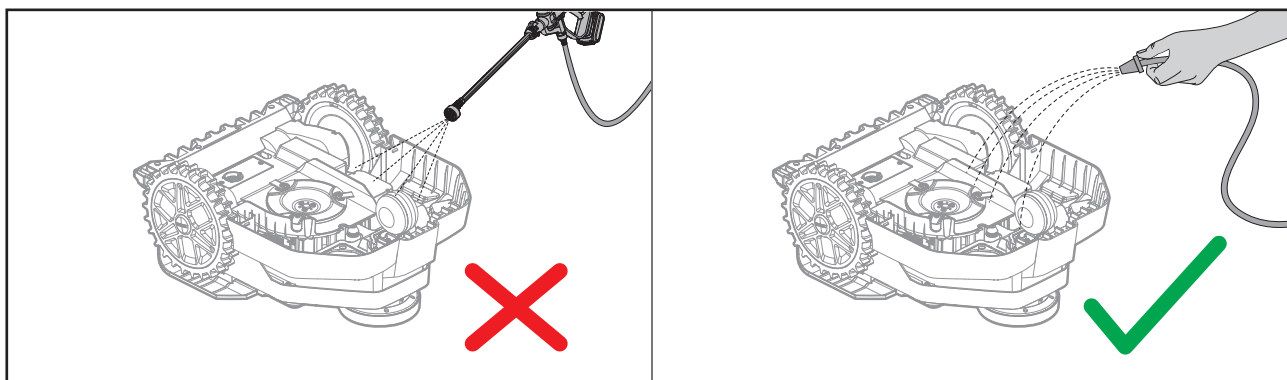

KEEP IT CHARGED

The heart of the mower is its 20V Li-Ion Worx PowerShare Battery.

- For the proper storage of the battery, make sure it is fully charged and kept in a cool dry place.
- The recommended mower operation temperature is between 0-55°C.
- The life-span of the mower's battery depends on hours of usage and the length of use per day during the mowing season.

KEEP IT UPDATED

The mower is always improving and new firmware versions are available for free. Always keep the mower's firmware up to date to make the most of your mower.

Check the current firmware version of the mower in the app:

- Tap the sidebar icon in the top left corner.
- Select "Firmware Update."
- The screen will display "Current Version." The small grey text below indicates the firmware version currently installed.

Update the mower's firmware via the app:

- Tap the sidebar icon in the top left corner.
- Select "Firmware Update."
- Tap "Update." The app will send a firmware update request. If the mower is properly connected to Wi-Fi, the update will start. Please wait patiently until the process is complete.

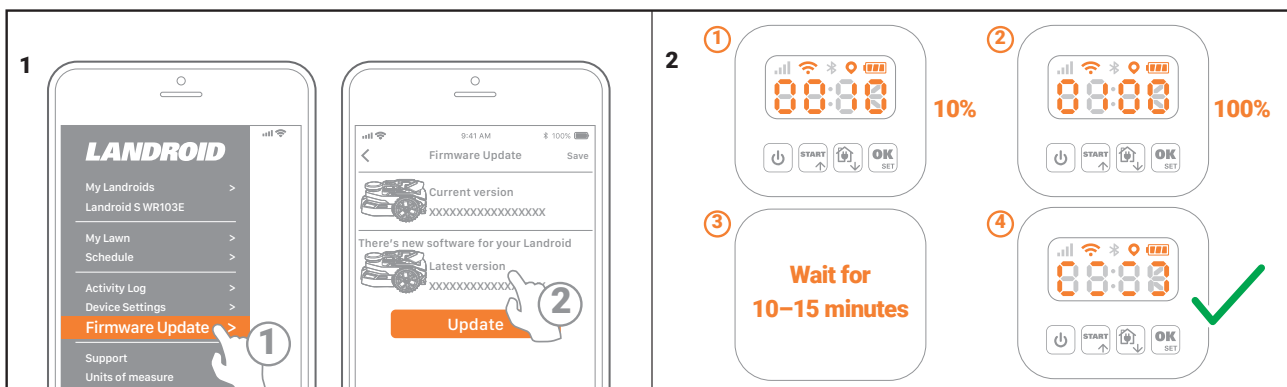

REMOVE THE CHARGING STATION

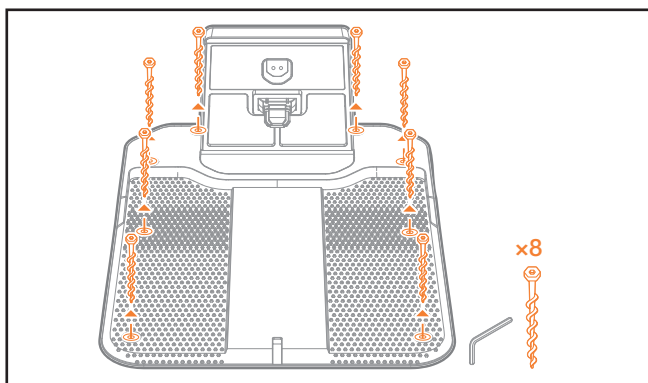

If the charging station requires repair or needs to be stored for a long period, it can be completely removed.







This section contains a guide on operation and potential error messages your mower displays. There is also a troubleshooting section at the end that is designed to help you understand and solve any issues.

ERROR MESSAGES

Sometimes things can go wrong. Fortunately, the mower is smart enough to tell you if it encounters an issue, so you can fix it. If in doubt, please visit our website where you will find useful videos and further support.

MESSAGE	CAUSE	ACTION
-EE-	Error unknown	Please restart the mower.
-F01-	Rain delay	The mower is in rain delay state.
-F02-	Low battery	The mower is low on power.
-E01-	Out of working area	Take the mower back to the charging station to charge, then restart it.
-E02-	Wheels motor fault	Turn off the mower, flip the mower over, and check for anything blocking the wheels; if found, please remove it.
-E03-	Blade motor fault	Turn off the mower and flip it over. Put on safety gloves to avoid injury and check whether anything is blocking the blade disc. If so, please remove it.
-E05-	Mower Lifted	Place the mower on level ground, press  then press  to resume normal operation.
-E06-	Mower upside down	
-E07-	Battery charge error	Battery temperature too low: When the outside temperature is below 0 °C, operation is not suitable and the mower will stop charging. Please store the mower indoors. Power supply is broken: please contact Customer Services.
-E08-	The mower cannot find charging station	The charging station is not installed in an appropriate location—it may be surrounded by obstacles or placed on uneven ground. Please check the installation site.
-E09-	Map not detected	Please check whether a map has been created for this area. If not, create a map in the app and make sure to click “Save” to complete the process.
-E11-	Battery temperature is out of range	The battery temperature is too high. When the temperature is lowered to 55°C, the mower will return to normal work.
-E12-	Camera is covered	Please clean the cover on the camera. Verify whether the mower’s decorative cover is lifted; if so, reinstall it properly.
-E14-	Insufficient light	In the schedule, set the mower to return to the charging station before dusk, or purchase an FiatLux light from a store.
-E16-	The mower failed to transfer between zones.	Check whether there are any obstacles in the passage and remove them if present. If the problem persists, recreate the passage in the map.

NOTES

- Before turning power on, always check the mower is inside its working area.
- If for any reason—i.e. a party, children playing...—you want to park your mower in the charging station: press  then . The mower will go to its station and stay there. Please note that the mower will now wait until the next scheduled mowing session. If you want to re-start it at anytime, press  then  to start your mower.
- If an error repeatedly occurs in the same area of your lawn, you might have a problem with the working area so please refer to the installation instructions and check your set up is correct with its help.
- If your lawn is divided in two separated areas, connected by a corridor less than 1m wide, one of which is not provided with the charging station: when the mower runs out of charge, take it manually to the charging station.
- If the mower runs abnormally once in a while, please reset it by turning it off and removing the battery for 30 seconds, then restart it. If the problem cannot be solved, please contact our Customer Service for help.



TROUBLESHOOTING

If your mower does not work correctly, follow the troubleshooting guide below. Scan the QR code for more troubleshooting.

SYMPTOM	CAUSE	SOLUTION
The mower can not find the charging station.	There are obstacles in front of the charging station.	Please remove the obstacles within the 2 m in front of the charging station.
	The QR code is sheltered.	Make sure the QR code is clear and that there is nothing directly on it or above it.
	The charging station has been installed in a shaded area.	Please relocate the charging station to a place without tall walls or trees on either side that may cause shade.
The secondary area is not mowed.	Incorrectly mapping	Please delete and remap the passage.
	There are obstacles in the passage.	Remove the obstacles.
The mower is not operating at the correct time.	The clock is not set to the correct time.	Keep the mower connected to Wi-Fi, then reset the working schedule.
	The previous mowing task was not completed.	The mower will continue the unfinished task.
The mower shuts off when docking in the charging pile.	The mower fails to charge due to over temperature protection and is powered off.	Place the charging station in a shady area or wait until the temperature has cooled down.
	Poor connection.	Check the LED light on the charging pile. Check the connection between the contact pins located on the charging pile and the charging strip.
The mower fails to connect to the internet.	Please check your router has the correct settings.	Make sure your router is 2.4GHz. If your router has two settings, please enable the 2.4GHz band. Make sure your router is set to 802.11 mode and wireless setting is b/g/n mixed. Make sure your router has the SSID Broadcast function enabled when you connect the mower with the app. You can close it after you connect successfully. Make sure DHCP function is enabled. If you changed your Wi-Fi network, you need to connect the mower to the new network.
	Please check whether the router is disconnected or Wi-Fi SSID is changed.	Make sure the router is connected and Wi-Fi SSID is correct.
The firmware upgrade fails.	The Wi-Fi signal is weak.	Move closer to the router to strengthen the signal.
	The battery level is less than 50%.	Place the mower on the charging station or ensure that the battery level is above 50%.
Charging station indicator is solid blue	The charging station has lost connection with the mower.	Check if the mower is too far from the charging station. If the mower frequently disconnects at a certain location, adjust the placement of the charging station according to the instructions in the QSG.
Charging station indicator is flashing green and blue alternately	The charging station is not connected, or not yet connected, to the home Wi-Fi.	Make sure the mower is successfully paired with the app. If pairing is complete, check the Wi-Fi signal strength on your smartphone. If the signal is weak, the charging station may be too far from the router. 1. Reposition the charging station following the instructions in the QSG. 2. Move the router closer to the charging station. 3. Buy a Wi-Fi signal booster.
When the mower is equipped with the Cut to Zero module, its housing may often get stuck on raised obstacles.	The selected Cut to Zero cutting height is too low.	Check the Cut to Zero height setting and adjust it one level higher.

Environmental protection



Waste electrical products should not be disposed of with household waste. Please recycle where facilities exist. Check with your Local Authority or retailer for recycling advice.

For battery tools:

Details regarding safe disposal of used batteries

At the end of the life of the appliance, remove the battery pack safely before disposing of the appliance. Do not throw batteries away or throw them in the normal trash can. Also do not dispose of the battery with the machine. Remove the used battery pack from the appliance and dispose of it at the nearest or convenient dedicated recycling facility. If in doubt, consult your local environmental protection department. Batteries may enter water cycle if disposed improperly, which can be hazardous for ecosystem. Do not dispose of waste batteries as unsorted municipal waste.

We, Positec Technology (China) Co., Ltd, hereby declare, that the below product(s) covered in this document are in conformance with the applicable security requirements in Schedule 1 of The Product Security and Telecommunications Infrastructure (Security Requirements for Relevant Connectable Products) Regulations 2023 (“**Security Requirements**”)

Please note that this statement of compliance, including the Defined Support Period stated herein, is only applicable to products sold in the UK.

Positec Technology (China) Co., Ltd welcomes input on potential firmware vulnerabilities so that we can take appropriate steps to maintain the security of our products and systems. Information on how to report security questions, issues or possible incidents to the Product Security Team can be found here:

Link: <https://security.positecgroup.com>

Network Interface Description

The following network interfaces are enabled by default when the device is powered on:

- Bluetooth

Enables pairing and binding between the device and the mobile app. Supports Wi-Fi configuration via the app. During the mapping process, Bluetooth also allows for device control and management.

- Wi-Fi

Connects the device to the home wireless network for data communication with the cloud server. Supports remote monitoring, control, and parameter configuration via the app. Also enables OTA (Over-The-Air) firmware updates to ensure timely firmware optimization.

- 4G Cellular Network

Provides connectivity to the cloud server in the absence of Wi-Fi, ensuring continuous communication between the device and the app for remote interaction, data synchronization, and control.

- RadioLink

Connects to the compatible charging station to receive high-precision RTK positioning data. Enables centimeter-level positioning accuracy, enhancing navigation stability and operational precision.

TECHNICAL DATA

Type **WR303E WR305E WR365E WR365E.1 WR308E (200-399 - designation of machinery, representative of Robotic lawn mower with Vision technology)**



	WR303E	WR305E	WR365E	WR365E.1	WR308E
Rated voltage	20V Max.*				
No load speed (/min)	2800 /min				
Cutting area (m ²)	300 m ²	500 m ²	650 m ²		800 m ²
Cutting diameter (cm)	18 cm				
Cutting height (mm)	30-40-50-60 mm				
Cutting height adjustment method	Manual				
Cutting system	3 blades				
Cut to Zero	N			Y	
Cutting height of the Cut to Zero	/			1-2-3 50-60-70 mm	
Camera	Mono		Stereo		
Slope (%)	30% (17°)**				
Battery type	Lithium-ion				
Battery Capacity (Ah)	2.5 Ah		4 Ah		
Battery model	WA3640		WA3644		
Charging time approx. (mins.)	100 mins.		80mins.		
Charger model	WA3931 / WA3932		WA3775 / WA3776		
Charger rating	Input:100-240 V~50/60 Hz, 48W, Output: 20 V , 1.5 A		Input:100-240 V~50/60 Hz, 90W, Output: 20 V , 3.0 A		
Machinery weight (kg)	11.1 kg		11.4 kg		12.8 kg
Protection degree	III				
App (Wi-Fi/Bluetooth)	Y				
Frequency bands for Bluetooth (MHz)	2400-2483.5 MHz				
Maximum Transmitted Power for Bluetooth (dBm)	8 dBm				
Frequency bands for Wi-Fi (MHz)	2400-2483.5 MHz				
Maximum Transmitted Power for Wi-Fi (dBm)	20 dBm				
Waterproof level	IPX 6				

*Voltage is measured under no-load condition. The initial maximum battery voltage can reach 20 volts, while the nominal voltage is 18 volts.

**If the mower is equipped with the Cut to Zero module, it is not recommended to operate the mower on slopes greater than 15°.

TECHNICAL DATA

 Type **WR304E WR306E WR310E (200-399 - designation of machinery, representative of Robotic lawn mower with Vision technology)**



	WR304E	WR306E	WR310E
Rated voltage	20V  Max.*		
No load speed (/min)	2800 /min		2400 /min
Cutting area (m ²)	400 m ²	600 m ²	1000 m ²
Cutting diameter (cm)	18 cm		22 cm
Cutting height (mm)	30-40-50-60 mm		
Cutting height adjustment method	Manual		Electric
Cutting system	3 blades		
Cut to Zero	N	Y	
Cutting height of the Cut to Zero	/	1-2-3 50-60-70 mm	
Camera	Mono	Stereo	
Slope (%)	30% (17°)**		
Battery type	Lithium-ion		
Battery Capacity (Ah)	2.5 Ah	4 Ah	
Battery model	WA3640	WA3644	
Charging time approx. (mins.)	100 mins.	80 mins.	
Charger model	WA3931 / WA3932	WA3775 / WA3776	
Charger rating	Input: 100-240 V~50/60 Hz, 48W, Output: 20 V  , 1.5 A	Input: 100-240 V~50/60 Hz, 90W, Output: 20 V  , 3.0 A	
Machinery weight (kg)	11.1 kg	12.8 kg	14.3 kg
Protection degree	III		
App (Wi-Fi/Bluetooth)	Y		
Frequency bands for Bluetooth (MHz)	2400-2483.5 MHz		
Maximum Transmitted Power for Bluetooth (dBm)	8 dBm		
Frequency bands for Wi-Fi (MHz)	2400-2483.5 MHz		
Maximum Transmitted Power for Wi-Fi (dBm)	20 dBm		
Waterproof level	IPX 6		

*Voltage is measured under no-load condition. The initial maximum battery voltage can reach 20 volts, while the nominal voltage is 18 volts.

**If the mower is equipped with the Cut to Zero module, it is not recommended to operate the mower on slopes greater than 15°.

TECHNICAL DATA

 Type **WR312E WR318E WR330E (200-399 - designation of machinery, representative of Robotic lawn mower with Vision technology)**



	WR312E	WR318E	WR330E
Rated voltage	20V  Max.*		
No load speed (/min)	2400 /min		
Cutting area (m ²)	1200 m ²	1800 m ²	3000 m ²
Cutting diameter (cm)	22 cm		
Cutting height (mm)	30-40-50-60 mm		
Cutting height adjustment method	Electric		
Cutting system	3 blades		
Cut to Zero	Y		
Cutting height of the Cut to Zero	1-2-3 50-60-70 mm		
Camera	Stereo		
Slope (%)	30% (17°)**		
Battery type	Lithium-ion		
Battery Capacity (Ah)	4 Ah	5 Ah	
Battery model	WA3644	WA3645	
Charging time approx. (mins.)	80 mins.	100 mins.	60 mins.
Charger model	WA3775 / WA3776		WA3796 / WA3798
Charger rating	Input:100-240 V~50/60 Hz, 90W, Output: 20 V  , 3.0 A		Input:100-240 V~50/60 Hz, 190W, Output: 28 V  , 5.0 A
Machinery weight (kg)	14.3 kg		
Protection degree	III		
App (Wi-Fi/Bluetooth)	Y		
Frequency bands for Bluetooth (MHz)	2400-2483.5 MHz		
Maximum Transmitted Power for Bluetooth (dBm)	8 dBm		
Frequency bands for Wi-Fi (MHz)	2400-2483.5 MHz		
Maximum Transmitted Power for Wi-Fi (dBm)	20 dBm		
Waterproof level	IPX 6		

*Voltage is measured under no-load condition. The initial maximum battery voltage can reach 20 volts, while the nominal voltage is 18 volts.

**If the mower is equipped with the Cut to Zero module, it is not recommended to operate the mower on slopes greater than 15°.

TECHNICAL DATA

Type **WR340E WR341E WR342E WR344E (200-399 - designation of machinery, representative of Robotic lawn mower with Vision technology)**

	WR340E	WR341E	WR342E	WR344E
Rated voltage	20V  Max.*			
No load speed (/min)	2600 /min	2400 /min		
Cutting area (m ²)	600 m ²	1000 m ²	2000 m ²	4000 m ²
Cutting diameter (cm)	20 cm	22 cm		
Cutting height (mm)	20-30-40-50-60-70 mm			
Cutting height adjustment method	Electric			
Cutting system	3 blades			
Cut to Zero	N		Y	
Cutting height of the Cut to Zero	/		1-2-3 50-60-70 mm	
Cut to Zero width	/		110 mm	
Camera	Stereo			
Slope (%)	84% (40°)**			
Battery type	Lithium-ion			
Battery Capacity (Ah)	4 Ah	5 Ah		
Battery model	WA3644	WA3645		
Charging time approx. (mins.)	80 mins.	100 mins.	60 mins.	
Charger model	WA3775 / WA3776		WA3796 / WA3798	
Charger rating	Input: 100-240 V~50/60 Hz, 90W, Output: 20 V  , 3.0 A		Input: 100-240 V~50/60 Hz, 190W, Output: 28 V  , 5.0 A	
Machinery weight (kg)	17.8 kg	17.9 kg	19 kg	
Protection degree	III			
App (Wi-Fi/Bluetooth)	Y			
Frequency bands for Bluetooth (MHz)	2400-2483.5 MHz			
Maximum Transmitted Power for Bluetooth (dBm)	8 dBm			
Frequency bands for Wi-Fi (MHz)	2400-2483.5 MHz			
Maximum Transmitted Power for Wi-Fi (dBm)	20 dBm			
Waterproof level	IPX 6			

*Voltage is measured under no-load condition. The initial maximum battery voltage can reach 20 volts, while the nominal voltage is 18 volts.

**If the mower is equipped with the Cut to Zero module, it is not recommended to operate the mower on slopes greater than 15°.

TECHNICAL DATA FOR 4G (WR330E / WR344E ONLY)

Band	Tx(Mhz)	Rx(Mhz)	RF Output Power (Max)
GSM900(B8)	880-915	925-960	33dBm
DCS1800(B3)	1710-1785	1805-1880	30dBm
WCDMA B1	1920-1980	2110-2170	24dBm
WCDMA B8	880-915	925-960	24dBm
WCDMA Band V	824-849	869-894	24dBm
LTE-FDD B1	1920-1980	2110-2170	23dBm
LTE-FDD B3	1710-1785	1805-1880	23dBm
LTE-FDD B7	2500-2570	2620-2690	23dBm
LTE-FDD B8	880-915	925-960	23dBm
LTE-FDD B20	832-862	791-821	23dBm
LTE-FDD B28	703-748	758-803	23dBm
LTE-TDD B38	2570-2620	2570-2620	23dBm
LTE-TDD B40	2300-2400	2300-2400	23dBm
LTE Band 3	1710-1785	1805-1880	23dBm
LTE Band 41	2535-2675	2535-2675	23dBm

TECHNICAL DATA FOR 4G-GNSS

Global Navigation SatelliteSystem (GNSS)	GPS / GLONASS / BDS / Galileo / SBAS
Nominal Frequency	1559-1610 MHz 1215-1300 MHz 1164-1215 MHz

NOISE DATA

	WR303E WR305E WR365E WR365E.1 WR308E WR304E WR306E	WR310E WR312E WR318E WR330E
A weighted sound pressure	$L_{pA} = 47 \text{ dB(A)}$ $K_{pA} = 1.3 \text{ dB(A)}$	$L_{pA} = 48 \text{ dB(A)}$ $K_{pA} = 2.7 \text{ dB(A)}$
A weighted sound power	$L_{wA} = 55 \text{ dB(A)}$ $K_{wA} = 1.3 \text{ dB(A)}$	$L_{wA} = 56 \text{ dB(A)}$ $K_{wA} = 2.7 \text{ dB(A)}$
Wear ear protection when sound pressure is over 80 dB (A).		



	WR340E	WR341E WR342E WR344E
A weighted sound pressure	$L_{pA} = 47.4 \text{ dB(A)}$ $K_{pA} = 0.8 \text{ dB(A)}$	$L_{pA} = 47.7 \text{ dB(A)}$ $K_{pA} = 1.4 \text{ dB(A)}$
A weighted sound power	$L_{wA} = 55.4 \text{ dB(A)}$ $K_{wA} = 0.8 \text{ dB(A)}$	$L_{wA} = 55.7 \text{ dB(A)}$ $K_{wA} = 1.4 \text{ dB(A)}$
Wear ear protection when sound pressure is over 80 dB (A).		



A degree of noise from the machine is not avoidable. Route noisy work is to be licensed and limits for certain periods. Keep rest periods and they may need to restrict the working hours to a minimum. For their personal protection and protection of people working nearby, an appropriate hearing protection shall be worn.

ACCESSORIES

	WR303E	WR305E WR365E	WR365E.1 WR308E	WR304E	WR306E	WR310E
Screw	8	8	8	8	8	8
Charging tower	1	1	1	1	1	1
Charging base plate	1	1	1	1	1	1
Hex key	1	1	1	1	1	1
Blade	6	6	8	6	8	8
Cut to Zero module	/	/	1	/	1	1
Battery pack (WA3640)	1	/	/	1	/	/
Battery pack (WA3644)	/	1	1	/	1	1
Charger (WA3931 / WA3932)	1	/	/	1	/	/
Charger (WA3775 / WA3776)	/	1	1	/	1	1

	WR312E	WR318E	WR330E	WR340E WR341E	WR342E	WR344E
Screw	8	8	8	8	8	8
Charging tower	1	1	1	1	1	1
Charging base plate	1	1	1	1	1	1
Hex key	1	1	1	1	1	1
Blade	8	8	8	6	6	8
Cut to Zero module	1	1	1	/	/	1
FiatLux	/	/	1	/	/	1
RadioLink	1	1	/	/	1	/
Battery pack (WA3644)	1	/	/	1	/	/
Battery pack (WA3645)	/	1	1	/	1	1
Charger (WA3775 / WA3776)	1	1	/	1	1	/
Charger (WA3796 / WA3798)	/	/	1	/	/	1

We recommend that you purchase genuine accessories listed in the above list from the same store where you purchased the tool. Refer to the accessory packaging for further details. Store personnel can assist you and offer advice.

DECLARATION OF CONFORMITY

We,
 Positec Germany GmbH
 Postfach 680194, 50704 Cologne, Germany

On behalf of Positec declare that the product

Description **Robotic Lawnmower**

Type **WR303E; WR305E; WR365E; WR365E.1; WR308E; WR304E; WR306E; WR310E; WR312E; WR318E; WR330E; WR340E; WR341E; WR342E; WR344E (200-399 - designation of machinery, representative of Robotic lawn mower with Vision technology) (Serial number is placed on the back page) with battery charger WA3931 / WA3932 / WA3775 / WA3776 / WA3796 / WA3798 and charging station WA0516 / WA0517**

Function **Cutting grass**

Serial number **It can be found on marking label**

Complies with the following Directives,
2006/42/EC, 2014/30/EU, 2014/35/EU, 2011/65/EU&(EU)2015/863, 2000/14/EC amended by 2005/88/EC&(EU)2024/1208, 2014/53/EU amended by (EU) 2022/30

2000/14/EC amended by 2005/88/EC&(EU)2024/1208 **WR303E WR305E WR365E WR365E.1 WR308E WR304E WR306E**

- Conformity Assessment Procedure as per **Annex V**
- Measured Sound Power Level **55.0 dB (A)**
- Declared Guaranteed Sound Power Level **57 dB (A)**

2000/14/EC amended by 2005/88/EC&(EU)2024/1208 **WR310E WR312E WR318E WR330E**

- Conformity Assessment Procedure as per **Annex V**
- Measured Sound Power Level **56.0 dB (A)**
- Declared Guaranteed Sound Power Level **59 dB (A)**

2000/14/EC amended by 2005/88/EC&(EU)2024/1208 **WR340E / WR341E WR342E WR344E**

- Conformity Assessment Procedure as per **Annex V / Annex V**
- Measured Sound Power Level **55.4 dB (A) / 55.7 dB (A)**
- Declared Guaranteed Sound Power Level **57 dB (A) / 58 dB (A)**

Standards conform to,

For Lawn mower: EN 50636-2-107:2015+A1:2018+A2:2020+A3:2021, EN 60335-1:2012+A11:2014+A13:2017+A1:2019+A2:2019+A14:2019+A15:2021+A16:2023, EN IEC 62311:2020, EN IEC 55014-1:2021, EN IEC 55014-2:2021, EN IEC 61000-3-2:2019+A1:2021+A2:2024, EN 61000-3-3:2013+A1:2019+A2:2021+AC:2022, EN 18031-1:2024, EN 18031-2:2024
For Bluetooth & Wi-Fi module (2.4G): EN 301 489-1 V2.2.3, EN 301 489-17 V3.3.1, EN 300 328 V2.2.2
For 4G+GPS module: EN 301 489-1 V2.2.3, EN 301 489-19 V2.2.1, EN 301 489-52 V1.3.1, EN 301 511 V12.5.1, EN 301 908-1 V15.2.1, EN 301 908-13 V13.2.1, EN 303 413 V1.2.1, EN 301 908-2 V13.1.1, EN 50665:2017
For charger: EN IEC 55014-1:2021, EN IEC 55014-2:2021, EN IEC 61000-3-2:2019+A1:2021+A2:2024, EN 61000-3-3:2013+A1:2019+A2:2021, EN IEC 60335-2-29:2021+A1:2021+A11:2024, EN 60335-1:2012+A11:2014+A13:2017+A1:2019+A2:2019+A14:2019+A15:2021+A16:2023, EN 62233:2008
For Noise: EN ISO 3744:2010
For RoHS: EN IEC 63000:2018

The person authorized to compile the technical file,

Name Marcel Filz
Address Positec Germany GmbH
Postfach 680194, 50704 Cologne, Germany



2026/01/15
 Allen Ding
 Deputy Chief Engineer, Testing & Certification
 authorized to issue the declaration of conformity
 on behalf of the manufacturer
 Positec Technology (China) Co., Ltd
 18, Dongwang Road, Suzhou Industrial
 Park, Jiangsu 215123, P. R. China

DECLARATION OF CONFORMITY

We,
Positec Germany GmbH
Postfach 680194, 50704 Cologne, Germany

On behalf of Positec declare that the product
Description **Battery pack**
Type **WA3640; WA3644; WA3645**
Function **Provide energy for power tools, garden tools and similar products**
Serial number **It can be found on marking label**

Complies with the following Regulation and Directives,
(EU) 2023/1542, 2011/65/EU & (EU) 2015/863

Standards conform to,
EN 62133-2:2017, EN 62133-2:2017/A1:2021, EN IEC 63000:2018

The person authorized to compile the technical file,
Name Marcel Filz
Address Positec Germany GmbH
Postfach 680194, 50704 Cologne, Germany

2026/01/13
Allen Ding
Deputy Chief Engineer, Testing & Certification
authorized to issue the declaration of conformity
on behalf of the manufacturer
Positec Technology (China) Co., Ltd
18, Dongwang Road, Suzhou Industrial
Park, Jiangsu 215123, P. R. China

DECLARATION OF CONFORMITY

We,
Positec (UK & Ireland) Ltd
PO BOX 6242, Newbury, RG14 9LT, UK

On behalf of Positec declare that the product

Description **Robotic Lawnmower**

Type **WR303E; WR305E; WR365E; WR365E.1; WR308E; WR304E; WR306E; WR310E; WR312E; WR318E; WR330E; WR340E; WR341E; WR342E; WR344E (200-399 - designation of machinery, representative of Robotic lawn mower with Vision technology) (Serial number is placed on the back page) with battery charger WA3931 / WA3932 / WA3775 / WA3776 / WA3796 / WA3798 and charging station WA0516 / WA0517**

Function **Cutting grass**

Serial number **It can be found on marking label**

Complies with the following Regulations:

Supply of Machinery (Safety) Regulations 2008

Radio Equipment Regulations 2017

Electrical Equipment (Safety) Regulations 2016

Electromagnetic Compatibility Regulations 2016

The Restriction of the Use of Certain Hazardous Substances in Electrical and Electronic Equipment Regulations

Noise Emission in the Environment by Equipment for Use Outdoors Regulations

- Conformity Assessment Procedure as per
- Measured Sound Power Level
- Declared Guaranteed Sound Power Level

**WR303E WR305E WR365E WR365E.1 WR308E WR304E WR306E
Annex V
55.0 dB (A)
57 dB (A)**

Noise Emission in the Environment by Equipment for Use Outdoors Regulations

- Conformity Assessment Procedure as per
- Measured Sound Power Level
- Declared Guaranteed Sound Power Level

**WR310E WR312E WR318E WR330E
Annex V
56.0 dB (A)
59 dB (A)**

Noise Emission in the Environment by Equipment for Use Outdoors Regulations

- Conformity Assessment Procedure as per
- Measured Sound Power Level
- Declared Guaranteed Sound Power Level

**WR340E / WR341E WR342E WR344E
Annex V / Annex V
55.4 dB (A) / 55.7 dB (A)
57 dB (A) / 58 dB (A)**

Standards conform to,

**For Lawn mower: BS EN 50636-2-107:2015+A1:2018+A2:2020+A3:2021, BS EN 60335-1:2012+A11:2014+A13:2017+A1:2019+A2:2019+A14:2019+A15:2021+A16:2023, BS EN IEC 62311:2020, BS EN IEC 55014-1:2021, BS EN IEC 55014-2:2021, BS EN IEC 61000-3-2:2019+A1:2021+A2:2024, BS EN 61000-3-3:2013+A1:2019+A2:2021+AC:2022, BS EN 18031-1:2024, BS EN 18031-2:2024
For Bluetooth & Wi-Fi module (2.4G): BS EN 301 489-1 V2.2.3, BS EN 301 489-17 V3.3.1, BS EN 300 328 V2.2.2
For 4G+GPS module: BS EN 301 489-1 V2.2.3, BS EN 301 489-19 V2.2.1, BS EN 301 489-52 V1.3.1, BS EN 301 511 V12.5.1, BS EN 301 908-1 V15.2.1, BS EN 301 908-13 V13.2.1, BS EN 303 413 V1.2.1, BS EN 301 908-2 V13.1.1, BS EN 50665:2017
For charger: BS EN IEC 55014-1:2021, BS EN IEC 55014-2:2021, BS EN 61000-3-2:2019+A1:2021+A2:2024, BS EN 61000-3-3:2013+A1:2019+A2:2021, BS EN IEC 60335-2-29:2021+A1:2021+A11:2024, BS EN 60335-1:2012+A11:2014+A13:2017+A1:2019+A2:2019+A14:2019+A15:2021+A16:2023, BS EN 62233:2008
For Noise: BS EN ISO 3744:2010
For RoHS: BS EN IEC 63000:2018**

The person authorized to compile the technical file,

Name Jim Kirkwood
Address Positec (UK & Ireland) Ltd
PO BOX 6242, Newbury, RG14 9LT, UK



2026/01/15
Allen Ding
Deputy Chief Engineer, Testing & Certification
authorized to issue the declaration of conformity
on behalf of the manufacturer
Positec Technology (China) Co., Ltd
18, Dongwang Road, Suzhou Industrial
Park, Jiangsu 215123, P. R. China

DECLARATION OF CONFORMITY

We,
Positec (UK & Ireland) Ltd
PO BOX 6242, Newbury, RG14 9LT, UK

On behalf of Positec declare that the product
Description **Battery pack**
Type **WA3640; WA3644; WA3645**
Function **Provide energy for power tools, garden tools and similar products**
Serial number **It can be found on marking label**

Complies with the following Regulation,
The Batteries and Accumulators (Placing on the Market) Regulations 2008 (as amended) and the Waste Batteries and Accumulators Regulations 2009 (as amended)
The Restriction of the Use of Certain Hazardous Substances in Electrical and Electronic Equipment Regulations 2012

Standards conform to,
BS EN 62133-2:2017, BS EN 62133-2:2017/A1:2021, BS EN IEC 63000:2018

The person authorized to compile the technical file,
Name Jim Kirkwood
Address Positec (UK & Ireland) Ltd
PO BOX 6242, Newbury, RG14 9LT, UK



2026/01/15
Allen Ding
Deputy Chief Engineer, Testing & Certification
authorized to issue the declaration of conformity
on behalf of the manufacturer
Positec Technology (China) Co., Ltd
18, Dongwang Road, Suzhou Industrial
Park, Jiangsu 215123, P. R. China