

**FEATURES**

- PVC-U fittings for the PVC pipe union.
- Material: PVC-U.
- Injection moulding.
- Density: 1,4 g/cm<sup>3</sup>.
- Color: grey RAL 7024.
- Dimensions: socket fittings D16 to D400 and threaded fittings from ¼" to 4".
- Dimensions:
  - Socket fittings according to EN 1452-3.
  - Threaded fittings according to ISO 7/1.
- For tubes according to EN 1452-2.
- Socket fittings: we recommend solvent cement for PVC-U.
- Threaded fittings: in order to guarantee the watertightness, PTFE thread-wrap tape must be used. In PVC-U metal unions, use PVC-U as the male.

**CARACTERÍSTICAS**

- Accesorios en PVC-U para unión de tuberías de PVC.
- Moldeo por inyección.
- Densidad: 1,4 g/cm<sup>3</sup>.
- Color: gris RAL 7024.
- Dimensiones: accesorios encolar de D16 hasta D400 y accesorios roscar de ¼" a 4".
- Dimensiones:
  - Accesorios encolar según la norma EN 1452-3.
  - Accesorios roscados según la norma ISO 7/1.
- Para tubos según norma EN 1452-2.
- Accesorios encolar: recomendamos el uso de cola para PVC-U.
- Accesorios roscados: para garantizar la estanqueidad sólo es admisible el uso de cinta de PTFE. En uniones PVC-U-metal, el macho debe ser el PVC-U.

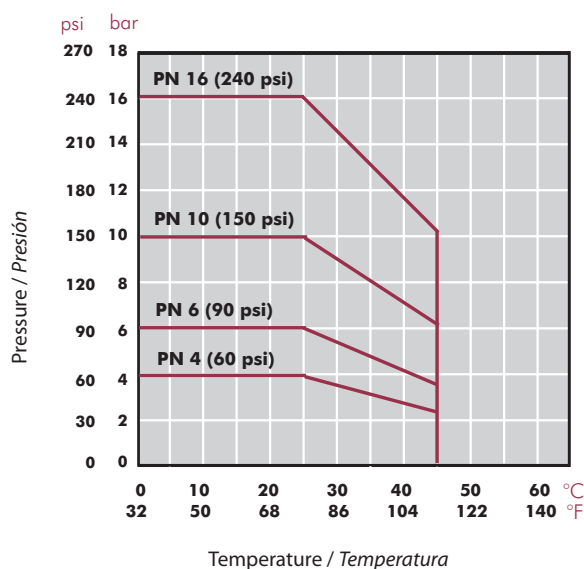

FIG.	Details	Detalles
1	Logo, material, dimensions, PN	Logo, material, dimensiones, PN
2	European standard, N (Aenor), Kiwa o NF (Afnor)	Norma europea, N (Aenor), Kiwa o NF (Afnor)
3	Marked at 45°	Marcaje a 45°

**TECHNICAL CHARACTERISTICS**  
**CARACTERÍSTICAS TÉCNICAS**

Unions Uniones	Sizes Medidas	Working pressure at 20°C Presión de servicio a 20°C
Solvent socket / Encolar	D16 - D140	PN 16 (240 psi)
Solvent socket / Encolar	D160 - D315	PN10 (150 psi)
Threaded / Roscar	½" - 4"	PN 10 (150 psi)
Threaded reinforced / Roscar reforzado	½" - 4"	PN 16 (240 psi)

**PRESSURE / TEMPERATURE GRAPH**  
**DIAGRAMA PRESIÓN / TEMPERATURA**



Life: 50 years  
Hydrostatic maximum pressure a component may withstand in continuous service (without overpressure)

*Vida útil: 50 años*  
*Presión hidrostática máxima que un componente es capaz de soportar en servicio continuo (sin sobrepresión)*

**TOLERANCE CHART**  
**TABLA TOLERANCIAS**

D	DN	Minimum diameter Diámetro mínimo	Maximum diameter Diámetro máximo
16	10	16.1	16.3
20	15	20.1	20.3
25	20	25.1	25.3
32	25	32.1	32.3
40	32	40.1	40.3
50	40	50.1	50.3
63	50	63.1	63.3
75	65	75.1	75.3
90	80	90.1	90.3
110	100	110.1	110.4
125	110	125.1	125.4
140	125	140.2	140.5
160	150	160.2	160.5
200	175	200.2	200.6
225	200	225.3	225.7
250	225	250.3	250.8
315	300	315.4	316.0

### UP. 18. MT - THREADED NIPPLE

**Hexagon nipple**

• BSP male thread

**Machón doble rosca**

• Roscar macho BSP

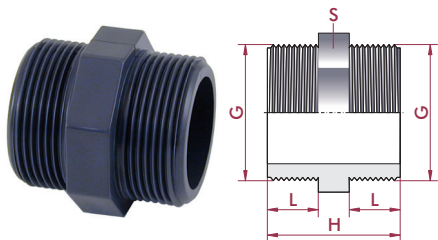

G	DN	PN	REF.	CODE
3/8"	10	10	05 18 616	<b>02111</b>
1/2"	15	10	05 18 620	<b>02112</b>
3/4"	20	10	05 18 625	<b>02113</b>
1"	25	10	05 18 632	<b>02114</b>
1 1/4"	32	10	05 18 640	<b>02115</b>
1 1/2"	40	10	05 18 650	<b>02116</b>
2"	50	10	05 18 663	<b>02117</b>
2 1/2"	65	10	05 18 675	<b>02118</b>
3"	80	10	05 18 690	<b>02119</b>
4"	100	10	05 18 710	<b>02120</b>

L	H	S
11	32	20
14	40	27
16	44	32
19	51	36
21	55	46
21	56	55
26	66	65
30	75	90
33	81	108
38	91	135

### UP. 31. SFT - ADAPTOR NIPPLE

**Adaptor nipple**

• Female solvent socket & BSP female thread

• Metric series

**Adaptador mixto**

• Encolar hembra y roscar hembra BSP

• Serie métrica

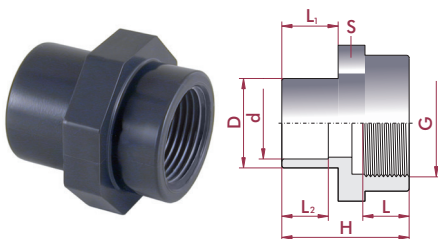

D - d x G	DN	PN	REF.	CODE
20 - 16 x 3/4"	16	10	05 31 420	<b>02243</b>
20 - 16 x 1/2"	16	10	05 31 421	<b>02244</b>
20 - 16 x 3/8"	12	10	05 31 422	<b>02245</b>
20 - 16 x 1/4"	12	10	05 31 423	<b>02246</b>
25 - 20 x 1"	20	10	05 31 425	<b>02247</b>
25 - 20 x 3/4"	20	10	05 31 426	<b>02248</b>
25 - 20 x 1/2"	16	10	05 31 427	<b>02249</b>
32 - 25 x 1 1/4"	25	10	05 31 432	<b>02250</b>
32 - 25 x 1"	25	10	05 31 433	<b>02251</b>
32 - 25 x 3/4"	20	10	05 31 434	<b>02252</b>
32 - 25 x 1/2"	16	10	05 31 435	<b>24822</b>
40 - 32 x 1 1/2"	32	10	05 31 440	<b>02253</b>
40 - 32 x 1 1/4"	32	10	05 31 441	<b>02254</b>
40 - 32 x 1"	25	10	05 31 442	<b>02255</b>
50 - 40 x 2"	40	10	05 31 450	<b>02256</b>
50 - 40 x 1 1/2"	40	10	05 31 451	<b>02257</b>
50 - 40 x 1 1/4"	32	10	05 31 452	<b>02258</b>
63 - 50 x 2 1/2"	50	10	05 31 463	<b>02259</b>
63 - 50 x 2"	50	10	05 31 464	<b>02260</b>
63 - 50 x 1 1/2"	40	10	05 31 465	<b>02261</b>
75 - 63 x 3"	50	10	05 31 475	<b>02262</b>
75 - 63 x 2 1/2"	65	10	05 31 476	<b>02263</b>
75 - 63 x 2"	50	10	05 31 477	<b>02264</b>
90 - 75 x 4"	65	10	05 31 490	<b>02265</b>
90 - 75 x 3"	65	10	05 31 491	<b>02266</b>
90 - 75 x 2 1/2"	65	10	05 31 492	<b>02267</b>
110 - 90 x 4"	80	10	05 31 511	<b>02268</b>
110 - 90 x 3"	80	10	05 31 512	<b>02269</b>

L	L <sub>1</sub>	L <sub>2</sub>	H	S
19	16	14	44	32
18	16	14	43	32
14	16	14	39	32
12	16	14	37	32
22	19	16	50	36
19	19	16	47	32
18	19	16	46	32
25	22	19	56	46
22	22	19	53	36
19	22	19	50	36
18	22	19	49	36
25	26	22	60	55
25	26	22	60	46
22	26	22	57	46
29	31	26	69	65
25	31	26	65	55
25	31	26	65	55
34	38	31	81	78
29	38	31	76	65
25	38	31	72	65
37	44	38	96	108
34	44	38	87	78
29	44	38	82	78
42	51	44	124	135
36	51	44	98	108
33	51	44	92	90
42	61	51	116	135
36	61	51	105	110

### UP. 24. SF - SPIGOT CONNECTION

**Spigot connection**

• Solvent socket

**Espiga conexión a PE lisa**

• Encolar

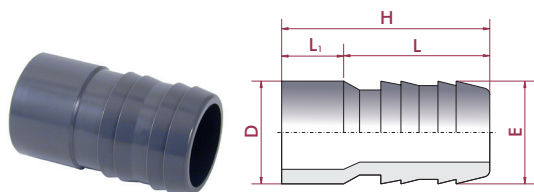

D x E	DN	PN	REF.	CODE
16 x 16	10	10	05 24 016	<b>02200</b>
20 x 18	15	10	05 24 018	<b>02201</b>
20 x 20	15	10	05 24 020	<b>02202</b>
25 x 25	20	10	05 24 025	<b>02203</b>
32 x 30	25	10	05 24 032	<b>02204</b>
40 x 40	32	10	05 24 040	<b>02205</b>
50 x 50	40	10	05 24 050	<b>02206</b>
50 x 38	40	10	05 24 051	<b>02207</b>
63 x 60	50	10	05 24 063	<b>02208</b>

H	L <sub>1</sub>	L	E
49	14	35	16
51	16	35	18
54	16	38	20
61	19	42	25
69	22	47	30
78	26	52	40
88	31	57	50
88	31	57	38
98	38	60	61